

PRODUCT NO.  
10018784-X0XXXX

1 2

3

4

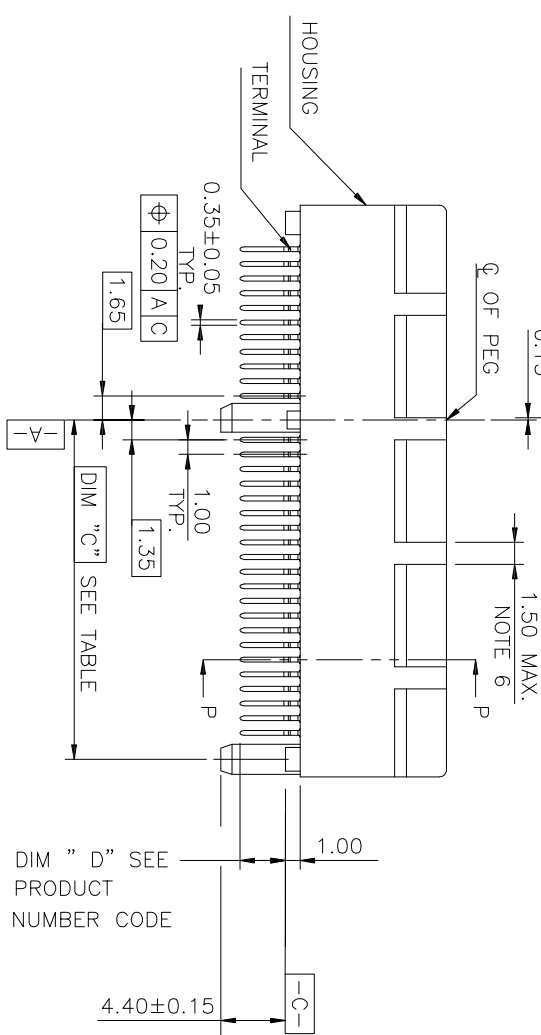
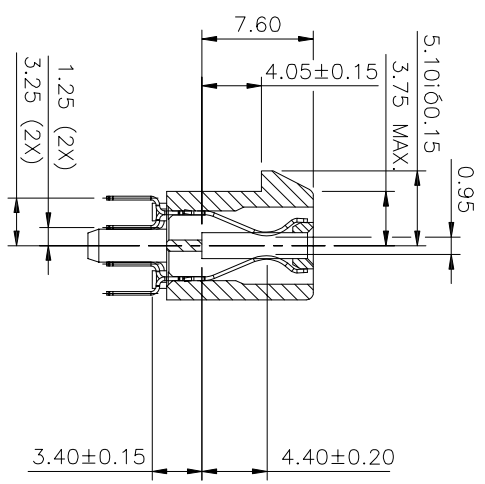
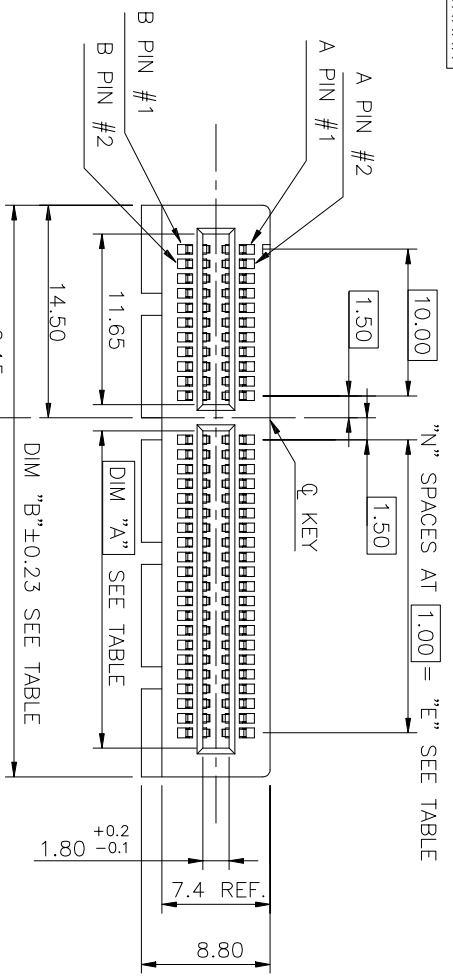

PLASTIC PEG TYPE

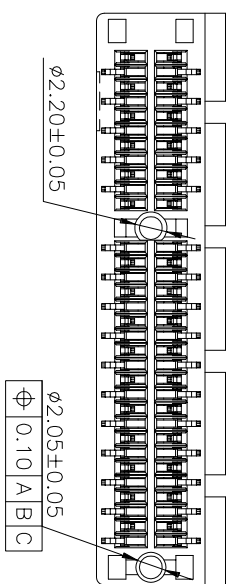

CONFIDENTIAL

mat'l. code	ecm no.	dr	date	linear	tolerances unless otherwise specified	CUSTOMER COPY	projection	title
M T05-0124	M	W	06/07/05	.XX ± 0.20	X ± 0.30			PCI EXPRESS GEN3
N T05-0153	M	W	07/12/05	.XXX ± 0.10				CARD EDGE ASSY
P T05-0208	M	W	09/15/05	0° ±2°				EDGE CARD
R T05-0206	R	C	12/01/06					
S ELX-06-2161-1	S	T	05/27/15					

sheet	revision	sheet	1	2	3	4	5	6
Index		Sheet						

code	revision	sheet	1	2	3	4	5	6
code		Sheet						

code	revision	sheet	1	2	3	4	5	6
code		Sheet						

code	revision	sheet	1	2	3	4	5	6
code		Sheet						

code 22526

PRODUCT NO.  
10018784-X1XXXX

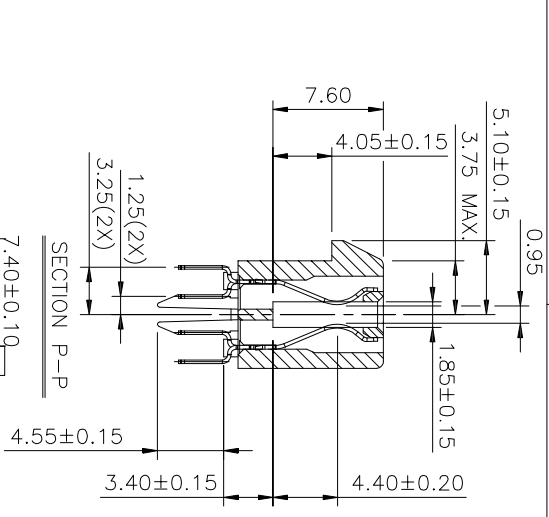
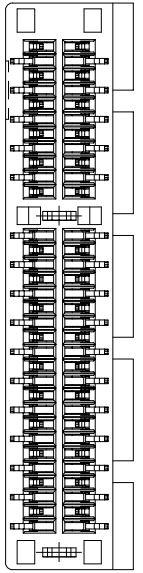
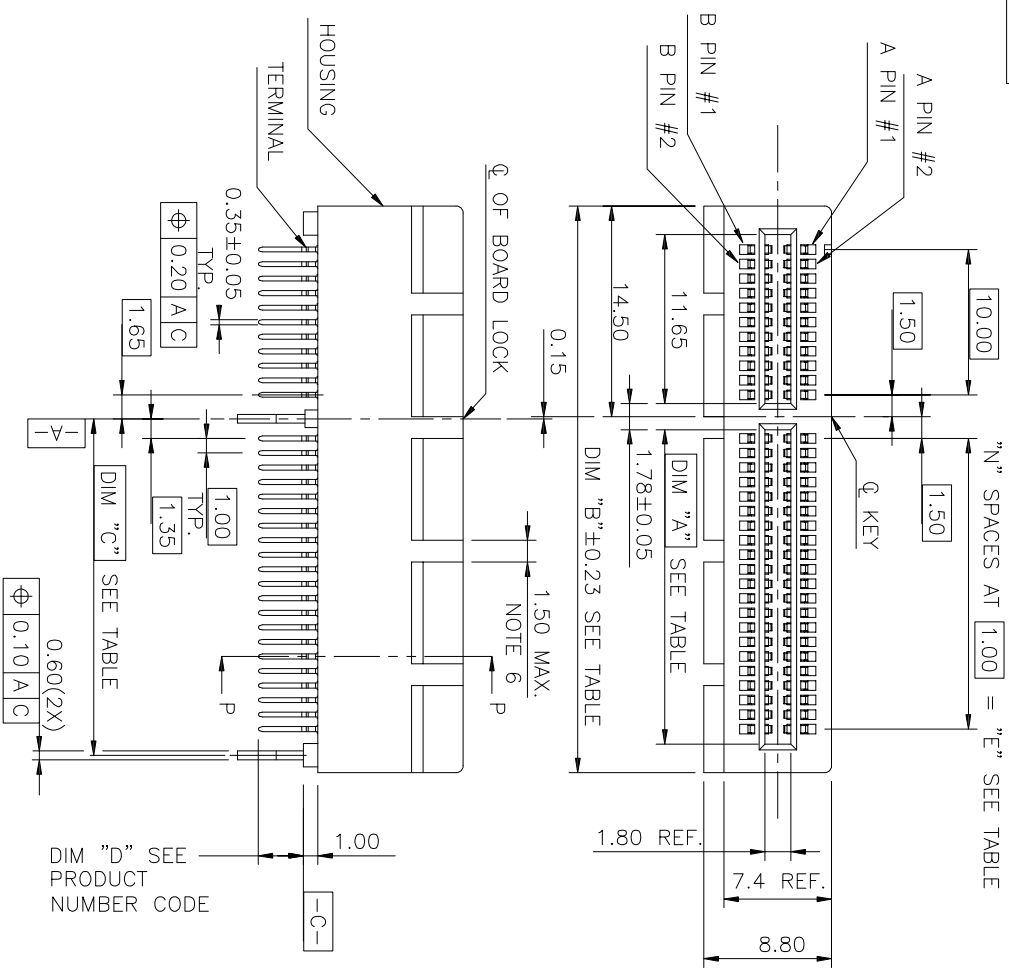

METAL BOARD LOCKS TYPE

CONFIDENTIAL

mat'l. code		tolerances unless otherwise specified		CUSTOMER COPY		title	
itr	ecn no	dr	date	linecr	projection	product family	PCI EXPRESS GEN3 CARD EDGE ASSY
				.XX ± 0.30	MM	EDGE CARD	
				.XXX ± 0.10		10018784	
				0° ± 2°	scale	2:1	
				dr STONE LI 05/27/15			
				engr STONE LI 05/27/15			
				chr /			
				qppd PM ZHENG 05/27/15			
sheet	revision						code
index	sheet						TWN
							code
							2 of

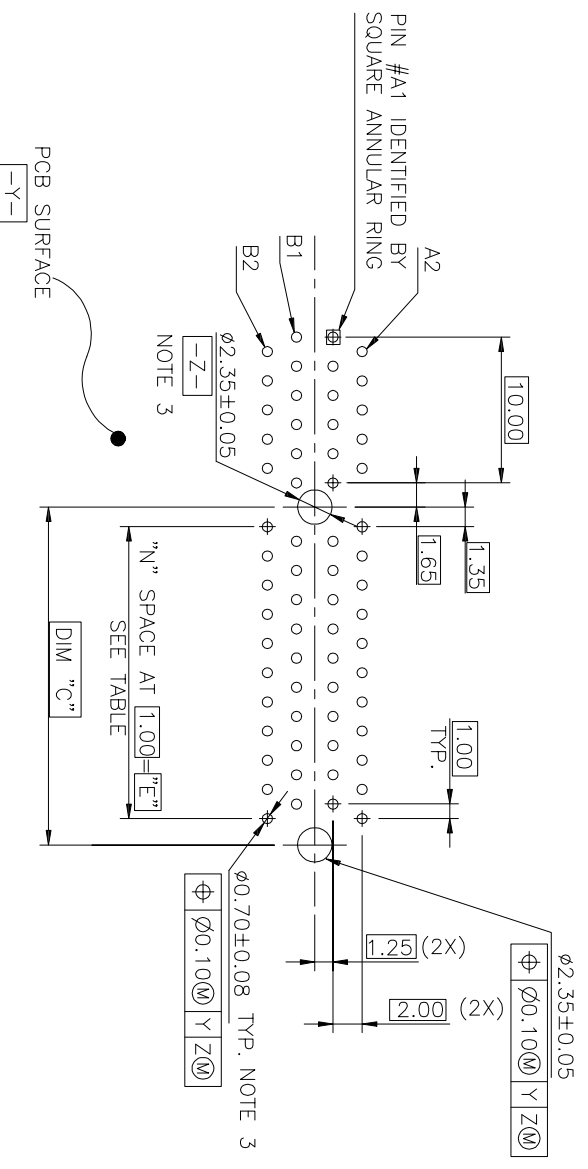

→ I/O PANEL DIRECTION

RECOMMENDED FOOTPRINT

CONFIDENTIAL

mat'l. code		tolerances unless otherwise specified		CUSTOMER COPY		 www.fciconnect.com	
ltr	ecn no	dr	date	linear	X ±	projection	title
				.XXX ±		MM	PCI EXPRESS GEN3 CARD EDGE ASS'Y
				angles	0° ±2'	scale	product family
				dr	STONE LI	2:1	EDGE CARD
				engr	STONE LI		code
				chr	/		TWN
				qppd	PM ZHENG		sheet
					05/27/15		3 of
sheet	revision						
Index	sheet						

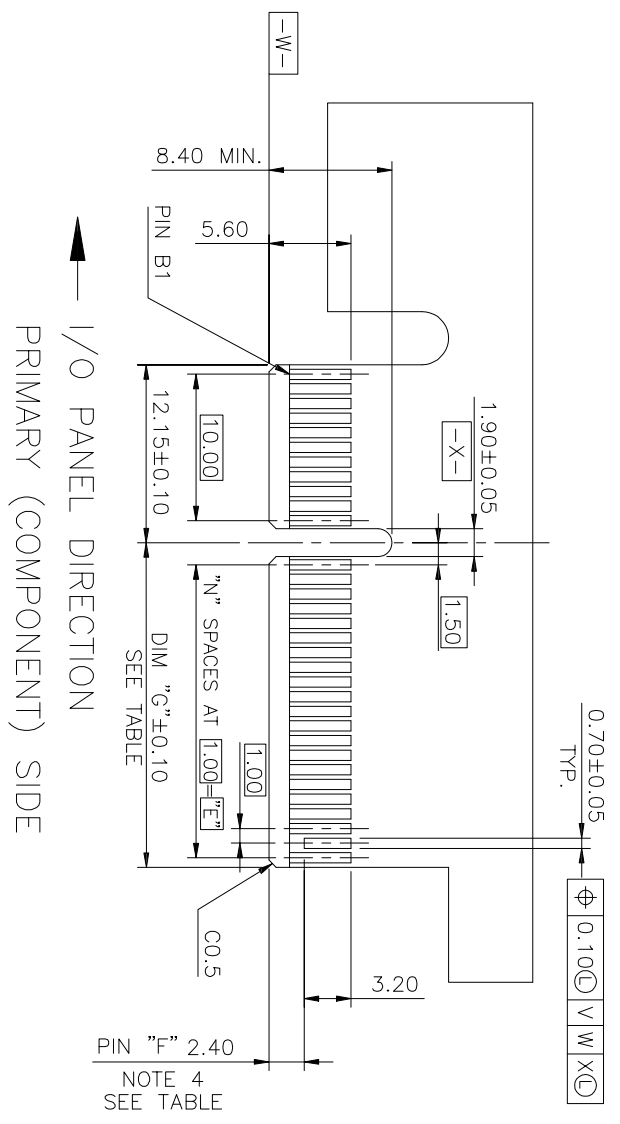

I/O PANEL DIRECTION  
PRIMARY (COMPONENT) SIDE

SCALE 2:1

I/O PANEL DIRECTION  
SECONDARY (SOLDER) SIDE

# POS. REF.	N	DIM "G"	"F"
36	6	8.15	B17
64	20	22.15	B31
98	37	39.15	B48
164	70	72.15	B81

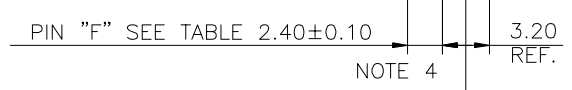

ADD-IN CARD EDGE-FINGER DIMENSIONS

CONFIDENTIAL

mat'l. code	tolerances unless otherwise specified	CUSTOMER COPY	title
ltr	.X ±	projection	<b>FCI</b> PCI EXPRESS GEN3 CARD EDGE ASS'Y
ecm no	.XX ±	MM	product family EDGE CARD
dr	.XXX ±	scale	size dwg no 10018784
date	0° ±2'	2:1	code TWIN
linear	STONE LI 05/27/15		sheet 4 of
angles	engr STONE LI 05/27/15		
dr	chr /		
engr	pppd PM ZHENG 05/27/15		
chr			
pppd			

code code  
22526

NOTES:

1. MATERIAL:

HOUSING: NYLON, GLASS FILLED UL94V-0 RATE, SUITABLE FOR WAVE SOLDERING.

TERMINAL: COPPER ALLOY

PLATING: 50u" NICKEL UNDERPLATE ALL OVER

CONTACT AREA PLATING - SEE PRODUCT NUMBER CODE

SOLDER TAIL: TIN/LEAD (90/10) - SEE PRODUCT NUMBER CODE

METAL BOARD LOCKS: COPPER ALLOY

FINISH: 100u" TIN/LEAD (90/10) OVER 50u" NICKEL

2. PRODUCT SPECIFICATION: GS-12-233

UNDERPLATE SEE PRODUCT NUMBER CODE

3. THE HORIZONTAL AXIS FOR THE HOLE PATTERN IS ESTABLISHED BY

A LINE THROUGH THE CENTER OF THE TWO #2.35 HOLES.

THE VERTICAL AXIS IS 90° TO THE HORIZONTAL AXIS, THROUGH THE CENTER

OF DATUM Z.

4. NO THE BAR PERMITTED FROM CARD EDGE TO LEADING EDGE OF PAD FOR

PINS A1 AND PIN NUMBERS "F".

5. CHAMFER EDGES MUST BE FREE OF CUTTING BURRS.

6. FREQUENCY & LOCATION AT SUPPLIER DISCRETION. RIDGE MAY BE

CONTINUOUS WITH NO BREAKS.

7. ROHS COMPATIBLE PRODUCT SPECIFICATIONS

8. PLATING:

- "LF" MEANS THE PRODUCT IS LEAD-FREE, 2um MINIMUM MATTE TIN OVER 1.27um

MINIMUM NICKEL UNDERPLATE.

9. MANUFACTURING PROCESS COMPATIBILITY

- THE HOUSING WILL WITHSTAND EXPOSURE TO 260°C±5°C SOLDER BATH TEMPERATURE FOR

5 SECONDS IN A WAVE SOLDER APPLICATION WITH A 1.6mm MIN THICK CIRCUIT BOARD.

- THE HOUSING WILL WITHSTAND EXPOSURE TO 240°C±5°C SOLDER BATH TEMPERATURE FOR

5 SECONDS IN A WAVE SOLDER APPLICATION WITH A 1.6mm MIN THICK CIRCUIT BOARD.

(For 10018784-X 0 X X X (X) X options)

PRODUCT NUMBER CODE  
10018784-X X X X X X X X X X X X

LEAD FREE OPTION  
LEAVE BLANK FOR TERMINAL PLATING 3,4,5  
"LF" FOR TERMINAL PLATING OPTION 0,1,2

HOUSING COLOR OPTIONS  
0-WHITE  
1-BLACK

PEGS OPTIONS  
0-PLASTIC PEGS  
1-METAL BOARD LOCKS

TERMINAL PLATING OPTIONS

0-50u" NI UNDERPLATE  
30u" AU CONTACT AREA  
100u" TIN TAIL AREA ----- COMPATIBLE ROHS  
1-50u" NI UNDERPLATE  
15u" AU CONTACT AREA  
100u" TIN TAIL AREA ----- COMPATIBLE ROHS  
2-50u" NI UNDERPLATE  
GOLD FLASH CONTACT AREA  
100u" TIN TAIL AREA ----- COMPATIBLE ROHS  
3-50u" NI UNDERPLATE  
30u" AU CONTACT AREA  
100u" TIN/LEAD TAIL AREA ----- INCOMPLIANT ROHS  
4-50u" NI UNDERPLATE  
15u" AU CONTACT AREA  
100u" TIN/LEAD TAIL AREA ----- INCOMPLIANT ROHS  
5-50u" NI UNDERPLATE  
GOLD FLASH CONTACT AREA  
100u" TIN/LEAD TAIL AREA ----- INCOMPLIANT ROHS

TAIL LENGTH OPTIONS  
DIM "D"  
PCB THICKNESS  
BOARD LOCKS DIM "G"

DIM "D"	PCB THICKNESS	BOARD LOCKS DIM "G"
0	2.30 ±0.13	1.56 ±0.10
1	3.10 ±0.25	2.36 ±0.10
		2.50 ±0.15

POS OPTIONS  
0-36  
1-64  
2-98  
3-184

PACKAGING OPTIONS  
T-TRAY PACKAGING  
M-TRAY PACKAGING & MYLAR TAPE FOR PICK-N-PLACE. SEE FIGURE 1

CONNECTOR	#	POS REF.	N	DIM "A"	DIM "B"	DIM "C"	"E"
1 PORT	36	6	6	7.65	25.00	9.15	6.00
4 PORT	64	20	20	21.65	39.00	23.15	20.00
8 PORT	98	37	37	38.65	56.00	40.15	37.00
16 PORT	164	70	70	71.65	89.00	73.15	70.00

**CONFIDENTIAL**

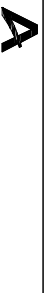

PCI EXPRESS GEN3 CARD EDGE ASSY

EDGE CARD

product family

size dwg no

10018784

code

TWN

sheet

5 of

code code

22526

CUSTOMER COPY  
projection  
scale

tolerances unless otherwise specified	X ±	projection	scale
lineor	.XXX ±		MM
onngles	0° ±2'		
dr	STONE LI 05/27/15		
engr	STONE LI 05/27/15	scale	1:1
chr	/		
qppd	PM ZHENG 05/27/15		

mat'l. code	ecr no	dr	date	lineor	onngles	dr	engr	chr	qppd
itr				.XXX ±	0° ±2'	STONE LI	05/27/15	/	PM ZHENG
sheet									
index									

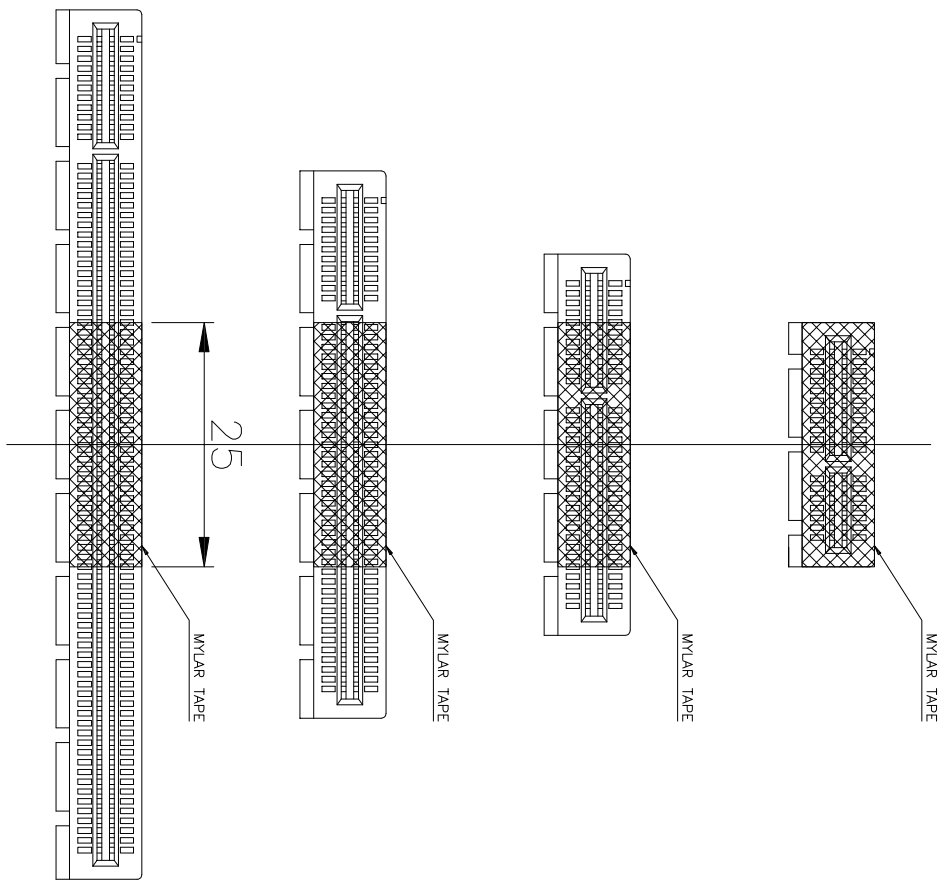

FIGURE 1

CONFIDENTIAL

mat'l. code		tolerances unless otherwise specified		CUSTOMER COPY		title	
litr	ecn no	dr	date	.X ± 0.25		PCI EXPRESS GEN3 CARD EDGE ASS'Y	
				.XX ± 0.13		www.fciconnect.com	
				.XXX ± 0.05		product family	
				0° ± 2°		EDGE_CARD	
				STONE LI 05/27/15		code	
				STONE LI 05/27/15		TWN	
				engr /		code	
				chr /		sheet	
				oppd PM ZHENG 05/27/15		6 of	
sheet	revision			scale 1.5:1		sheet	
index	sheet			A4		6 of	

code code  
22526