

281/556/557 Series

Thru-Hole Circuit Board Mount Blocks for Micro™/TR-3 Fuses

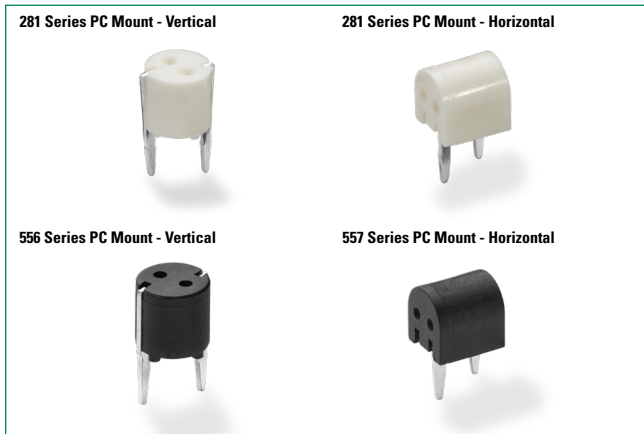

Product Characteristics

| Compatible Fuses | 281 Series Vertical | 281 Series Horizontal | 556 Series Vertical | 557 Series Horizontal |
|---------------------------|--|-----------------------|--------------------------------|-----------------------|
| | MICRO™/TR3® | | | |
| Description | Thru-hole circuit board mount blocks designed for Littelfuse MICRO™/TR3 type and other fuse series with .025" diameter leads rated to 5 amps | | | |
| Electrical | Rated at 5A / 1.6W to 125 volts. | | | |
| Mounting Method | PC Board Thru-Hole @ 5.08 hole spacing | | | |
| Mount Color & Direction | White Vertical | White Horizontal | Black Vertical | Black Horizontal |
| Molded Part Specs | White Thermoplastic UL 94V0 PBT | | Black Thermoplastic UL 94V0 | |
| Metal Parts and Terminals | Copper Alloy with options Tin Plating (281008, 281010) or Silver Plating (281005, 281007) | | Copper Alloy with Tin Plating | |
| Ambient Temperature | -40°C to +100°C. | | | |
| Unit Weight | 0.41g | 0.50g | 0.42g | 0.51g |

Additional Information



Resources
281 Series



Resources
556 Series



Resources
557 Series



Accessories
281 Series



Accessories
556 Series



Accessories
557 Series



Samples
281 Series



Samples
556 Series



Samples
557 Series

Agency Approvals

| Agency | Agency File Number | | |
|--------|--------------------|------------|------------|
| | 281 Series | 556 Series | 557 Series |
| | E14721 | N/A | N/A |

Ordering Information

| Ordering Number | Terminal Plating | Mount Color | Mount Direction | Packaging |
|-----------------|---------------------|-------------|-----------------|------------------|
| 02810005H | Silver ¹ | White | Vertical | 100 (Bulk pack) |
| 02810008H | Tin ¹ | White | Vertical | 100 (Bulk pack) |
| 02810007H | Silver ¹ | White | Horizontal | 100 (Bulk pack) |
| 02810010H | Tin ¹ | White | Horizontal | 100 (Bulk pack) |
| 55600000001* | Tin | Black | Vertical | 1000 (Bulk pack) |
| 55700000001* | Tin | Black | Horizontal | 1000 (Bulk pack) |

1. UL recognized.

* RoHS compliant.

Note: 281 Series meets with Glow Wire requirements specified on IEC 60695-2-12 & 60695-2-13

Disclaimer Notice - Information furnished is believed to be accurate and reliable. However, users should independently evaluate the suitability of and test each product selected for their own applications. Littelfuse products are not designed for, and may not be used in, all applications. Read complete Disclaimer Notice at: www.littelfuse.com/disclaimer-electronics.



Dimensions units in inch (mm)

02810005H, 02810008H
White / Vertical Mount Devices

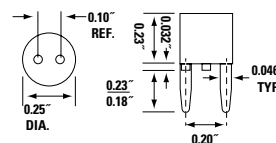

Circuit Board Mounting Detail

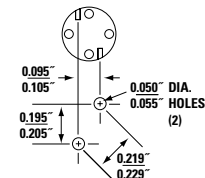

02810007H, 02810010H
White / Horizontal Mount Devices

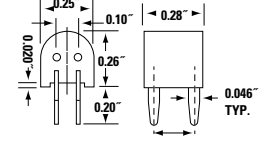

Circuit Board Mounting Detail

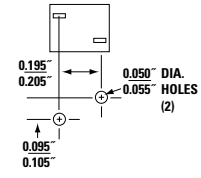

55600000001
Black / Vertical Mount Devices

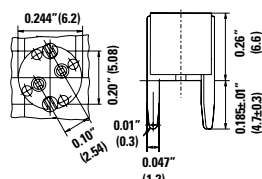

Circuit Board Mounting Detail

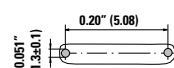

55700000001
Black / Horizontal Mount Devices

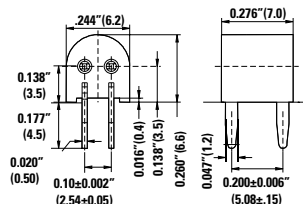

Circuit Board Mounting Detail

