



Speakon® 8-Pole



This series of professional speaker and amplifier connectors is recognized as the industry standard. The Speakon® product line now comes in 2,4, and 8 contact versions.

Patent protected, reliable, cost effective, and extremely durable the Speakon® system offers the "quick lock" locking system and recently redesigned inserts on it's cable ends. The inserts feature solderless connections using new pozidrive and slot combination screw terminals with a captivated pressure plate. No special tools are required making these connectors 100% field repairable.

Speakon® panel receptacles with solder terminations also allow you to use quick disconnect type terminals for ease and reliability of assembly. These quick disconnects can be ordered from NEUTRIK USA, Inc. - use part# NL-FASTON. PCB vertical and horizontal terminations are also available as is a non-air-tight version for amplifier use. OEM specials are available, please contact Neutrik USA, Inc.

The contacts in this series are touch proof and designed to prevent damage from arcing if disconnected under load. Ensuring fail safe conditions for both the equipment and the operator. Speakon meets the prevailing safety standards of IEC65, IEC348, CE, CSA and are UL rated (file #E135070).

Speakon® is not to be used as a "main" (AC) connector.

Part drawings are available courtesy of www.Neutrik.com

ORDERING INFORMATION Speakon® Series			
Description	2 Pole	4 Pole	8 Pole
Cable connector, quicklock latch or ring	NL2FC	NL4FC	NL8FC
- w/ gold plated contact	NL2FC-B	NL4FC-B	N/A
Chassis connector, air tight, solder terminations	NL2MP	NL4MP	N/A
- w/ gold plated contact	NL2MP-B	NL4MP-B	N/A
Chassis connector, air tight, round flange, solder terminations	N/A	NL4MPR	NL8MPR
Vertical PCB-version, air tight, square flange	NL2DM-V	NL4MD-V	N/A

Vertical PCB-version, air tight, round flange	N/A	NL4MPR-V	NL8MD-V
Horizontal PCB-version, air tight	NL2MD-H	NL4MD-H*	N/A
Coupler for linking (extending) cables	N/A	NL4MM	NL8MM
Adapter to 1/4" 2 pole jack (6.3 mm) (Connects "1+" to Tip, "1-" to Sleeve of 1/4" Jack. Same dimensions as NL4FC)	N/A	NA4LJ	N/A

*Add "-NG" as suffix for non-air-tight applications.

Front side

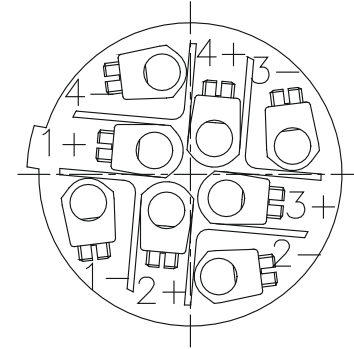
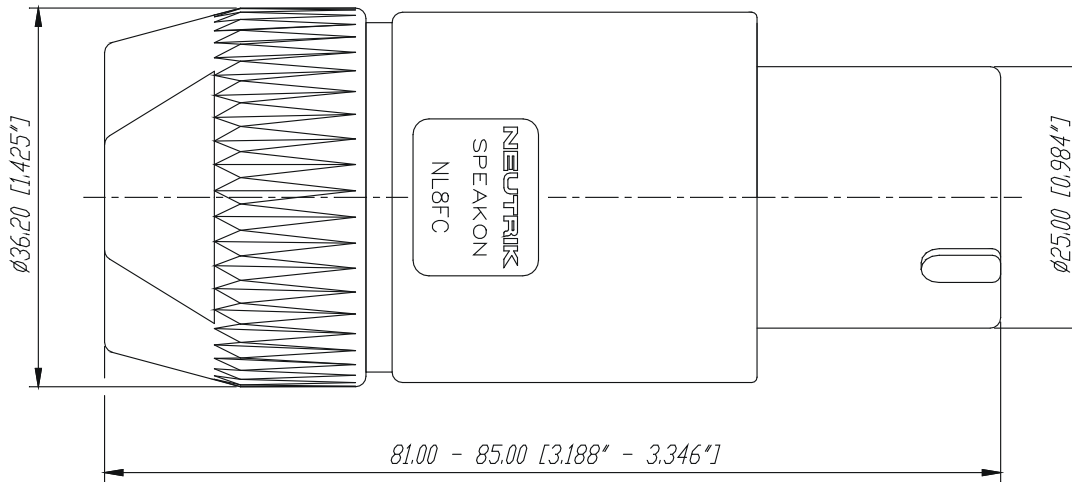

Rear side

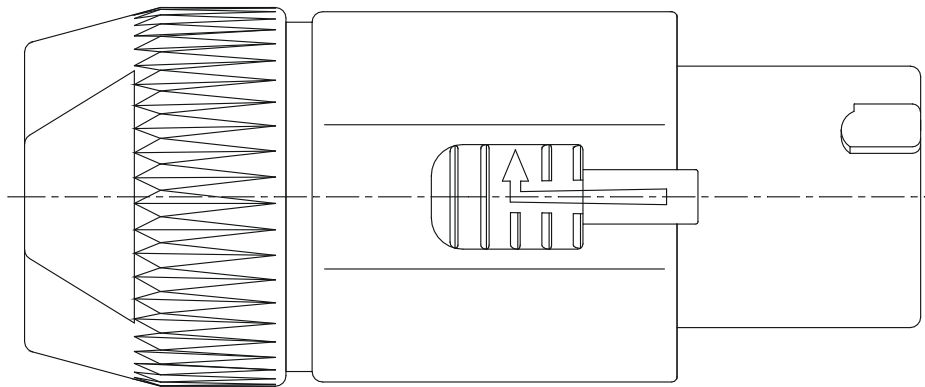

						Werkstoff:	Massstab:		Datum	Name
						*Lieferant darf ohne Ruecksprache nicht geaendert werden	2:1	Gezeichnet	29.06.89	Martinek
								Geprueft		
						Zeichnung urheberrechtlich geschuetzt (DIN 34) (C)		Gesehen		
						Benennung:	Speakon NL 8 FC		Ersetzt durch:	Blatt
								Ersatz fuer:		von Blatt
A	neue Verriegelung	19.05.95	Loretz							
Ind.	Aenderung	Datum	Name			NEUTRIK AG FL-9494 SCHAAN		Zeichn. Nr.	3102 St 05 04	

Specifications Speakon®	
UL-Recognized	
US. Pat. 5205749	
CSA listed UK. Path.: 2209635	
A. Pat.: 387871	
Electrical	
Number of contacts:	2,4, or 8
Rated current/contact:	40 A rms 1 min
	25 A rms continuous
Rated voltage	250 Vac
Contact resistance after 5000 insertion-withdrawal operations:	< 3 mΩ
Insulation resistance initial:	> 2·10 ⁸ Ω
Insulation resistance after damp heat test:	> 10 ⁸ mΩ
Inrush/outrush current capability:	12 V source: 300/30 A/200 m secs
Creepage distance:	according to IEC 664-1
Dielectric strength:	4240 V pp
Mechanical	
Wiring, Cable:	screw-type terminals or soldering
Max. wire size/contact:	4 mm ² / 12 AWG (stranded)
Wiring, Chassis:	- flat tabs for (FASTON®) 0.187 ¹¹ x 0.02 ¹¹ - (4.8mm x 0.; 5 mm) or soldering
	PCB-version: pins 1.6 mm x 0.5 mm
Cable OD range 2-pole:	6-10mm
Cable OD range 4-pole :	5-15mm white chuck: 6mm(.236") - 11mm(.433") black chuck: 9.5mm(.374") - 15mm(.59")
Cable OD range 8-pole :	8-20mm w/ reducing sleeve: 8mm(.315") - 15mm(.59") w/o reducing sleeve: 15mm(.59") - 20mm(.787")
Cable anchoring:	NEUTRIK® chuck principle
Cable retention force:	≥ 220 N, depending on cable diameter and material
Retention method:	Quicklock: with latch on 4-8 pole
	Quicklock: with locking ring on 2-pole
Environmental	
Temperature range:	-30°C to +80°C
Materials	
Housing:	PA 6 30% GR

Insert (FC part):	PBTB 20% GR
Chuck:	POM
Bushing:	PA 6 15% GR
Contact:	Cable: CuZn39Pb3
	Receptacle: CuSn8, 4 µm Ag plated
Securing lever:	ZnAl4Cu1, CuNi plated
Spring element:	Neoprene

Part drawings are available courtesy of www.Neutrik.com. For additional drawings, please contact NeutrikUSA.

Speakon® is not to be used as a "main" (AC) connector.

Positive signal on speaker pin "+" produces positive waveform from driver (moves cone outwardly).

"+" - In phase (high), "-" = Ground, out of phase (low)

Lower numbers for lower frequencies.

Speakon® Series - Wiring			
	Amplifier	Cable	Speaker
Stereo ("HiFi")	One NL4MP socket	NL4FC on amplifier end, four conductor cable splits into two pairs with NL4FC on each end.	One NL4MP per speaker
	left channel pins 1+/1-		left speaker pins 1+/1-
	right channel pins 2+/2-		right speaker pins 2+/2-
POWER ("PA") standard	Three NL4MP socket	A two-conductor cable for each channel with NL4FC on both ends.	NL4MP pin 1+ to speaker coil"+"
	"A" left channel pins 1+/1-		NL4MP pins 1- and 2+ to speaker coil"-"
	"B" right channel pins 1+/1-		
Bridged Mono	"M" socket	A special two-conductor cable for on both ends wired to pins 1+/2+ of NL4FC.	NL4MP pin 1+ to speaker coil"+"
	left channel pins 1+/1-		NL4MP pins 1- and 2+ to speaker coil"-"
	right channel pins 2+/2-		
Bi-Amp	One NL4MP socket	A four-conductor cable on both ends wired to pins 1+/1-, 2+/2- of NL4FC	One NL4MP socket
	low frequency pins 1+/1-		low frequency pins 1+/1-
	high frequency pins 2+/2-		high frequency pins 2+/2-

Schematics are available courtesy of www.Neutrik.com.

For additional drawings, please contact NeutrikUSA.