

**PRODUCT NUMBER**  
98424-XX2-XX-XXXXL

- PLATING \_\_\_\_\_ ROHS COMPATIBLE, SEE NOTE 8  
 S = 0.38µm GOLD/GXT ON CONTACT AREA 2µm MIN MATTE TIN ON TAIL  
 G = 0.76µm GOLD/GXT ON CONTACT AREA 2µm MIN MATTE TIN ON TAIL  
 F = GOLD FLASH ON CONTACT AREA 2µm MIN MATTE TIN ON TAIL  
 T = 2.0-6.0µm FULL MATTE TIN  
 1.27µm NI MIN UNDERLAYER

- NOTES:  
 1. MATERIAL HOUSING: HIGH TEMP. THERMOPLASTIC UL-94V0  
 - STANDARD COLOR CREAM  
 B = OPTIONAL COLOR BLACK  
 2. MATERIAL TERMINAL: COPPER ALLOY  
 3. TO DETERMINE DIMENSIONS:  
 N = NUMBER OF POSITIONS PER ROW  
 4. 7N MIN. PIN RETENTION IN EITHER DIRECTION.  
 5. PACKAGING:  
 - STANDARD PACKAGING IN POLYBAGS  
 - POLYBAGS PACKAGING WHEN POLARISATION FEATURE APPLICABLE  
 U = TUBE AVAILABLE FROM 08 TO 50 POS  
 A = TAPE AND REEL WITH PICK UP CAP, AS AVAILABLE  
 K = TAPE AND REEL WITHOUT PICK UP CAP, AS AVAILABLE  
 C = TAPE AND REEL WITH SPECIAL LARGE CAP, ONLY FOR 98424-Y52-06CLF FOR ALL SPECIAL PACKAGING. FCI TO BE CONTACTED  
 UV = TUBE WITHOUT PICK UP CAP FOR CUSTOMER DEDICATED PART  
 AV = TAPE & REEL WITH PICK UP CAP FOR CUSTOMER DEDICATED PART  
 KV = TAPE & REEL WITHOUT PICK UP CAP FOR CUSTOMER DEDICATED PART

6. DIM "C" = (N x 2) + 1.4  
 EXAMPLE: N = 7  
 DIM "C" = (7 x 2) + 1.4 = 15.4 mm  
 7. FOR POLARIZATION, SPECIFIED PIN EXAMPLE : A03 = ROW A, POSITION 03 TO OMIT PIN OMIT FROM PRODUCT NUMBER IF THIS FEATURE IS NOT APPLICABLE  
 8. ROHS COMPATIBLE PRODUCT SPECIFICATIONS

- a - PLATING:  
 - "L" MEANS THE PRODUCT IS LEAD-FREE, 2µm MINIMUM MATTE TIN OVER 1.27µm MINIMUM NICKEL UNDERPLATE.  
 b - MANUFACTURING PROCESS COMPATIBILITY  
 - THE HOUSING WILL WITHSTAND EXPOSURE TO 260°C PEAK TEMPERATURE FOR 30 SECONDS MAX IN A CONVECTION, INFRA-RED OR VAPOR PHASE OR REFLOW OVEN.  
 c - LABELLING:  
 - MEETS PACKAGING SPECS AS PER GS-14-920  
 d - THIS PRODUCT MEETS EUROPEAN DIRECTIVES AND OTHER COUNTRY REGULATIONS AS DISCRIBED IN GS-47-0004.

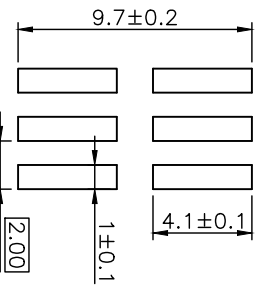
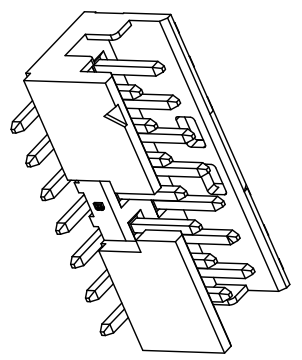
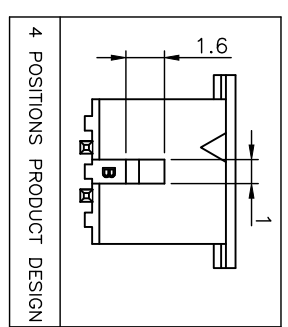
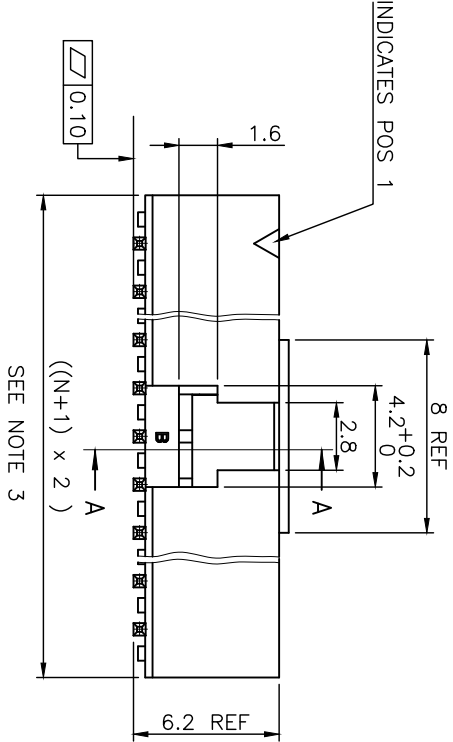
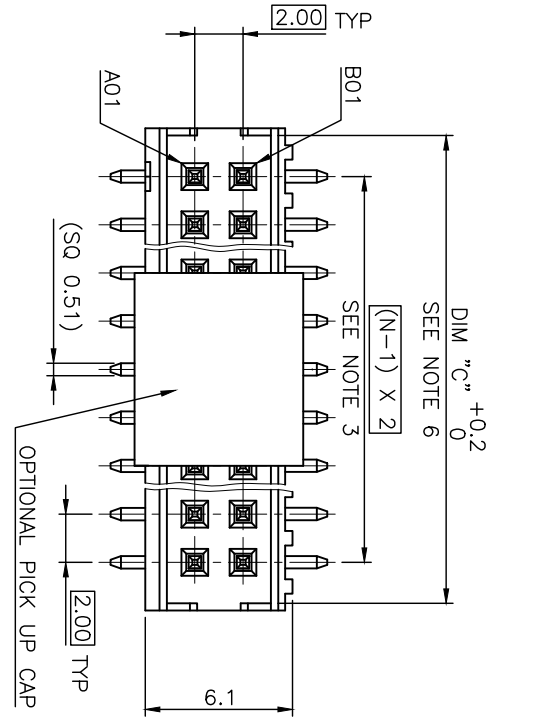

mat'l. code	surface	tolerance	projection	product family
SEE NOTES	ISO 1302	ISO 406 ISO	101	MINITEK
ISO 1302	tolerances unless otherwise specified		mm	title
dr	date	linear	scale 1:1	SHR HEADER
JCA	17.02.27	X.X		2.00 VERTICAL SMT
DDE	20.01.24	X.XX ±0.13		sheet no
		X.XXX ±0.05		98424
				sheet 1 of 2
L.MULIN	14.10.24			CUSTOMER Drawing
engr	14.12.16			size
J.COMPAGNON	04.09.27			A3
chr				
JMC	04.09.27			
revision				
X				
B				
sheet				
1				
2				
index				
sheet				
1				
2				

