

linear/swivel clamp CLR-12-10-L-P-A

Part number: 535432

FESTO

Clamping system with linear and swivel motion, 90° to the left

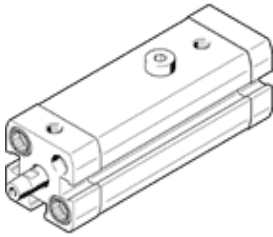

Data sheet

Feature	Value
Total stroke	19 mm
Piston diameter	12 mm
Piston rod thread	M3
Swivel angle	90 deg +/- 4 deg
Clamping stroke	10 mm
Cushioning	P: Flexible cushioning rings/plates at both ends
Assembly position	Any
Design structure	Piston Piston rod Cylinder barrel
Position detection	For proximity sensor
Swivel direction	Left
Operating pressure	2 ... 10 bar
Mode of operation	double-acting
Operating medium	Compressed air in accordance with ISO8573-1:2010 [7:4:4]
Note on operating and pilot medium	Lubricated operation possible (subsequently required for further operation)
Corrosion resistance classification CRC	2 - Moderate corrosion stress
Ambient temperature	-10 ... 80 °C
Effective clamping force at 2 bar	12 N
Effective clamping force at 4 bar	23 N
Effective clamping force at 6 bar	34 N
Max. tightening torque, tensioning finger screw	1.2 Nm
Theoretical clamping force at 6 bar	51 N
Product weight	135 g
Mounting type	Optional with through hole with internal (female) thread with accessories
Pneumatic connection	M5
Material of flange screw	Steel Galvanised
Material cover	Wrought Aluminium alloy coated
Material seals	NBR TPE-U(PU)
Material housing	Wrought Aluminium alloy Smooth anodised
Material piston rod	High alloy steel, non-corrosive
Material cylinder barrel	Wrought Aluminium alloy Smooth anodised