

This document is the property of Amphenol Corporation and is intended for use only in the manufacture of parts for Amphenol Corporation. It is not to be used for any other purpose. All rights are reserved. No part of this document may be reproduced or transmitted in any form or by any means, electronic or mechanical, including photocopying, recording, or by any information storage and retrieval system, without the prior written permission of Amphenol Corporation.

CUSTOMER DRAWING

REVISIONS		DATE	APPROVED
1	***	2021/03/07	Michael

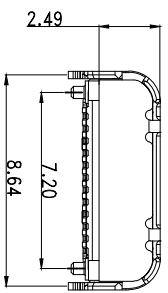
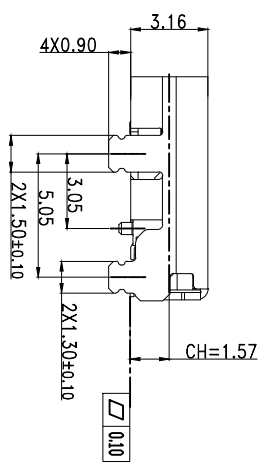
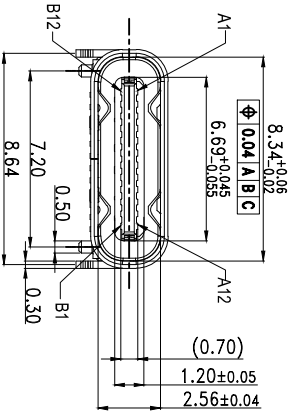
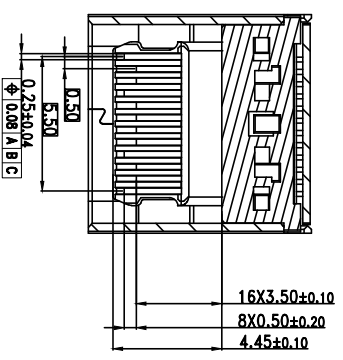
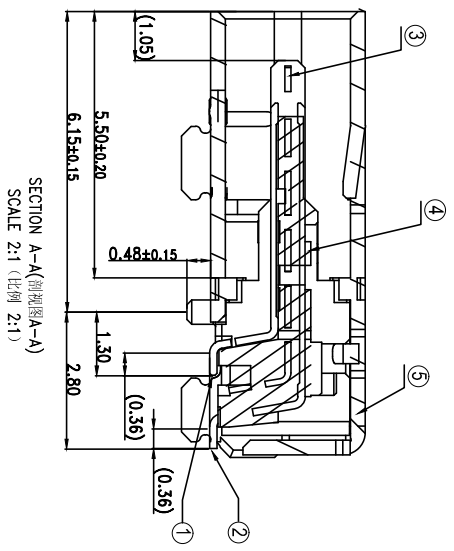
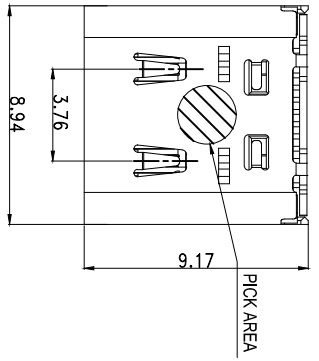

Pin 定义:

A1	A2	A3	A4	A5	A6	A7	A8	A9	A10	A11	A12
GND	TX1+	TX1-	VBUS	CC1	D+	D-	SBU1	VBUS	RX2-	TX2+	GND
B12	B11	B10	B9	B8	B7	B6	B5	B4	B3	B2	B1

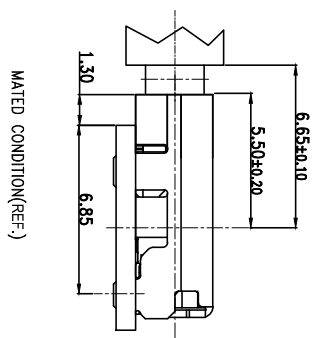
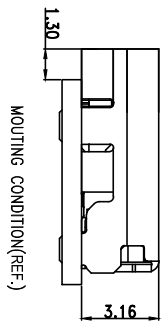
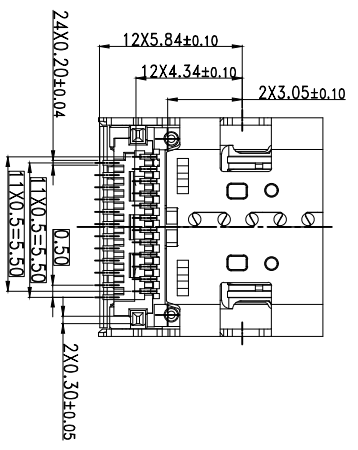

ITEM	DESCRIPTION	QTY	MATERIAL	REMARK
1	TOP TERMINAL	1	COPPER ALLOY	MATING SIDE: GOLD FLASH; 300° NICKEL OVERALL.
2	BOTTOM TERMINAL	1	COPPER ALLOY	SOLDER HALFCOLD FLASH; 300° NICKEL OVERALL.
3	IND PLATE	1	STAINLESS STEEL	
4	MAIN HOUSING	1	STAINLESS STEEL	
5	INT SHELL	1	NICKEL PLATING	

UNLESS OTHERWISE SPECIFIED	TOLERANCES	U.S.	METRIC	APPROVAL	DATE
XX	±0.00		0.00	DRIVER	19/07/20
XX	±0.10		0.10	ORDERED	19/07/20
XX	±0.10		0.10	MECHANICAL	

FRACTURES	REMOVE SHARP EDGES	DRAWING FILE :	ANGLE OF PROJECTION	TITLE
XX	XX	XXXX	XX	Customer Drawing For
XX	XX	XXXX	XX	Amphenol East Asia Limited

UNLESS OTHERWISE SPECIFIED	TOLERANCES	U.S.	METRIC	APPROVAL	DATE
XX	±0.00		0.00	DRIVER	19/07/20
XX	±0.10		0.10	ORDERED	19/07/20
XX	±0.10		0.10	MECHANICAL	

UNLESS OTHERWISE SPECIFIED	TOLERANCES	U.S.	METRIC	APPROVAL	DATE
XX	±0.00		0.00	DRIVER	19/07/20
XX	±0.10		0.10	ORDERED	19/07/20
XX	±0.10		0.10	MECHANICAL	

UNLESS OTHERWISE SPECIFIED	TOLERANCES	U.S.	METRIC	APPROVAL	DATE
XX	±0.00		0.00	DRIVER	19/07/20
XX	±0.10		0.10	ORDERED	19/07/20
XX	±0.10		0.10	MECHANICAL	

UNLESS OTHERWISE SPECIFIED	TOLERANCES	U.S.	METRIC	APPROVAL	DATE
XX	±0.00		0.00	DRIVER	19/07/20
XX	±0.10		0.10	ORDERED	19/07/20
XX	±0.10		0.10	MECHANICAL	

UNLESS OTHERWISE SPECIFIED	TOLERANCES	U.S.	METRIC	APPROVAL	DATE
XX	±0.00		0.00	DRIVER	19/07/20
XX	±0.10		0.10	ORDERED	19/07/20
XX	±0.10		0.10	MECHANICAL	

UNLESS OTHERWISE SPECIFIED	TOLERANCES	U.S.	METRIC	APPROVAL	DATE
XX	±0.00		0.00	DRIVER	19/07/20
XX	±0.10		0.10	ORDERED	19/07/20
XX	±0.10		0.10	MECHANICAL	

UNLESS OTHERWISE SPECIFIED	TOLERANCES	U.S.	METRIC	APPROVAL	DATE
XX	±0.00		0.00	DRIVER	19/07/20
XX	±0.10		0.10	ORDERED	19/07/20
XX	±0.10		0.10	MECHANICAL	

UNLESS OTHERWISE SPECIFIED	TOLERANCES	U.S.	METRIC	APPROVAL	DATE
XX	±0.00		0.00	DRIVER	19/07/20
XX	±0.10		0.10	ORDERED	19/07/20
XX	±0.10		0.10	MECHANICAL	

UNLESS OTHERWISE SPECIFIED	TOLERANCES	U.S.	METRIC	APPROVAL	DATE
XX	±0.00		0.00	DRIVER	19/07/20
XX	±0.10		0.10	ORDERED	19/07/20
XX	±0.10		0.10	MECHANICAL	

UNLESS OTHERWISE SPECIFIED	TOLERANCES	U.S.	METRIC	APPROVAL	DATE
XX	±0.00		0.00	DRIVER	19/07/20
XX	±0.10		0.10	ORDERED	19/07/20
XX	±0.10		0.10	MECHANICAL	

UNLESS OTHERWISE SPECIFIED	TOLERANCES	U.S.	METRIC	APPROVAL	DATE
XX	±0.00		0.00	DRIVER	19/07/20
XX	±0.10		0.10	ORDERED	19/07/20
XX	±0.10		0.10	MECHANICAL	

UNLESS OTHERWISE SPECIFIED	TOLERANCES	U.S.	METRIC	APPROVAL	DATE
XX	±0.00		0.00	DRIVER	19/07/20
XX	±0.10		0.10	ORDERED	19/07/20
XX	±0.10		0.10	MECHANICAL	

UNLESS OTHERWISE SPECIFIED	TOLERANCES	U.S.	METRIC	APPROVAL	DATE
XX	±0.00		0.00	DRIVER	19/07/20
XX	±0.10		0.10	ORDERED	19/07/20
XX	±0.10		0.10	MECHANICAL	

UNLESS OTHERWISE SPECIFIED	TOLERANCES	U.S.	METRIC	APPROVAL	DATE
XX	±0.00		0.00	DRIVER	19/07/20
XX	±0.10		0.10	ORDERED	19/07/20
XX	±0.10		0.10	MECHANICAL	

UNLESS OTHERWISE SPECIFIED	TOLERANCES	U.S.	METRIC	APPROVAL	DATE
XX	±0.00		0.00	DRIVER	19/07/20
XX	±0.10		0.10	ORDERED	19/07/20
XX	±0.10		0.10	MECHANICAL	

UNLESS OTHERWISE SPECIFIED	TOLERANCES	U.S.	METRIC	APPROVAL	DATE
XX	±0.00		0.00	DRIVER	19/07/20
XX	±0.10		0.10	ORDERED	19/07/20
XX	±0.10		0.10	MECHANICAL	

UNLESS OTHERWISE SPECIFIED	TOLERANCES	U.S.	METRIC	APPROVAL	DATE
XX	±0.00		0.00	DRIVER	19/07/20
XX	±0.10		0.10	ORDERED	19/07/20
XX	±0.10		0.10	MECHANICAL	

UNLESS OTHERWISE SPECIFIED	TOLERANCES	U.S.	METRIC	APPROVAL	DATE
XX	±0.00		0.00	DRIVER	19/07/20
XX	±0.10		0.10	ORDERED	19/07/20
XX	±0.10		0.10	MECHANICAL	

UNLESS OTHERWISE SPECIFIED	TOLERANCES	U.S.	METRIC	APPROVAL	DATE
XX	±0.00		0.00	DRIVER	19/07/20
XX	±0.10		0.10	ORDERED	19/07/20
XX	±0.10		0.10	MECHANICAL	

UNLESS OTHERWISE SPECIFIED	TOLERANCES	U.S.	METRIC	APPROVAL	DATE
XX	±0.00		0.00	DRIVER	19/07/20
XX	±0.10		0.10	ORDERED	19/07/20
XX	±0.10		0.10	MECHANICAL	

UNLESS OTHERWISE SPECIFIED	TOLERANCES	U.S.	METRIC	APPROVAL	DATE
XX	±0.00		0.00	DRIVER	19/07/20
XX	±0.10		0.10	ORDERED	19/07/20
XX	±0.10		0.10	MECHANICAL	

UNLESS OTHERWISE SPECIFIED	TOLERANCES	U.S.	METRIC	APPROVAL	DATE
XX	±0.00		0.00	DRIVER	19/07/20
XX	±0.10		0.10	ORDERED	19/07/20
XX	±0.10		0.10	MECHANICAL	

UNLESS OTHERWISE SPECIFIED	TOLERANCES	U.S.	METRIC	APPROVAL	DATE
XX	±0.00		0.00	DRIVER	19/07/20
XX	±0.10		0.10	ORDERED	19/07/20
XX	±0.10		0.10	MECHANICAL	

UNLESS OTHERWISE SPECIFIED	TOLERANCES	U.S.	METRIC	APPROVAL	DATE
XX	±0.00		0.00	DRIVER	19/07/20
XX	±0.10		0.10	ORDERED	19/07/20
XX	±0.10		0.10	MECHANICAL	

UNLESS OTHERWISE SPECIFIED	TOLERANCES	U.S.	METRIC	APPROVAL	DATE
XX	±0.00		0.00	DRIVER	19/07/20
XX	±0.10		0.10	ORDERED	19/07/20
XX	±0.10		0.10	MECHANICAL	

UNLESS OTHERWISE SPECIFIED	TOLERANCES	U.S.	METRIC	APPROVAL	DATE
XX	±0.00		0.00	DRIVER	19/07/20
XX	±0.10		0.10	ORDERED	19/07/20
XX	±0.10		0.10	MECHANICAL	

UNLESS OTHERWISE SPECIFIED	TOLERANCES	U.S.	METRIC	APPROVAL	DATE
XX	±0.00		0.00	DRIVER	19/07/20
XX	±0.10		0.10	ORDERED	19/07/20
XX	±0.10		0.10	MECHANICAL	

UNLESS OTHERWISE SPECIFIED	TOLERANCES	U.S.	METRIC	APPROVAL	DATE
XX	±0.00		0.00	DRIVER	19/07/20
XX	±0.10		0.10	ORDERED	19/07/20
XX	±0.10		0.10	MECHANICAL	

UNLESS OTHERWISE SPECIFIED	TOLERANCES	U.S.	METRIC	APPROVAL	DATE
XX	±0.00		0.00	DRIVER	19/07/20
XX	±0.10		0.10	ORDERED	19/07/20
XX	±0.10		0.10	MECHANICAL	

UNLESS OTHERWISE SPECIFIED	TOLERANCES	U.S.	METRIC	APPROVAL	DATE
XX	±0.00		0.00	DRIVER	19/07/20
XX	±0.10		0.10	ORDERED	19/07/20
XX	±0.10		0.10	MECHANICAL	

UNLESS OTHERWISE SPECIFIED	TOLERANCES	U.S.	METRIC	APPROVAL	DATE
XX	±0.00		0.00	DRIVER	19/07/20
XX	±0.10		0.10	ORDERED	19/07/20
XX	±0.10		0.10	MECHANICAL	

UNLESS OTHERWISE SPECIFIED	TOLERANCES	U.S.	METRIC	APPROVAL	DATE
XX	±0.00		0.00	DRIVER	19/07/20
XX	±0.10		0.10	ORDERED	19/07/20
XX	±0.10		0.10	MECHANICAL	

UNLESS OTHERWISE SPECIFIED	TOLERANCES	U.S.	METRIC	APPROVAL	DATE
XX	±0.00		0.00	DRIVER	19/07/20
XX	±0.10		0.10	ORDERED	19/07/20
XX	±0.10		0.10	MECHANICAL	

UNLESS OTHERWISE SPECIFIED	TOLERANCES	U.S.	METRIC	APPROVAL	DATE
XX	±0.00		0.00	DRIVER	19/07/20
XX	±0.10		0.10	ORDERED	19/07/20
XX	±0.10		0.10	MECHANICAL	

This document is the property of Amphenol Corporation and is intended for use only for the specific product and quantity identified. It is not to be used for any other product or quantity without the prior consent of Amphenol Corporation. Amphenol Corporation reserves the right to modify this drawing without notice. All dimensions are in millimeters unless otherwise specified. All tolerances are as shown.

CUSTOMER DRAWING

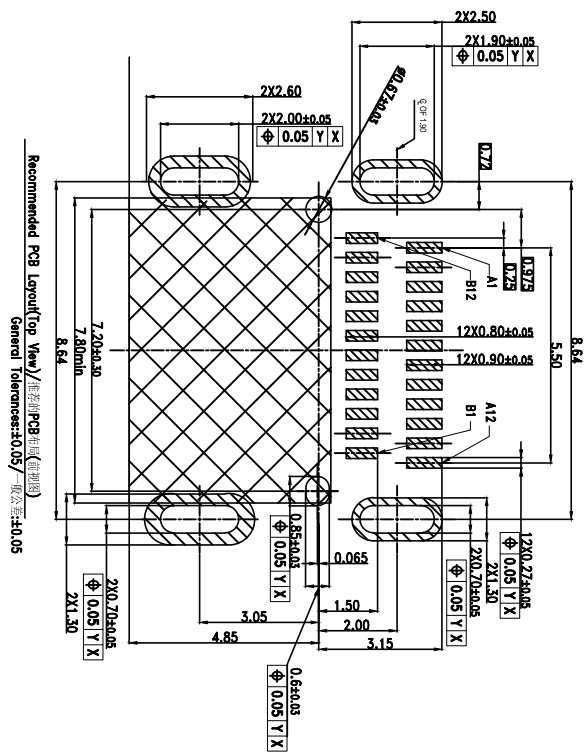

Recommended PCB Layout (Top View) / 推荐PCB布局 (顶部视图)
General Tolerances: ±0.05 / 一般公差: ±0.05

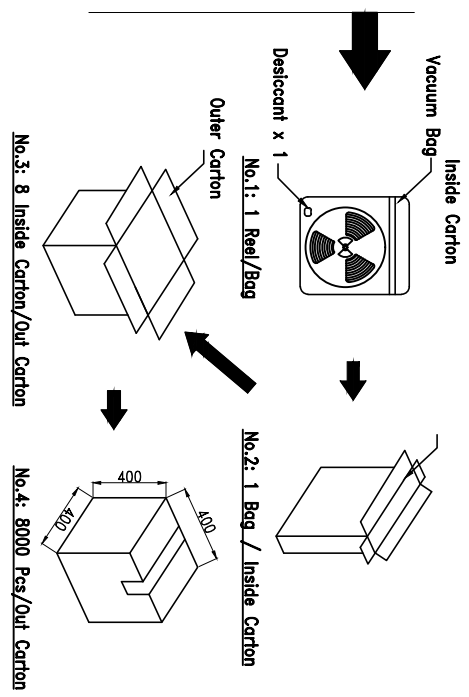
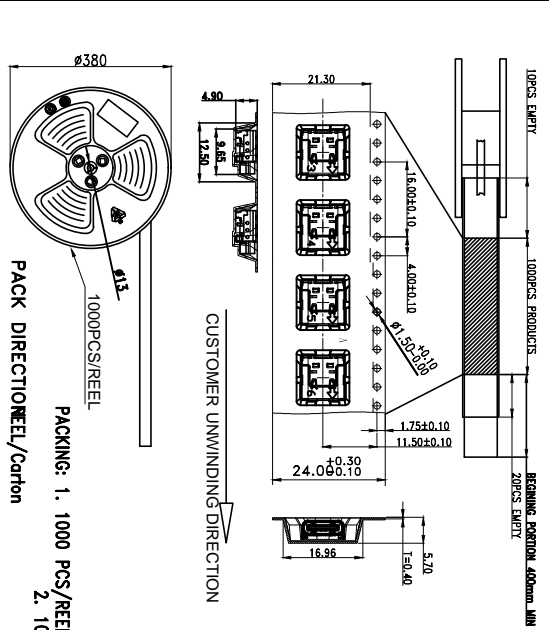

NOTES/注意:

- MATERIAL/材料: SEE TABLE/见下表
- GENERAL SPECIFICATION/通用特性:
2.1 COPPLANARITY / 共面度: 0.10 Max.
2.2 CURRENT RATING: 5A / 额定电流: 5安培
2.3 CONTACT RESISTANCE: 40mΩ MAX (INITIAL).
2.4 DIELECTRIC WITHSTANDING VOLTAGE: 100 VAC
接触电压: 40毫欧最大(初始值) / 绝缘电压: 100V AC
- MECHANICAL CHARACTERISTICS:
2.5 MECHANICAL CHARACTERISTICS:
INSERTION FORCE: 5~20N EXTRACTION FORCE: 6~20N
力学特性: 插接入力: 5~20N 拔出力: 6~20N
耐久后拔出力: 6~20N
- DURABILITY: 10000 CYCLES / 耐久性: 10000次
2.6 DURABILITY: 10000 CYCLES / 耐久性: 10000次
- PACKAGING TYPE: CARRIER TAPE / 包装类型: 载带包装
2.7 PACKAGING TYPE: CARRIER TAPE / 包装类型: 载带包装
尺寸标准基于 ASME Y14.5M 1994标准规范
MATERIAL SHOULD BE FILLED AMPHENOL SPEC.# S-SN-002.
FOR HALOGEN FREE PRODUCTS, ALSO NEED TO MEET S-SN-004.
产品材料环保标准符合 Amphenol S-SN#002, 如果无卤产品需满足标准 S-SN#004
ORDER P/N SYSTEM/产品料号系统: 12402076512A

Plating Spec: Au 30µm Min
Epl. Metal Area: Au 30µm Min
Solder Area: Gold Finish
Solder Min Nickel Under Plating Over All
Package Spec: AHF
Z:reel
Date Code Description
1:with D/C

REV	ECN	DESCRIPTION	REVISIONS	DATE	APPROVED
			SEE PAGE 1		



UNITS/公差		TOLERANCES		APPROVAL		DATE		TITLE	
MILITARY	METRIC	U.S.	METRIC	DRAWN	FAKMA	09/19/20		Amphenol	Amphenol East Asia Limited
ASME	ISO	ASME	ISO	CHECKED	Madhuchan	09/19/20		Customer Drawing For	Customer Drawing For
REMOVE SHARP EDGES								12402076	12402076
DIMENSIONS								SCALE	SHEET 2 OF 2