

**PLEASE CHECK WWW.MOLEX.COM FOR LATEST PART INFORMATION**

**Part Number:** [48405-0003](#)  
**Status:** **Active**  
**Overview:** Consumer USB Products  
**Description:** Universal Serial Bus (USB 3.0) I/O Receptacle, Right-Angle, Type A, High-Temperature Blue Nylon, 15µ' Gold (Au) Plating, Height 3.91mm, Contact Height 1.45mm

**Documents:**

[3D Model](#) [Test Summary TS-48405-001 \(PDF\)](#)  
[Drawing \(PDF\)](#) [RoHS Certificate of Compliance \(PDF\)](#)  
[Product Specification PS-48405-001 \(PDF\)](#)

**General**

Product Family	I/O Connectors
Series	<a href="#">48405</a>
Application	Wire-to-Board
Component Type	Receptacle
Overview	<u>Consumer USB Products</u>
Product Name	USB 3.0
Type	A
UPC	887191519142

**Physical**

Circuits (Loaded)	9
Color - Resin	Blue
Durability (mating cycles max)	5,000
Gender	Female
Keying to Mating Part	Yes
Lock to Mating Part	No
Material - Metal	Copper Alloy
Material - Plating Mating	Nickel, Tin
Material - Plating Termination	Gold
Material - Resin	High Temperature Thermoplastic
Net Weight	2.420/g
Number of Rows	2
Orientation	Right Angle
PC Tail Length	2.80mm
PCB Locator	Yes
PCB Retention	Yes
Packaging Type	Tray
Panel Mount	No
Pitch - Mating Interface	2.00mm, 2.50mm
Pitch - Termination Interface	2.00mm, 2.50mm
Polarized to Mating Part	Yes
Polarized to PCB	Yes
Ports	1
Temperature Range - Operating	-20°C to +85°C
Termination Interface: Style	Through Hole

**Electrical**

Current - Maximum per Contact	1.8A
Grounding to Panel	Yes
Voltage - Maximum	30V AC/DC

**Material Info**

**Reference - Drawing Numbers**

Product Specification	PS-48405-001
-----------------------	--------------

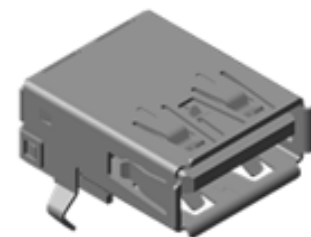

*image - Reference only*

*Series*

**EU RoHS**

**ELV and RoHS  
Compliant**

**REACH SVHC**

**Contains SVHC: No  
Low-Halogen Status  
Low-Halogen**

**China RoHS**



**Need more information on product  
environmental compliance?**

Email [productcompliance@molex.com](mailto:productcompliance@molex.com)  
 For a multiple part number RoHS Certificate of Compliance, [click here](#)

Please visit the [Contact Us](#) section for any non-product compliance questions.

**Search Parts in this Series**

48405Series

**Mates With**

USB 3.0 Type A Plug

This document was generated on 12/17/2014

**PLEASE CHECK [WWW.MOLEX.COM](http://WWW.MOLEX.COM) FOR LATEST PART INFORMATION**