

Customer Information Sheet

DRAWING No.: M30-600XX46

SHEET 2 OF 2

IF IN DOUBT - ASK

©

NOT TO SCALE

THIRD ANGLE PROJECTION

ALL DIMENSIONS IN mm

SPECIFICATIONS:

MATERIAL:
 MOULDING - POLYAMIDE 46 NATURAL, UL94V-0
 CONTACT - BRASS
 RETAINER - PHOSPHOR BRONZE

FINISH:
 CONTACT & RETAINER - 100% TIN

ELECTRICAL:
 RATED CURRENT - 1A AC/DC
 RATED VOLTAGE - 150V AC/DC
 DIELECTRIC STRENGTH - 500V AC
 INSULATION RESISTANCE - 1000 MEGOHMS MIN
 DIELECTRIC WITHSTANDING VOLTAGE - 500V AC

ENVIRONMENTAL:
 TEMPERATURE RANGE - -55°C TO +85°C

PACKING: TUBE

FOR COMPLETE SPECIFICATIONS,
 SEE COMPONENT SPECIFICATION
 C025XX (LATEST ISSUE)

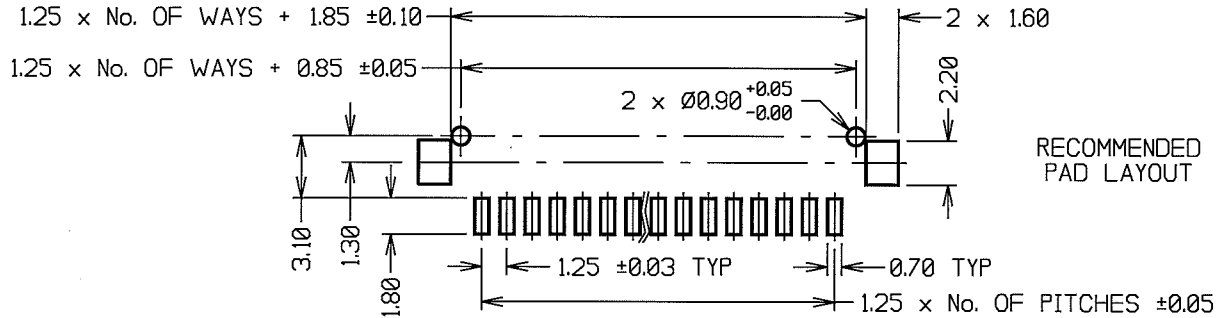

RECOMMENDED
PAD LAYOUT

NOTES:

1. ALL TOLERANCES ARE ±0.30 UNLESS OTHERWISE STATED.
2. MATES WITH M30-1000046 CRIMP CONTACTS AND M30-110XX00 CRIMP MOULDING.
3. COPLANARITY OF CONTACTS AND RETAINER. TO BE 0.1mm MAX.

ORDER CODE:
M30-600XX46

No. OF WAYS: _____
 02 TO 15

FINISH: _____
 46 = 100% TIN

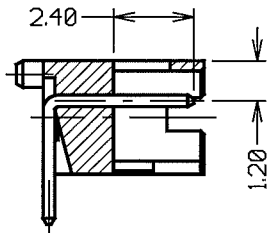

SECTION A-A

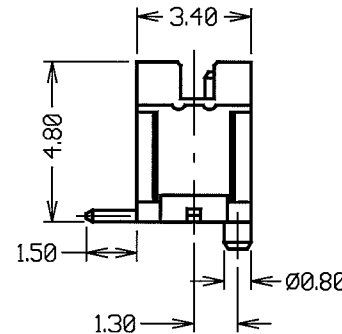
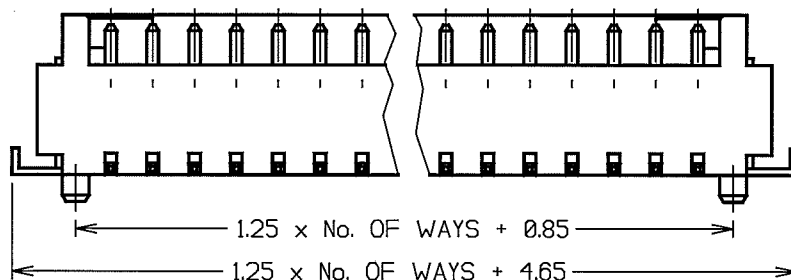
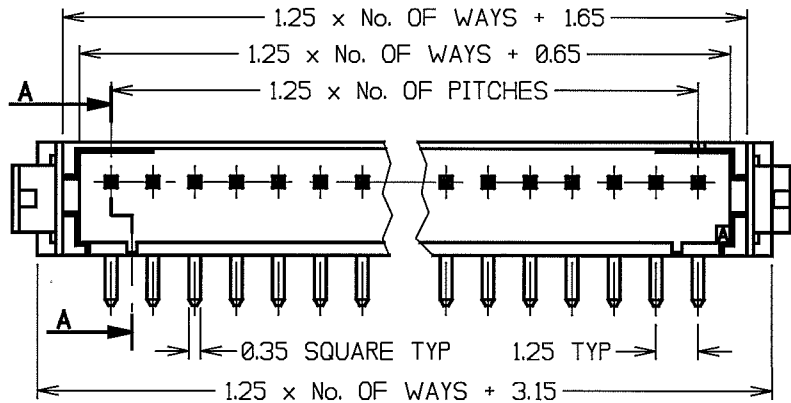

| | | | |
|------------------------------|------|----------|--------|
| RA | 8 | 20.01.09 | 10265 |
| NAME | ISS. | DATE | C/NOTE |
| APPROVED: <i>[Signature]</i> | | | |
| CHECKED: <i>[Signature]</i> | | | |
| DRAWN: W. J. BOURNE | | | |
| CUSTOMER REF: | | | |
| ASSEMBLY DRG: | | | |

HARWIN

| | | |
|--|--|--|
| HARWIN USA TEL: 603 893 5376 FAX: 603 893 5396 mis@harwin.com | HARWIN Europe (UK) TEL: 023 9231 4545 FAX: 023 9231 4590 mis@harwin.co.uk | HARWIN Asia TEL: +65 6 779 4909 FAX: +65 6 779 3868 mis@harwin.com.sg |
|--|--|--|

THIS DRAWING AND ANY INFORMATION OR DESCRIPTIVE MATTER SET OUT HEREON ARE CONFIDENTIAL AND COPYRIGHT PROPERTY OF THE HARWIN GROUP AND MUST NOT BE DISCLOSED, LOANED, COPIED OR USED FOR MANUFACTURING, TENDERING OR FOR ANY OTHER PURPOSE WITHOUT THEIR WRITTEN PERMISSION.

TOLERANCES

X. = ±1mm
 X.X = ±0.25mm
 X.XX = ±0.10mm
 X.XXX = ±0.01mm
 ANGLES = ±5°
 UNLESS STATED

MATERIAL:
SEE ABOVE

FINISH:
SEE ABOVE

S/AREA: mm²

TITLE:
1.25mm PITCH SIL
SMT BOARD MOUNT CONNECTOR

DRAWING NUMBER:
M30-600XX46

SHT 2 OF 2