

## R1-4B

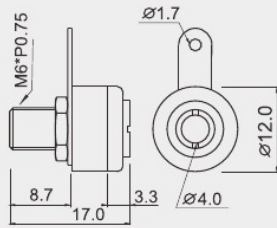

$\pm 0.1$  0.5~3.0mm

10A

DC500V 100M $\Omega$

AC 1000V 1minute

-20°C~+80°C

### FEATURES:

- Material:  
Insulation: nylon(UL flame: 94V-2).  
Metal: nickel plated brass.
- $\varnothing 4.0$ mm(0.160") banana socket.

### CUT-OUT

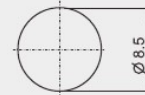

# Mouser Electronics

Authorized Distributor

Click to View Pricing, Inventory, Delivery & Lifecycle Information:

[Shin Chin:](#)

[R1-04B-R](#)