

**RoHS
Compliant
Drawing For
Reference Only**

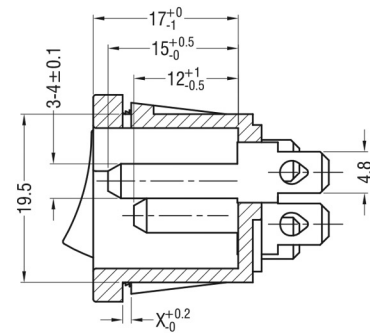

SECTION: A-A

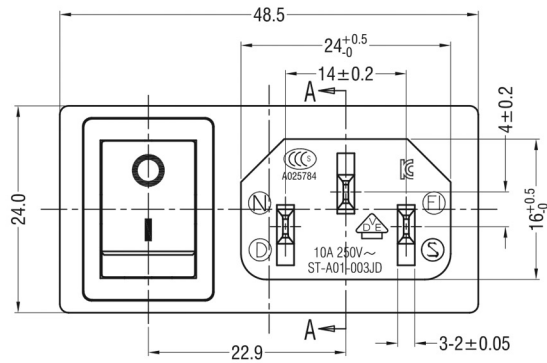
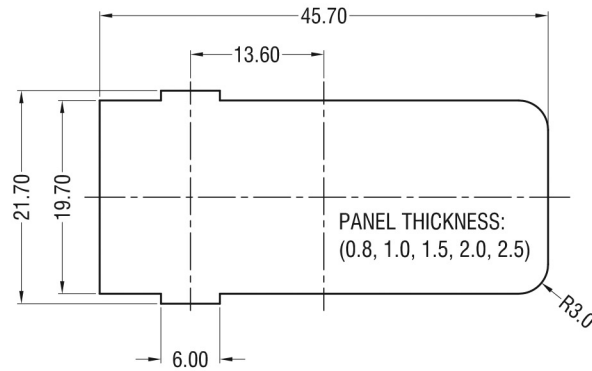
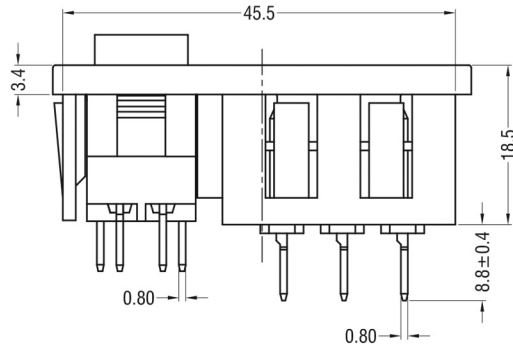

PANEL CUT-OUT

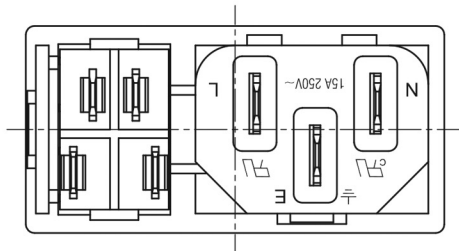

SPEC:

A. Material:

- 1.Housing: PA66
- 2.Terminal: COPPER ALLOY, TIN PLATED

B.Electrical Characteristics:

- 1.Rating: 15A 250V~ (UL,CUL)
10A 250V~(CCC,VDE,SEMKO,NEMKO,FIMKO,DEMKO,KC)
- 2.Electric Strength: AC 2,000 V FOR ONE MINUTE
- 3.Insulation Resistance: 100MΩ MIN, AT 500V DC

C.Approvals:

- UL, CUL, CCC, VDE, SEMKO, NEMKO, FIMKO, DEMKO, KC

Technical requirement :

1. This product should meet EU RoHS related requirement.
2. The surface of plastic part should be without any crackle such as burr,lack,and so on phenomenon.
3. The surface of metal part should be without any defect such as scour,nick,oxidation and plating problem.
4. The electronic performance should be the same as spec.

Common Tolerance	
DIMENSION:	ANGLE:
0.0 ±0.3	±3°
0.00 ±0.20	
0.000 ±0.100	

DCI DRAGON CITY INDUSTRIES LIMITED

Item Name	AC SOCKET	Tolerance :	Design	K.W Law	Remark	Scale
Item No.	AS-216-EN	Unit : mm	Drawing	W.K Yeung	Remark	Material
			Check	K.L Wong	Remark	Drawing No. A503261600
			Approval	K.W Chan	Remark	Sheet