

Board Level Cooling – High Power Extruded 5320



BOARD LEVEL COOLING – High Power Extruded 5320

High Power Extruded 5320 is a series of dual radial board level heat sinks designed to cool TO-220 and TO-220-single gauge devices. Representative image only.

ORDERING INFORMATION

Part Number	Device Type
532602B00000G	TO-220
532602B02500G	TO-220, TO-220-single gauge
532702B02500G	TO-220, TO-220-single gauge
532802B00000G	TO-220, TO-220-single gauge
532802B02500G	TO-220, TO-220-single gauge



HEAT SINK DETAILS

Property	Details
Material	Aluminum
Finish	Black Anodize
Device Attachment Options	Requires Mounting Kit
Thermal Interface Material	-

Property	Details
Heat Sink Width (mm)	41.91
Heat Sink Length (mm)	25.40
Heat Sink Height (mm)	See "H" Dim below
Heat Sink Mounting Direction	Vertical

MECHANICAL & PERFORMANCE

Drawing dimensions are shown in mm, (in)

Part Number	"H" Dim	"X" Dim	"Y" Dim	"Z" Dim
532602B00000G	38.10	12.70 (0.50)	0.79 (0.031)	2.67 (0.105)
532602B02500G	38.10	12.70 (0.50)	-	2.67 (0.105)
532702B02500G	50.80	12.65 (0.498)	-	2.67 (0.105)
532802B00000G	63.50	12.70 (0.50)	0.79 (0.031)	2.67 (0.105)
532802B02500G	63.50	12.70 (0.50)	-	2.67 (0.105)

Part Numbers: 532602B00000G and 532802B00000G

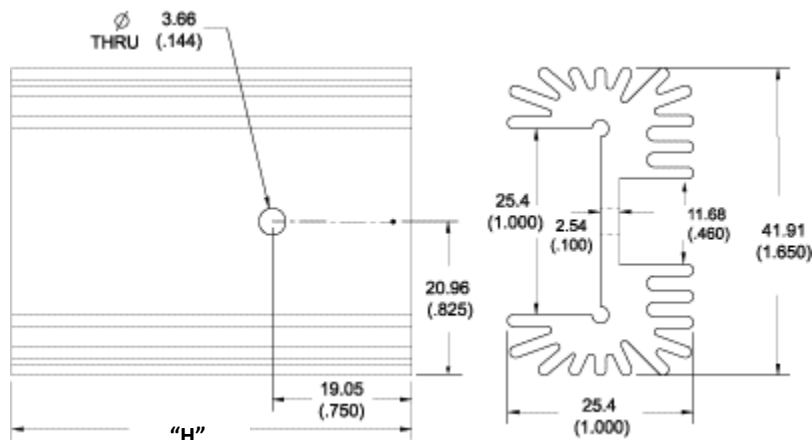

Board Level Cooling – High Power Extruded 5320

Part Numbers: 532602B02500G,
532702B02500G, 532802B02500G

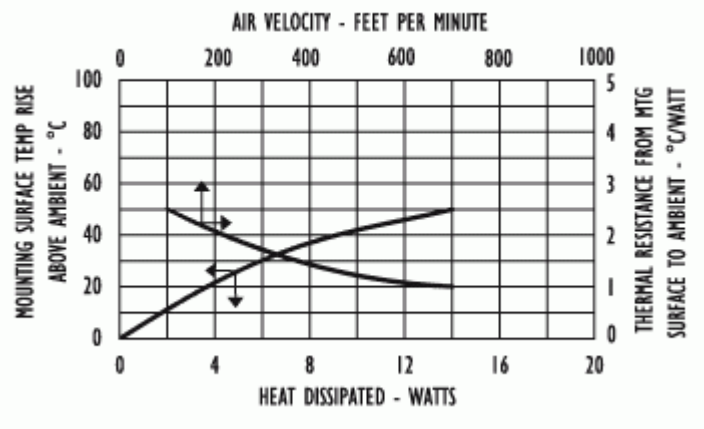
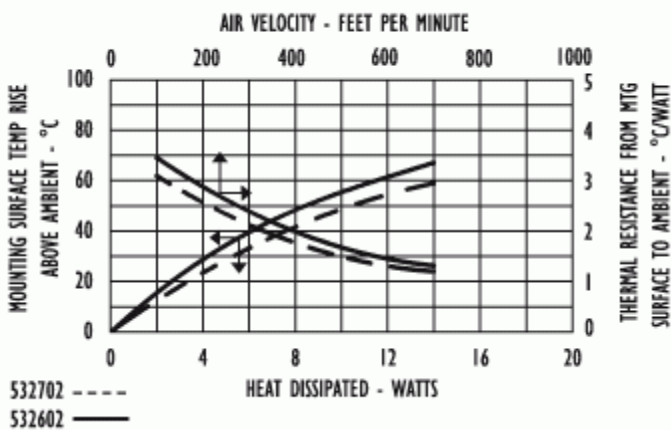
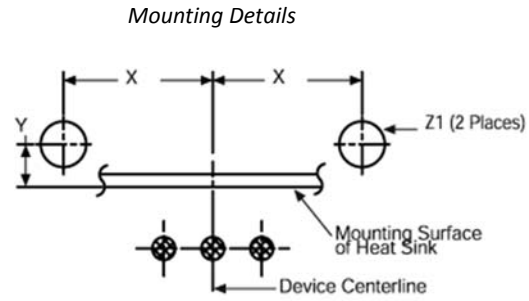
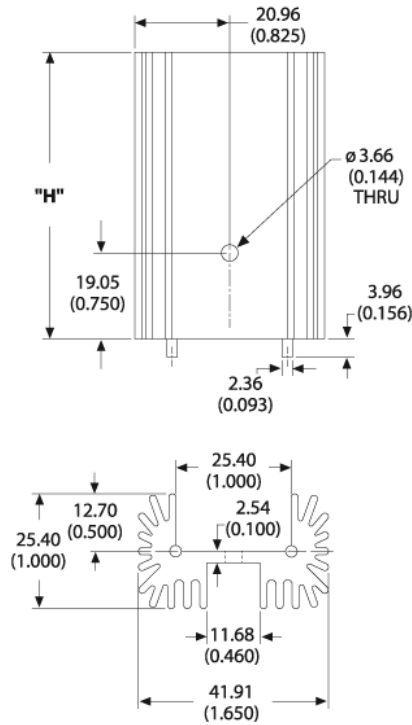

Mouser Electronics

Authorized Distributor

Click to View Pricing, Inventory, Delivery & Lifecycle Information:

[Aavid:](#)

[532702B02500G](#) [532602B02500G](#) [532802B02500G](#) [532602B00000G](#)