



BOARD LEVEL COOLING – Channel 5040

Channel 5040 is a series of narrow channel board level heat sinks designed to cool TO-220 devices. Representative image only.

ORDERING INFORMATION

Part Number	Device Type
504102B00000G	TO-220
504202B00000G	TO-220

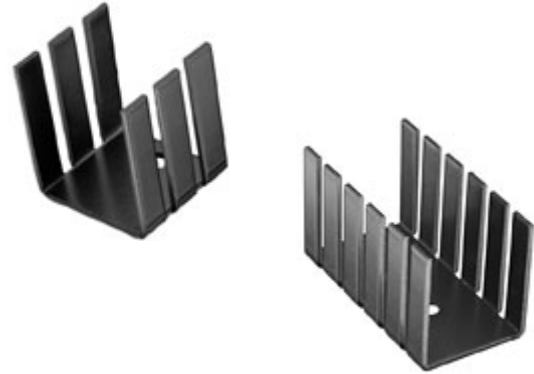

HEAT SINK DETAILS

Property	Details
Material	Aluminum
Finish	Black Anodize
Device Attachment Options	Requires Mounting Kit
Thermal Interface Material	-

Property	Details
Heat Sink Width (mm)	19.80
Heat Sink Length (mm)	21.59
Heat Sink Height (mm)	See "H" Dim below
Heat Sink Mounting Direction	Vertical, Horizontal

MECHANICAL & PERFORMANCE

Drawing dimensions are shown in mm, (in)

Part Number	"H" Dim
504102B00000G	17.80
504202B00000G	36.83

Part Number: 504102B00000G

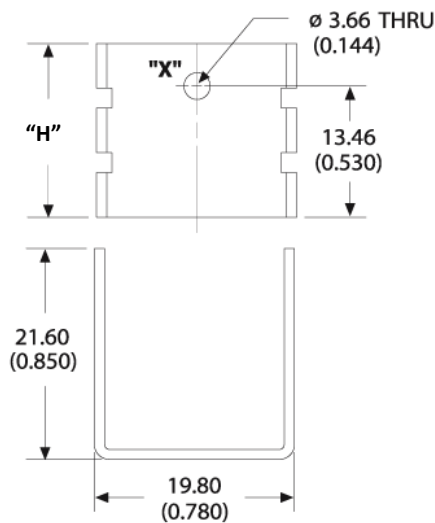

Part Number: 504202B00000G

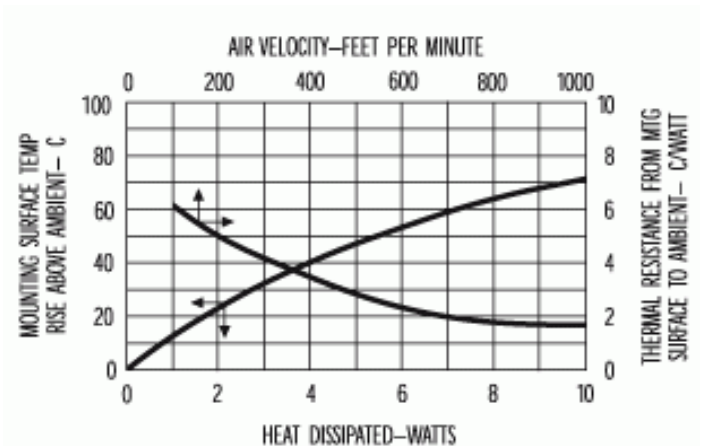
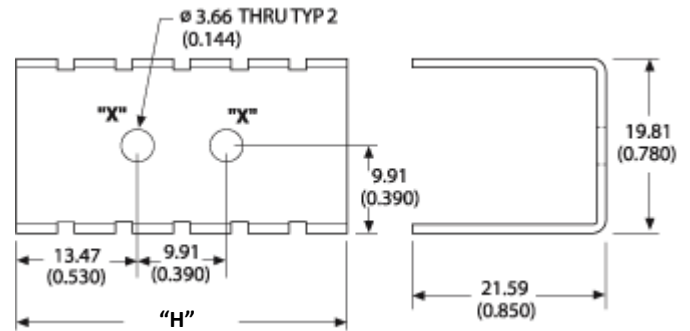

Mouser Electronics

Authorized Distributor

Click to View Pricing, Inventory, Delivery & Lifecycle Information:

[Aavid:](#)

[504222B00000G](#) [504102B00000G](#)