

THIS COPY IS PROVIDED ON A RESTRICTED BASIS AND IS NOT TO BE USED IN ANY WAY DETRIMENTAL TO THE INTERESTS OF PANDUIT CORP.

| PANDUIT PART # | WIRE SIZE AWG [mm <sup>2</sup> ] | COLOR  | DIMENSIONS in. [mm] |              |
|----------------|----------------------------------|--------|---------------------|--------------|
|                |                                  |        | L± .03 [0,8]        | B± .01 [0,3] |
| ESV18BX        | #22-18 [0,5-1,0]                 | RED    | 1.03 [26,2]         | .17 [4,3]    |
| ESV14BX        | #16-14 [1,5-2,5]                 | BLUE   | 1.04 [26,4]         | .20 [5,1]    |
| ESV10BX        | #12-10 [4,0-6,0]                 | YELLOW | 1.18 [30,0]         | .25 [6,4]    |

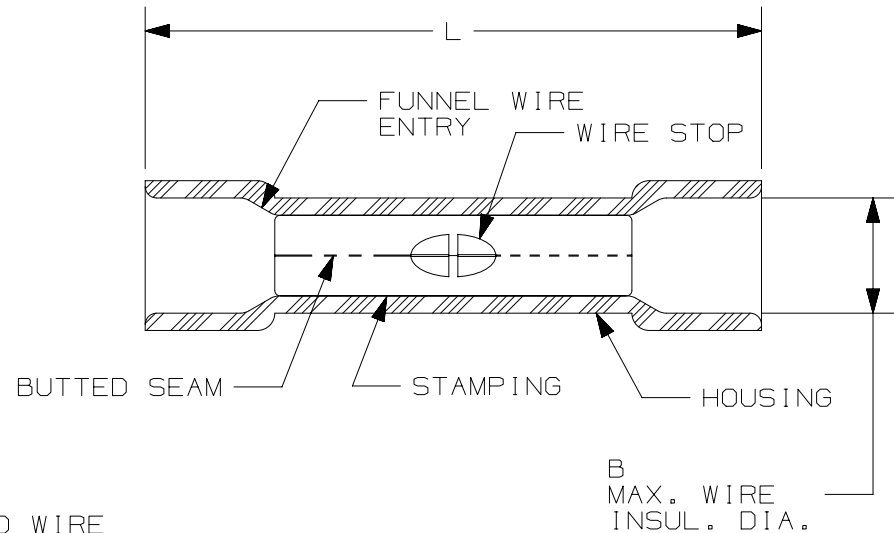

NOTES:

- USED FOR:
  - A. SOLID OR STRANDED COPPER WIRE
  - B. 221°F [105°C] MAX OPERATING TEMPERATURE
  - C. 600V MAX VOLTGE RATING
  - D. ESV10BX 300V MAX VOLTAGE RATING WITH 10 AWG SOLID WIRE
- INSTALLATION TOOLS: CT-100A, CT-160, CT-260, CT-1550, CT-1551, CT-600A (CT-550CH), CT-2500 (CT-2550CH)
  - A. #22-18 AWG [0,5-1,0 mm<sup>2</sup>]: CT-100A, CT-160, CT-260, CT-400, CT-600A (CT-550CH), CT-2500 (CT-2550CH)
  - B. #16-14 AWG [1,5-2,5 mm<sup>2</sup>]: CT-100A, CT-160, CT-260, CT-400, CT-460, CT-600-A, CT-2500
  - C. #12-10 [4,0-6,0 mm<sup>2</sup>] STRANDED AND #12 AWG SOLID COPPER WIRE WITH CT-1550 & CT-1551 TOOLS: CT-100A, CT-160, CT-260, CT-460, CT-600-A (CT-550CH), CT-2500 (CT-2550CH)
- WIRE STRIP LENGTH: 5/16" <sup>+1/32</sup>/<sub>-0</sub> [7,9mm <sup>+0,8</sup>/<sub>-0</sub>]
- MATERIAL:
  - A. STAMPING (#22-18 & #16-14): .03" [0,8] THK COPPER, TIN PLATED
  - B. STAMPING (#12-10): .04" [1,0] THK COPPER, TIN PLATED
  - C. HOUSING: VINYL
- SEE [www.panduit.com](http://www.panduit.com) FOR PACKAGE QUANTITIES INDICATED BY PART NUMBER SUFFIX
- DIMENSIONS IN BRACKETS ARE METRIC EQUIVALENT



LISTED  
587H  
E52164



CERTIFIED  
LR31212

|                                                                                                   |                 |                               |             |
|---------------------------------------------------------------------------------------------------|-----------------|-------------------------------|-------------|
| TITLE<br><b>STRONGHOLD BUTT SPLICE, EXPANDED DIAMETER VINYL INSULATED, BUTTED SEAM #22-10 AWG</b> |                 | CUSTOMER DRAWING              |             |
| ITEM REVISION NAME                                                                                |                 | 00123SHC/00                   |             |
| DATASET FILE NAME                                                                                 |                 | 00123SHC_DC/00A               |             |
| UNLESS OTHERWISE SPECIFIED, DIMENSIONAL TOLERANCES ARE: IN [mm]                                   |                 | MATERIAL:<br><b>SEE NOTES</b> |             |
| .x ± .1 [2.54]      .xxx ± .005 [0.127]                                                           |                 | DRAWING NUMBER:<br>SH41181    |             |
| .xx ± .01 [0.25]      ANGLES ± 5°                                                                 |                 | THIRD ANGLE PROJECTION        |             |
|                                                                                                   | DRAWN BY<br>TMR | DATE<br>10.10.17              | CHK<br>JHNU |
| SCALE<br>N.T.S.                                                                                   | SHT 1 OF 1      |                               | SIZE<br>A   |

| REV | DATE     | BY  | CHK  | APR | DESCRIPTION      | ECN     |
|-----|----------|-----|------|-----|------------------|---------|
| 00  | 10.10.17 | TMR | JHNU | RGB | DRAWING RELEASED | 00123SH |

D10100DA/15

# Mouser Electronics

Authorized Distributor

Click to View Pricing, Inventory, Delivery & Lifecycle Information:

[Panduit:](#)

[ESV10BX-Q](#) [ESV14BX-L](#) [ESV14BX-Q](#) [ESV18BX-Q](#) [ESV18BX-L](#)