

# Customer Information Sheet

DRAWING No.: M20-789XXXX

SHEET 2 OF 2

IF IN DOUBT - ASK

©

NOT TO SCALE

THIRD ANGLE PROJECTION

ALL DIMENSIONS IN mm

**SPECIFICATION:**

**MATERIAL:**  
 MOULDING = PA6T UL94V-0, BLACK  
 CONTACTS = PHOSPHOR BRONZE  
**FINISH (OVER NICKEL):**  
 42 = GOLD FLASH ON CONTACT AREA,  
 2.54µ 100% TIN ON TAILS  
 46 = 2.54µ 100% TIN  
**ELECTRICAL:**  
 CURRENT RATING = 3A  
 VOLTAGE PROOF = 500V AC FOR ONE MINUTE  
 CONTACT RESISTANCE = 20mΩ MAX  
 INSULATION RESISTANCE = 1,000MΩ MIN.  
**MECHANICAL:**  
 DURABILITY = 300 CYCLES MIN (GOLD),  
 50 CYCLES MIN (TIN)  
 INSERTION FORCE = 2.0N MAX PER PIN  
 WITHDRAWAL FORCE = 0.5N MIN PER PIN  
**ENVIRONMENTAL:**  
 TEMPERATURE RANGE = -40° TO +105°  
**PACKING:**  
 TUBE  
 FOR COMPLETE SPECIFICATION SEE COMPONENT  
 SPECIFICATION C001XX (LATEST ISSUE)

**PART SECTION X-X**

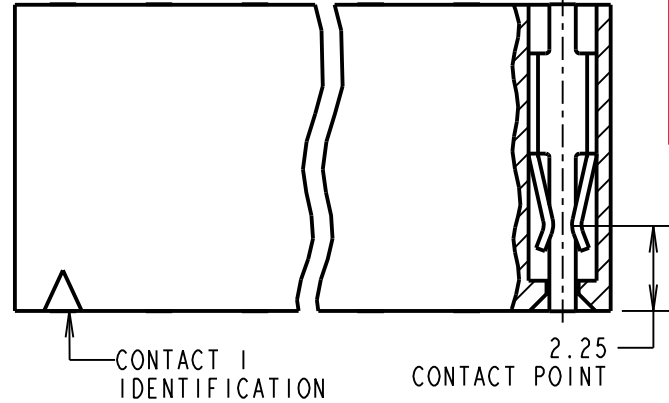

**OBSOLETE**  
 All other size/  
 finish  
 combinations not  
 listed

**ORDER CODE: M20-789XXXX**  
 No. OF CONTACTS: \_\_\_\_\_  
 02 TO 20, 25, 36, 40  
**FINISH:** \_\_\_\_\_  
 42 = SELECTIVE GOLD + 100% TIN  
 46 = 100% TIN

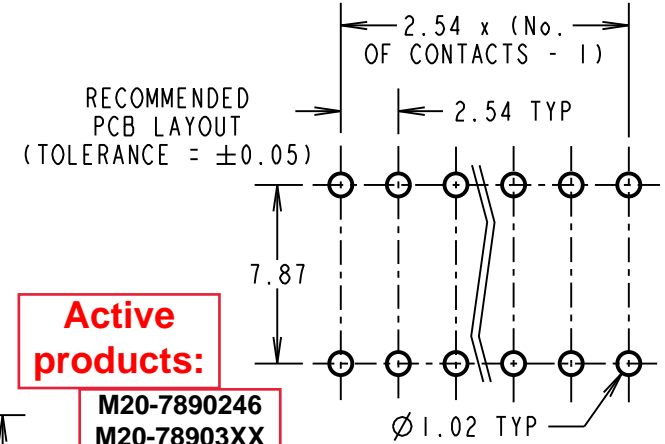

**Active products:**  
 M20-7890246  
 M20-78903XX  
 M20-78904XX  
 M20-78905XX  
 M20-78906XX  
 M20-78908XX  
 M20-7891046  
 M20-7891442  
 M20-7892046  
 M20-7893646

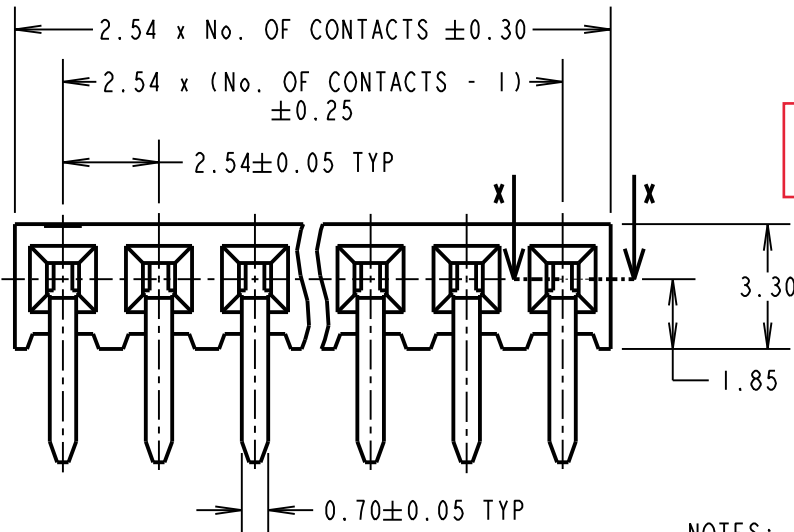
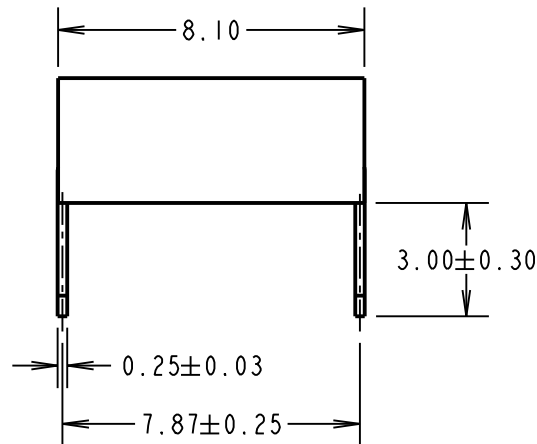

**NOTES:**  
 1. ALL TOLERANCES ARE ±0.15  
 UNLESS OTHERWISE STATED.

WJP	14	01.08.17	20398
NAME	ISS.	DATE	C/NOTE
APPROVED: W. J. PRESTON			
CHECKED: S. BENNETT			
DRAWN: J. EVANS			
CUSTOMER REF.:			
ASSEMBLY DRG:			

**HARWIN**

www.harwin.com  
 technical@harwin.com

THIS DRAWING AND ANY  
 INFORMATION OR DESCRIPTIVE  
 MATTER SET OUT HEREON ARE  
 CONFIDENTIAL AND COPYRIGHT  
 PROPERTY OF THE HARWIN  
 GROUP AND MUST NOT BE  
 DISCLOSED, LOANED, COPIED  
 OR USED FOR MANUFACTURING,  
 TENDERING OR FOR ANY  
 OTHER PURPOSE WITHOUT  
 THEIR WRITTEN PERMISSION.

**TOLERANCES**  
~~X = ±1mm~~  
~~X.X = ±0.50mm~~  
~~X.XX = ±0.10mm~~  
~~X.XXX = ±0.01mm~~  
 ANGLES = ±5°  
 UNLESS STATED

**MATERIAL:**  
 SEE ABOVE  
**FINISH:**  
 SEE ABOVE  
**S/AREA:**  
 mm<sup>2</sup>

**TITLE:**  
 2.54mm PITCH SIL PC TAIL  
 HORIZONTAL SOCKET ASSEMBLY  
**DRAWING NUMBER:**  
 M20-789XXXX  
 SHT  
 2 OF 2

# Mouser Electronics

Authorized Distributor

Click to View Pricing, Inventory, Delivery & Lifecycle Information:

## Harwin:

[M20-7893542](#) [M20-7893546](#) [M20-7893342](#) [M20-7893346](#) [M20-7893746](#) [M20-7893742](#) [M20-7892246](#) [M20-7892242](#) [M20-7892642](#) [M20-7892646](#) [M20-7892446](#) [M20-7892442](#) [M20-7892046](#) [M20-7892042](#) [M20-7892846](#) [M20-7892842](#) [M20-7892742](#) [M20-7892746](#) [M20-7891042](#) [M20-7891046](#) [M20-7890642](#) [M20-7890646](#) [M20-7891846](#) [M20-7891842](#) [M20-7890242](#) [M20-7890246](#) [M20-7891446](#) [M20-7891442](#) [M20-7890842](#) [M20-7890846](#) [M20-7891242](#) [M20-7891246](#) [M20-7891646](#) [M20-7891642](#) [M20-7890442](#) [M20-7890446](#) [M20-7890342](#) [M20-7890346](#) [M20-7891546](#) [M20-7891542](#) [M20-7891946](#) [M20-7891942](#) [M20-7890746](#) [M20-7890742](#) [M20-7892346](#) [M20-7892342](#) [M20-7891142](#) [M20-7891146](#) [M20-7892146](#) [M20-7892142](#) [M20-7892942](#) [M20-7892946](#) [M20-7891746](#) [M20-7891742](#) [M20-7890542](#) [M20-7890546](#) [M20-7892542](#) [M20-7892546](#) [M20-7891346](#) [M20-7891342](#) [M20-7890942](#) [M20-7890946](#) [M20-7893442](#) [M20-7893446](#) [M20-7893842](#) [M20-7893846](#) [M20-7893046](#) [M20-7893042](#) [M20-7894042](#) [M20-7894046](#) [M20-7893646](#) [M20-7893642](#) [M20-7893242](#) [M20-7893246](#) [M20-7893942](#) [M20-7893946](#) [M20-7893142](#) [M20-7893146](#)