

PRODUCT NO
SEE TABLE

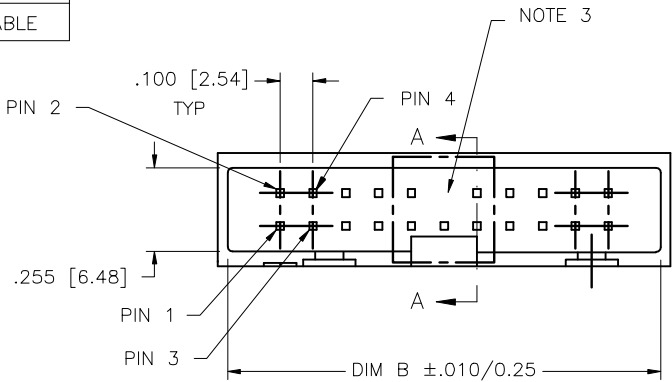

Ø.006/0.15 M X

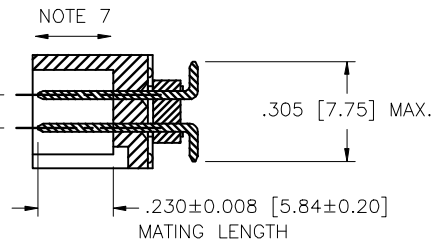

SECTION A-A

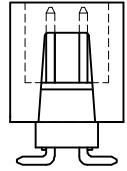
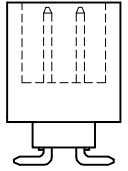
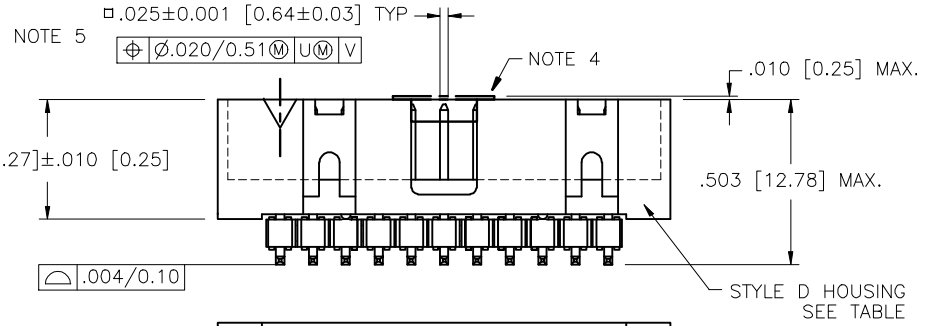

w/WINDOW OPTION
SEE TABLE

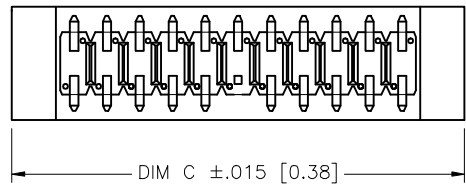

DRAWN WITHOUT WINDOW OPTION

mat'l. code SEE NOTES 1 & 2				surface ISO 1302	tolerance ISO 406 ISO 1101	projection ISO 1002	product family BERGSTIK
ltr	ecp no	dr	date	tolerances unless otherwise specified		INCH/MM	title
Y	v03-0476	DAI	6/17/03	angles	.XX±.01/XX±0.3	scale 1:1	BERGSTIK® II HDR. D/R SLIMLINE SMT ASSEMBLY
AA	M05-0086	ERE	9/28/05	linear	.XXX±.006/XXX±0.13		
AB	M06-0269	MNR	7/17/06	0°±2'	.XXX±.0020/XXX±0.051		
AC	M06-0356	MNR	9/08/06	dr	E. KROPWIENICK 8/21/96	dwg no	sheet 1 of 4 size
AD	M08-0108	MHT	4/17/08	engr	L. FYE 8/21/96	72454	A3
AE	M08-0230	MHT	8/14/08	chr	T. BREWBAKER 8/21/96	type Product Customer Drawing	
AF	M08-0291	MHT	10/08/08	appd	T. BREWBAKER 8/21/96		
sheet	revision	AF	AF	AF	AF		
index	sheet	1	2	3	4		



Copyright FCI

PRODUCT NO	PLATING CODE	CONTACT AREA PLATING	SOLDER TAIL PLATING
SEE TABLE	AA	30u"/.76u AU OVER 50u"/1.27u Ni	100u"/2.54u TIN OVER 50u"/1.27u Ni
	4	100u"/3.05u Sn OVER 50u"/1.27u Ni	100u"/3.05u Sn OVER 50u"/1.27u Ni

LEAD FREE PLATING	AA	30u"/.76u AU OVER 50u"/1.27u Ni	100u"/2.54u TIN OVER 50u"/1.27u Ni
	4	100u"/3.05u Sn OVER 50u"/1.27u Ni	100u"/3.05u Sn OVER 50u"/1.27u Ni

NOTE 11

NOTES:

1. BODY MATERIAL: PCT, GLASS FIBER REINFORCED, FLAME RETARDANT PER UL-94V-0.
COLOR: BLACK OR
MINERAL FILLED LCP, FLAME RETARDANT PER UL-94V-0 BLACK
2. PIN MATERIAL: PHOS-BRONZE.
3. PINS DELETED FROM SPECIFIED LOCATIONS FOR POLARIZATION. SEE TABLE FOR LOCATIONS.
4. PACKAGING OPTIONS: CHECK SPECIFIC PART NUMBERS FOR AVAILABILITY. PART NUMBERS WITHOUT A SUFFIX ARE PACKAGED IN TRAYS. PART NUMBERS FOLLOWED BY A "V" SUFFIX ARE PACKAGED TAPE-ON-REEL WITH A PICK-UP CAP INSTALLED. VACUUM CAP TO BE CENTRALLY LOCATED REGARDLESS OF NUMBER OF POSITIONS. PART NUMBERS FOLLOWED BY A "B" SUFFIX ARE ASSEMBLED WITH VACUUM PICK-UP CAPS INSTALLED AND PACKAGED IN TRAYS
5. MEASURED WITH PART IN RESTRAINED CONDITION.
6. TWO SIDES OF PIN TIPS NOT PLATED. TYPICAL BOTH ENDS (SIMPLEX PLATING ONLY).
7. 2 LBS/0.9KG MIN PIN RETENTION IN EITHER DIRECTION.
8. ADD "LF" SUFFIX AT THE END OF PART NUMBER FOR LEAD FREE OPTION.
9. THIS PRODUCT MEETS EUROPEAN UNION DIRECTIVES AND OTHER COUNTRY REGULATION AS DESCRIBED IN GS-22-008.
10. THE HOUSING WILL WITHSTAND EXPOSURE TO 260°C PEAK TEMPERATURE FOR 10-20 SECONDS IN A CONVECTION, INFRA-RED OR VAPOR PHASE REFLOW OVEN. SEE APPLICATION NOTES/PROCEDURES IF THEY ARE AVAILABLE.
11. "THIS PRODUCT HAS 100% TIN PLATING IN THE INTERFACE AND HAS NOT BEEN TESTED FOR WHISKER GROWTH IN ALL INTERCONNECT ENVIRONMENTS."

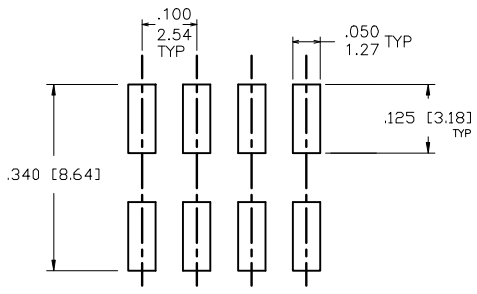

RECOMMENDED PAD LAYOUT
SCALE 4/1

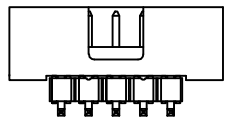

5 POSITION
2 X 5, STYLE A

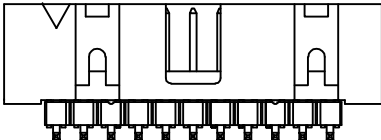

2 x 8 AND LARGER, STYLE D

mat'l. code		surface	tolerance	projection	product family
ISO 1302		ISO 406	ISO 1101		BERGSTIK
title		tolerances unless otherwise specified			title
AF		linear	.XX±.01/XX±0.3	INCH/MM	BERGSTIK® II HDR. D/R
		angles	.XXX±.006/XXX±0.13	scale 1:1	SLIMLINE SMT ASSEMBLY
		0'±2'	.XXX±.0020/XXX±0.051		dwg no
dr		E. KROPWIENICK 8/21/96			sheet 2 of 4 size
engr		L. FYE 8/21/96			72454 A3
chr		T. BREWBAKER 8/21/96			type
appd		T. BREWBAKER 8/21/96			Product Customer Drawing
sheet	revision				
index	sheet				

FCI
FCIconnect.com
Copyright FCI

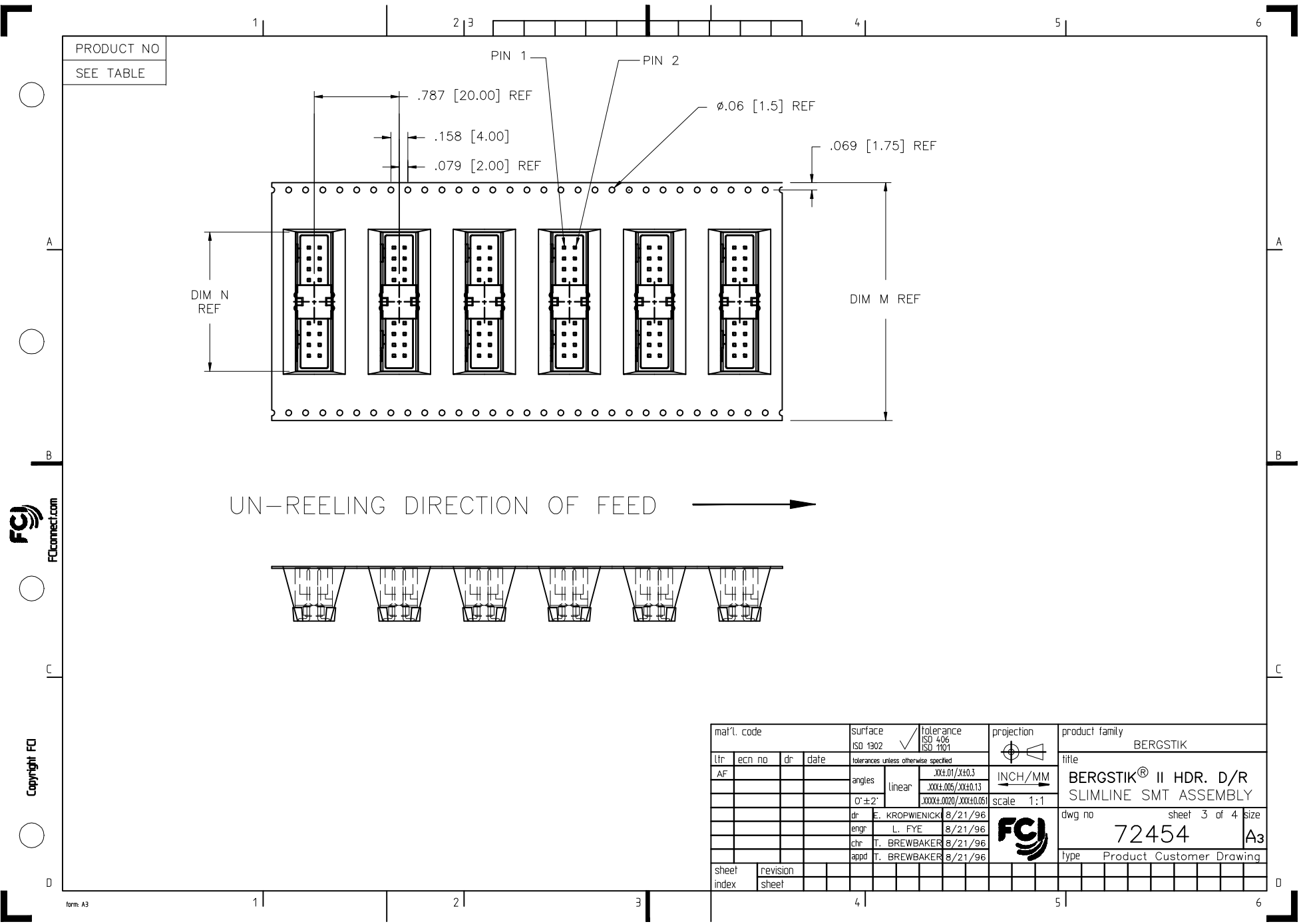

PRODUCT NO
SEE TABLE

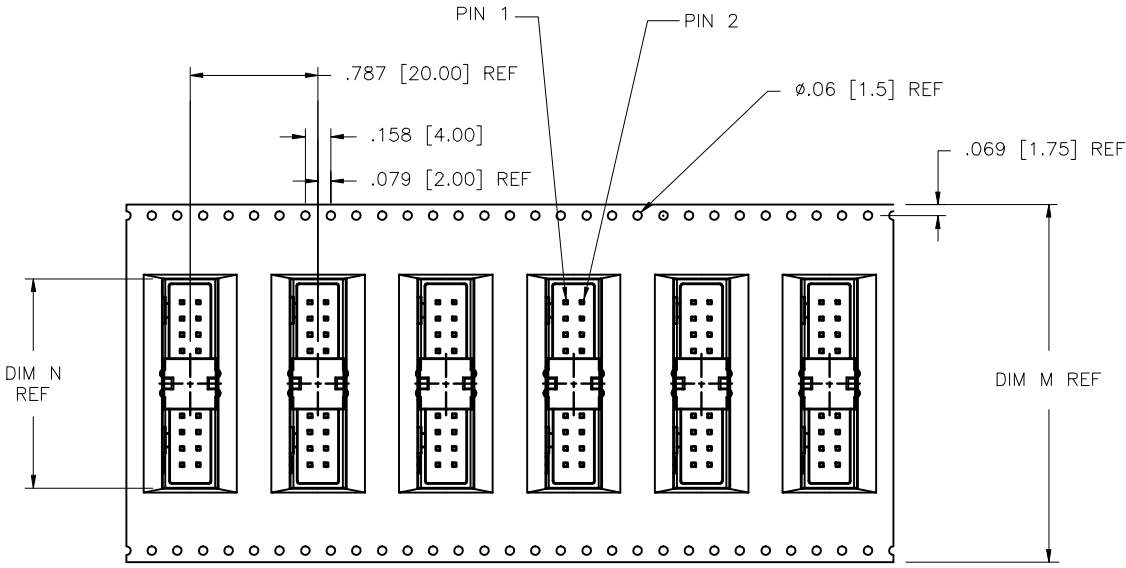

UN-REELING DIRECTION OF FEED →

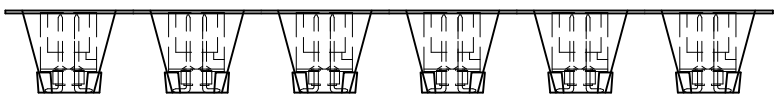

mat'l. code		surface	tolerance	projection	product family
		ISO 1302	ISO 406		BERGSTIK
			ISO 1101		tolerances unless otherwise specified
ltr	ec'n no	dr	date		title
AF					BERGSTIK® II HDR. D/R SLIMLINE SMT ASSEMBLY
		angles	linear	scale	1:1
		0° ± 2'	.XX±.01/XX±0.3		
			.XXX±.006/XXX±0.13		
			.XXX±.0020/XXX±0.051		
		dr	E. KROPWIENICK 8/21/96	dwg no	
		engr	L. FYE 8/21/96	sheet 3 of 4 size	
		chr	T. BREWBAKER 8/21/96	72454 A3	
		appd	T. BREWBAKER 8/21/96	type	
				Product Customer Drawing	
sheet	revision				
index	sheet				



Copyright FCJ

form A3

PRODUCT NUMBER	NO. OF POSITIONS	DIM B	DIM C	STYLE	POLARIZED POSITION	WINDOW OPTION	PLATING CODE	PACKAGING	TAPE WIDTH DIM M	POCKET DEPTH	DIM N	LEAD FREE OPTION
72454-008	2 X 4	.610/15.50	.690/15.33	A	-	N	AA	TRAY	---	---	---	NOTE 8,9
72454-010	2 X 5	.710/18.03	.790/20.07	A	-	N	AA	TRAY	---	---	---	
72454-010V	2 X 5	.710/18.03	.790/20.07	A	-	N	AA	TAPE ON REEL	1.260/32.00	.515/13.08	.790/20.07	
72454-014	2 X 7	.910/23.11	.99/25.2	D	-	N	AA	TRAY	---	---	---	
72454-014V	2 X 7	.910/23.11	.99/25.2	D	-	N	AA	TAPE ON REEL	1.732/44.00	.515/13.08	1.090/27.69	
72454-016	2 X 8	1.010/25.65	1.090/27.69	D	-	N	AA	TRAY	---	---	---	
72454-016V	2 X 8	1.010/25.65	1.090/27.69	D	-	N	AA	TAPE ON REEL	1.732/44.00	.515/13.08	1.090/27.69	
72454-020	2 X 10	1.210/30.73	1.290/32.77	D	-	N	AA	TRAY	---	---	---	
72454-020V	2 X 10	1.210/30.73	1.290/32.77	D	-	N	AA	TAPE-ON-REEL	2.205/56.00	.505/12.83	1.290/32.77	
72454-021	2 X 11	1.310/33.27	1.390/35.31	D	12	N	AA	TRAY	---	---	---	
72454-022	2 X 11	1.310/33.27	1.390/35.31	D	-	N	AA	TRAY	---	---	---	
72454-024	2 X 12	1.410/35.81	1.490/37.9	D	-	N	AA	---	---	---	---	
72454-024V	2 X 12	1.410/35.81	1.490/37.9	D	-	N	AA	TAPE-ON-REEL	2.205/56.00	.515/13.08	1.490/37.85	
72454-026	2 X 13	1.510/38.35	1.590/40.39	D	-	N	AA	TRAY	---	---	---	
72454-030	2 X 15	1.710/43.43	1.790/45.47	D	-	N	AA	TRAY	---	---	---	
72454-030V	2 X 15	1.710/43.43	1.790/45.47	D	-	N	AA	TAPE-ON-REEL	0.787/20.00	2.834/72.00	1.771/45.00	
72454-034	2 X 17	1.910/48.51	1.990/50.60	D	-	N	AA	TRAY	---	---	---	
72454-040	2 X 20	2.210/56.13	2.290/58.17	D	-	N	4	TRAY	---	---	---	
72454-041	2 X 20	2.210/56.13	2.290/58.17	D	-	N	AA	TRAY	---	---	---	
72454-044	2 X 22	2.410/61.21	2.490/63.25	D	-	N	AA	TRAY	---	---	---	
72454-050	2 X 25	2.710/68.83	2.790/70.87	D	-	N	AA	TRAY	---	---	---	
72454-051	2 X 10	1.210/30.73	1.290/32.77	D	-	Y	AA	TRAY	---	---	---	
72454-051V	2 X 10	1.210/30.73	1.290/32.77	D	-	Y	AA	TAPE-ON-REEL	2.205/56.00	.505/12.83	1.290/32.77	
72454-052	2 X 20	2.210/56.13	2.290/58.17	D	20	N	AA	TRAY	---	---	---	
72454-053V	2 X 5	0.710/18.03	0.790/20.07	A	9	N	AA	TAPE ON REEL	1.260/32.00	.515/13.08	.790/20.07	



Copyright FCJ

mat'l. code		surface	tolerance	projection	product family
ISO 1902		ISO 406	ISO 1101		BERGSTIK
ltr	ecn no	dr	date	title	
AF				BERGSTIK® II HDR. D/R	
angles		linear	linear	INCH/MM	SLIMLINE SMT ASSEMBLY
0°±2'		XXX±.01/XX±0.3	XXX±.006/XX±0.13	scale 1:1	
dr	E. KROPWIENICK	8/21/96		dwg no	sheet 4 of 4 size
engr	L. FYE	8/21/96		72454	A3
chr	T. BREWBAKER	8/21/96		type Product Customer Drawing	
appd	T. BREWBAKER	8/21/96			
sheet index	revision sheet				