

MOTECH MOTOR CO., LTD

Product Name		Hybrid Stepper Motor MT-1703HS120A			
Made by	P.T	Approve	R.Y	Date	9/28/2015

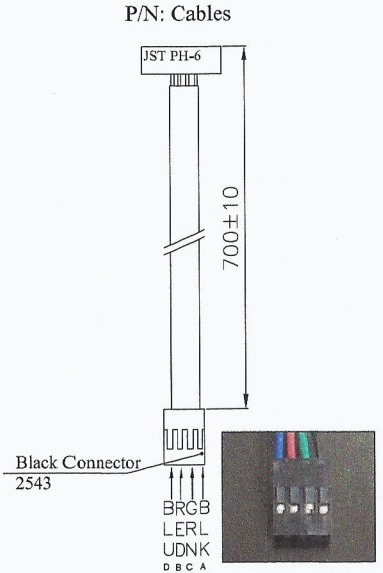
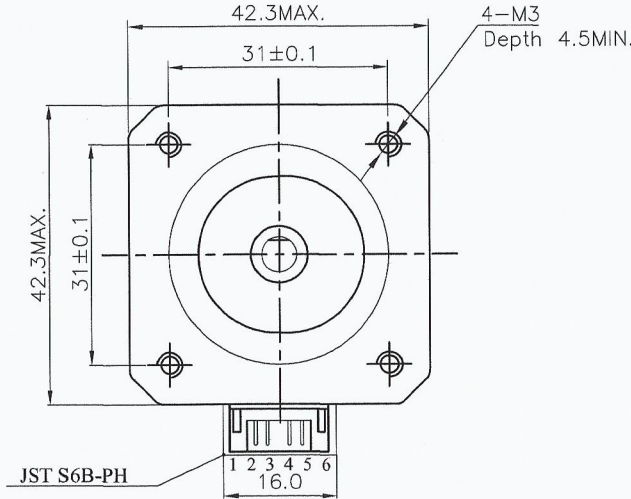
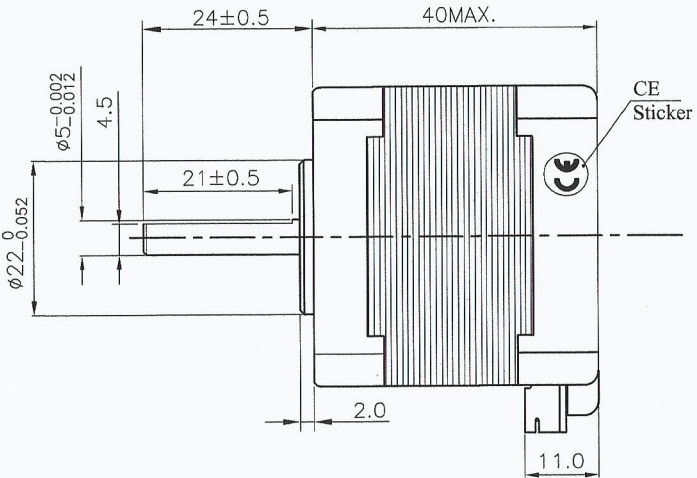

Items	Specs	Items	Specs
Phase Number	2 phases	Step Angle	1.8°±5%
Rated Voltage	3.4 VDC	Rated Current	DC 1.2 A / Phase
Resistance(20°C)	3.0±10% Ω / phase	Inductance	3.2±20% mH / Phase
Holding Torque	≥ 4.4 Kg-cm(61 Oz-in)	Detent Torque	0.22 Kg-cm REF.
Rotate Direction	ABCD A CW	MAX Starting PPS	2500 PPS
MAX slewing PPS	2500 PPS	Insulation Resistance	≥100 MΩ(DC 500V)
HI POT	AC600V/1mA/1S	Insulation Class	Class B
Rotor Inertia	54 g.cm²	Weight	0.30 Kg REF.

Wiring Diagram

