

### BU-1420711821

(PCB Edge Mount SMA Jack with Round Contact)

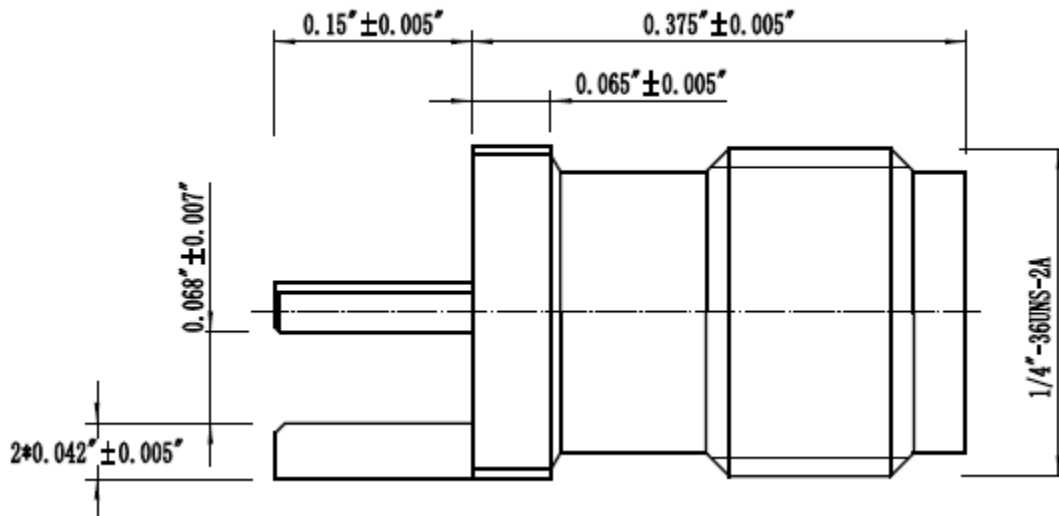

Mueller Electric Company  
2850 Gilchrist Rd. Bld 5A  
Akron, OH 44305

[www.muellerelectric.com](http://www.muellerelectric.com)

Toll Free: 800.955.2629  
Phone: 330.780.2525  
Fax: 330.780.2524

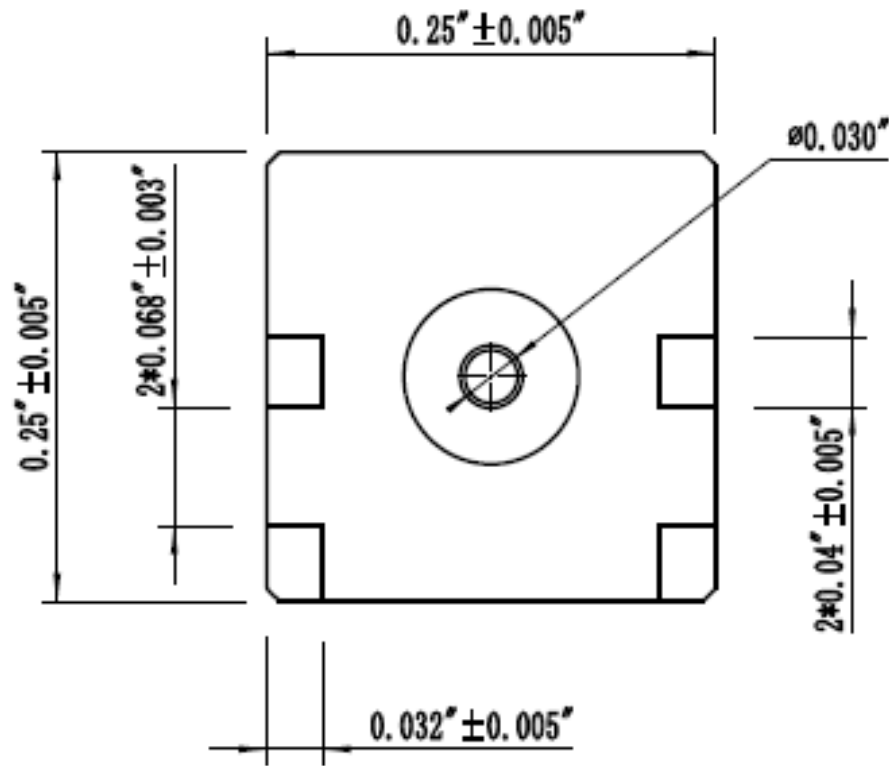

(Dimensions in Inches)

- End launch mounting
- Designed to mount on .063" (1.57 mm) Circuit Boards.
- Impedance: 50  $\Omega$
- Frequency: DC to 18 Ghz.
- Working Voltage: 335 VRMS Max
- Dielectric Withstand: 1000 VRMS
- Contact Resistance: 3 milliohms
- Mating Cycles: 500 Minimum
- Meets or exceeds the applicable paragraph of MIL-C-39012
- Operating Temperature: -65°C to 150°C
- RoHS 3 Compliant

Mueller Electric Company  
2850 Gilchrist Rd. Bld 5A  
Akron, OH 44305

[www.muellerelectric.com](http://www.muellerelectric.com)

Toll Free: 800.955.2629  
Phone: 330.780.2525  
Fax: 330.780.2524