

This document is the property of Amphenol Corporation and is delivered on the express condition that it is not to be disclosed, reproduced or used, in whole or in part, for manufacture or sale by anyone other than Amphenol Corporation without its prior consent, & that no right is granted to disclose or to use any information in this document.

Customer Drawing

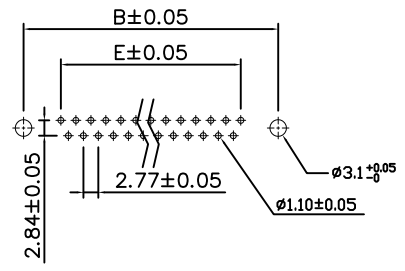
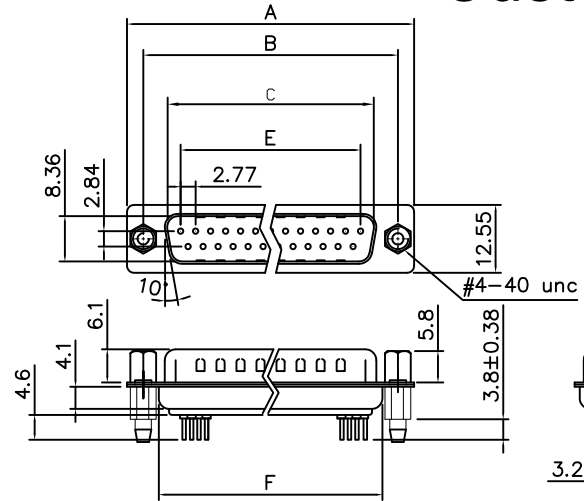

RECOMMENDED P.C.B LAYOUT
TOLERANCE: ±0.05MM

Dimensions

Positions	A	B	C	E	F
9	30.81	24.99	16.92	11.08	19.20
15	39.20	33.30	25.25	19.39	27.70
25	53.04	47.04	38.96	33.24	41.10
37	69.40	63.50	55.42	49.86	57.30

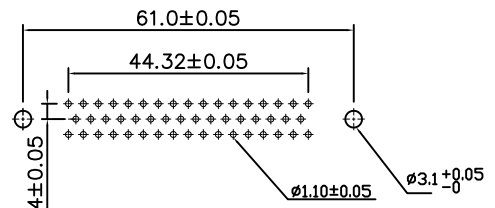
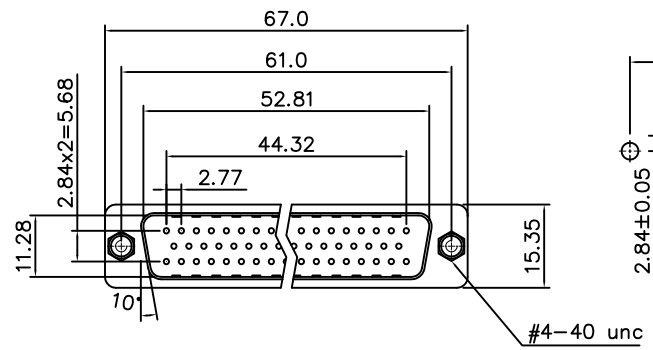

RECOMMENDED P.C.B LAYOUT
TOLERANCE: ±0.05MM

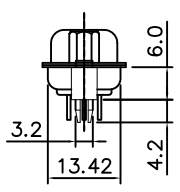
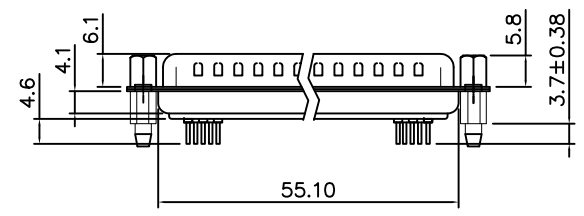

50 POSITIONS



REVISIONS				
SYM	ECN	DESCRIPTION	DATE	APPROVED
1	HK--	First Release Drawing	01/25/08	IP
2	HK--	Update the drawing	08/18/16	IP

D-SUB TECHNICAL DATA

- SHELL : Steel, 100u" min Tin over 50u" min nickel over 50u" min Copper
- BODY : Glass-Filled Thermoplastic PBT, UL94V-0, color Black
- CONTACTS : Copper alloy
30u" Gold over 50u" Nickel on mating area
100u" Tin over 50u" Nickel on solder area
- SCREWLOCK: Brass, Nickel Plated
- BOARDLOCK: Brass, Tin Plated
- ELECTRICAL : Voltage rating 250 V Rms
Current Rating :3 AMP
Withstanding Voltage : 1000 V AC/rms
Insulation resistance : 1000 MΩ min
Contact resistance 20 mΩ max
- MARKING : Amphenol...(Series No.)
Commercial reference
Manufacturing date

PRODUCT CODE

L 717 SD X H XX P OL2 RM8 C309

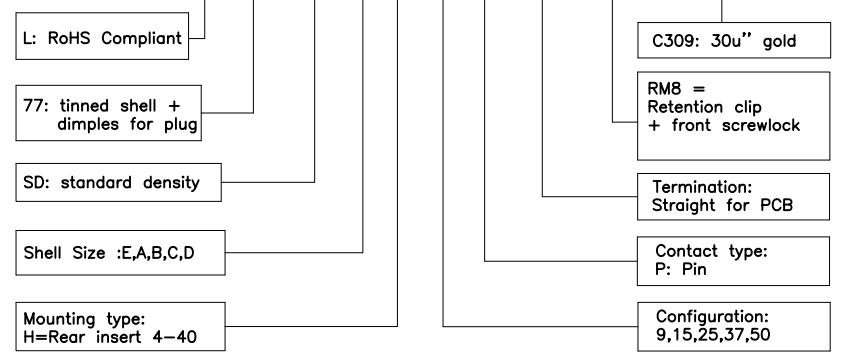

UNLESS OTHERWISE SPECIFIED TOLERANCES	APPROVAL		DATE
	U.S.	METRIC	
.X +/-	0.50	DRAWN	08/18/16
.XX +/-	0.30	CHECKED	08/18/16
.XXX +/-	0.20	CHECKED	
FRACTIONS +/-	5'	DRAWING FILE :	
ANGLES +/-		ANGLE OF PROJECTION	
FOR MATERIALS AND FINISHES SEE NOTES			
REMOVE SHARP EDGES			
DIMENSIONS		SCALE	
U.S.	INCHES	NONE	
METRIC	MM	SHEET 1 OF 1	

Amphenol

D-SUB connector, SD Series

SIZE	DRAWING NO.	REV.
A4	L717SDXHXXPOL2RM8C309	2

Mouser Electronics

Authorized Distributor

Click to View Pricing, Inventory, Delivery & Lifecycle Information:

[Amphenol:](#)

[L717SDBH25POL2RM8C309](#) [L717SDCH37POL2RM8C309](#) [L717SDDH50POL2RM8C309](#)
[L717SDEH09POL2RM8C309](#)