

Work Smart with Magnets

A comprehensive range of magnetic products
for a multitude of applications



(≤18.00")

400P
(880I

Work Smart with Magnets

With over 100 years of magnetic heritage and over 20,000 product choices, we can help you:-

Hold



Organise

Lock



Collect

Retrieve



Display



Lift



Weld



Measure









Protect



Contents



| | | Page |
|---|--|----------------------------------|
|  | Over 100 Years of Magnetic Heritage Work Smart with Our NEW Additions | 5-6 7 |
|  | Alnico Ferrite | 10-12 13-14 |
|  | Neodymium Alnico Ferrite Samarium Cobalt | 16-24 25-26 27-29 30-31 |
|  | Energise to Hold Energise to Release Armature Plates | 34 35 35 |
|  | UltraLift Lifting Handling | 38-39 40 41-42 |
|  | Retrieval Tools Pick-Up Tools Workshop Tools Mounting/Measurement | 44-47 48-50 51-55 56-57 |
|  | Magnetic Switchable Welding Aids Magnetic Welding Aids | 60-61 62-65 |

Contents



PRECISION

| | |
|----------------------|-------|
| Workholding | 68-71 |
| Mounting/Measurement | 72-73 |
| Bases | 74 |
| Fitments | 75-77 |
| Fitments LED Lamp | 78-79 |



DISPLAY

81-85

Let your business work smart with magnets

Typical industries benefiting from magnets

86-87

Guide to Magnet Materials

Choose the right material for your application

88-89

Customised Magnetic Solutions

We can solve your problem

90

Over 100 Years of Magnetic Heritage



Eclipse Magnetics has a rich history as a pioneer in applying magnetic technology to the **everyday challenges** of industry and commerce. From large complex OEM design projects to simple holding or pick up tasks, our clients can rest assured that **Eclipse Magnetics is definitely a brand to trust for product quality and service support.**



Add Value to Your Portfolio

End users can enjoy the benefits of a high performance, built to last product, whilst our agents and distributors can boost their portfolio and profits by stocking a globally recognised brand.

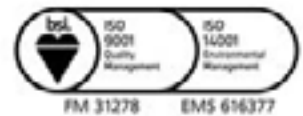

Problem Solving Solutions

Our range encompasses products for a diverse range of applications. Our knowledge and expertise of magnet materials has enabled us to design problem solving solutions for a diverse range of business sectors including: retail, aerospace, automotive, food processing, precision manufacturing, automation systems and power generation.

Premium Product Quality

Our skilled design and engineering teams set high standards of product design both in terms of performance and affordability. All our manufacturing is carried out under ISO 9001 quality management systems and where relevant, industry specific approvals.



Retail friendly packs



How it all began...

(≤18.00")

400
(880)

Over 100 Years of Magnetic Heritage

Post-Sales Support

We offer worldwide sales and technical support through our centres in the UK, Canada and China. We also have a worldwide network of approved distribution partners providing local support. Most of our products are available direct from our stock locations for immediate despatch.



Group Support

Eclipse Magnetics are part of the Spear & Jackson Group of companies, a world famous name with over 250 years of manufacturing and commercial success.

Environmental Policy

We are committed to continued improvement in key areas of efficient energy use and waste/pollution minimisation. We also comply with all legislation, regulations and codes of practice relevant to our sector. Our internal systems and procedures are fully accredited to ISO 14001 standards.

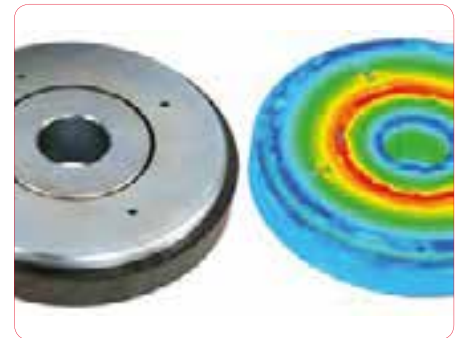

Contact Us

For more information about our products you can contact us via:

- +44 (0)114 225 0600
- +44 (0)114 225 0610
- www.eclipsemagnetics.com
- info@eclipsemagnetics.com

Eclipse Magnetics Ltd
Atlas Way, Sheffield, S4 7QQ, England.

Work Smart with our
NEW additions

NEW

Page
60

NEW Welding Clamps

With switchable feature



Page
48

NEW Pick Up Tools

Safe, convenient pick-up



Page
44

NEW Retrieval Tools

For those awkward jobs in difficult locations



Page
51

NEW Workshop Tools

Simplify everyday challenges



Did you know?

"Legend has it that a Greek shepherd called Magnes discovered magnetism 4000 years ago"





The
world renowned
HERITAGE
range

Heritage Range

We have a rich heritage of making magnets since 1914. The "Eclipse Magnetics Red" branding is now a globally recognised brand and an accepted symbol of high-quality craftsmanship and guaranteed high performance.

Over the years, we have set the benchmark for magnet quality, pioneered magnet shapes, colour and sizes which are now the norm worldwide.

Available in a variety of materials and designs for various applications, Heritage Range is a true value adding range for both end-users and stockists.

Typical Applications

The Heritage range is typically used in holding, fixing, clamping and switching applications, including:

- Reed Switches
- Hall Effect Sensors
- Retrieval
- Soldering fixtures
- Positioning jigs
- Circuit boards
- Educational use
- Security Instruments

Alnico

(See page 88 for material characteristics)

Alnico Cylindrical Bars

- Sold in pairs
- Typical Applications: Reed switches, hall effect sensors, coin operated machines, security instruments, electrical meters, circuit boards

| Product Number | Diameter mm | Length* mm | Weight / Pair g | Gauss | Pairs / Pack |
|----------------|-------------|------------|-----------------|-------|--------------|
| E808** | 4 | 10 | 2 | 1200 | 5 |
| E809** | 5 | 10 | 3 | 1200 | 5 |
| E810** | 6 | 10 | 4 | 1200 | 5 |
| E805 | 6 | 20 | 8 | 1200 | 10 |
| E806 | 8 | 25 | 18 | 1200 | 5 |
| E807 | 10 | 30 | 35 | 1200 | 5 |



*Magnetic axis
**Supplied natural

Alnico Rectangular Bars

- Sold in pairs
- North pole indicated by notch
- Typical Applications: Components for reed switches, relays, hall effect sensors, oil filters, educational use, laboratory use

| Product Number | Material | Length* mm | Width mm | Height mm | Weight / Pair g | Gauss | Pairs / Pack |
|----------------|----------|------------|----------|-----------|-----------------|-------|--------------|
| E842 | Alnico 2 | 50 | 15 | 10 | 220 | 750 | 2 |
| E843 | Alnico 2 | 75 | 15 | 10 | 330 | 750 | 2 |
| E844 | Alnico 5 | 20 | 10 | 5 | 30 | 1100 | 5 |
| E845 | Alnico 5 | 40 | 12.5 | 5 | 40 | 1100 | 5 |
| E846 | Alnico 5 | 60 | 15 | 5 | 130 | 1100 | 5 |



*Magnetic axis

Alnico Minor

- Typical Applications: Educational use, domestic, DIY use, attracting, holding or clamping steel parts

| Product Number | Length mm | Width mm | Height mm | Pole Gap mm | Weight g | Pull Force kg | Units / Pack |
|----------------|-----------|----------|-----------|-------------|----------|---------------|--------------|
| E801 | 22.2 | 7.9 | 11.1 | 6.3 | 10 | 0.9 | 10 |



Alnico



Alnico Buttons

- Typical Applications: Paint plant jigs, damping applications, relay switches, temperature sensitive devices

| Product Number | Diameter mm | Height mm | Slot Size (Min–Max) mm | Hole Size mm | Weight g | Pull Force kg | Units / Pack |
|----------------|-------------|-----------|------------------------|--------------|----------|---------------|--------------|
| E821 | 12.7 | 9.5 | 4.0–7.2 | 4.4 | 6 | 0.7 | 10 |
| E822 | 19.1 | 12.7 | 5.6–8.7 | 4.8 | 20 | 1.9 | 10 |
| E825 | 22.2 | 19.1 | 6.3–6.3 | 4.8 | 50 | 3 | 10 |
| E823 | 25.4 | 15.9 | 5.6–8.7 | 4.8 | 50 | 3.4 | 10 |
| E824 | 31.8 | 25.4 | 8.0–12.7 | 7.1 | 113 | 4.8 | 2 |



Alnico Pockets

- Typical Applications: Educational use, domestic /DIY attracting, holding and clamping steel parts

| Product Number | Length mm | Width mm | Height mm | Width Of Gap mm | Weight g | Pull Force kg | Units / Pack |
|----------------|-----------|----------|-----------|-----------------|----------|---------------|--------------|
| E802 | 28.5 | 7.6 | 25.4 | 6.3 | 30 | 2.4 | 10 |
| E803 | 33.3 | 15.9 | 35 | 7.9 | 90 | 4 | 5 |



Alnico Powers

- Typical Applications: Retrieval, welding/soldering fixtures, ultrasonic testing, crack detection, general attracting, clamping and holding steel parts

| Product Number | Length mm | Width mm | Height mm | Width Of Gap mm | Hole Size mm | Hole Centres mm | Weight g | Pull Force kg | Units / Pack |
|----------------|-----------|----------|-----------|-----------------|--------------|-----------------|----------|---------------|--------------|
| 811 | 30 | 20 | 20 | 15 | 5 | n/a | 60 | 4.5 | 5 |
| 812 | 40 | 25 | 25 | 20 | 5 | n/a | 120 | 9 | 5 |
| 813 | 45 | 30 | 30 | 23 | 5 | n/a | 180 | 11.8 | 2 |
| 814 | 57 | 44.5 | 35 | 27.8 | 2 x 7.9 | 31.75 | 370 | 23.5 | 1 |
| 815 | 70 | 57.2 | 41.3 | 34.1 | 2 x 7.9 | 38.10 | 710 | 37 | 1 |
| 816 | 79.4 | 82.6 | 54 | 38.1 | 2 x 9.5 | 42.86 | 1450 | 47 | 1 |
| 817 | 60.3 | 62 | 39.7 | 31.75 | n/a | n/a | 800 | 35 | 1 |
| 818 | 79.4 | 85.7 | 54 | 47.6 | n/a | n/a | 1800 | 60 | 1 |



Alnico

Alnico Shallow Pots

- Max operating temperature 450°C
- Mild steel pot
- Typical Applications: For height restricted applications, gripping, lifting, positioning jigs, soldering fixtures, general securing and fixtures



| Product Number | Diameter mm | Thickness mm | Hole Size mm | Screw Head Size mm | Weight g | Pull Force kg | Units / Pack |
|----------------|-------------|--------------|--------------|--------------------|----------|---------------|--------------|
| 826 | 19 | 7.5 | 4.5 | M3 csk | 10 | 3.0 | 10 |
| 827 | 28.5 | 8.5 | 5.2 | M4 csk | 30 | 5.0 | 10 |
| 828 | 38.1 | 10.35 | 5.2 | M4 csk | 80 | 13.0 | 5 |

Alnico Deep Pots

- Max operating temperature 220°C
- Mild steel pot, aluminium spacer
- Typical Applications: Gripping, lifting, positioning jigs, soldering fixtures, general securing and fixtures



| Product Number | Diameter mm | Height mm | Thread Size | Weight g | Pull Force kg | Units / Pack |
|----------------|-------------|-----------|-------------|----------|---------------|--------------|
| 829 | 9.5 | 15 | M3 | 5 | 1 | 10 |
| 830 | 12.7 | 15.9 | M4 | 15 | 2 | 10 |
| 831 | 17.5 | 16 | M6 | 23 | 2.65 | 10 |
| 832 | 20.5 | 19 | M6 | 40 | 4 | 5 |
| 833 | 27 | 25 | M6 | 85 | 6.1 | 5 |
| 834 | 35 | 30 | M6 | 184 | 14.75 | 2 |



Ferrite

(See page 88 for material characteristics)

Ferrite Shallow Pots With Threaded Hole

- Max operating temperature 120°C
- Mild steel pot
- Typical Applications: For height restricted applications, light lifting, holding, securing and clamping



| Product Number | Diameter mm | Thickness mm | Thread | Weight g | Pull Force kg | Units / Pack |
|----------------|-------------|--------------|--------|----------|---------------|--------------|
| E780 | 50 | 10 | M8 | 160 | 15 | 1 |
| E781 | 80 | 18 | M10 | 560 | 55 | 1 |

Ferrite Shallow Pots with Hook

- Max operating temperature 120°C
- Mild steel pot
- Removable hook
- Typical Applications: For height restricted applications, light lifting, holding, securing and clamping

| Product Number | Diameter mm | Thickness mm | Thread | Weight g | Pull Force kg | Units / Pack |
|----------------|-------------|--------------|--------|----------|---------------|--------------|
| E890 | 46 | 10.7 | M6 | 90 | 6 | 5 |
| E891 | 56 | 10.7 | M6 | 130 | 16 | 5 |
| E892 | 66 | 10.7 | M6 | 190 | 25 | 5 |



| Product Number | Diameter mm | Height mm | Fixing Stud Centres PCD M6 | Central Fixing Point | Weight g | Pull Force kg | Units / Pack |
|----------------|-------------|-----------|----------------------------|----------------------|----------|---------------|--------------|
| E895 | 66 | 10.7 | 46mm - 3 holes | M6 | 270 | 25 | 1 |
| E896 | 76 | 12.5 | 46mm - 3 holes | M6 | 300 | 33 | 1 |
| E897 | 100 | 15.5 | 70mm - 3 holes | M6 | 610 | 55 | 1 |



With M6 tapped holes

Heritage

Ferrite

Ferrite Channels

- Max operating temperature 120°C
- Mild steel body
- Ideal for door latches, holding, signage



| Product Number | Length mm | Width mm | Height mm | Plain Fixing Holes mm | Hole Centres mm | Weight g | Pull Force kg | Units / Pack |
|----------------|-----------|----------|-----------|-----------------------|-----------------|----------|---------------|--------------|
| E898/1 | 115 | 30 | 13 | 4.2 | 80 | 250 | 8 | 5 |
| E898/2 | 130 | 30 | 13 | 4.2 | 90 | 300 | 14 | 5 |
| E899 | 190 | 43 | 13 | 4.2 | 110 | 550 | 48 | 2 |



UTILITY

Utility Range - Work Smart with Magnets

Our Utility Range includes a variety of magnet materials and assemblies which are ideal for design engineering and simple practical applications. From basic clamping or holding to complex power generation or switching applications Utility Range provides a solution.

These high-quality magnets are manufactured to precise tolerances to meet a range of challenges. Whether it's magnetic strength, compact size, lightweight, surface protection, specialist attachments, mountings or temperature resistance, the Utility Range has the answer.

Typical Applications

- Audio system assemblies
- Magnetic pump couplings
- Door catches
- Motors
- Generators
- Sensors
- MRI and NMR
- Magnetic separators
- Magnetic bearings
- Lifting applications
- Retrieval magnets
- POS hanging and attaching

Neodymium

(See page 88 for material characteristics)

Neodymium Discs

- Ideal where compact size and maximum strength are required
- Ideal for retail, display or industrial holding or mounting applications

| Product Number | Diameter mm | Thickness* mm | Weight g | Pull Force kg | Units / Pack |
|----------------|-------------|---------------|----------|---------------|--------------|
| N835 | 3 | 1 | 0.1 | 0.13 | 50 |
| N800 | 3 | 2 | 0.1 | 0.3 | 10 |
| N836 | 4 | 1 | 0.1 | 0.16 | 50 |
| N801 | 4 | 2 | 0.2 | 0.4 | 10 |
| N802 | 4 | 3 | 0.3 | 0.7 | 10 |
| N803 | 4 | 4 | 0.4 | 0.9 | 10 |
| N837 | 5 | 1 | 0.2 | 0.20 | 50 |
| N804 | 5 | 2 | 0.3 | 0.55 | 10 |
| N805 | 5 | 3 | 0.4 | 0.85 | 10 |
| N806 | 5 | 5 | 0.7 | 1.3 | 10 |
| N838 | 6 | 1 | 0.2 | 0.33 | 50 |
| N807 | 6 | 3 | 0.6 | 1.0 | 10 |
| N808 | 6 | 4 | 0.8 | 1.3 | 10 |
| N824 | 6 | 6 | 1.3 | 2.00 | 10 |
| N839 | 8 | 1 | 0.4 | 0.39 | 50 |
| N825 | 8 | 3 | 1.2 | 1.28 | 10 |
| N809 | 8 | 4 | 1.5 | 1.7 | 10 |
| N810 | 8 | 5 | 1.7 | 2.12 | 10 |
| N840 | 9 | 1 | 0.5 | 0.45 | 50 |
| N811 | 9 | 3 | 1.4 | 1.6 | 10 |
| N841 | 10 | 1 | 0.6 | 0.51 | 50 |
| N826 | 10 | 2 | 1.2 | 1.10 | 10 |
| N812 | 10 | 3 | 1.8 | 1.65 | 10 |
| N813 | 10 | 5 | 2.9 | 2.7 | 10 |
| N842 | 12 | 1 | 0.9 | 0.60 | 50 |
| N827 | 12 | 2 | 1.8 | 1.30 | 10 |
| N828 | 12 | 3 | 2.6 | 2.10 | 10 |
| N843 | 15 | 1 | 1.4 | 0.75 | 50 |
| N814 | 15 | 3 | 4 | 2.5 | 3 |
| N829 | 15 | 5 | 6.8 | 4.10 | 5 |
| N815 | 20 | 3 | 7.1 | 3.3 | 3 |
| N830 | 20 | 5 | 12 | 5.50 | 5 |
| N816 | 20 | 10 | 23.6 | 10.5 | 1 |
| N831 | 25 | 5 | 19 | 9.00 | 5 |



*Magnetic axis

Neodymium



Adhesive Backed Discs

- Easy application for magnetic closures and fixings
- Material Grade: N42
- Coating Nickel plated
- Adhesive: 3M 468 Adhesive with quick release tab
- Polarity:
 - North - Adhesive on south pole
 - South - Adhesive on north pole



| Product Number | Diameter mm | Thickness mm | Polarity | Holding Force kg | Units / Pack | Product Weight Per Pack g |
|----------------|-------------|--------------|----------|------------------|--------------|---------------------------|
| N850N | 6 | 1 | North | 0.30 | 50 | 11.65 |
| N850S | 6 | 1 | South | 0.30 | 50 | 11.65 |
| N851N | 8 | 1 | North | 0.40 | 50 | 18.76 |
| N851S | 8 | 1 | South | 0.40 | 50 | 18.76 |
| N855N | 9.5 | 0.75 | North | 0.35 | 50 | 22 |
| N855S | 9.5 | 0.75 | South | 0.35 | 50 | 22 |
| N852N | 10 | 1 | North | 0.50 | 50 | 30 |
| N852S | 10 | 1 | South | 0.50 | 50 | 30 |
| N853N | 12 | 1 | North | 0.65 | 50 | 41.66 |
| N853S | 12 | 1 | South | 0.65 | 50 | 41.66 |
| N854N | 15 | 1 | North | 0.80 | 50 | 67.5 |
| N854S | 15 | 1 | South | 0.80 | 50 | 67.5 |

Neodymium Rings

- Ideal for countersunk screw mounting
- For door closures, general fixing and attaching applications

| Product Number | Diameter mm | Thickness* mm | Hole mm | Screw Head | Weight g | Pull Force kg | Units / Pack |
|----------------|-------------|---------------|---------|------------|----------|---------------|--------------|
| N832 | 15.4 | 3.25 | 3.3 | M3 | 4.4 | 3.5 | 5 |
| N834 | 17.5 | 4 | 4.5 | M4 | 6.9 | 4.8 | 5 |
| N833 | 19 | 7.6 | 4.5 | M4 | 15.5 | 8.1 | 5 |
| N822 | 20 | 10 | 6 csk | M6 | 21.4 | 4.7 | 1 |
| N823 | 37 | 3.5 | 6 csk | M6 | 27.5 | 4.9 | 1 |



*Magnetic axis

Neodymium

Neodymium Blocks

- Nickel plated for corrosion resistance
- Ideal for manufacturing, engineering and display projects where compact size and high strength is required

| Product Number | Length mm | Width mm | Height* mm | Weight g | Pull Force kg | Units / Pack |
|----------------|-----------|----------|------------|----------|---------------|--------------|
| N817 | 25 | 10 | 3 | 5.6 | 4.7 | 4 |
| N818 | 25 | 10 | 5 | 9.4 | 4.9 | 4 |
| N819 | 35 | 10 | 5 | 13.1 | 5.8 | 1 |
| N820 | 50 | 20 | 3 | 22.5 | 5.8 | 1 |
| N821 | 50 | 50 | 12.5 | 243.8 | 40.1 | 1 |



*Magnetic axis

Neodymium Shallow Pots

- High strength clamping and holding performance

| Product Number | Diameter mm | Thickness* mm | Weight g | Pull Force kg | Units / Pack |
|----------------|-------------|---------------|----------|---------------|--------------|
| E760NEO | 6 | 4.5 | 1 | 0.5 | 20 |
| E761NEO | 8 | 4.5 | 1.8 | 1.3 | 20 |
| E762NEO | 10 | 4.5 | 2.5 | 2.5 | 20 |
| E763NEO | 13 | 4.5 | 4.5 | 6 | 20 |
| E764NEO | 16 | 4.5 | 5.5 | 9.5 | 20 |
| E765NEO | 20 | 6 | 15 | 14 | 10 |
| E766NEO | 25 | 7 | 31 | 20 | 10 |
| E767NEO | 32 | 7 | 40 | 35 | 10 |



*Magnetic axis

Neodymium Shallow Pots with Threaded Hole

- Zinc plated body
- With female threaded hole for component mounting

| Product Number | Diameter mm | Thickness* mm | Total Height mm | Thread Size mm | Ferrule Outer Dia. mm | Weight g | Pull Force kg | Units / Pack |
|----------------|-------------|---------------|-----------------|----------------|-----------------------|----------|---------------|--------------|
| E770NEO | 6 | 4.5 | 11.5 | M3 | 6 | 2.7 | 0.5 | 20 |
| E771NEO | 8 | 4.5 | 11.5 | M3 | 6 | 3.5 | 1.3 | 20 |
| E772NEO | 10 | 4.5 | 11.5 | M3 | 6 | 4.5 | 2.5 | 20 |
| E773NEO | 13 | 4.5 | 11.5 | M3 | 6 | 7.5 | 6 | 20 |
| E774NEO | 16 | 4.5 | 11.5 | M4 | 8 | 13.2 | 9.5 | 20 |
| E775NEO | 20 | 6 | 13 | M4 | 8 | 16.5 | 14 | 10 |
| E776NEO | 25 | 7 | 14 | M4 | 8 | 34 | 20 | 10 |
| E777NEO | 32 | 7 | 15.5 | M5 | 10 | 48 | 35 | 5 |



*Magnetic axis

Neodymium



Neodymium Shallow Pots with Countersunk Hole

- Zinc plated body
- With countersunk hole for screw fixings



| Product Number | Diameter mm | Thickness* mm | Hole Size mm | Screw Head mm | Weight g | Pull Force kg | Units / Pack |
|----------------|-------------|---------------|--------------|---------------|----------|---------------|--------------|
| E998/NEO | 10 | 4.5 | 3 | M3 | 2 | 1.3 | 20 |
| E999/NEO | 13 | 4.5 | 3 | M3 | 3 | 3 | 20 |
| E1000/NEO | 16 | 4.5 | 3.5 | M3 | 6 | 7.5 | 20 |
| E1001/NEO | 20 | 6 | 4.5 | M4 | 13 | 10.5 | 10 |
| E1002/NEO | 25 | 7 | 4.5 | M4 | 24 | 16 | 10 |
| E1003/NEO | 32 | 7 | 5.5 | M5 | 39 | 31 | 10 |
| E1004/NEO | 40 | 8 | 5.5 | M5 | 73 | 50 | 5 |
| E1005/NEO | 48 | 11.5 | 8.5 | M8 | 100 | 87 | 1 |

*Magnetic axis

Neodymium Shallow Pots with Internal Thread

- Zinc plated body with threaded stem
- Maximum operating temperature of 80°C

| Product Number | Diameter mm | Thickness* mm | Thread mm | Weight g | Pull Force kg | Units / Pack |
|----------------|-------------|---------------|-----------|----------|---------------|--------------|
| E1018/NEO | 10 | 4.5 | M3 | 2.5 | 1.0 | 20 |
| E1019/NEO | 13 | 4.5 | M3 | 4.3 | 2.5 | 20 |
| E1020/NEO | 16 | 4.5 | M4 | 6.3 | 5.0 | 20 |
| E1021/NEO | 20 | 6 | M4 | 11 | 7.0 | 10 |
| E1022/NEO | 25 | 7 | M5 | 21 | 13.5 | 10 |
| E1023/NEO | 32 | 7 | M6 | 36 | 25.0 | 10 |
| E1024/NEO | 40 | 8 | M6 | 68 | 39.0 | 5 |



*Magnetic axis

Neodymium

Neodymium Shallow Pots with Borehole

- Zinc plated body with threaded stem
- Maximum operating temperature of 80°C
- Used in point of sale

| Product Number | Diameter mm | Thickness* mm | Hole In Body mm | Hole In Magnet mm | Depth mm | Weight g | Pull Force kg | Units / Pack |
|----------------|-------------|---------------|-----------------|-------------------|----------|----------|---------------|--------------|
| E1010/NEO | 16 | 5 | 3.5 | 6.5 | 3.8 | 9.9 | 4 | 20 |
| E1011/NEO | 20 | 7 | 4.5 | 8 | 5.5 | 13 | 6 | 10 |
| E1012/NEO | 25 | 8 | 5.5 | 9 | 6 | 29.1 | 14 | 10 |
| E1013/NEO | 32 | 8 | 5.5 | 9 | 5.5 | 36 | 23 | 10 |
| E1014/NEO | 42 | 9 | 6.5 | 11 | 6 | 52 | 32 | 5 |



*Magnetic axis

Neodymium Shallow Pots with External Thread

- Zinc plated body with threaded stem
- Maximum operating temperature of 80°C

| Product Number | Diameter mm | Thickness* mm | Overall Height mm | Thread mm | Weight g | Pull Force kg | Units / Pack |
|----------------|-------------|---------------|-------------------|-----------|----------|---------------|--------------|
| E1050/NEO | 10 | 4.5 | 11.5 | M3 | 3.4 | 2.5 | 20 |
| E1051/NEO | 13 | 4.5 | 11.5 | M3 | 3.9 | 6.0 | 20 |
| E1052/NEO | 16 | 4.5 | 13.5 | M4 | 7.1 | 9.5 | 20 |
| E1053/NEO | 20 | 6 | 15.5 | M4 | 14.9 | 14.0 | 10 |
| E1054/NEO | 25 | 7 | 16.5 | M5 | 26.9 | 20.0 | 10 |
| E1055/NEO | 32 | 7 | 18.5 | M6 | 43.9 | 35.0 | 5 |
| E1056/NEO | 40 | 8 | 20 | M8 | 80.1 | 41.0 | 5 |



*Magnetic axis

Neodymium Shallow Pots with Eyelet

- Zinc plated body with threaded stem
- Maximum operating temperature of 80°C

| Product Number | Diameter mm | Thickness mm | Overall Height mm | Thread mm | Weight g | Pull Force kg | Units / Pack |
|----------------|-------------|--------------|-------------------|-----------|----------|---------------|--------------|
| E1041/NEO | 16 | 4.5 | 27.5 | M4 | 9.9 | 8.0 | 20 |
| E1042/NEO | 20 | 6 | 29 | M4 | 13 | 13.5 | 10 |
| E1043/NEO | 25 | 7 | 49 | M6 | 29.1 | 18.0 | 10 |
| E1044/NEO | 32 | 7 | 49 | M6 | 52 | 30.0 | 10 |



Neodymium



Neodymium Bi-Pole Deep Pots with Threaded Hole

- Aluminium pot with mild steel pole pieces



| Product Number | Diameter mm | Height mm | Thread Size mm | Weight g | Pull Force kg | Units / Pack |
|----------------|-------------|-----------|----------------|----------|---------------|--------------|
| NH025 | 12.7 | 12 | M5 | 10 | 2.5 | 10 |
| NH065 | 16 | 16 | M6 | 18 | 8.0 | 10 |
| NH130 | 22.2 | 20 | M6 | 40 | 16.0 | 5 |
| NH240 | 25.4 | 25 | M6 | 70 | 25.0 | 5 |

Neodymium Shallow Pots with Hook

- Zinc plated body with threaded stem
- Maximum operating temperature of 80°C
- Used in point of sale



| Product Number | Diameter mm | Thickness mm | Overall Height Inc. Hook mm | Thread mm | Weight g | Pull Force kg | Units / Pack |
|----------------|-------------|--------------|-----------------------------|-----------|----------|---------------|--------------|
| E1030/NEO | 10 | 4.5 | 15 | M3 | 4.5 | 2.5 | 20 |
| E1031/NEO | 13 | 4.5 | 15 | M3 | 7.5 | 6.0 | 20 |
| E1032/NEO | 16 | 4.5 | 20.5 | M4 | 13.2 | 9.5 | 20 |
| E1033/NEO | 20 | 6 | 22 | M4 | 16.5 | 14.0 | 10 |
| E1034/NEO | 25 | 7 | 23 | M4 | 34 | 20.0 | 10 |
| E1035/NEO | 32 | 7 | 30 | M5 | 48 | 35.0 | 5 |

Neodymium

Neodymium Shallow Pots with Hook

- Mild steel pot painted white
- For retail and display applications
- Ideal for hanging graphics, utensils, tools etc

| Product Number | Diameter mm | Thickness mm | Total Height mm | Weight g | Pull Force kg | Units / Pack |
|----------------|-------------|--------------|-----------------|----------|---------------|--------------|
| M19863XR | 32 | 7 | 38 | 51 | 35 | 1 |



Neodymium Shallow Pots with Swivel Hook

- Turns freely 360° around the magnet base and swing 180°
- Great for hanging various items in a desired direction without the need for nails or screws

| Product Number | Diameter mm | Thickness (incl. Ferrule) mm | Height (incl. Hook) mm | Weight g | Pull Force kg | Units / Pack |
|----------------|-------------|------------------------------|------------------------|----------|---------------|--------------|
| E1070/NEO | 25 | 15 | 65 | 38 | 18 | 2 |
| E1071/NEO | 32 | 15 | 65 | 52 | 30 | 2 |
| E1072/NEO | 36 | 15 | 65 | 65 | 40 | 2 |
| E1073/NEO | 40 | 15 | 65 | 84 | 50 | 2 |



Neodymium Shallow Pots with Spring Closure Carabiner Hook

- Zinc plated body
- 80°c max operating temperature
- Ideal for holding and suspending ropes, wires and cables etc

| Product Number | Diameter mm | Height mm | Weight g | Pull Force kg | Units / Pack |
|----------------|-------------|-----------|----------|---------------|--------------|
| E1066/NEO | 28 | 14 | 30 | 20 | 1 |



Neodymium



Neodymium Bi-Pole Deep Pots

- Brass pot
- Diameter ground to H6 tolerance
- For positioning, holding and clamping

| Product Number | Diameter mm | Height mm | Weight g | Pull Force kg | Units / Pack |
|----------------|-------------|-----------|----------|---------------|--------------|
| E750NEO | 6 | 20 | 4 | 1.0 | 20 |
| E751NEO | 8 | 20 | 7 | 2.5 | 20 |
| E752NEO | 10 | 20 | 11 | 4.5 | 20 |
| E753NEO | 13 | 20 | 19 | 7.0 | 20 |
| E754NEO | 16 | 20 | 29 | 15.0 | 10 |
| E755NEO | 20 | 25 | 57 | 28.0 | 5 |
| E756NEO | 25 | 35 | 128 | 45.0 | 2 |
| E757NEO | 32 | 40 | 228 | 70.0 | 2 |



Neodymium Deep Pots

- N35 grade
- Steel casing

| Product Number | Diameter mm | Height mm | Thread Size | Weight g | Pull Force kg | Units / Pack |
|----------------|-------------|-----------|-------------|----------|---------------|--------------|
| E740NEO | 6 | 20 | M3 | 4 | 0.6 | 20 |
| E741NEO | 8 | 20 | M3 | 7.5 | 1.2 | 20 |
| E742NEO | 10 | 20 | M4 | 11 | 2.4 | 20 |
| E743NEO | 13 | 20 | M4 | 20 | 6.0 | 20 |
| E744NEO | 16 | 20 | M4 | 30 | 9.0 | 10 |
| E745NEO | 20 | 25 | M6 | 58 | 13.5 | 5 |
| E746NEO | 25 | 35 | M6 | 131 | 19.0 | 2 |
| E747NEO | 32 | 40 | M8 | 243 | 34.0 | 2 |



Neodymium Channel Magnet

- High strength magnet for holding, attaching or fixing applications

| Product Number | Length mm | Width mm | Height Size mm | Countersunk Hole | Hole Centres | Weight g | Pull Force kg | Units / Pack |
|----------------|-----------|----------|----------------|------------------|--------------|----------|---------------|--------------|
| NCM010 | 10 | 13.5 | 5 | 1 x M3 | N/A | 5 | 4 | 5 |
| NCM020 | 20 | 13.5 | 5 | 1 x M3 | N/A | 9 | 8 | 5 |
| NCM040 | 40 | 13.5 | 5 | 2 x M3 | 30 | 18 | 17 | 3 |
| NCM060 | 60 | 13.5 | 5 | 2 x M3 | 50 | 28 | 30 | 3 |
| NCM080 | 80 | 13.5 | 5 | 2 x M3 | 70 | 38 | 35 | 1 |
| NCM100 | 100 | 13.5 | 5 | 2 x M3 | 90 | 47 | 37 | 1 |
| NCM120 | 120 | 13.5 | 5 | 2 x M3 | 110 | 57 | 42 | 1 |



Rubber Covered Neodymium Pots

- Santoprene Rubber coating for scratch-free clamping
- Neodymium Magnets (NdFeB) inside for maximum holding forces
- Extremely good shear forces - high resistance to sliding
- Protects surfaces such as lacquered mild steel car body work
- Maximum recommended operating temperature is 60°C



With Threaded Neck

| Product Number | Diameter mm | Thickness mm | Overall Height mm | Thread Length mm | Thread Size | Holding Force kg | Units / Pack |
|----------------|-------------|--------------|-------------------|------------------|-------------|------------------|--------------|
| E851 | 22 | 6 | 12.5 | 6.5 | M4 | 5 | 2 |
| E853 | 43 | 6 | 21 | 15 | M6 | 8.5 | 2 |
| E854 | 66 | 8.5 | 23.5 | 15 | M8 | 18 | 2 |
| E855 | 88 | 8.5 | 23.5 | 15 | M8 | 42 | 2 |



With Screwed Bush

| Product Number | Diameter mm | Thickness mm | Overall Height mm | Bush Diameter mm | Thread Size | Holding Force kg | Units / Pack |
|----------------|-------------|--------------|-------------------|------------------|-------------|------------------|--------------|
| E851/1 | 22 | 6 | 11.5 | 8 | M4 | 5 | 2 |
| E853/1 | 43 | 6 | 10.5 | 8 | M4 | 8.5 | 2 |
| E854/1 | 66 | 8.5 | 15 | 10 | M5 | 18 | 2 |
| E855/1 | 88 | 8.5 | 17 | 12 | M8 | 42 | 2 |



With Internal Thread

| Product Number | Diameter mm | Thickness mm | Thread Size | Holding Force kg | Units / Pack |
|----------------|-------------|--------------|-------------|------------------|--------------|
| E851/2 | 22 | 6 | M4 | 5 | 2 |
| E853/2 | 43 | 6 | M4 | 8.5 | 2 |
| E854/2 | 66 | 8.5 | M5 | 18 | 2 |
| E855/2 | 88 | 8.5 | M8 | 42 | 2 |



Rubber Covered Rectangular Neodymium with Internal Thread

| Product Number | Length mm | Width mm | Thickness mm | Thread Size | Holding Force kg | Units / Pack |
|----------------|-----------|----------|--------------|-------------|------------------|--------------|
| E856/2 | 43 | 31 | 6 | 1 x M4 | 8.5 | 2 |
| E857/2 | 43 | 31 | 6 | 2 x M4 | 8.5 | 2 |



Alnico

(See page 88 for material characteristics)



Alnico Deep Pots

- Max. operating temperature: 220°C
- Mild steel pot
- Brass spacer
- Zinc plated body

| Product Number | Diameter mm | Height mm | Weight g | Pull Force kg | Units / Pack |
|----------------|-------------|-----------|----------|---------------|--------------|
| E790 | 6 | 20 | 4 | 0.2 | 20 |
| E791 | 8 | 20 | 7 | 0.4 | 20 |
| E792 | 10 | 20 | 11 | 0.8 | 20 |
| E793 | 13 | 20 | 19 | 1.0 | 20 |
| E794 | 16 | 20 | 29 | 1.8 | 10 |
| E795 | 20 | 25 | 57 | 4.2 | 5 |
| E796 | 25 | 35 | 140 | 8.0 | 2 |



Alnico Deep Pots

- Max. operating temperature: 220°C
- Mild steel pot
- Brass spacer
- Zinc plated body
- Diameter ground to H6 tolerance
- Ideal for press fitting into milled holes

| Product Number | Diameter mm | Height mm | Weight g | Pull Force kg | Units / Pack |
|----------------|-------------|-----------|----------|---------------|--------------|
| E730 | 6 | 10 | 2 | 0.2 | 20 |
| E731 | 8 | 12 | 4 | 0.3 | 20 |
| E732 | 10 | 16 | 9 | 0.5 | 20 |
| E733 | 13 | 18 | 17 | 1.0 | 20 |
| E734 | 16 | 20 | 29 | 1.5 | 10 |
| E735 | 20 | 25 | 57 | 3.5 | 5 |
| E736 | 25 | 30 | 110 | 8.0 | 5 |
| E737 | 32 | 35 | 200 | 15.0 | 2 |
| E738 | 40 | 45 | 420 | 20.0 | 2 |
| E739 | 50 | 50 | 720 | 35.0 | 1 |



Utility

Alnico

(See page 88 for material characteristics)

Alnico Deep Pots with Threaded Hole

- Max. operating temperature: 220°C
- Mild steel pot
- Brass spacer
- Zinc plated body

| Product Number | Diameter mm | Height mm | Thread mm | Weight g | Pull Force kg | Units / Pack |
|----------------|-------------|-----------|-----------|----------|---------------|--------------|
| E740 | 6 | 20 | M3 | 4 | 0.2 | 20 |
| E741 | 8 | 20 | M3 | 7 | 0.4 | 20 |
| E742 | 10 | 20 | M4 | 11 | 0.8 | 20 |
| E743 | 13 | 20 | M4 | 19 | 1.0 | 20 |
| E744 | 16 | 20 | M4 | 29 | 1.8 | 10 |
| E745 | 20 | 25 | M6 | 55 | 4.2 | 5 |
| E746 | 25 | 35 | M6 | 250 | 8.0 | 5 |
| E747 | 32 | 40 | M8 | 370 | 15.0 | 2 |
| E748 | 45 | 44 | M10 | 500 | 30.0 | 2 |



Alnico Major

- Ideal for magnetising small components
- Suitable for wave guidance applications

| Product Number | Length mm | Width mm | Height mm | Pole Gap mm | Weight kg | Flux Density at Gap Centre | | Units / Pack |
|----------------|-----------|----------|-----------|-------------|-----------|----------------------------|-------|--------------|
| | | | | | | Wb/m | Gauss | |
| 862 | 103.5 | 50 | 111 | 27.3 | 2.9 | 0.210 | 2000 | 1 |



Ferrite

(See page 88 for material characteristics)



Ferrite Shallow Pots with Mounting Hole

- Max. operating temperature: 120°C
- Mild steel pot
- Zinc plated body

| Product Number | Diameter mm | Thickness mm | Hole In Body mm | Hole In Magnet mm | Weight g | Pull Force kg | Units / Pack |
|----------------|-------------|--------------|-----------------|-------------------|----------|---------------|--------------|
| E888 | 50 | 10 | 8.5 | 22 | 9 | 18 | 5 |
| E889 | 80 | 18 | 6.5 | 16 | 480 | 54 | 1 |



Ferrite Shallow Pots with Countersunk Hole

- For screw fixing

| Product Number | Diameter mm | Thickness mm | Hole Size mm | Screw Head | Weight g | Pull Force kg | Units / Pack |
|----------------|-------------|--------------|--------------|------------|----------|---------------|--------------|
| E887 | 20 | 6 | 4.2 | M4 | 9 | 2.7 | 10 |
| E876 | 25 | 7 | 5.5 | M5 | 16 | 3.6 | 10 |
| E877 | 32 | 7 | 5.5 | M5 | 27 | 7.2 | 10 |
| E878 | 40 | 8 | 5.5 | M5 | 53 | 9.0 | 5 |

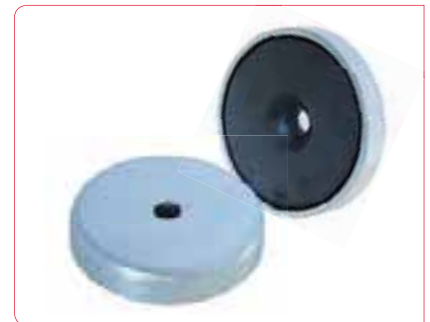

Ferrite Shallow Pots with Male Thread

- Ideal for mounting components

| Product Number | Diameter mm | Thickness mm | Overall Height mm | Thread | Weight g | Pull Force kg | Units / Pack |
|----------------|-------------|--------------|-------------------|--------|----------|---------------|--------------|
| E720 | 22 | 7 | 17 | M5 | 20 | 3.5 | 5 |
| E723 | 32 | 7 | 22 | M5 | 32 | 8.0 | 5 |



Ferrite

Ferrite Shallow Pots

- Max. operating temperature: 120°C
- Mild steel pot
- Zinc plated
- For press fit applications

| Product Number | Diameter mm | Thickness mm | Weight g | Pull Force kg | Units / Pack |
|----------------|-------------|--------------|----------|---------------|--------------|
| E700 | 10 | 4.5 | 2 | 0.4 | 20 |
| E701 | 13 | 4.5 | 3 | 1.0 | 20 |
| E702 | 16 | 4.5 | 4.5 | 1.8 | 20 |
| E703 | 20 | 6 | 10 | 3.0 | 10 |
| E704 | 25 | 7 | 19 | 4.0 | 10 |
| E705 | 32 | 7 | 30 | 8.0 | 10 |
| E706 | 40 | 8 | 55 | 12.5 | 5 |
| E707 | 50 | 10 | 100 | 22.0 | 5 |
| E708 | 63 | 14 | 230 | 35.0 | 1 |
| E709 | 80 | 18 | 485 | 60.0 | 1 |



Ferrite Shallow Pots with Threaded Hole

- Max. operating temperature: 120°C
- Mild steel pot
- Zinc plated
- Female thread
- Ideal for mounting components with screw or bolt

| Product Number | Diameter mm | Thickness mm | Overall Height mm | Thread | Weight g | Pull Force kg | Units / Pack |
|----------------|-------------|--------------|-------------------|--------|----------|---------------|--------------|
| E860 | 10 | 4.5 | 11 | M3 | 3 | 0.4 | 20 |
| E861 | 13 | 4.5 | 11.5 | M3 | 5 | 1.0 | 20 |
| E862 | 16 | 4.5 | 11.5 | M3 | 6 | 1.8 | 20 |
| E863 | 20 | 6 | 13 | M3 | 11 | 3.0 | 10 |
| E864 | 25 | 7 | 15 | M4 | 22 | 4.0 | 10 |
| E865 | 32 | 7 | 15 | M4 | 32 | 8.0 | 5 |
| E866 | 36 | 8 | 16 | M4 | 45 | 10.0 | 5 |
| E867 | 40 | 8 | 18 | M5 | 60 | 12.5 | 5 |
| E868 | 47 | 9 | 17 | M4 | 90 | 18.0 | 1 |
| E869 | 50 | 10 | 22 | M6 | 110 | 22.0 | 1 |
| E870 | 57 | 10.5 | 18.5 | M4 | 145 | 28.0 | 1 |
| E871 | 63 | 14 | 30 | M8 | 240 | 35.0 | 1 |
| E872 | 80 | 18 | 34 | M10 | 520 | 60.0 | 1 |
| E873 | 90 | 20 | 40 | M10 | 820 | 70.0 | 1 |
| E874 | 100 | 22 | 42 | M12 | 940 | 90.0 | 1 |
| E875 | 125 | 26 | 50 | M14 | 1720 | 130.0 | 1 |



Ferrite



Ferrite Discs

| Product Number | Diameter mm | Thickness mm | Weight g | Pull Force kg | Units / Pack |
|----------------|-------------|--------------|----------|---------------|--------------|
| CM700-R | 14 | 5 | 3.8 | 0.123 | 10 |
| CM701-R | 20 | 5 | 7.9 | 0.175 | 10 |
| CM702-R | 30 | 5 | 17.7 | 0.262 | 10 |



Ferrite Shallow Pots with Hook

- Max. operating temperature: 120°C
- Mild steel pot painted white
- Ideal for retail or general display applications
- For hanging graphics, utensils, tools etc



| Product Number | Diameter mm | Thickness mm | Height mm | Thread | Weight g | Pull Force kg | Units / Pack |
|----------------|-------------|--------------|-----------|--------|----------|---------------|--------------|
| E879-RB | 25 | 34 | 8 | M4 | 27 | 4.0 | 1 |
| E880-RB | 32 | 34 | 8 | M4 | 34 | 8.0 | 1 |
| E881-RB | 36 | 34 | 8 | M4 | 38 | 10.0 | 1 |

Ceiling Magnet with Hook

- Simple solution for hanging display materials
- Can be attached/removed quickly with no marking

| Product Number | Length mm | Width mm | Height mm | Thread | Weight kg | Pull Force kg | Units / Pack |
|----------------|-----------|----------|-----------|--------|-----------|---------------|--------------|
| CM3429 | 34 | 29 | 12 | M4 | 0.04 | 6 | 1 |
| CM5715 | 57 | 15 | 24 | M4 | 0.05 | 11.5 | 1 |
| CM5327 | 53 | 27 | 12 | M4 | 0.06 | 15 | 1 |



Samarium Cobalt

(See page 88 for material characteristics)

Samarium Cobalt Shallow Pots

- Max. operating temperature: 200°C
- Mild steel pot
- Zinc plated body
- For press fit applications

| Product Number | Diameter mm | Thickness mm | Weight g | Pull Force kg | Units / Pack |
|----------------|-------------|--------------|----------|---------------|--------------|
| E760 | 6 | 4.5 | 1 | 0.5 | 20 |
| E761 | 8 | 4.5 | 1.5 | 1.1 | 20 |
| E762 | 10 | 4.5 | 2.5 | 2.0 | 20 |
| E763 | 13 | 4.5 | 4.5 | 4.0 | 20 |
| E764 | 16 | 4.5 | 6.5 | 6.0 | 20 |
| E765 | 20 | 6 | 15 | 9.0 | 10 |
| E766 | 25 | 7 | 22 | 15.0 | 10 |
| E767 | 32 | 7 | 40 | 22.0 | 10 |



Samarium Cobalt Shallow Pots with Threaded Hole

- Max. operating temperature: 200°C
- Mild steel pot
- Zinc plated body
- Easy attachment with screw or bolt

| Product Number | Diameter mm | Thickness mm | Height (Inc Thread) mm | Thread | Ferrule Outer Dia. mm | Weight g | Pull Force kg | Units / Pack |
|----------------|-------------|--------------|------------------------|--------|-----------------------|----------|---------------|--------------|
| E770 | 6 | 4.5 | 11.5 | M3 | 6 | 2.7 | 0.5 | 20 |
| E771 | 8 | 4.5 | 11.5 | M3 | 6 | 3.6 | 1.1 | 20 |
| E772 | 10 | 4.5 | 11.5 | M3 | 6 | 4.5 | 2.0 | 20 |
| E773 | 13 | 4.5 | 11.5 | M3 | 6 | 7.5 | 4.0 | 20 |
| E774 | 16 | 4.5 | 11.5 | M4 | 8 | 9 | 6.0 | 20 |
| E775 | 20 | 6 | 13 | M4 | 8 | 16.5 | 9.0 | 10 |
| E776 | 25 | 7 | 14 | M4 | 8 | 33 | 15.0 | 10 |
| E777 | 32 | 7 | 15.5 | M5 | 10 | 48 | 22.0 | 5 |



Samarium Cobalt



Samarium Cobalt Deep Pots

- Max. operating temperature: 200°C
- Brass pot
- Diameter ground to H6 tolerance
- Ideal for press fit installation



| Product Number | Diameter mm | Thickness mm | Weight g | Pull Force kg | Units / Pack |
|----------------|-------------|--------------|----------|---------------|--------------|
| E750 | 6 | 20 | 4 | 0.8 | 20 |
| E751 | 8 | 20 | 7 | 2.2 | 20 |
| E752 | 10 | 20 | 11 | 4.0 | 20 |
| E753 | 13 | 20 | 19 | 6.0 | 20 |
| E754 | 16 | 20 | 29 | 12.5 | 10 |
| E755 | 20 | 25 | 57 | 23.0 | 5 |
| E756 | 25 | 35 | 128 | 40.0 | 2 |
| E757 | 32 | 40 | 228 | 60.0 | 2 |



Did you know?

"A typical car can contain 120 magnet assemblies"



ELECTRO



Electromagnets - Work Smart with Magnets

Our high-performance range of electromagnets are widely used for a variety of design engineering projects e.g. access control systems, medical devices and automation systems.

The standard electromagnet concept - a solenoid (wound copper coil) within a high-quality high permeability iron assembly - gives high clamping forces with low magnetic losses. They offer cost effective, energy efficient, durable solutions for manual and automated hold and release applications.

Typical Applications

- Door locks
- Alarm systems
- Security devices
- Card readers
- Sensors
- Actuators
- MRI scanners
- Stage Design
- Robotics
- Vending machines
- Audio systems

Electromagnets

(≤18.00")

400V
(880)

Energise to Hold

Power required to turn magnet ON. Power removed to turn magnet OFF.

- Sturdy bright nickel plated cylinder, passivated with body mounting
- High-quality permeable iron for low remanence
- Armature plates to suit

Operating Voltage 12VDC, 24VDC & 240VAC (with rectified plug connector)
Connector Options Flying leads, two-pole connector and Hirschman connector
Mounting Threaded holes in magnet rear face
Finish Bright nickel plated with machined face
ED Rating 100%
IP Rating 54 (20 for the two-pole connector)



| Standard Operating Voltage | | | | | | | Air Gap mm | | | | | | | | | | | | |
|-----------------------------|----|---------------|----------------------------|--------------|---------------|----------------------------|------------------------------|---------------|------|------|------|------|------|------|------|------|------|------|--|
| 240VAC Product Number | | Current mA | 24VDC Product Number | | Current mA | 12VDC Product Number | | Current mA | 0 | 0.09 | 0.18 | 0.27 | 0.36 | 0.59 | 1.00 | 1.59 | 2.00 | 4.00 | |
| | | | | | | | Pull Force (+/- 10%) Newtons | | | | | | | | | | | | |
| Diameter mm | 20 | | M52180/24VDC | 100 | M52180/12VDC | 210 | 53 | 22 | 9 | 5 | 3 | 2 | 1 | - | - | - | | | |
| | 25 | | M52172/24VDC | 90 | M52172/12VDC | 180 | 150 | 51 | 22 | 12 | 8 | 4 | 2 | - | - | - | | | |
| | 30 | | M52173/24VDC | 140 | M52173/12VDC | 280 | 280 | 149 | 80 | 43 | 26 | 12 | 5 | 2 | 2 | - | | | |
| | 40 | | M52174/24VDC | 230 | M52174/12VDC | 440 | 550 | 276 | 144 | 83 | 57 | 30 | 14 | 7 | 5 | 3 | | | |
| | 50 | M52175/240VA | 40 | M52175/24VDC | 240 | M52175/12VDC | 470 | 1000 | 655 | 442 | 282 | 187 | 87 | 37 | 24 | 19 | 6 | | |
| | 65 | M52176/240VA | 50 | M52176/24VDC | 340 | M52176/12VDC | 690 | 1670 | 1137 | 792 | 533 | 347 | 180 | 78 | 39 | 23 | 11 | | |
| | 80 | | | M52183/24VDC | 580 | M52183/12VDC | 1116 | 2000 | 1560 | 1117 | 715 | 567 | 283 | 130 | 67 | 37 | 20 | | |
| 100 | | | M52184/24VDC | 940 | M52184/12VDC | 1850 | 3600 | 2790 | 2230 | 1610 | 1360 | 1340 | 470 | 260 | 150 | 60 | | | |

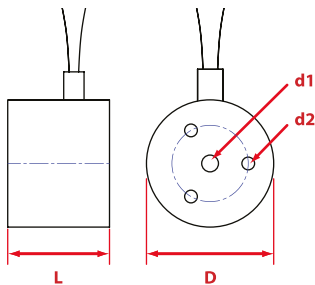

20, 25, 30mm diameter. Free leads (500mm long)
Leads: 1 red, 1 black. 0.3mm square x 500mm long)

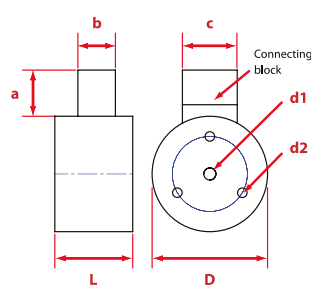

40, 50, 65, 80, 100mm diameter.
12VDC & 24VDC. Two pole connector

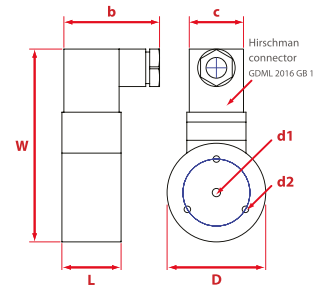

50, 65mm diameter 240VAC.
Hirschman Connector

| Product Number | Dimension mm | | | | | | | | PCD mm | Weight g |
|---------------------------|--------------|----|-----|----|----|----|-----|----|--------|----------|
| | D | L | W | A | B | C | D1 | D2 | | |
| 12 & 24V Units | | | | | | | | | | |
| M52180/24VDC | 20 | 18 | - | - | - | - | M4 | M3 | 14 | 36 |
| M52172/24VDC | 25 | 20 | - | - | - | - | M4 | M3 | 15 | 66 |
| M52173/24VDC | 30 | 24 | - | - | - | - | M5 | M3 | 18 | 108 |
| M52174/24VDC | 40 | 27 | - | 16 | 13 | 19 | M5 | M4 | 26 | 210 |
| M52175/24VDC | 50 | 30 | - | 16 | 13 | 19 | M5 | M4 | 34 | 364 |
| M52176/24VDC | 65 | 35 | - | 16 | 13 | 19 | M8 | M5 | 40 | 710 |
| M52183/24VDC | 80 | 38 | - | 16 | 13 | 19 | M8 | M6 | 50 | 1203 |
| M52184/24VDC | 100 | 43 | - | 16 | 13 | 19 | M10 | M6 | 75 | 2200 |
| 240V Units | | | | | | | | | | |
| M52175/240VA | 50 | 30 | 98 | - | 50 | 30 | M5 | M4 | 34 | 408 |
| M52176/240VA | 65 | 35 | 111 | - | 50 | 30 | M8 | M5 | 40 | 744 |



Energise to Release

Power required to turn magnet OFF. Power removed to turn magnet ON.

- Sturdy bright nickel plated cylinder, passivated with body mounting
- High-quality permeable iron for low remanence
- Armature plates to suit

| | |
|--------------------------|--|
| Operating Voltage | 24VDC & 240VAC (with rectified plug connector) |
| Connector Options | Hirschman connector |
| Mounting | Central machined hole in rear face of magnet |
| Finish | Bright nickel plated with machined face |
| IP Rating | S4 |
| Duty Cycle | S2 |



| Diameter mm | 35 | Standard Operating Voltage | | | | Air Gap mm | | | | | | | |
|-------------|----|------------------------------|------------|----------------------|------------|------------|------|------|------|------|------|------|------|
| | | 240VAC Product Number | Current mA | 24VDC Product Number | Current mA | 0 | 0.09 | 0.18 | 0.27 | 0.36 | 0.59 | 1.00 | 1.59 |
| | | Pull Force (+/- 10%) Newtons | | | | | | | | | | | |
| | 50 | M52177/240VA | 50 | M52177/24VDC | 240 | 250 | 91 | 51 | 32 | 23 | 17 | – | – |
| | 50 | M52178/240VA | 40 | M52178/24VDC | 350 | 500 | 317 | 208 | 151 | 116 | 73 | 47 | 28 |

| Product Number | Dimensions mm | | | | | | Weight g |
|----------------|---------------|----|----|----|-----------------|----|----------|
| | D | L | B | W | Connector | D1 | |
| M52177/24VDC | 35 | 48 | 50 | 78 | Hirschman Style | M5 | 352 |
| M52178/24VDC | 50 | 63 | 50 | 94 | Hirschman Style | M5 | 874 |
| M52177/240VA | 35 | 48 | 50 | 81 | Hirschman | M5 | 354 |
| M52178/240VA | 50 | 63 | 50 | 97 | Hirschman | M5 | 880 |

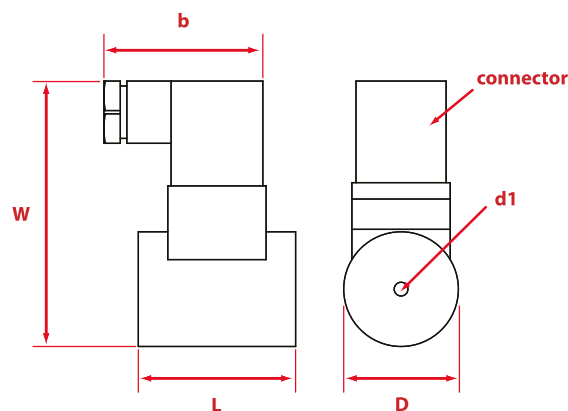

Armature Plates

- To fit both types

| Product Number | Diameter mm | Height mm | Screw | To Suit Diameter mm | Weight g |
|----------------|-------------|-----------|-------|---------------------|----------|
| M52171/25ARM | 25 | 3 | M3 | 20.25 | 15 |
| M52171/30ARM | 30 | 4 | M4 | 30 | 30 |
| M52171/40ARM | 40 | 5 | M4 | 35 / 40 | 50 |
| M52171/50ARM | 50 | 6 | M4 | 50 | 100 |
| M52171/65ARM | 65 | 8 | M5 | 65 | 210 |
| M52171/80ARM | 80 | 10 | M6 | 80 | 400 |
| M52171/100ARM | 100 | 12 | M10 | 100 | 740 |



To achieve the optimum pull force, 100% contact area must be achieved using the recommended armature plate. The force will be affected if other material specifications, thickness and surfaces are used, or if the armature fails to make positive contact over the full diameter of the face of the magnet. Where misalignment is likely to be an issue we recommend that an oversized armature plate is used to ensure 100% full contact, this however will reduce the stated pull force by approximately 10%



Did you know?

"With a magnetic North & South Pole
the Earth is like one big bar magnet"



LIFTING

Work Smart & Safely with Magnetic Lifting

Our lifting and handling systems are based on fail-safe magnetic technology which drives process efficiency and optimum operation safety. Ideal for a range of lifting applications from heavy duty steel-stock movement to light duty pick and place, magnetic lifting is the most efficient way of moving ferrous loads.

Total Safety

Operation safety is the foremost consideration in the design of all our magnetic lifting and handling systems. Each model has built-in safety mechanisms and comply with HSE guidelines such as the Lifting Operations and Lifting Equipment Regulations (LOLER) and the Provision and Use of Work Equipment Regulations (PUWER). They are also designed in accordance with ASME BS30.20-2010

Offers major benefits over slings, chains, hooks and grabs:

- Simple, Easy to use – ready to use in minutes
- Increased lifts per hour – simple on-off, single face engagement with load
- Protects the load – minimal surface contact, no sliding or movement
- Single person operation – labour efficient, minimal training required
- Optimised space – access only required to one face of the load
- Precision – greater lifting control/placement



UltraLift^{plus}+

3 Safety Features

- Locking switch handle mechanism
- Unique 'Safety Shim' - Pre-test any load to ensure a 3:1 safety factor
- Locking eye mechanism
 - Magnet cannot be switched off while holding a load

Magnetic lifters are quicker, easier and safer to use than slings, chains, hooks and grabs, and do not mark the load.

Onboard switching and permanent magnet technology mean installation and operation could not be easier and running costs are non-existent. Access is only required to the load's top face, allowing for more efficient storage and handling.

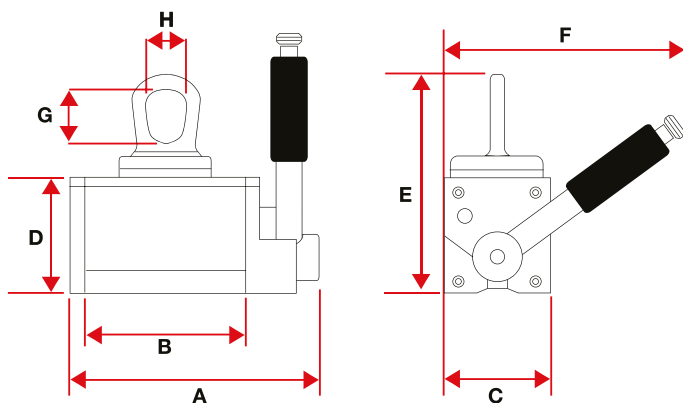

3:1 Safety Factor

The patented 'safety shim' allows pre-testing of the load to be lifted irrespective of weight, material, thickness and surface condition.



| Product Number | Self Weight kg | Dimensions mm | | | | | | | | Material Length Max. mm | Flat Section | | Round Section | |
|----------------|----------------|---------------|-----|-----|-----|-----|-----|-----|----|-------------------------|--------------|-------------------|---------------|-----------------|
| | | A | B | C | D | E | F | G | H | | SWL* kg | Thickness Min. mm | SWL* kg | Diameter Max mm |
| UL0125+ | 4 | 155 | 101 | 69 | 74 | 138 | 152 | 34 | 27 | 1500 | 125 | 20 | 50 | 200 |
| UL0250+ | 11 | 214 | 155 | 92 | 96 | 192 | 218 | 51 | 40 | 1500 | 250 | 25 | 100 | 300 |
| UL0500+ | 27 | 300 | 224 | 122 | 128 | 251 | 266 | 63 | 49 | 2000 | 500 | 30 | 200 | 400 |
| UL1000+ | 63 | 359 | 260 | 176 | 174 | 314 | 382 | 71 | 55 | 3000 | 1000 | 45 | 400 | 450 |
| UL2000+ | 157 | 477 | 368 | 233 | 227 | 422 | 552 | 102 | 79 | 3000 | 2000 | 55 | 800 | 600 |

*Safe working load

UltraLift



UltraLift LM

- Lifts up to 2000kg (flat) 800kg (round)
- Locking switch handle safety mechanism

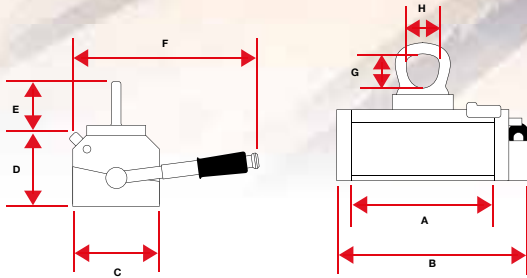

| Product Number | Self Weight kg | Dimensions mm | | | | | | | | Material Length Max mm | Flat Section | | Round Section | |
|----------------|----------------|---------------|-----|-----|-----|-----|-----|----|----|------------------------|--------------|-------------------|---------------|-----------------|
| | | A | B | C | D | E | F | G | H | | SWL* kg | Thickness Min. mm | SWL* kg | Diameter Max mm |
| LM0125 | 4.5 | 150 | 110 | 76 | 62 | 120 | 150 | 30 | 27 | 1500 | 125 | 20 | 50 | 250 |
| LM0250 | 8.5 | 210 | 165 | 90 | 72 | 150 | 200 | 45 | 40 | 1500 | 250 | 25 | 100 | 300 |
| LM0500 | 17.5 | 281 | 225 | 106 | 88 | 191 | 243 | 53 | 48 | 2000 | 500 | 30 | 200 | 400 |
| LM1000 | 36.5 | 391 | 325 | 136 | 103 | 217 | 365 | 59 | 52 | 3000 | 1000 | 45 | 400 | 450 |
| LM2000 | 79 | 483 | 400 | 186 | 132 | 302 | 526 | 88 | 79 | 3000 | 2000 | 70 | 800 | 600 |

*Safe working load

UltraLift TP

Thin Plate Lifter

- Lifts up to 400kg (flat)
- Specifically designed for the safe lifting of thin plate and pressings
- Can lift single sheets from the tops of stacks
- Locking switch handle safety mechanism

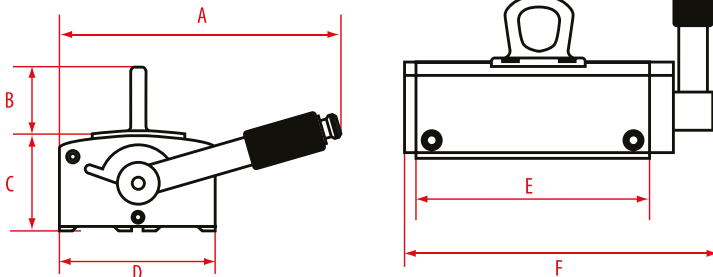

| Product Number | Self Weight kg | Dimensions mm | | | | | | Material Thickness mm | | | | | | | |
|----------------|----------------|---------------|----|----|-----|-----|-----|-----------------------|-------------|-----------|-------------|-----------|-------------|------------|--------------|
| | | A | B | C | D | E | F | 5 SWL* kg | 5 Length mm | 6 SWL* kg | 6 Length mm | 8 SWL* kg | 8 Length mm | 10 SWL* kg | 10 Length mm |
| TP150 | 8 | 181 | 52 | 74 | 100 | 150 | 202 | 75 | 1500 | 100 | 1500 | 150 | 1500 | 200 | 1500 |
| TP300 | 15 | 181 | 52 | 74 | 100 | 300 | 352 | 150 | 2000 | 200 | 2000 | 300 | 2000 | 400 | 2000 |

*Safe working load

Lifting

90° Disc and Plate Lifter

- Cost effective lifting frame with permanent lifting magnet
- Ideal for lifting and rotating steel discs and plates in positioning and machine loading applications
- Full adjustment and built in safety features



How it works

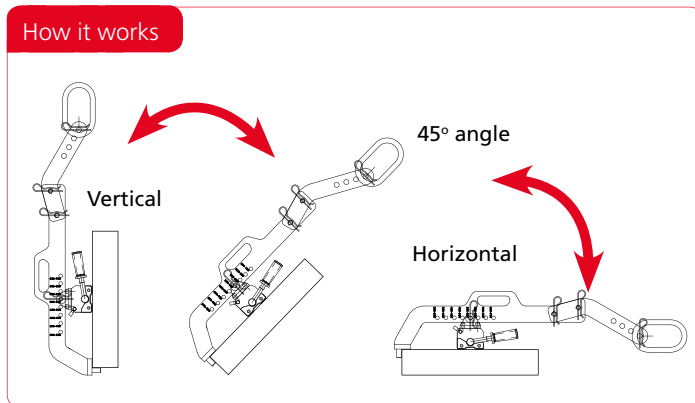

90° lifter can lift round and rectangular items.

| Product Number | SWL* kg | Load Thickness Min. mm | Load Thickness Max. mm | Load Diameter Min. mm | Load Diameter Max. mm |
|----------------|------------|------------------------------|------------------------------|-----------------------------|-----------------------------|
| LF125 | 125 | 20 | 55 | 250 | 600 |
| LF250 | 250 | 30 | 80 | 300 | 700 |
| LF500 | 500 | 40 | 125 | 350 | 800 |
| LF1000 | 1000 | 50 | 160 | 500 | 1000 |

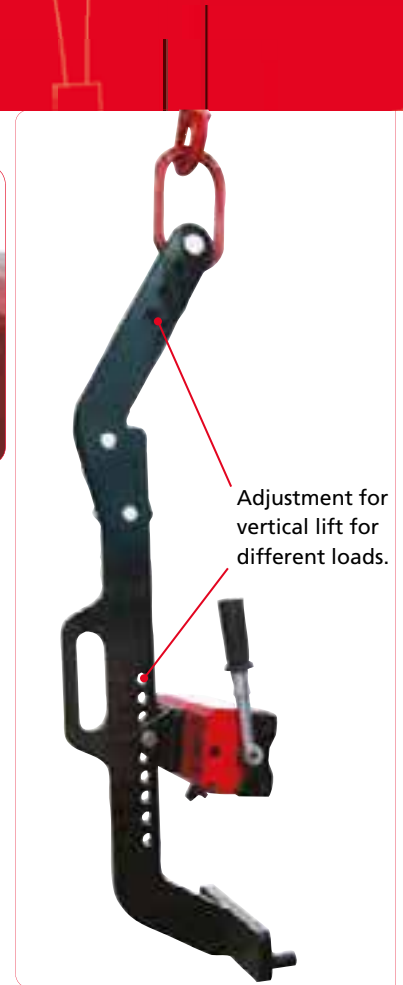

*Safe working load

Handling



Electronically switchable permanent magnet (ESPM)

Optimag E

- Ideal for clamping or lifting loads with clean, even, flat surfaces
- Suitable for applications which require sensing or built-in PLC control
- Failsafe operation - lose power it will retain the hold
- Ideal for materials from 10mm thick

| Product Number | Load Profile | SWL* kg | Dimensions mm | | | | Unit Weight kg | Rating @ 240v |
|----------------------|--------------|------------|------------------|-----|-----|-----|-------------------|------------------|
| | | | A | B | C | D | | |
| Circular | | | | | | | | |
| ESPM80C | Flat | 85 | 80 | 55 | N/A | N/A | 1.5 | 3.1 |
| ESPM100C | Flat | 150 | 105 | 55 | N/A | N/A | 3 | 4.4 |
| ESPM125C | Flat | 250 | 130 | 80 | N/A | N/A | 5.7 | 9.2 |
| ESPM150C | Flat | 400 | 155 | 80 | N/A | N/A | 8 | 11.5 |
| Rectangular** | | | | | | | | |
| ESPM284 | Flat | 42 | N/A | 83 | 40 | 80 | 1.4 | 2.8 |
| ESPM286 | Flat | 49 | N/A | 83 | 60 | 80 | 1.9 | 5.6 |
| ESPM2166 | Flat | 97 | N/A | 83 | 60 | 160 | 3.8 | 11.4 |
| ESPM2246 | Flat | 146 | N/A | 83 | 60 | 240 | 5.9 | 14.3 |
| ESPM2177H | Flat | 300 | N/A | 130 | 75 | 170 | 11 | 10 |
| ESPM2257H | Flat | 450 | N/A | 130 | 75 | 250 | 16.5 | 16 |
| ESPM2347H | Flat | 600 | N/A | 130 | 75 | 340 | 22 | 20 |

*Safe working load

**Can be manufactured to lift flat or round

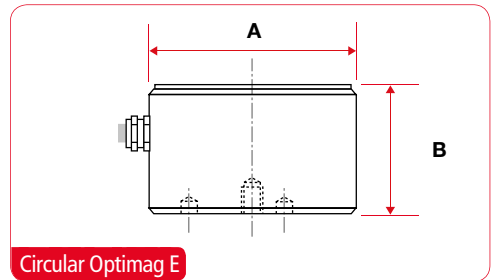

Circular Optimag E

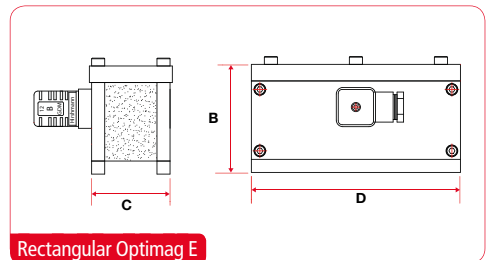

Rectangular Optimag E

ESPM Controller Unit

| Product Number | Operating Voltage | Rating | Dimensions mm | | |
|----------------|-------------------|--------|------------------|--------|-------|
| | v | | Width | Height | Depth |
| M24388/SC | 240 | 50 | 300 | 300 | 155 |
| M24388/DC | 240 | 100 | 300 | 300 | 155 |
| 6001CONT | 415 | 180 | 400 | 300 | 155 |
| M24388/HAND | N/A | N/A | 112 | 65 | 55 |
| 6001/MH | N/A | N/A | 112 | 65 | 55 |



ESPM Control Unit

Lifting

Handling

Pneumatically switchable permanent magnet (PSPM)

Optimag P

- Ideal for rigid, thin or perforated pressings or sheet
- Suitable for loads with rough, uneven or painted surfaces
- Failsafe operation - lose air clamping hold is retained
- Ideal for material thicknesses from 2mm thick

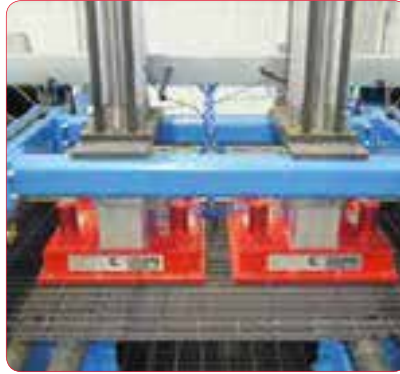

| Product Number | Load Profile | SWL* kg | Dimensions mm | | | | Unit Weight kg |
|--------------------|--------------|------------|------------------|-------------|------------|-------------|-------------------|
| | | | Diameter A | Height B | Width C | Length D | |
| Circular | | | | | | | |
| PSPM80C | Flat | 8.5 | 80 | 78.5 | N/A | N/A | 1.00 |
| PSPM100C | Flat | 18.5 | 100 | 82.5 | N/A | N/A | 1.50 |
| PSPM125C | Flat | 29 | 125 | 93 | N/A | N/A | 3.00 |
| PSPM150C | Flat | 59 | 150 | 109 | N/A | N/A | 4.80 |
| Rectangular | | | | | | | |
| PSPM1520 | Flat | 35 | N/A | 165 | 200 | 150 | 6.00 |
| PSPM2030 | Flat | 100 | N/A | 201 | 300 | 200 | 14.70 |

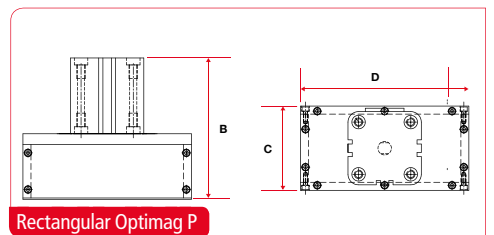
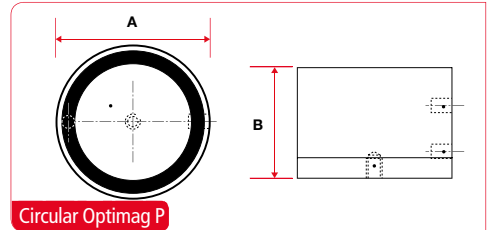

*Safe working load

Testing Service & Spares

We test and repair all models of permanent magnetic chucks, lifters and magnetic tools.

- Free inspection and quotation
- Certificate of performance for magnetic lifters to satisfy H&S audits
- Spare parts available

For more details, call us on +44 (0)114 225 0600



Workshop Tools – Work Smart with Magnets

Our Workshop range definitely allows you to "Work Smart with Magnets". We have applied our magnetic expertise to produce a range of magnetic tools which overcome simple everyday challenges faced in engineering workshops, factories, commercial workplaces and public spaces.

Typical Applications

- Tool storage
- Lost item retrieval e.g. keys or tools
- Car park clearing
- Swarf skimming
- Work bench cleaning
- Holding nails, screws, bolts
- Garage retrieval
- Sheet separation
- Demagnetisation
- Magnet fishing
- Protecting sports fields, play areas

Retrieval

Light Duty Telescopic Magnetic Retrieval Tool

- High precision Magnetic Retrieval tool
- Ideal for precise pick-up and retrieval
- Compact size with added pocket clip
- Extends 66cm
- Extra wide versions available for large areas



| Product Number | Length mm | Weight kg | Pull Force kg |
|----------------|-----------|-----------|---------------|
| EM967-R | 147-660 | 0.04 | 1 |

Heavy Duty Telescopic Magnetic Retrieval Tool

- Telescopic Magnetic Retrieval tool with over 7kg pick up capacity
- Extends to 77cm
- Anti-slip rubber handle for use in any working environment



| Product Number | Length mm | Weight kg | Pull Force kg |
|----------------|-----------|-----------|---------------|
| MRT770 | 180-770 | 0.88 | 7 |

Retrieval

Heavy Duty Telescopic Magnetic Retrieval Tool with Torch

- Extends to 81cm with 3kg magnetic hold
- Perfect for retrieving objects in hard to reach places
- Powerful LED Light (batteries Included)



| Product Number | Length mm | Weight kg | Pull Force kg |
|----------------|-----------|-----------|---------------|
| MRT810T | 190-810 | 0.08 | 3 |



Multifunction Telescopic Magnetic Retrieval Tool with Torch and Inspection Mirror

- Multi Function Telescopic Magnetic Retrieval tool with LED and inspection mirror
- Flexible head ideal for hard to reach places
- With added magnetic base can be used as inspection light
- Inspection mirror ideal in confined spaces
- Powerful LED Light (batteries Included)

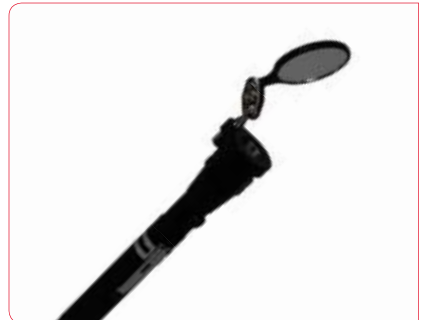

| Product Number | Length mm | Weight kg | Pull Force (Head) kg | Pull Force (Base) kg |
|----------------|-----------|-----------|----------------------|----------------------|
| MRT582MF | 175-582 | 0.132 | 3.5 | 5.0 |

Retrieval

Flexible Magnetic Retrieval Tool

- Flexible Magnetic Retrieval
- Ideal for retrieving items in hard to reach places
- Available up to 52cm



| Product Number | Length mm | Weight kg | Pull Force kg |
|----------------|-----------|-----------|---------------|
| E601 | 450 | 0.12 | 1.0 |
| E602 | 520 | 0.13 | 1.8 |

| Product Number | Length mm | Magnet Diameter mm | Outer Diameter mm | Weight kg | Pull Force kg |
|----------------|-----------|--------------------|-------------------|-----------|---------------|
| MRT505F | 505 | 6 | 6.5 | 0.10 | 0.9 |



Special Magnetic Retrieval Tool with Torch and Claw

- 62cm flexible length ideal for hard to reach places
- Push button spring steel retrieval claw ideal for non-magnetic pickup
- Powerful LED Light (batteries Included)



| Product Number | Length mm | Weight kg | Pull Force kg |
|----------------|-----------|-----------|---------------|
| MRT625MFF | 625 | 0.15 | 2.25 |



Retrieval

WORKSHOP

Recovery Tool

- Constructed from a ferrite magnet sandwiched between two steel plates
- Designed for recovery or retrieval, such as recovering objects from coolant tanks or vats

| Product Number | Width mm | Height mm | Thickness mm | Weight kg | Pull Force kg |
|----------------|----------|-----------|--------------|-----------|---------------|
| E936 | 80 | 101.5 | 36 | 1.4 | 50 |



Pick-Up

Magnetic Sweepers

- Attracts potentially dangerous or damaging ferrous items e.g. nails, pins, staples
- For easy clear of work areas, floors, sports pitches or car parks
- With adjustable telescopic handle
- Handle mounted quick release mechanism releases debris collected
- Extra wide version available for large areas



| Product Number | Head Width mm | Height Including Handle mm | Weight kg | Pull Force kg |
|----------------|---------------|----------------------------|-----------|---------------|
| MSW385 | 385 | 1050 | 1.225 | 2 |
| MSW620 | 620 | 1050 | 1.925 | 8 |
| MSW940 | 940 | 1050 | 2.695 | 12 |

Forklift Mounted Magnetic Sweeper

- Used for clearing larger areas e.g. factory floors, car parks of steel debris
- Reduces the risk of expensive punctures or human injury
- Easily mounted onto forklifts and secured with fastenings
- Corrosion resistant
- Incorporates a "quick release" mechanism for easy cleaning



| Product Number | Overall Length mm | Width mm | Height (Box Section) Overall Height (Excl.Eyebolt) mm | Depth of Field mm | Weight kg | Pull Force kg |
|----------------|-------------------|----------|---|-------------------|-----------|---------------|
| MSW1200/FLT | 1200 | 76 | 100/148 | 60 | 14 | 90 |

Magnetic Rake

- Protects grassed areas, sand, gravel, soil from potentially dangerous ferrous items
- Robust construction
- Telescopic handle
- Quick release mechanism of magnet



| Product Number | Head Width mm | Length mm | Weight kg |
|----------------|---------------|-----------|-----------|
| MR305 | 305 | 1100 | 0.835 |

Pick-Up

WORKSHOP

Magnetic Pick-Up Wand

- Quick and safe pick-up of iron and steel offcuts, filings, chips and general swarf
- Features a quick release handle
- Lightweight and extremely durable - non-rusting
- Long reach version available 90cm



| Product Number | Length mm | Weight kg | Collection Capacity kg |
|----------------|--------------|--------------|---------------------------|
| MW400 | 400 | 0.476 | 6.35 |
| MW900 | 900 | 0.725 | 6.35 |

Magnetic Pick-Up Tool

- Long reach pick-up tool
- Large magnetic head
- Ideal for garage, workshop factory, general purpose use
- Telescopic handle
- Holds up to 4kg



| Product Number | Head Diameter mm | Length mm | Weight kg | Pull Force kg |
|----------------|---------------------|--------------|--------------|------------------|
| MPT1100 | 88 | 990 | 0.835 | 4 |

Magnetic Hand Lifter

- Quick and easy pick-up of ferrous components, plates and discs
- Easy attachment to/release from ferrous surfaces
- Features a comfortable non-slip rubber grip
- Separates awkward to handle/pick up items



| Product Number | Length mm | Width mm | Height mm | Weight kg | Pull Force kg |
|----------------|--------------|-------------|--------------|--------------|------------------|
| MHL | 130 | 28 | 85 | 0.42 | 45 |

Pick-Up

Hand-Held Pick-Up Tool

- Ferrite magnet attracts ferrous items to base
- Quick release handle frees attracted items
- Ideal for picking up small components, nails, bolts and spilt materials

| Product Number | Length mm | Width mm | Height mm | Weight kg | Pull Force kg |
|----------------|-----------|----------|-----------|-----------|---------------|
| E961 | 121 | 41 | 235 | 2.75 | 1.15 |



Heavy Duty Hand-held Magnetic Pick-Up Tool

- Powerful ferrite magnet for easy pick-up and release of ferrous items
- Features a quick release handle to free attracted items
- An effective, rapid means of lifting small iron and steel parts from stock bins, boxes
- Long reach handle version available (see below)



| Product Number | Length mm | Width mm | Height mm | Weight kg | Pull Force kg |
|----------------|-----------|----------|-----------|-----------|---------------|
| MPT185 | 120 | 70 | 185 | 1.130 | 6 |

Long Reach Heavy Duty Hand-Held Magnetic Pick-Up Tool

- Facilitates easy pick up and placement of items from ground level locations
- User friendly, safe, practical and time saving
- Features a quick release handle to release attracted items

| Product Number | Length mm | Width mm | Height mm | Weight kg | Pull Force kg |
|----------------|-----------|----------|-----------|-----------|---------------|
| MPT700 | 120 | 70 | 700 | 2.030 | 6 |



Workshop Tools

WORKSHOP

Magnetic Tool Rack

- Contains 2 powerful magnetic bars with extruded magnetic rubber lengths, housed between two pole pieces
- Neatly secures and holds tools in the garage or workshop and knives in the kitchen



| Product Number | Length mm | Height mm | Thickness mm | Weight kg |
|----------------|-----------|-----------|--------------|-----------|
| EM985-R | 350 | 33 | 13 | 0.31 |

Heavy Duty Magnetic Tool Rack

- An efficient way of keeping your most-used tools organised, visible and accessible
- Ideal for use in the home, garage or workshop
- Modular design allows multiple units to be connected
- Easily mount screwdrivers, hammers, wrenches, spanners, ratchets, pliers, saw blades, knives, scissors etc
- Non-magnetic tools can be placed between the rack and the wall
- Simple screw-fit attachment to wall or other surfaces



| Product Number | Overall Length mm | Body Width mm | Body Depth mm | Weight kg |
|----------------|-------------------|---------------|---------------|-----------|
| MTR250 | 345 | 24.5 | 14 | 0.480 |
| MTR400 | 506 | 24.5 | 14 | 0.730 |

Mobile Magnetic Tool Rack

- Simple and neat way to store tools in multi-locations
- Magnetic both sides for simple attachment to tool cabinets or other steel surfaces.
- Can be used to carry tools between locations



| Product Number | Overall Length mm | Body Width mm | Body Depth mm | Weight kg |
|----------------|-------------------|---------------|---------------|-----------|
| MTR250M | 305 | 50 | 14 | 0.570 |

Workshop Tools

Magnetic Trays

- Perfect for secure holding small metal parts and tools
- Magnetic both sides - can be used horizontally, vertically or even upside down
- Features rubber scratch guard to protect location surface
- Suitable for automotive mechanics, limited access repairs and general workshop
- Premium quality stainless steel finish
- Several size options available (see below)

Magnetic Trays Round

| Product Number | Diameter mm | Overall Height mm | Bowl Depth mm | Weight kg |
|----------------|-------------|-------------------|---------------|-----------|
| E634 (MT100)* | 107 | 32 | 19 | 0.160 |
| E633 (MT150)* | 150 | 36 | 22 | 0.290 |



*New product code coming soon

Magnetic Trays Rectangular

| Product Number | Length mm | Width mm | Overall Height mm | Bowl Depth mm | Weight kg |
|----------------|-----------|----------|-------------------|---------------|-----------|
| MT2414 | 237 | 136 | 42 | 28 | 0.600 |
| MT3616 | 358 | 160 | 38 | 23 | 0.930 |



Magnetic Tray Square

| Product Number | Length mm | Width mm | Overall Height mm | Bowl Depth mm | Weight kg |
|----------------|-----------|----------|-------------------|---------------|-----------|
| MT2927 | 292 | 270 | 38 | 26 | 1.250 |



Workshop Tools

Magnetic Wristband

- Effectively provides you a “third hand”
- Great for storing small tools and screws while you work
- Adjustable strap allows a one size fits all
- Includes 10 strong magnets perfect for holding screws, nails, drill bits and other tools



| Product Number | Overall Length mm | Width mm | Weight kg |
|----------------|-------------------|----------|-----------|
| MWB157 | 330 | 90 | 0.070 |

Magnetiser / Demagnetiser

- A great addition to every toolbox!
- A convenient pocket-sized tool & housed in a strong plastic case
- Ideal for magnetising/demagnetising of small hand tools i.e. screwdrivers, hexagon keys etc
- EASY TO USE! Magnetises and demagnetises in seconds
- Demagnetises screwdriver tips prior to work on sensitive electronic components
- Corrosion-resistant with protective polymer shell
- 2 sizes available



MDT050



MDW100

| Product Number | Description | Length mm | Width mm | Depth mm | Weight kg |
|----------------|--------------------------------------|-----------|----------|----------|-----------|
| MDT050 | Magnetiser / Demagnetiser - Toolbox | 52 | 50 | 29 | 0.070 |
| MDW100 | Magnetiser / Demagnetiser - Workshop | 98 | 98 | 41 | 0.260 |

Magnetic Vice Jaws

- Powerful neodymium magnet material encased in polyurethane
- Secure round and irregular workpieces without damage or distortion

| Product Number | Length mm | Height mm | Width mm | Weight Per Pair kg |
|----------------|-----------|-----------|----------|--------------------|
| EM983-R | 103 | 32 | 31 | 0.13 |



Workshop Tools

Magnetic Vice Jaws

- Rubber magnetic jaws securely holds your workpiece without damaging or marking surface
- Ideal for jewellery makers, gripping objects, holding wood, metals and tubing



| Product Number | Length mm | Width mm | Height mm | Weight kg |
|----------------|-----------|----------|-----------|-----------|
| MVJ/4 | 113 | 25 | 28 | 0.14 |
| MVJ/6 | 156 | 25 | 28 | 0.18 |

Sheet Floaters

- Sheet separators use magnetic repulsion to separate sheets in a stack so they can be removed more easily
- Sold in pairs

| Product Number | Width mm | Height mm | Depth mm | Mounting Hole Size | Weight Per Pair kg |
|----------------|----------|-----------|----------|--------------------|--------------------|
| E913 | 73 | 76 | 65 | M8 | 1.40 |
| E914 | 92 | 102 | 76 | M8 | 3.10 |
| E915 | 113 | 152 | 89 | M10 | 6.75 |



Holding Magnet with Eyelet

- Designed to retrieve and hold flat steel surfaces, nails, hand tools and other ferrous items on contact
- Magnet assembly made of ceramic (ferrite) magnets and steel enclosed with durable red plastic and black rubber
- Eyebolt can be added on the top or side of magnet and used to hold, lift and hang objects



| Product Number | Length mm | Width mm | Overall Height (Excluding Bolt) mm | Weight kg | Pull Force kg |
|----------------|-----------|----------|------------------------------------|-----------|---------------|
| HM6460 | 64 | 60 | 32 | 0.34 | 45 |

Workshop Tools

WORKSHOP

Table-top Demagnetiser

- Lightweight unit for the removal of residual magnetism from components after workholding
- CE Approved
- Max Usage: 2 mins in any 4 minute period



| Product Number | Voltage mm | Width mm | Height mm | Depth mm | Weight kg |
|----------------|------------|----------|-----------|----------|-----------|
| DA955/UK | 240 | 150 | 117 | 87 | 3.83 |
| DA955/EUR | 220 | 150 | 117 | 87 | 3.83 |
| DB956/EUR | 110 | 150 | 117 | 87 | 3.83 |

Pole Indicator

- Shows the true north or true south pole of magnets
- Pocket sized
- Battery powered - Includes 4 x 1.5v batteries



| Product Number | Length mm | Width mm | Thickness mm | Weight kg |
|----------------|-----------|----------|--------------|-----------|
| MPI/100 | 132 | 22 | 19 | 0.11 |

Gauss Meter

- Digital hand held Gauss meter for checking magnetic flux
- GMET/1 Supplied with 1 Transverse Probe (TX), Case and battery (PP3)
- GMET/2 Supplied with 2 Transverse Probes (TX), Case and battery (PP3)
- Axial Probe available upon request
- Measurement units: Gauss, Tesla, Oersteds, Ampere meters



Measuring Range Settings

- 1 - 1 to 3000 Gauss (0.0001 to 0.3 Tesla) Resolution - 1 Gauss
- 2 - 10 to 30,000 Gauss (0.001 to 3 Tesla) Resolution - 10 Gauss
- Auto: Automatically measures between settings 1 and 2
- +/- 15mT on/off hysteresis

| Product Number | Weight kg |
|----------------|-----------|
| GMET/1 | 0.5 |
| GMET/2 | 0.5 |

Mounting/Measurement

Flexible Inspection Lamp

- Switchable lamp with magnifying glass for close inspection or intricate, detailed work
- Ideal for use in quality inspection, model making, precision finishing
- 10 x magnification factor allows you to work with confidence
- Features flexible support arm for adjusting angle/direction
- Can be supplied with or without compatible Magnetic Bases



FILSMB/UK



FIL

Inspection Lamp

| Product Number | Metal Tube mm | Head Diameter mm | Glass Lens Diameter mm | Cable Length mm | Screw Thread mm | Weight kg |
|----------------|---------------|------------------|------------------------|-----------------|-----------------|-----------|
| FIL | 400 x ø15 | 150 | 125 | 1.2 | M8 | 0.940 |

Adapter

| Product Number | Description |
|----------------|--------------------------------|
| FIL/UKP | USB Power Adapter DC5V 1A (UK) |
| FIL/EUP | USB Power Adapter DC5V 1A (EU) |



FIL/EUP

FIL/UKP

With a Base and Adapter

| Product Number | Description | Weight kg |
|----------------|--|-----------|
| FILSMB/UK | Flexible Inspection Lamp Switchable Magnetic Base UK | 2 |
| FILSMB/EU | Flexible Inspection Lamp Switchable Magnetic Base EU | 2 |

Flexible Lamp Permanent Magnetic Base Large

- LED flexible lamp
- Flexible and adjustable body
- Practical magnetic base
- Portable
- Zoom IN/OUT
- ON/OFF button (2 brightness settings)



| Product Number | Neck Size mm | Head Diameter mm | Grip Size mm | Magnetic Diameter mm | Battery | Weight kg | Power Rating | LED |
|----------------|--------------|------------------|--------------|----------------------|------------|-----------|--------------|-----|
| FLMBL | 450 x ø7.8 | 20 | 70 x ø27.5 | 30 | 3pcs x AAA | 0.245 | 3W | 1pc |

Mounting/Measurement

WORKSHOP

Flexible Lamp

- Switchable lamp for assembly, close inspection or work-bench lighting
- Provides “hands-free” lighting in restricted access areas
- Features 30° Beam Angle with 130 lumen light (6400K)
- Adjustable “gooseneck” gives full flexibility to direct light onto work area
- Can be supplied with or without compatible Magnetic Bases

Inspection Lamp

| Product Number | Metal Tube mm | Head Diameter mm | Glass Lens Diameter mm | Cable Length mm | Screw Thread mm | Weight kg |
|----------------|---------------|------------------|------------------------|-----------------|-----------------|-----------|
| FL | 600 x ø11 | 50 | 33.5 | 1.2 | M8 | 0.500 |

Adapter

| Product Number | Description |
|----------------|---------------------------------|
| FL/UKP | Power Adapter DC3.3V 600mA (UK) |
| FL/EUP | Power Adapter DC3.3V 600mA (EU) |

With a Base and Adapter

| Product Number | Description | Weight kg |
|----------------|---|-----------|
| FLSMB/UK | Flexible Lamp Switchable Magnetic Base UK | 1.7 |
| FLSMB/EU | Flexible Lamp Switchable Magnetic Base EU | 1.7 |



Flexible Lamp Magnetic Base Compact

- The perfect addition to any tool kit
- Zoom in and out
- ON/OFF switch
- Illuminates hard to access areas
- Can be easily attached to any steel surface e.g machine, racking, casings
- Flexible arm allows easy positioning and adjustment
- Also sold in a pack of 12 (FLMBC/POSPACK)



| Product Number | Length mm | Magnet Diameter mm | Outer Diameter mm | Weight kg | Pull Force kg | Battery |
|----------------|-----------|--------------------|-------------------|-----------|---------------|----------|
| FLMBC | 257 | 10 | 12.64 | 0.04 | 1.5 | LR41 x 3 |
| FLMBC/POSPACK | | | | | | |





Did you know?

"Studies suggest that animals & birds use the Earth's magnetic field to navigate"





WELDING

Work Smart with Magnetic Welding Tools

By applying over 100 years of magnetic expertise we have revolutionised traditional methods of clamping during welding, soldering, brazing and assembly processes, gluing and pipe installation.

Our magnetic welding aids provide a fast, secure, accurate alternative which improves efficiency and productivity. With models to suit a variety of securing angles, workpiece sizes and profile, they deliver key benefits over traditional clamping methods:-

- **Speed & Simplicity** – fast, easy set-up, no manual clamps or mounting holes
- **Precision** – switchable models allow precise adjustment
- **Safe** – high strength magnets ensure secure “non-slip” location
- **Versatile** – models available for multi-angles
- **Access** – minimal single face contact allows full access to the workpiece
- **Durability** – minimal maintenance, simple wipe down cleaning

Typical use

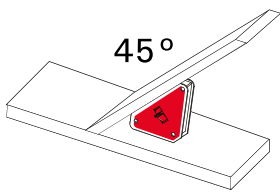

45°

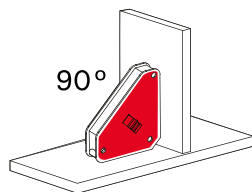

90°

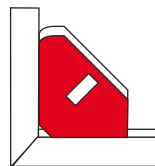

Square tubing

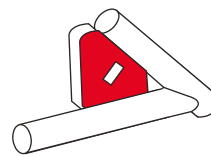

Round tubing

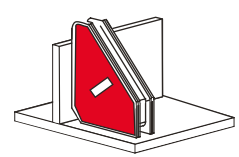

Metal plates

Welding

(≤18.00")

400K
(880)

Magnetic Switchable Welding Aids

Quick Holding Clamp Switchable

- Features ON/OFF switches
- The fast & easy way to hold metal workpieces at 45°, 90°
- Turn the magnet OFF or at the midpoint position when setting up, turn ON when you're ready to work
- Fast and safe set-up!
- Ideal for round and square tubing, angle, and flat stock
- Simple wipe clean design



| Product Number | Angles | Dimensions mm | Weight kg | Pull Force* kg |
|----------------|----------|----------------|-----------|----------------|
| QHCSS | 45°, 90° | 111 x 95 x 29 | 0.7 | 40 |
| QHCSL | 45°, 90° | 152 x 130 x 35 | 1.4 | 75 |

* Magnetic force is based on the longest side of magnet with 10mm thick steel.

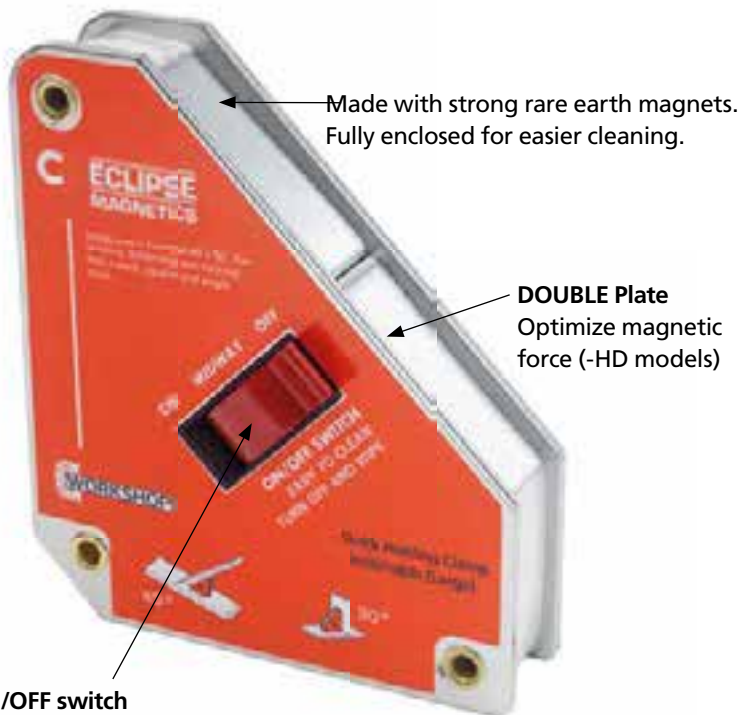

Made with strong rare earth magnets. Fully enclosed for easier cleaning.

DOUBLE Plate
Optimize magnetic force (-HD models)



The ON/OFF switch
Mid point switch position: for alignment / easy part placement.

NOTE: Must be used for tack welding only and removed before completing weld. Avoid prolonged exposure of magnetic products to heat sources of 356°F / 180°

WELDING

Magnetic Switchable Welding Aids

90° Fixed Welding Clamps Switchable

- Convenience of ON/OFF switches
- Two ON/OFF switches for independent operation
- **Easy and safe set-up!**
- Machined flat and V-surfaces are ideal for round and square tubing, angle, and flat stock
- Heavy duty construction



| Product Number | Angles | Dimensions mm | Weight kg | Pull Force* kg |
|----------------|--------|----------------|-----------|----------------|
| FWCSS | 90° | 152 x 152 x 38 | 1.2 | 55 |
| FWCSL | 90° | 197 x 197 x 48 | 2.7 | 120 |

*Magnetic force is based on 10mm thick steel.

Inside and Outside Welding Clamps

- Hold and position sheet metal, round pipes, square, angled or flat stock
- The Inside and Outside Welding Clamps are constructed from two independent rectangular magnets for consistent, undiminished magnetic force when both sides are attached to workpieces
- Use mounting holes to link two magnets together for use as fixturing elements
- Use hex hole on magnet for breakaway leverage



| Product Number | Angles | Height mm | Width mm | Thickness mm | Weight kg | Pull Force kg |
|----------------|---------------|-----------|----------|--------------|-----------|---------------|
| IOWCC* | 30°, 60°, 90° | 75.5 | 52 | 14 | 0.13 | 9 |
| | 30°, 60°, 90° | 125 | 85 | 18 | 0.415 | 15 |
| IOWCL | 30°, 60°, 90° | 165 | 110 | 20 | 0.8 | 18 |

NOTE: Must be used for tack welding only and removed before completing weld. Avoid prolonged exposure of magnetic products to heat sources of 356°F / 180°

Magnetic Welding Aids

Variable Welding Clamp

- Fast accurate holding of ferrous sheets and tubes for welding and assembly work
- Variable from 25° to 280°

| Product Number | Angles | Length mm | Height mm | Width mm | Weight kg | Pull Force kg |
|----------------|----------|-----------|-----------|----------|-----------|---------------|
| E952 | 25°-280° | 195 | 200 | 11 | 0.49 | 20 |



Heavy Duty Variable Welding Clamp

- Clamps components during welding, fabrication and assembly
- Powerful 40kg clamping force, enables larger components to be clamped with ease

| Product Number | Angles | Length mm | Height mm | Width mm | Weight kg | Pull Force kg |
|----------------|---------|-----------|-----------|----------|-----------|---------------|
| E974 | 45°-90° | 140 | 140 | 35 | 1.40 | 40 |



90° Fixed Welding Clamps

- Two magnetic faces in a rigid 90° angle for jiggling on sheets, pipes and tubes
- A fast and cost effective means of clamping components rigid at 90° angles during fabrication, assembly and weld preparation applications



E971



E972

| Product Number | Angles | Length mm | Height mm | Width mm | Weight kg | Pull Force kg |
|----------------|--------|-----------|-----------|----------|-----------|---------------|
| E971 | 90° | 140 | 140 | 35 | 1.40 | 40 |
| E972 | 90° | 225 | 225 | 22 | 2.20 | 75 |
| E973 | 90° | 300 | 300 | 35 | 4.70 | 200 |



E973

WELDING

Magnetic Welding Aids

Quick Holding Clamps

- Fast and accurate holding of ferrous metals at different fixed angles
- Also suitable for retrieval applications



| Product Number | Angles | Length mm | Height mm | Width mm | Weight kg | Pull Force kg |
|----------------|-------------------------|-----------|-----------|----------|-----------|---------------|
| E951 | 30°, 45°, 60°, 75°, 90° | 100.5 | 65.5 | 12 | 0.3 | 10 |
| E953 | 30°, 45°, 60°, 75°, 90° | 100.5 | 65.5 | 20 | 0.4 | 15 |

Quick Holding Clamp Pack Set

- Cost effective, retail friendly pack of 4, easy to apply welding clamps



| Product Number | Angled | Length mm | Width mm | Depth mm | Net Weight kg | Pull Force kg | Units / Pack |
|----------------|-----------------|-----------|----------|-----------------------|---------------|---------------|--------------|
| QHPCS | 45°, 90° & 135° | 58.7 | 51.1 | 12.1 (13.7 at rivets) | 0.400 | 4 | 4 |

Mitre Clamps

- Effective and inexpensive method of clamping flat (923) or round (924) ferrous components

| Product Number | Angles | Length Base Face mm | Length Top Face mm | Height mm | Width mm | Weight kg | Pull Force kg |
|----------------|----------|---------------------|--------------------|-----------|----------|-----------|---------------|
| 923 | 45°, 90° | 156 | 66 | 45 | 43 | 1.36 | 100 |
| 924 | 45°, 90° | 184 | 94 | 45 | 43 | 1.64 | 68 |



Magnetic Welding Aids

Heavy Duty Welding Clamps

- Holds workpieces at an exact 45° or 90° angle to each other
- 10kg and 15kg of magnetic pull make these ideal for a range of workshop welding and applications

| Product Number | Angles | Depth mm | Height mm | Width mm | Weight kg | Pull Force kg |
|----------------|----------|----------|-----------|----------|-----------|---------------|
| E954 | 45°, 90° | 14 | 82 | 120 | 0.3 | 10 |
| E955 | 45°, 90° | 18 | 102 | 160 | 0.7 | 15 |



Holdfasts

- Supplied with screw release handle
- Can be built into workholding, handling and assembly fixtures to provide a high clamping force and positive grip

| Product Number | Diameter mm | Height mm | Fixing Holes PCD mm | Holes | Weight kg | Pull Force kg |
|----------------|-------------|-----------|---------------------|--------|-----------|---------------|
| E939 | 44.5 | 44.5 | 31.75 | 2 x M8 | 0.6 | 20 |
| E940 | 54.0 | 49.2 | 38.1 | 2 x M8 | 1.0 | 40 |
| E941 | 70.0 | 64.5 | 50.8 | 2 x M8 | 2.0 | 88 |
| E942 | 101.6 | 74.6 | 69.0 | 3 n/a | 4.7 | 183 |



Weld Holder

- Provides the welder with a powerful, rigid support on flat and round components at various angles during welding preparation applications

| Product Number | Length mm | Height mm | Width mm | Weight kg | Pull Force kg |
|----------------|-----------|-----------|----------|-----------|---------------|
| E925 | 108 | 140 | 108 | 5.67 | 100 |



Steel Plate Drag

- Used to remove steel sheets from a stack and transport sheets to and from machines
- Contains permanent ferrite magnets in an aluminium housing

| Product Number | Length mm | Height mm | Width mm | Weight kg | Pull Force kg |
|----------------|-----------|-----------|----------|-----------|---------------|
| E964 | 118 | 98 | 38 | 2.8 | 170 |



WELDING

Magnetic Welding Aids



Positioners

- 2 magnetic blocks connected by 2 non magnetic steel straps
- The blocks contain ferrite magnetic material
- Magnetic on 2 faces
- ON / OFF switch located at each end

| Product Number | Length mm | Height mm | Width mm | Weight kg | Pull On Flat Face kg | Pull On V Face kg |
|----------------|-----------|-----------|----------|-----------|----------------------|-------------------|
| 922 | 206 | 63.5 | 76 | 3.17 | 80 | 80 |
| 922SU | 63.5 | 63.5 | 51 | 1.48 | 80 | 80 |



Adjustable Links

- Ferrite magnetic material
- Clamp components at any angle for welding and assembly applications

| Product Number | Length mm | Height mm | Width mm | Weight kg | Pull Force kg |
|----------------|-----------|-----------|----------|-----------|---------------|
| 920SU (Single) | 60 | 25 | 29 | 0.35 | 12 |
| 920 (Pair) | 127 | 25 | 51 | 0.70 | 12 |



Adjustable Clamping Links

- Alnico magnetic material
- Clamp components at any angle for welding and assembly applications

| Product Number | Length mm | Height mm | Width mm | Weight kg | Pull Force kg |
|---------------------------|-----------|-----------|----------|-----------|---------------|
| 920SUOT (Original Single) | 60 | 25 | 25 | 0.32 | 12 |
| 920OTPR (Original Pair) | 127 | 25 | 48 | 0.70 | 12 |



Earth Welding Clamp

- Quick and easy earthing for most steel welding operations
- Provides earthing / ground on large welding operations where croc-clip or G-Clamps cannot be easily used

| Product Number | Width mm | Height mm | Length mm | Weight kg | Pull Force kg | Maximum Current amps |
|----------------|----------|-----------|-----------|-----------|---------------|----------------------|
| E946 | 90 | 64 | 193 | 1.6 | 25 | 800 |



Did you know?

"Magnets are present in many everyday items e.g. phones, TV's, Audio Equipment, Computers"





PRECISION

Work Smart, improve speed and accuracy with magnets.

Our Precision range drives business efficiencies by providing quick and easy set-up, whilst maintaining pinpoint accuracy. The range includes Magnetic Bases for mounting measuring and optical instruments, and Magnetic Chucks for machining operations.

Precision - Magnetic Bases

Applying magnetics makes precision measurement and inspection a simple, trouble-free process. Available with a variety of precision fitment arms, each base is supplied complete with a simple on/off mechanism for fast and accurate engagement.

Typical applications

- Dial test indicator securing
- Holding and positioning lights
- Mounting visual inspection instruments
- Mounting photographic equipment
- Mounting measuring equipment

Precision – Magnetic Workholding

Since making the world's first permanent magnetic chuck in 1934 we have remained at the forefront of workholding systems. We provide a range of high performance permanent magnetic chucks for grinding and other surface finishing applications.

Specifying an Eclipse Magnetics' chuck provides an array of advantages over traditional clamping and holding methods:-

- Faster set up, feed rates achievable
- Instant, single surface clamping
- Allows 5 face machining – minimal repositioning
- Failsafe – magnetic technology guarantees a secure hold
- 100% consistent clamping – across entire surface
- Eliminates vibration or "chatter"

Precision

(≤18.00")

400K
(880I

Workholding

Premier Range Chucks

Premier Range chucks provide precision performance and durability.

Eclipse Magnetics invented the first permanent magnet chuck in 1934 and we continue to set the benchmark for quality workholding with today's Premier Range.

Premier Range Chuck - Circular

- Unique top plate concentrates magnetic energy on to the chuck face
- The chucks can be partially magnetised to aid the correct positioning of the workpiece
- Grooved rings in the top plate assist in visual positioning to aid quick changeover
- Excellent for holding thin ring-shaped components that can be subject to radial distortion

| Product Number | A mm | B mm | C mm | D mm | E mm | F mm | G mm | Weight kg |
|----------------|------|------|-------|------|--------|------|-------|-----------|
| AX475C/P | 121 | 45 | 50.8 | 6.5 | 76.2 | M6 | 101.6 | 4.23 |
| AX651C/P | 167 | 60 | 76.22 | 6.5 | 101.6 | M10 | 139.7 | 9.66 |
| AX91C/P | 229 | 60 | 85.8 | 6.5 | 114.3 | M10 | 190.5 | 20 |
| AX12C/P | 305 | 72 | 152.4 | 4.75 | 184.15 | M12 | 254 | 45.5 |

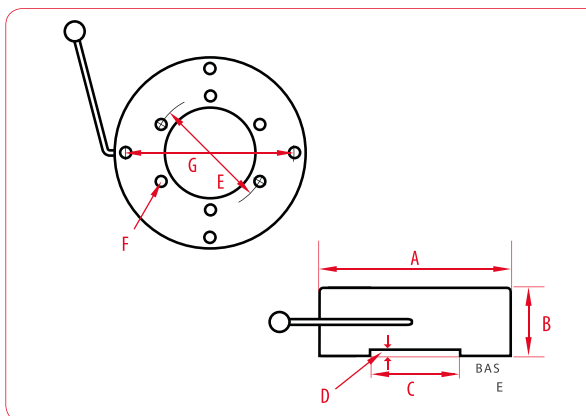

Workholding

PRECISION

Premier Range Chuck - Radial Pole

- Dynamically balanced to enable use at high RPM
- All metal top plate and a rugged industrial build ensures accuracy and longevity
- Through-bored (except NRC100C) allows through-flushing of coolant during machining
- Optional centre plug available

| Product Number | A mm | B mm | C mm | D mm | E mm | F mm | G mm | H mm | I mm | No. Of Poles | Weight kg |
|----------------|------|------|-------|-------|--------|------|-------|------|------|--------------|-----------|
| NR100C | 100 | 48 | 50.8 | 6.5 | N/A | M6 | 76 | N/A | N/A | 6 | 3.08 |
| NR150C | 150 | 69 | 76.2 | 4 | N/A | M10 | 102 | 32 | 36 | 10 | 8.79 |
| NR225C | 225 | 71 | 85.8 | 5 | 114.3 | M10 | 190.5 | 50 | 54 | 14 | 18.5 |
| NR300C | 300 | 71 | 152.4 | 54.75 | 184.15 | M12 | 354 | 62 | 66 | 18 | 40 |

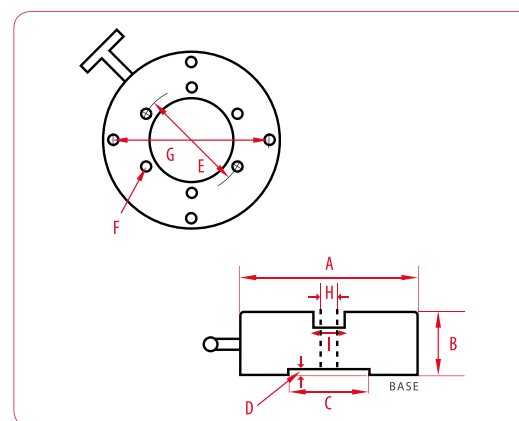

Premier Range Chuck - Rectangular

- Unique top plate concentrates magnetic energy on to the chuck face
- The all-metal top plate is extra thick to ensure accuracy after frequent re-grinding
- Chrome plated side and end stops for packing and positioning
- The chucks can be partially magnetised to allow part positioning
- Removable, ergonomically designed handles allow easy switching

| Product Number | Length mm | Height mm | Width mm | Pole Pitch | Weight kg |
|----------------|-----------|-----------|----------|------------|-----------|
| AX47/P | 203 | 42 | 127 | 17.6 | 8.2 |
| AX510/P | 276 | 53 | 129 | 35 | 16 |
| AXS612/P | 322 | 63 | 151 | 32 | 22 |
| AXS614/P | 360 | 63 | 151 | 32 | 22 |
| AXS618/P | 451 | 63 | 151 | 32 | 36 |
| AXM824/P | 601 | 63 | 201 | 35 | 56 |



Precision

Workholding

Standard Range Chucks

Standard Range chucks provide high performance at a competitive price

- Clamping force: 80N/cm² on test piece Steel ring 52mm Ø outer 38mm Ø inner, 10mm thick
- Brass and steel top plates
- All chucks are supplied with side and end stops, and with clamps
- Removable hexagon key handles ensure ease of operation through a 180 degree arc

Standard Pole

Pole Spacing: 4.0mm steel - 2.0mm brass
Effectively clamps all workpiece thicknesses down to 3mm



Fine Pole

Pole Spacing: 1.5mm steel - 0.5mm brass
Ideal for small workpieces less than 3mm in height

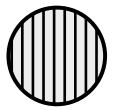

Standard Range Chucks - Circular

| Product Number | | A | B | C | D | E | F | G | Weight |
|----------------|---------|-----|----|-------|------|-------|-----|-------|--------|
| Standard | Fine | mm | mm | mm | mm | mm | mm | mm | kg |
| ECSP100 | ECFP100 | 100 | 50 | 50.8 | 6.35 | 76.2 | M6 | N/A | 6 |
| ECSP125 | ECFP125 | 125 | 50 | 50.8 | 6.35 | 76.2 | M6 | 101.6 | 9.38 |
| ECSP160 | ECFP160 | 160 | 50 | 76.2 | 6.35 | 101.6 | M10 | 139.7 | 13.50 |
| ECSP195 | ECFP195 | 195 | 50 | 76.2 | 6.35 | 101.6 | M10 | 139.7 | 18 |
| ECSP255 | ECFP255 | 255 | 50 | 85.7 | 6.35 | 114.3 | M10 | 190.5 | 22.50 |
| ECSP310 | ECFP310 | 310 | 50 | 152.4 | 6.35 | 184.1 | M12 | 254 | 32 |
| ECSP350 | ECFP350 | 350 | 50 | 196.8 | 6.35 | 234.9 | M12 | N/A | 40 |

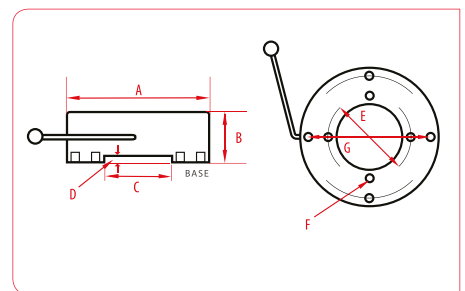

Standard Range Chucks - Rectangular

| Product Number | | Length | Width | Height | Weight |
|----------------|----------|--------|-------|--------|--------|
| Standard | Fine | mm | mm | mm | kg |
| ERSP1018 | ERFP1018 | 180 | 100 | 50 | 9.5 |
| ERSP1325 | ERFP1325 | 255 | 130 | 50 | 15 |
| ERSP1530 | ERFP1530 | 300 | 150 | 50 | 20.5 |
| ERSP1535 | ERFP1535 | 350 | 150 | 50 | 23.5 |
| ERSP1545 | ERFP1545 | 450 | 150 | 50 | 30 |
| ERSP2060 | ERFP2060 | 600 | 200 | 50 | 52 |



Workholding

PRECISION

Chuck Blocks

- Use to extend the flux paths of a magnetic chuck with parallel poles
- Can be machined to accommodate awkward workpieces

| Product Number | Length mm | Height mm | Width mm | Pole Direction kg | Weight kg |
|----------------|-----------|-----------|----------|-------------------|-----------|
| 950 | 60 | 30 | 75 | Longitudinal* | 2.4 |
| 950v | 50 | 40 | 100 | Longitudinal* | 2.4 |



*Along width

Simple Magnetic Sine Tables Short Lift

- Accuracy of sine table within (+/- 5 secs of arc)
- Pole spacing 2mm (1.5mm Steel 0.5mm Brass)
- Clamping force 80N/cm²

| Product Number | Chuck | Top Plate mm | | Base mm | | Height At Zero mm | Weight kg |
|----------------|----------|--------------|-------|---------|-------|-------------------|-----------|
| | | Length | Width | Length | Width | | |
| SSTFP1018 | ERFP1018 | 180 | 100 | 215 | 115 | 73 | 12 |
| SSTFP1325 | ERFP1325 | 255 | 130 | 295 | 195 | 78 | 24 |
| SSTFP1535 | ERFP1535 | 350 | 150 | 390 | 165 | 89 | 39 |



'V' Blocks

- 'V' blocks are ideal for holding cylindrical and complex workpieces for marking, spark erosion, grinding and measurement operations
- Can be used on its base, side or end

| Product Number | Width mm | Length mm | Height mm | Max diameter of workpiece | | Weight kg |
|---------------------------|----------|-----------|-----------|---------------------------|---------------|-----------|
| | | | | Top 'V' mm | Bottom 'V' mm | |
| 25 Micron Accuracy | | | | | | |
| E934 | 70 | 101.6 | 95 | 65 | 22 | 1.98 |
| E934MP | 70 | 101.6 | 95 | 65 | 22 | 3.96 |
| E935 | 70 | 80 | 95 | 65 | 22 | 3.12 |
| E935MP | 70 | 80 | 95 | 65 | 22 | 6.24 |
| 10 Micron Accuracy | | | | | | |
| E933A | 70 | 120 | 95 | 65 | 22 | 4.4 |
| E934MPA | 70 | 120 | 95 | 65 | 22 | 8.8 |
| E935A | 70 | 80 | 95 | 65 | 22 | 2.95 |
| E935MPA | 70 | 80 | 95 | 65 | 22 | 5.9 |



Precision

($\leq 18.00''$)

400K
(880I)

Mounting/Measurement

Custom Solutions in 3 Easy Steps

A customised Eclipse Magnetics magnetic base holding system can be constructed from our wide range of components.

Step 3 - Choose Power Supply



Step 2 - Choose Arm

Step 1 - Choose Base

Mounting/Measurement

PRECISION

Step 1 - Choose Base

| | | | | | | | | |
|-----------------------|-----------|------------|--------|--------|--------|------------|-----------|------------|
| Product Number | 834 | E905WF/50 | E900WF | E901WF | E905WF | E905WF/100 | E905WF/AF | E905WF/130 |
| Magnet | Permanent | Switchable | | | | | | |
| Hold kg | 14.75 | 50 | 30 | 80 | 80 | 100 | 50 | 130 |
| Screw Thread | M6 | | M8 | | | | | M10 |

Step 2 - Choose Arm

| | | | | | | | | | | | |
|-----------------------|----------|----------------------|--------|---------|---------|---------|------------------|------------------|----------|----------|----------------------|
| Product Number | RP909FIT | RP999S | RP72CP | RP991BL | RP995BL | RP901/1 | RP907S | RP999 | FL | FIL | RP999L |
| Clamp Hole mm | 8.0 | 6.0/8.0/ Dovetail | 8.0 | 4.5/8.0 | 4.5/8.0 | 6.5/8.0 | 8.0/ Dovetail | 8.0/ Dovetail | LED Lamp | LED Lamp | 6.0/8.0/ Dovetail |
| Screw Thread | M6 | | M8 | | | | | | | M10 | |

Step 3 - Choose Power Supply

| | | | | |
|-----------------------|---------|---------|---------|---------|
| Product Number | FL/UKP | FL/EUP | FIL/UKP | FIL/EUP |
| Plug Type | UK Plug | EU plug | UK Plug | EU Plug |
| To Fit | FL | | FIL | |



Alternative Option

| | |
|-----------------------|-------------|
| Product Number | FLTC |
| Plug Type | Table Clamp |
| To Fit | FL |



Bases

Magnetic Bases with Toggle Switch

- Toggle switched magnetic bases to hold Eclipse Magnetics fitments for inspecting workpieces
- Can be located on any ferrous surface to provide rigid support
- Magnetic on 3 sides
- Can clamp onto curved and flat surfaces



E905WF/50



E905WF/130

| Product Number | Length mm | Width mm | Height g | Screw Thread mm | Hold kg | Weight kg |
|----------------|-----------|----------|----------|-----------------|---------|-----------|
| E905WF/50 | 40 | 40 | 40 | M6 | 50 | 0.405 |
| E905WF | 65 | 50 | 55 | M8 | 80 | 0.960 |
| E905WF/100 | 75 | 50 | 55 | M8 | 100 | 1.200 |
| E905WF/130 | 117 | 50 | 55 | M10 | 130 | 1.900 |

Magnetic Bases with Push Button Switch

- Eclipse Magnetics bases can be attached to any ferrous surface to provide a rigid support
- 4 magnetic faces

| Product Number | Length mm | Width mm | Height mm | Screw Thread mm | Weight kg | Hold kg |
|----------------|-----------|----------|-----------|-----------------|-----------|---------|
| E900WF | 48 | 40 | 52 | M8 | 0.5 | 30 |
| E901WF | 64 | 64 | 76 | M8 | 1.70 | 80 |



Permanent Magnetic Base

| Product Number | Width mm | Height mm | Screw Thread mm | Hold kg | Weight kg | Pull Force kg | Units/ Pack |
|----------------|----------|-----------|-----------------|---------|-----------|---------------|-------------|
| 834 | 35 | 30 | M6 | 14.75 | 0.184 | 14.75 | 2 |



Switchable ANYFORM Magnetic Base

- Versatile, with adjustable base profile which allows use on any ferrous surface
- Ideal for irregular or uneven surfaces

| Product Number | Length mm | Width mm | Height mm | Thread Size | Weight kg | Hold kg |
|----------------|-----------|----------|-----------|-------------|-----------|---------|
| E905WF/AF | 91 | 30 | 55 | M8 | 0.88 | 50 |



Fitments

PRECISION

- Wide range of options for mounting components such measuring instruments and lighting
- Feature robust flexible arms with secure tightening/positioning
- Available with fine adjustment crossbar for precision measurement
- Complete with screw thread base for attaching to magnetic bases or direct to machine
- Flexible/snake arm version available

Light Duty

| Product Number | Pillar Height mm | Pillar Diameter mm | Crossbar Length mm | Crossbar Diameter mm | Screw Thread mm | Weight kg | Diameter of Clamp Hole mm |
|----------------|------------------|--------------------|--------------------|----------------------|-----------------|-----------|---------------------------|
| RP72CP | 185 | 12.5 | 150 | 6.3 | M8 | 0.358 | 8.0 |

With a Base

| Product Number | Base Part Number | Hold kg |
|----------------|------------------|---------|
| E903/CP | E900WF | 30 |



Heavy Duty with Fine Adjustment

| Product Number | Pillar Height mm | Pillar Diameter mm | Crossbar Length mm | Crossbar Diameter mm | Screw Thread mm | Weight kg | Diameter of Clamp Hole mm |
|----------------|------------------|--------------------|--------------------|----------------------|-----------------|-----------|---------------------------|
| RP991BL | 175 | 12 | 165 | 10 | M8 | 0.444 | 4.5/8.0 (with sleeve) |

With a Base

| Product Number | Base Part Number | Hold kg |
|----------------|------------------|---------|
| E901 | E901WF | 80 |
| E906 | E905WF | 80 |



Heavy Duty

| Product Number | Pillar Height mm | Pillar Diameter mm | Crossbar Length mm | Crossbar Diameter mm | Screw Thread mm | Weight kg | Diameter of Clamp Hole mm |
|----------------|------------------|--------------------|--------------------|----------------------|-----------------|-----------|---------------------------|
| RP995BL | 175 | 12 | 165 | 10 | M8 | 0.445 | 4.5/8.0 (with sleeve) |

With a Base

| Product Number | Base Part Number | Hold kg |
|----------------|------------------|---------|
| E908M | E900WF | 30 |
| E905 | E905WF | 80 |



Precision

(≤18.00")

400K
(880)

Fitments

Extra Large Heavy Duty

| Product Number | Pillar Height mm | Pillar Diameter mm | Crossbar Length mm | Crossbar Diameter mm | Screw Thread mm | Weight kg | Diameter of Clamp Hole mm |
|----------------|------------------|--------------------|--------------------|----------------------|-----------------|-----------|---------------------------|
| RP901/1 | 300 | 20 | 200 | 14 | M8 | 1.000 | 6.5/8.0 |

With a Base

| Product Number | Base Part Number | Hold kg |
|----------------|------------------|---------|
| E901/1 | E901WF | 80 |



E901/1



One Pillar

| Product Number | Pillar Height mm | Pillar Diameter mm | Screw Thread mm | Weight kg | Diameter of Clamp Hole mm |
|----------------|------------------|--------------------|-----------------|-----------|---------------------------|
| RP909FIT | 120 | 6 | M6 | 0.090 | 8.0 |

With a Base

| Product Number | Base Part Number | Hold kg |
|----------------|------------------|---------|
| E909 | 834 | 14 |



E909



Flexible Snake Arm Fine Adjustment

| Product Number | Maximum Extension mm | Screw Thread mm | Weight mm | Diameter of Clamp Hole mm |
|----------------|----------------------|-----------------|-----------|---------------------------|
| RP907S | 355 | M8 | 0.332 | 8.0/Dovetail |

With a Base

| Product Number | Base Part Number | Hold kg |
|----------------|------------------|---------|
| E907M | E905WF | 80 |



E907M



Fitments



PRECISION

Mechanical Fitment Stand (Small)

| Product Number | Maximum Extension mm | Screw Thread mm | Weight mm | Diameter of Clamp Hole mm |
|----------------|----------------------|-----------------|-----------|--------------------------------|
| RP999S | 162 | M6 | 0.175 | 6.0/8.0/Dovetail (with sleeve) |

With a Base

| Product Number | Base Part Number mm | Hold kg |
|----------------|---------------------|---------|
| E910S | E905WF/50 | 50 |



Mechanical Fitment Stand

| Product Number | Maximum Extension mm | Screw Thread mm | Weight mm | Diameter of Clamp Hole mm |
|----------------|----------------------|-----------------|-----------|---------------------------|
| RP999 | 295 | M8 | 0.272 | 8.0/Dovetail |

With a Base

| Product Number | Base Part Number | Hold kg |
|----------------|------------------|---------|
| E910 | E905WF | 80 |



Mechanical Fitment Stand (Extra Large)

| Product Number | Maximum Extension mm | Screw Thread mm | Weight mm | Diameter of Clamp Hole mm |
|----------------|----------------------|-----------------|-----------|---------------------------------|
| RP999L | 650 | M10 | 2.945 | 6.0/8.0/ Dovetail (with sleeve) |

With a Base

| Product Number | Base Part Number | Hold kg |
|----------------|------------------|---------|
| E910L | E905WF/130 | 130 |



Precision

Fitments LED Lamp

Flexible Lamp

- Switchable lamp for assembly, close inspection or work-bench lighting
- Provides "hands-free" lighting in restricted access areas
- Features 30° Beam Angle with 130 lumen light (6400K)
- Adjustable "gooseneck" gives full flexibility to direct light onto work area
- Can be supplied with or without compatible Magnetic Bases

| Product Number | Metal Tube mm | Head Diameter mm | Glass Lens Diameter mm | Cable Length mm | Screw Thread mm | Weight kg |
|----------------|------------------|---------------------|---------------------------|--------------------|--------------------|--------------|
| FL | 600 x ø11 | 50 | 33.5 | 1.2 | M8 | 0.500 |

Adapter

| Product Number | Description |
|----------------|---------------------------------|
| FL/UKP | Power Adapter DC3.3V 600mA (UK) |
| FL/EUP | Power Adapter DC3.3V 600mA (EU) |

With a Base and Adapter

| Product Number | Description | Weight kg |
|----------------|---|--------------|
| FLSMB/UK | Flexible Lamp Switchable Magnetic Base UK | 1.7 |
| FLSMB/EU | Flexible Lamp Switchable Magnetic Base EU | 1.7 |



Table Clamp

NB: ONLY suits Flexible Lamp FL.

| Product Number | Clamp Capacity mm | Screw Thread mm | Weight kg |
|----------------|----------------------|--------------------|--------------|
| FLTC | 0-55 Thickness | M10 | 0.0140 |



Fitment LED Lamp

PRECISION

Flexible Inspection Lamp

- Switchable lamp with magnifying glass for close inspection or intricate, detailed work
- Ideal for use in quality inspection, model making, precision finishing
- 10 x magnification factor allows you to work with confidence
- Features flexible support arm for adjusting angle/direction
- Can be supplied with or without compatible Magnetic Bases



| Product Number | Metal Tube mm | Head Diameter mm | Glass Lens Diameter mm | Cable Length mm | Screw Thread mm | Weight kg |
|----------------|------------------|---------------------|---------------------------|--------------------|--------------------|--------------|
| FIL | 400 x ø15 | 150 | 125 | 1.2 | M8 | 0.940 |

Adapter

| Product Number | Description |
|----------------|--------------------------------|
| FIL/UKP | USB Power Adapter DCSV 1A (UK) |
| FIL/EUP | USB Power Adapter DCSV 1A (EU) |



With a Base and Adapter

| Product Number | Description | Weight kg |
|----------------|--|--------------|
| FILSMB/UK | Flexible Inspection Lamp Switchable Magnetic Base UK | 2 |
| FILSMB/EU | Flexible Inspection Lamp Switchable Magnetic Base EU | 2 |



Did you know?

"When a magnet is cut into 2 pieces it will form 2 individual magnets"



Work Smart with our Magnetic Display Materials

We offer a range of simple magnetic solutions for fixing, holding or hanging display materials in retail and other commercial environments. These value adding options have been developed for maximum visual impact with easy/trouble free application and removal. The cost-effective range incorporates a variety of materials and innovative designs.

Typical Applications

- Retail Point-Of Sale
- Banner hanging
- Office/Workplace labelling
- Racking/Bay markers
- Vehicle livery/signage
- Notice board displays
- Exhibition graphic mounting
- Secondary glazing fitting
- Showroom signage
- Label holders

Display

(≤18.00")

400K
(880I

Magnetic Tape

- Material: Strontium ferrite in thermo-plastic binder
- Max operating temperature: 80°C
- Magnetic on 1 face only
- Can be cut with scissors

All supplied with standard acrylic adhesive. FM652, FM663, FM664, FM665 are also available with premium acrylic or foam adhesive.

| Product Number | Width mm | Thickness mm | Length m | Weight kg | Pull Force g/cm ² | Units / Pack |
|----------------|----------|--------------|----------|-----------|------------------------------|--------------|
| EM884-R | 13 | 0.5 | 1 | 0.027 | 28 | 1 |
| FM660 | 7.5 | 0.75 | 10 | 0.240 | 44 | 1 |
| FM661 | 12.5 | 0.75 | 10 | 0.390 | 44 | 1 |
| FM662 | 20 | 0.75 | 10 | 0.630 | 44 | 1 |
| FM652 | 10 | 1.5 | 30 | 1.7 | 55 | 1 |
| FM663 | 12.7 | 1.5 | 30 | 2.1 | 55 | 1 |
| FM664 | 20 | 1.5 | 30 | 3.3 | 55 | 1 |
| FM665 | 25.4 | 1.5 | 30 | 4.2 | 55 | 1 |



Steel Tape

- Adhesive-backed steel tape can be used with the matching width adhesive backed magnetic tape to provide temporary and semi-permanent fixings
- Supplied with standard acrylic adhesive.

| Product Number | Matching Magnetic Tape mm | Width mm | Thickness mm | Roll Length m | Weight kg | Units / Pack |
|----------------|---------------------------|----------|--------------|---------------|-----------|--------------|
| FM667 | FM663 | 13 | 0.2 | 30 | 0.8 | 1 |
| FM668 | FM664 | 20 | 0.2 | 30 | 1.2 | 1 |
| FM669 | FM665 | 25 | 0.2 | 30 | 1.5 | 1 |



Display

DISPLAY

Magnetic Extrusion

- Material: Strontium ferrite in thermo-plastic binder
- Max operating temperature: 80°C
- Magnetic on 1 face only
- Forms a strong bond when paired with itself

Please contact us if you require custom extruded profiles

| Product Number | Width mm | Thickness mm | Length m | Weight kg | Pull Force g/cm ² | Units / Pack |
|-------------------|----------|--------------|----------|-----------|------------------------------|--------------|
| EM888-R (Pairs) * | 9.5 | 3.6 | 0.15 | 0.021 | 65 | 1 Pair |
| EM880-R | 9.5 | 3.6 | 2 | 0.026 | 65 | 1 |
| FM670 | 9.5 | 3.6 | 10 | 1.44 | 65 | 1 |
| FM671 | 11 | 4.6 | 10 | 2.07 | 65 | 1 |
| FM672 | 15 | 6.4 | 10 | 3.64 | 65 | 1 |



*Adhesive Backed

Magnetic Sheet

- Max operating temperature: 80°C
- Magnetic on 1 face only
- UV Coating for cleaner handling.
- Flexible and impact resilient but can be easily cut with scissors
- Regular shapes can be cut using inexpensive dies

Available with plain, white gloss or standard acrylic adhesive backing. Coloured and dry wipe finishes available.

Please contact us for details.



| Product Number | Thickness mm | Width mm | Roll Length m | Weight kg | Pull Force g/cm ² | Finish |
|----------------|--------------|----------|---------------|-----------|------------------------------|-------------------|
| 060510A2 | 0.5 | 620 | 30 | 35 | 28 | Plain |
| 060710A2 | 0.75 | 620 | 30 | 53 | 44 | Plain |
| 060524A2 | 0.6 | 620 | 30 | 43 | 28 | Gloss Vinyl White |
| 060724A2 | 0.85 | 620 | 30 | 60 | 44 | Gloss Vinyl White |
| 060724D2 | 0.85 | 620 | 15 | 30 | 44 | Gloss Vinyl White |
| 060724X5 | 0.6 | 1000 | 10 | 23 | 28 | Gloss Vinyl White |
| 060724X4 | 0.85 | 1000 | 10 | 33 | 44 | Gloss Vinyl White |
| 060711A2 | 0.8 | 620 | 30 | 60 | 44 | Adhesive Backed |

| Product Number | Thickness mm | Width mm | Tile Length m | Weight kg | Pull Force g/cm ² | Finish | Units / pack |
|----------------|--------------|----------|---------------|-----------|------------------------------|----------|--------------|
| FM650 | 0.75 | 150 | 0.15 | 0.071 | 44 | Adhesive | 5 |

Display

(≤18.00")

400K
(880)

Labelling

3 ways to make your own custom magnetic labels:

- Print with laser printer or inkjet on to matt or gloss magnetic paper
- Apply self adhesive magnetic sheet to the back of labels, signs and graphics
- Write on dry-wipe flexible magnetic sheet



All materials are easily cut with scissors

| Product Number | Description | Application | Size | Thickness mm | Finish | Units / Pack |
|----------------|------------------------------|--------------------------------------|-----------------------|--------------|-----------------|--------------|
| FM651 | Magnetic paper | Laser / Inkjet Printing | A4 | 0.25 | White Matt | 10 |
| 060511D1 | Self adhesive magnetic sheet | Application to existing card / label | Business Card (85x55) | 0.6 | Adhesive Backed | 25 |
| 060711Y6 | Self adhesive magnetic sheet | Application to existing card / label | A4 | 0.8 | Adhesive Backed | 10 |
| 060510U14 | Dry wipe magnetic sheet | Dry-wipe marker | A4 | 0.6 | White Dry-Wipe | 10 |

Labelling Holders

- Temporary / permanent signage, identification
- Can be used on steel racking, cabinets, shelving or any magnetically receptive surface
- Complete with magnetic rubber, white card and cover



| Product Number | Width mm | Height mm | Units / Pack | Weight kg |
|----------------|----------|-----------|--------------|-----------|
| FM676/B | 100 | 25 | 50 | 1 |
| FM677/B | 100 | 30 | 50 | 1 |
| FM683 | 150 | 35 | 5 | 0.125 |

| Product Number | Roll Length m | Height mm | Units / Pack | Weight kg |
|----------------|---------------|-----------|--------------|-----------|
| FM674C | 50 | 15 | 1 | 7 |
| FM676C | 50 | 25 | 1 | 7 |
| FM677C | 50 | 30 | 1 | 7 |

Marker Magnets

- Magnet material in a coloured plastic shell
- Ideal for filing cabinets, fridge doors and noticeboards

| Diameter mm | Yellow | Blue | Red | White | Green | Black | Orange |
|-------------|---------|-----------|---------|---------|---------|-----------|---------|
| 20 | RM765/Y | RM765/BLU | RM765/R | RM765/W | RM765/G | RM765/BLK | RM765/O |
| 30 | RM768/Y | RM768/BLU | RM768/R | RM768/W | RM768/G | RM768/BLK | RM768/O |



Display

DISPLAY

Racking Strip & Bay Markers

- Sticks to all steel racking
- Dry-wipe surface - write on, wipe off
- Supplied in 10 metre rolls
- Thickness: 0.5mm



| Width mm | Yellow | Blue | Red | White | Green |
|----------|-------------|-------------|-------------|-------------|-------------|
| 20 | 060510U8/Y | 060510U8/B | 060510U8/R | 060510U8/W | 060510U8/G |
| 30 | 060510U9/Y | 060510U9/B | 060510U9/R | 060510U9/W | 060510U9/G |
| 50 | 060510U10/Y | 060510U10/B | 060510U10/R | 060510U10/W | 060510U10/G |
| 70 | 060510U11/Y | 060510U11/B | 060510U11/R | 060510U11/W | 060510U11/G |
| 90 | 060510U12/Y | 060510U12/B | 060510U12/R | 060510U12/W | 060510U12/G |

Ferrite Shallow Pots with Hooks

- Max. operating temperature: 120°C
- Mild steel pot painted white
- Ideal for retail or general display applications
- For hanging graphics, utensils, tools etc



| Product Number | Diameter mm | Height mm | Thickness mm | Thread | Weight g | Pull Force kg | Units / Pack |
|----------------|-------------|-----------|--------------|--------|----------|---------------|--------------|
| E879-RB | 25 | 8 | 34 | M4 | 27 | 4.0 | 1 |
| E880-RB | 32 | 8 | 34 | M4 | 34 | 8.0 | 1 |
| E881-RB | 36 | 8 | 34 | M4 | 38 | 10.0 | 1 |

Neodymium Shallow Pots with Hook

- Zinc plated body with threaded stem
- Maximum operating temperature of 80°C
- Used in point of sale



| Product Number | Diameter mm | Thickness* mm | Overall Height Inc. Hook mm | Thread mm | Weight g | Pull Force kg | Units / Pack |
|----------------|-------------|---------------|-----------------------------|-----------|----------|---------------|--------------|
| E1030/NEO | 10 | 4.5 | 15 | M3 | 4.5 | 2.5 | 20 |
| E1031/NEO | 13 | 4.5 | 15 | M3 | 7.5 | 6.0 | 20 |
| E1032/NEO | 16 | 4.5 | 20.5 | M4 | 13.2 | 9.5 | 20 |
| E1033/NEO | 20 | 6 | 22 | M4 | 16.5 | 14.0 | 10 |
| E1034/NEO | 25 | 7 | 23 | M4 | 34 | 20.0 | 10 |
| E1035/NEO | 32 | 7 | 30 | M5 | 48 | 35.0 | 5 |

(≤18.00")

400P
(880I

Let your business "Work Smart with Magnets"

Businesses around the world are benefiting from "Working Smart with Magnets". Our products are now widely used typical industries such as:-

Garage and Motor Repairs

Magnetic tools save time and stress in a variety of garage situations

- Tool and component storage and carrying
- Notice boards display
- Retrieving fixings, screws, tools from inaccessible places
- Attaching temporary signage – number plates etc
- Keeping floor spaces clean and safe
- Inspection light mounting
- Welding fixings
- Lifting large or heavy steel components



Retail

Magnets are widely used in retail as a versatile option for ease of application/ removal:-

- Ceiling magnets for hanging banners
- Notice board display
- Mounting wall signage for easy application/removal
- Graphics applied to curved surfaces
- Wall mounted product hangers
- Shelf/racking labelling
- Shopfitter tool storage





Electrical

Magnetic products are often the answer for specialist electrical applications

- OEM design projects – motors, locking systems
- Cable management
- Tool and component storage and carrying
- Retrieving items from wall cavities or under flooring
- Light source in dark areas
- Mounting inspection or lighting equipment



Warehouse/Distribution Centres

Magnetic products offer a quick and easy solution for any of the following:-

- Notice board and planner displays
- Removable racking bay markers
- Retrieving lost items from inaccessible places
- Keeping vehicle bays and car parks free from sharp ferrous items
- Maintenance tool storage
- Attaching temporary vehicle signage



Guide to Magnet Materials

When choosing a magnet material for an application you should take the following factors into consideration:

- Flux requirement of the application
- Maximum operating temperature
- Likely exposure to corrosive conditions
- Magnetic stability
- Size and weight limitations

What strength/flux of magnet do you need?

This table shows the comparative magnetic strengths of the same volume of the four main magnet materials in terms of their maximum energy products (BH_{max}) in CGS or SI units and their typical pole face flux densities.

Neodymium is the most powerful magnet material available. It is ideal for applications where high flux density is required or where space is at a premium.

| Magnet Material | Max Energy Product: CGS | Max Energy Product: SI | Flux Density |
|-----------------|-------------------------|------------------------|--------------|
| Ferrite | 3.3 MGOe | 26 KJ/m ³ | 1000 Gauss |
| Alnico | 5.2 MGOe | 42 KJ/m ³ | 1300 Gauss |
| Samarium Cobalt | 26 MGOe | 208 KJ/m ³ | 3500 Gauss |
| Neodymium | 35 MGOe | 279 KJ/m ³ | 4500 Gauss |

What temperature will the magnet be operating in?

In most applications, operating temperature is not a consideration but extreme temperatures will have an effect on the magnetic performance.

Each material has different temperature characteristics and these must be reviewed to ensure that the correct material is used for the application. Using the wrong material could lead to loss in magnetic performance.

| Magnet Material | Max Working Temperature °C | Effects of Sub Zero Temperature °C | Reversible Effect of Temp: 20°C - 150°C |
|-----------------|----------------------------|---|---|
| Ferrite | 250 | Large irreversible losses below -60°C | -0.19% per °C |
| Alnico | 550 | Permanent losses no more than 10% expected down to -269°C | -0.02% per °C |
| Samarium Cobalt | 300 | Minimal losses down to -269°C | -0.003% per °C |
| Neodymium | 80* | No irreversible losses down to -196°C | -0.12% per °C |

*N35 grade. Other grades available up to 230°C

Other Factors To Consider

Corrosion

Another potential cause of performance loss is a breakdown of the magnet's composition due to corrosive environmental effects. This table shows relative corrosive resistance for each material when uncoated. As neodymium's corrosive resistance is poor it is usually sold with a protective coating, normally either nickel or zinc.

External Demagnetising Fields / Magnet Stability

Temperature has the greatest effect on magnet stability but high external magnetic fields can influence performance. This table shows the relative demagnetising effect on each material.

| Magnet Material | Corrosion Resistance Uncoated | Resistance To Demagnetisation |
|-----------------|-------------------------------|-------------------------------|
| Ferrite | Excellent | High |
| Alnico | Fair | Low |
| Samarium Cobalt | Excellent | Very High |
| Neodymium | Poor | Very High |

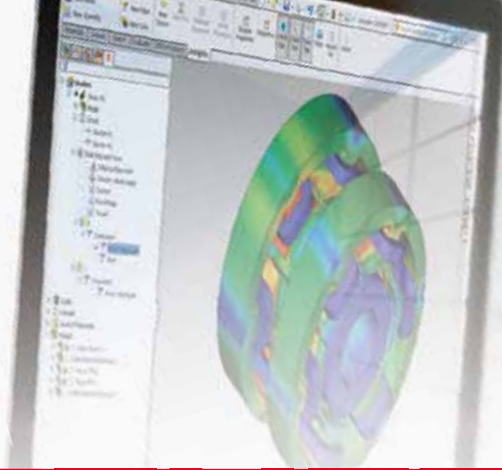

Magnetic field flowing across an air gap?

Single pole operation (bar, block, disc and ring magnet)

When a depth of field is required for attracting, switching or actuating across an air gap, use a single piece of magnet.

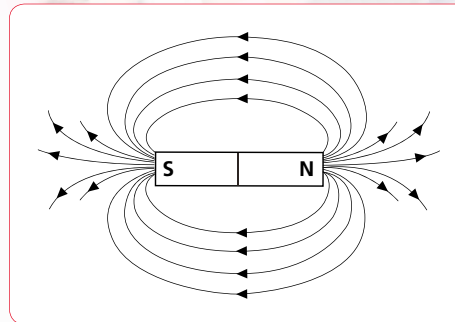

Single pole operation magnet flux crosses a gap but has a diminishing strength field.

Pot Magnets

Both north and south pole are on one face of the magnet, similar to button and horseshoe magnets.

The magnetic material is encased inside a steel pot. The pot is part of the magnetic circuit. The poles are concentric.

The depth of the magnetic field is shallower than that of magnets with poles further apart, e.g. horseshoe magnets, but grip in intimate contact is generally superior.

Maximum operating temperature of pots is lower than the magnet material used because of the different thermal expansion rates of the material and the pot. Exposure to temperatures higher than the recommended maximum can cause units to come apart.

Button Magnet

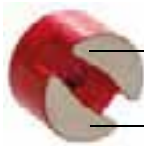

North Pole

South Pole

Horseshoe Magnet



North Pole

South Pole

Other Features

- No stray flux as magnetism is retained in a closed circuit
- Pot screens magnet material from demagnetising effects
- Pot is machinable
- Can be inserted into steel without adverse effects (not the case with unscreened magnets)

Clamping, Holding or Lifting

- Two pole operation (Horseshoe, button or pot magnet)
- Two pole or multi-pole magnets are designed for holding, clamping or lifting when in direct contact with a ferro-magnetic surface.

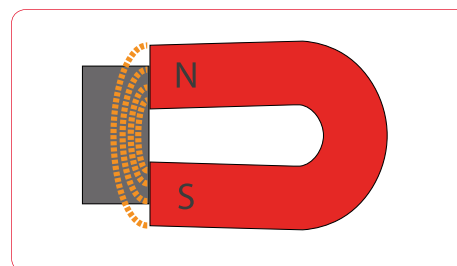

Two pole operation magnet flux does not travel as far but is stronger

Please note, this guide provides general information only.
For specific information on bespoke products or applications please contact us on +44 (0)114 225 0600

Customised Magnetic Solutions

If you cannot find a product in this catalogue suitable for your application, we can work with you to provide a customised solution.*

From Stage 1 To Project Completion

Many businesses are looking to add a competitive edge to their products or manufacturing processes. With our facilities and expertise we can tackle the most challenging of bespoke applications. We work closely with customers to understand their application, then to design, develop and produce a customised magnetic assembly.

Application Consultation

Our team can visit your site to understand the application and give advice.

Design & Prototyping

Using the latest software, our design team provide 3D designs, 3D FEA and trial prototypes.

Magnet Fabrication

Customised manufacture in a range of materials to customer specifications of shape, size, housings and magnetic intensity.

Magnet Stabilisation

For applications where consistent performance is critical we can ensure that magnet flux values are stabilised

Rotor Balancing

Ensures total concentricity for rotating magnet applications.

Machining Facilities

Micron accurate internal and external grinding facilities ensure that customised magnets are produced to high precision specifications.

Choice of Materials

We can offer the complete range of magnet materials to suit different application and operating conditions.

*Subject to quantities



Contact Us

If you have a project you would like to discuss, please contact us via:

+44 (0)114 225 0600

+44 (0)114 225 0610

www.eclipsemagnetics.com

info@eclipsemagnetics.com

Eclipse Magnetics Ltd

Atlas Way, Sheffield, S4 7QQ, England



Eclipse Magnetics Worldwide

Europe

Atlas Way
Sheffield
S4 7QQ
England

T +44 (0)114 225 0600
F +44 (0)114 225 0610
sales@eclipsemagnetics.com

Americas

442 Millen Road, Unit 9,
Stoney Creek
Ontario, L8E 6H2,
Canada

T +1 905-664-5585
F +1 905-664-7090
sales@eclipsetoolsinc.com

China

No. 168 Chengjian Road
Minhang District
Shanghai
PR China

T +86 21 6434 8600 *150
F +86 21 6434 6488
szhou@eclipsemagnetics.com

Australia

PO BOX 4400
Dandenong South
Victoria 3175
Australia

T +613 8792-9999
F +613 8792-9900
sales@spear-and-jackson.com.au

Representative:

www.eclipsemagnetics.com

Eclipse Magnetics Ltd

Atlas Way, Sheffield, S4 7QQ, England

☎ +44 (0)114 225 0600

📠 +44 (0)114 225 0610

🔍 www.eclipsemagnetics.com

✉ info@eclipsemagnetics.com

While every effort has been made to ensure the accuracy of the information within this publication, please note that specifications may change without notice.