

Cutting Tools

Cable Cutter - *For copper and aluminum cables only. Extremely high cutting capacity with adjustable screw joint.*



⚡1000V ⚡PE ⚡GS



⚡1000V ⚡PE ⚡GS

Part No	Type	for cable			Length mm	Std. Pk.
		Ømm	mm ²	AWG		
AP1017	N	15	50	1/0	160	15
1602 160	2K	15	50	1/0	160	15

Part No	Type	for cable			Length mm	Std. Pk.
		Ømm	mm ²	AWG		
AP1024	N	22	70	3/0	200	10
1602 200	2K	22	70	3/0	200	10

Special Electricians Scissors

Insulated Scissors

Small cutting nipper for sealing wires



Comfortable gripping with high cutting performance.



Handles made with shock-proof plastic.

⚡1000V ⚡PE ⚡GS



With safety spring for cutting wires.

Part No.	Length mm	Blade shape	Std. Pk.
16011	140	straight	15

Part No.	Type	Length mm	Blade shape	Std. Pk.
AV6720	N	180	straight	15
16031	2K	180	straight	15

Part No.	Length mm	Std. Pk.
AP0714	150	10

Wire Stripper

Cable Stripper

Cable Stripper



Adjusting screw for cables from 0.75 to 6mm², 18-10 AWG.

⚡1000V ⚡Ⓢ



For cables and cords with PVC-insulation. Cut without fraying / self-regulating.



For cables and cords. Made with shock-proof plastic.

Part No.	Type	for cable mm ²	for cable AWG	Length mm	Std. Pk.
AP0916N	N	0.75 - 6	18 - 10	160	15
1105 160	2K	0.75 - 6	18 - 10	160	15

Part No.	for cable mm ²	for cable AWG	Length mm	Std. Pk.
AV8210	0.08 - 6	28 - 10	205	1

Part No.	for cable mm ²	for cable AWG	Length mm	Std. Pk.
AV8203	6 - 16	8 - 6	170	1

Cable Stripper

Cable Stripper



Plastic handle



For all types of insulations.

Part No.	Outer Ø cable mm	Length mm	Std. Pk.
AV3801	8 - 28	135	1

Interchangeable blade for above

AV3899	8 - 28	1
--------	--------	---

Part No.	Outer Ø cable mm	Length mm	Std. Pk.
AV3810	4.5 - 29	138	1

Interchangeable blade for above

AV3819	4.5 - 29	1
--------	----------	---

Crimping Tools

Universal Ferrule Crimper

Front Conductor Entry

One die crimps a wide range of insulated and uninsulated ferrule sizes. Three Universal Ferrule Crimpers are offered to crimp different ferrule and wire size ranges up to 16mm² (6 AWG).

- Positive ratcheting with spring return
- Trapezoidal crimp geometry
- Comfort grip plastic handle
- Hardened steel frame, matte black

Universal Ferrule Crimper



Part No.	Wire/ AWG	Ferrule mm ²	Std. Pk.
E110.000	26 - 10	0.14 - 6	1

Universal Ferrule Crimper



Part No.	Wire/ AWG	Ferrule mm ²	Std. Pk.
E110.005	14 - 8	2.5 - 10	1

Universal Ferrule Crimper



Part No.	Wire/ AWG	Ferrule mm ²	Std. Pk.
E110.010	8 - 6	10 - 16	1

Ferrule Crimper

Side Conductor Entry

Individual crimp cavities conform to industry standard insulated and uninsulated ferrules from 25-50mm² (4-1 AWG).

- Positive ratcheting with spring return
- Emergency release
- Trapezoidal crimp geometry
- Comfort grip plastic handle
- Hardened steel frame, matte black

Ferrule Crimper



Part No.	Wire/ AWG	Ferrule mm ²	Std. Pk.
E110.015	4 - 2	25 - 35	1

Ferrule Crimper



Part No.	Wire/ AWG	Ferrule mm ²	Std. Pk.
E110.020	1	50	1

Ferrule Crimper

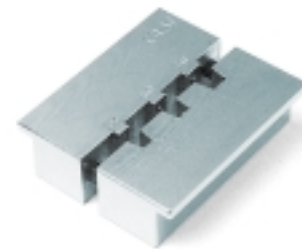

Part No.	Wire/ AWG	Ferrule mm ²	Std. Pk.
22.030	2/0-250 MCM	70 - 150	1

PNEUMATIC CRIMPING TOOLS

Altech's pneumatic crimping tools speed the crimping process of insulated or uninsulated ferrules for a wide range of wire sizes up to 8 AWG.

Altech pneumatic crimpers are simple and easy to use. Just install the ferrule over the end of the stripped wire and insert it into either the front or side tool opening. Then touch the actuating lever or push the footswitch pedal to initiate the crimp cycle. Once the head closes it will automatically reopen after crimping. The resulting crimp features a compact trapezoidal cross section which is mechanically very strong and provides a large surface to insure a highly efficient electrical contact.

Crimp ferrules efficiently and economically. A unique dual crimping head provides convenient front or side wire entry, allowing crimping from multiple positions. This feature makes crimping in tight places simple.

Choose either lever actuated, hand held units or hands-free footswitch operated table top models, in two basic tool sizes. Hand held models feature a flexible coil air-hose with 1/4" NPT interchange connector for quick hook-up with a standard push-to-connect coupler.

The table top units also include a flexible coil air hose to the footswitch and a 1/4" NPT interchange located on the footswitch for one hand push-to-connect supply hook-up. They feature a sturdy metal base with integral table clamp and dual storage trays for quick access to the ferrule supply. The air release port on the footswitch has been quieted with a sintered bronze air silencer. The footswitch has a metal frame and a tough fiberglass shroud. Its' spring return pedal provides for short actuating cycles.

Optional items for the hand held crimper include a counterbalance for maximum control and a magnetic holder for storage.

- Operates on 60 - 90 psi air supply
- Crimp insulated and uninsulated ferrules
- Trapezoidal crimp geometry
- Flexible coil air hose with 1/4" NPT interchange
- Metal tool body and base
- Hardened steel crimp head



Tool	Wire/ Ferrule Size AWG mm ²	Type	Cat. No.	Tool Wt. g (lbs.)	Std. Pk.
Hand Held Crimper with Actuating Lever Crimp Insulated Ferrules and Uninsulated Ferrules	24-14	ACT2.5-P 0.25-2.5	22.014	430 (.95)	1
Hand Held Crimper with Actuating Lever Crimp Insulated Ferrules and Uninsulated Ferrules	12-8	ACT10-P 4.0-10.0	22.015	430 (.95)	1
Table Top Crimper with Footswitch and Storage Trays Crimp Insulated Ferrules and Uninsulated Ferrules	24-14	ACT2.5-T 0.25-2.5	22.016	1000 (2.20)	1
Table Top Crimper with Footswitch and Storage Trays Crimp Insulated Ferrules and Uninsulated Ferrules	12-8	ACT10-P 4.0-10.0	22.017	1000 (2.20)	1
Magnetic Mounting Holder <i>for hand held pneumatic crimpers</i>		ACT-DXP	22.018	---	1
Counterbalance <i>for hand held pneumatic crimpers</i>		CT-DUP	22.019	---	1

FERRULES, INSULATED Industry Standard

INDUSTRY STANDARD FERRULES

Ferrules insure reliable electrical connections when terminating stranded flexible wire in terminal blocks, circuit breakers or other control devices. Insulated ferrules prevent conductor breakage due to bending, wire stress or vibration while facilitating wire insertion into the terminal clamp.

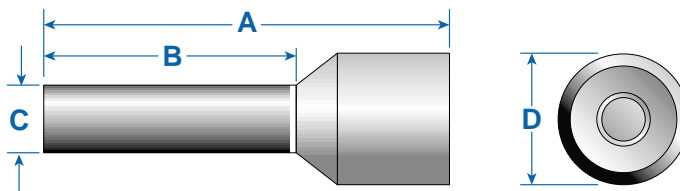

Altech's standard insulated ferrules are color coded by conductor size for convenient identification.

To ensure efficient ferrule crimping, always select the smallest ferrule diameter that fits the wire and use only professional crimping tools. (Please refer to the ordering pages and the Crimper Selector Guide on pages 58-61.)

- Sleeve: polypropylene
- Tube: tin-plated copper

	AWG (mm ²)	Color	Type	Cat. No.	Stripping Length mm (in.)	Ferrule Dimensions mm (in.)				Std. Pk.*
						A	B	C	D	
	24 (.25)	Lt. Blue	HI 0.25/10	2620.0	6.0(.24)	10.0 (.39)	6.0 (.24)	1.2 (.05)	2.3 (.09)	500/100
	24 (.25)	Lt. Blue	HI 0.25/12	2621.0	8.0(.31)	12.0 (.47)	8.0 (.31)	1.2 (.05)	2.3 (.09)	500/100
	22 (.34)	Turquoise	HI 0.34/10	2622.0	6.0(.24)	10.0 (.39)	6.0 (.24)	1.2 (.05)	2.5 (.10)	500/100
	22 (.34)	Turquoise	HI 0.34/12	2623.0	8.0(.31)	12.0 (.47)	8.0 (.31)	1.2 (.05)	2.5 (.10)	500/100
	20 (.50)	Orange	HI 0.50/12	2397.0	6.0(.24)	12.0 (.47)	6.0 (.24)	1.3 (.05)	2.8 (.11)	500/100
	20 (.50)	Orange	HI 0.50/14	2201.0	8.0(.31)	14.0 (.55)	8.0 (.31)	1.3 (.05)	2.8 (.11)	500/100
	20 (.75)	White	HI 0.75/12	2398.0	6.0(.24)	12.0 (.47)	6.0 (.24)	1.5 (.06)	3.3 (.13)	500/100
	20 (.75)	White	HI 0.75/14	2202.0	8.0(.31)	14.0 (.55)	8.0 (.31)	1.5 (.06)	3.3 (.13)	500/100
	18 (1.00)	Yellow	HI 1.0/12	2399.0	6.0(.24)	12.0 (.47)	6.0 (.24)	1.7 (.07)	3.5 (.14)	500/100
	18 (1.00)	Yellow	HI 1.0/14	2203.0	8.0(.31)	14.0 (.55)	8.0 (.31)	1.7 (.07)	3.5 (.14)	500/100
	16 (1.50)	Red	HI 1.5/14	2204.0	8.0(.31)	14.0 (.55)	8.0 (.31)	2.0 (.08)	4.0 (.16)	500/100
	16 (1.50)	Red	HI 1.5/16	2400.0	10.0(.39)	16.0 (.63)	10.0(.39)	2.0 (.08)	4.0 (.16)	500/100
	16 (1.50)	Red	HI 1.5/24	2205.0	18.0(.71)	24.0 (.94)	18.0(.71)	2.0 (.08)	4.0 (.16)	500/100
	14 (2.50)	Blue	HI 2.5/14	2206.0	8.0(.31)	14.0 (.55)	8.0 (.31)	2.5 (.10)	4.7 (.19)	500/100
	14 (2.50)	Blue	HI 2.5/18	2401.0	12.0(.47)	18.0 (.71)	12.0(.47)	2.5 (.10)	4.7 (.19)	500/100
	14 (2.50)	Blue	HI 2.5/24	2207.0	18.0(.71)	24.0 (.94)	18.0(.71)	2.5 (.10)	4.7 (.19)	500/100
	12 (4.00)	Gray	HI 4.0/17	2208.0	10.0(.39)	17.0 (.67)	10.0(.39)	3.2 (.13)	5.4 (.21)	500/100
	12 (4.00)	Gray	HI 4.0/20	2402.0	12.0(.47)	20.0 (.79)	12.0(.47)	3.2 (.13)	5.4 (.21)	500/100
	12 (4.00)	Gray	HI 4.0/26	2209.0	18.0(.71)	26.0 (1.02)	18.0(.71)	3.2 (.13)	5.4 (.21)	100
	10 (6.00)	Black	HI 6.0/20	2210.0	12.0(.47)	20.0 (.79)	12.0(.47)	3.9 (.15)	6.9 (.27)	100
	10 (6.00)	Black	HI 6.0/26	2211.0	18.0(.71)	26.0 (1.02)	18.0(.71)	3.9 (.15)	6.9 (.27)	100
	8 (10.00)	Ivory	HI 10.0/22	2212.0	12.0(.47)	22.0 (.87)	12.0(.47)	4.9 (.19)	8.4 (.33)	100
	8 (10.00)	Ivory	HI 10.0/28	2213.0	18.0(.71)	28.0 (1.10)	18.0(.71)	4.9 (.19)	8.4 (.33)	100
	6 (16.00)	Green	HI 16.0/24	2214.0	12.0(.47)	24.0 (.94)	12.0(.47)	6.2 (.24)	9.6 (.38)	100
	6 (16.00)	Green	HI 16.0/28	2215.0	18.0(.71)	28.0 (1.10)	18.0(.71)	6.2 (.24)	9.6 (.38)	100
	4 (25.00)	Brown	HI 25.0/30	2267.0	18.0(.71)	30.0 (1.18)	18.0(.71)	7.7 (.30)	12.0(.47)	50
	4 (25.00)	Brown	HI 25.0/36	2272.0	22.0(.87)	36.0 (1.42)	22.0(.87)	7.7 (.30)	12.0(.47)	50
	2 (35.00)	Beige	HI 35.0/30	2276.0	18.0(.71)	30.0 (1.18)	18.0(.71)	8.7 (.34)	13.5(.53)	50
	2 (35.00)	Beige	HI 35.0/39	2390.0	25.0(.98)	39.0 (1.54)	25.0(.98)	8.7 (.34)	13.5(.53)	50
	1 (50.00)	Olive	HI 50.0/36	2500.0	20.0(.79)	36.0 (1.42)	20.0(.79)	10.9(.43)	16.0(.63)	50
	2/0 (70.00)	Yellow	HI 70.0/37	2786.0	20.0(.79)	37.0 (1.46)	20.0(.79)	13.4(.53)	17.0(.67)	25
	3/0 (95.00)	Red	HI 95.0/44	2787.0	25.0(.98)	44.0 (1.73)	25.0(.98)	15.4(.61)	19.0(.75)	25
	4/0 (120.00)	Blue	HI 120.0/482788.0	27.0(1.06)	48.0 (1.89)	27.0(1.06)	17.6(.69)	22.4(.88)	25	
	250MCM(150.0)	Yellow	HI 150.0/582789.0	32.0(1.26)	58.0 (2.28)	32.0(1.26)	20.5(.81)	25.0(.98)	25	

* Different standard packs are available as shown. To order the desired standard pack, please use the quantity required as a suffix to the cat. no.

Example for 100 standard pack: Type HI 0.25/10, Cat. No. 2620.0/100

FERRULES, INSULATED DIN Standard

DIN STANDARD FERRULES

Ferrules insure reliable electrical connections when terminating stranded flexible wire in terminal blocks, circuit breakers or other control devices.

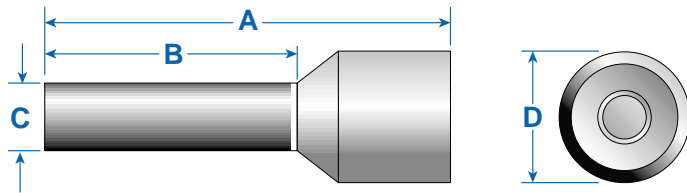

Insulated ferrules prevent conductor breakage due to bending, wire stress or vibration while facilitating wire insertion into the terminal clamp.

Altech's DIN standard ferrules are in compliance with DIN requirements, making them ideal for export applications. They also have a specified color code convention that differs from the color code used for Altech's industry standard ferrules.

To ensure efficient ferrule crimping, always select the smallest ferrule diameter that fits the wire and use only professional crimping tools. (Please refer to the ordering pages and the Crimper Selector Guide on pages 58-61.)

- Sleeve: polypropylene
- Tube: tin plated copper

	AWG (mm ²)	Color	Type	Cat. No.	Stripping Length mm (in.)	Ferrule Dimensions mm (in.)				Std. Pk.*
						A	B	C	D	
	20 (.50)	White	HD 0.50/12	2863.0	6.0(.24)	12.0 (.47)	6.0 (.24)	1.3 (.05)	2.8 (.11)	500/100
	20 (.50)	White	HD 0.50/14	2864.0	8.0(.31)	14.0 (.55)	8.0 (.31)	1.3 (.05)	2.8 (.11)	500/100
	20 (.50)	White	HD 0.50/16	2865.0	10.0(.39)	16.0 (.63)	10.0(.39)	1.3 (.05)	2.8 (.11)	500/100
	20 (.75)	Gray	HD 0.75/12	2866.0	6.0(.24)	12.0 (.47)	6.0 (.24)	1.5 (.06)	3.3 (.13)	500/100
	20 (.75)	Gray	HD 0.75/14	2867.0	8.0(.31)	14.0 (.55)	8.0 (.31)	1.5 (.06)	3.3 (.13)	500/100
	20 (.75)	Gray	HD 0.75/16	2868.0	10.0(.39)	16.0 (.63)	10.0(.39)	1.5 (.06)	3.3 (.13)	500/100
	20 (.75)	Gray	HD 0.75/18	2869.0	12.0(.47)	18.0 (.71)	12.0(.47)	1.5 (.06)	3.3 (.13)	500/100
	18 (1.00)	Red	HD 1.0/12	2870.0	6.0(.24)	12.0 (.47)	6.0 (.24)	1.7 (.07)	3.5 (.14)	500/100
	18 (1.00)	Red	HD 1.0/14	2871.0	8.0(.31)	14.0 (.55)	8.0 (.31)	1.7 (.07)	3.5 (.14)	500/100
	18 (1.00)	Red	HD 1.0/16	2872.0	10.0(.39)	16.0 (.63)	10.0(.39)	1.7 (.07)	3.5 (.14)	500/100
	18 (1.00)	Red	HD 1.0/18	2840.0	12.0(.47)	18.0 (.71)	12.0(.47)	1.7 (.07)	3.5 (.14)	500/100
	16 (1.50)	Black	HD 1.5/14	2841.0	8.0(.31)	14.0 (.55)	8.0 (.31)	2.0 (.08)	4.0 (.16)	500/100
	16 (1.50)	Black	HD 1.5/16	2842.0	10.0(.39)	16.0 (.63)	10.0(.39)	2.0 (.08)	4.0 (.16)	500/100
	16 (1.50)	Black	HD 1.5/18	2843.0	12.0(.47)	18.0 (.71)	12.0(.47)	2.0 (.08)	4.0 (.16)	500/100
	16 (1.50)	Black	HD 1.5/24	2844.0	18.0(.71)	24.0 (.94)	18.0(.71)	2.0 (.08)	4.0 (.16)	500/100
	14 (2.50)	Blue	HD 2.5/14	2845.0	8.0(.31)	14.0 (.55)	8.0 (.31)	2.5 (.10)	4.7 (.19)	500/100
	14 (2.50)	Blue	HD 2.5/18	2846.0	12.0(.47)	18.0 (.71)	12.0(.47)	2.5 (.10)	4.7 (.19)	500/100
	14 (2.50)	Blue	HD 2.5/24	2847.0	18.0(.71)	24.0 (.94)	18.0(.71)	2.5 (.10)	4.7 (.19)	500/100
	12 (4.00)	Gray	HD 4.0/17	2848.0	10.0(.39)	17.0 (.71)	10.0(.39)	3.2 (.13)	5.4 (.21)	500/100
	12 (4.00)	Gray	HD 4.0/20	2849.0	12.0(.47)	20.0 (.79)	12.0(.47)	3.2 (.13)	5.4 (.21)	500/100
	12 (4.00)	Gray	HD 4.0/26	2850.0	18.0(.71)	26.0 (1.02)	18.0(.71)	3.2 (.13)	5.4 (.21)	100
	10 (6.00)	Yellow	HD 6.0/20	2851.0	12.0(.47)	20.0 (.79)	12.0(.47)	3.9 (.16)	6.9 (.27)	100
	10 (6.00)	Yellow	HD 6.0/26	2852.0	18.0(.71)	26.0 (1.02)	18.0(.71)	3.9 (.16)	6.9 (.27)	100
	8 (10.00)	Red	HD 10.0/22	2853.0	12.0(.47)	22.0 (.87)	12.0(.47)	4.9 (.20)	8.4 (.33)	100
	8 (10.00)	Red	HD 10.0/28	2854.0	18.0(.71)	28.0 (1.10)	18.0(.71)	4.9 (.20)	8.4 (.33)	100
	6 (16.00)	Blue	HD 16.0/24	2855.0	12.0(.47)	24.0 (.87)	12.0(.47)	6.2 (.24)	9.6 (.38)	100
	6 (16.00)	Blue	HD 16.0/28	2856.0	18.0(.71)	28.0 (1.10)	18.0(.71)	6.2 (.24)	9.6 (.38)	100
	4 (25.00)	Yellow	HD 25.0/30	2857.0	18.0(.71)	30.0 (1.18)	18.0(.71)	7.7 (.30)	12.0(.47)	50
	4 (25.00)	Yellow	HD 25.0/36	2858.0	22.0(.87)	36.0 (1.5)	22.0(.87)	7.7 (.30)	12.0(.47)	50
	2 (35.00)	Red	HD 35.0/30	2859.0	18.0(.71)	30.0 (1.18)	18.0(.71)	8.7 (.34)	13.5(.53)	50
	2 (35.00)	Red	HD 35.0/39	2860.0	25.0(.98)	39.0 (1.54)	25.0(.98)	8.7 (.34)	13.5(.53)	50
	1 (50.00)	Blue	HD 50.0/36	2861.0	20.0(.79)	36.0 (1.5)	20.0(.79)	10.9(.43)	16.0(.63)	50

* Different standard packs are available as shown. To order the desired standard pack, please use the quantity required as a suffix to the cat. no.

Example for 100 standard pack: Type HD 0.50/12, Cat. No. 2863.0/100

FERRULES Uninsulated

UNINSULATED FERRULES









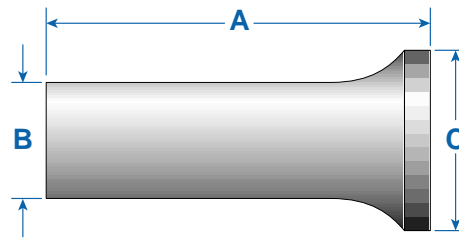

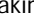

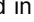





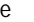
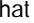

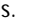
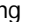

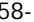



Ferrules insure reliable electrical connections when terminating stranded flexible wire in terminal blocks, circuit breakers or other control devices.

Uninsulated ferrules prevent wire strands from fraying and breaking and are extremely cost effective. Their shorter lengths and uninsulated bodies offer advantages when making terminations in printed circuit board terminal blocks and in other terminal blocks with smaller clamps or narrow widths.

To ensure efficient ferrule crimping, always select the smallest ferrule diameter that fits the wire and use only professional crimping tools. (Please refer to the ordering pages and the Crimper Selector Guide on pages 58-61.)

- Tube: tin plated copper



	AWG (mm ²)	Type	Cat. No.	Stripping Length mm (in.)	Ferrule Dimensions mm (in.)			Std. Pk.*
					A	B	C	
	20 (.50)	HU 0.50/6	2216.0	6.0 (.24)	6.0 (.24)	1.3 (.05)	2.1 (.08)	1000/100
	20 (.75)	HU 0.75/6	2217.0	6.0 (.24)	6.0 (.24)	1.5 (.06)	2.3 (.09)	1000/100
	20 (.75)	HU 0.75/10	2218.0	10.0 (.39)	10.0 (.39)	1.5 (.06)	2.3 (.09)	1000/100
	18 (1.00)	HU 1.0/6	2219.0	6.0 (.24)	6.0 (.24)	1.7 (.07)	2.5 (.10)	1000/100
	18 (1.00)	HU 1.0/10	2220.0	10.0 (.39)	10.0 (.39)	1.7 (.07)	2.5 (.10)	1000/100
	16 (1.50)	HU 1.5/7	2221.0	7.0 (.28)	7.0 (.28)	2.3 (.09)	2.8 (.11)	1000/100
	16 (1.50)	HU 1.5/10	2222.0	10.0 (.39)	10.0 (.39)	2.3 (.09)	2.8 (.11)	1000/100
	14 (2.50)	HU 2.5/7	2223.0	7.0 (.28)	7.0 (.28)	2.5 (.10)	3.4 (.13)	1000/100
	14 (2.50)	HU 2.5/12	2224.0	12.0 (.47)	12.0 (.47)	2.5 (.10)	3.4 (.13)	1000/100
	12 (4.00)	HU 4.0/9	2225.0	9.0 (.35)	9.0 (.35)	3.2 (.13)	4.0 (.16)	1000/100
	12 (4.00)	HU 4.0/12	2226.0	12.0 (.47)	12.0 (.47)	3.2 (.13)	4.0 (.16)	1000/100
	10 (6.00)	HU 6.0/12	2227.0	12.0 (.47)	12.0 (.47)	3.9 (.15)	4.7 (.19)	500/100
	10 (6.00)	HU 6.0/15	2388.0	15.0 (.59)	15.0 (.59)	3.9 (.15)	4.7 (.19)	500/100
	8 (10.00)	HU 10.0/12	2228.0	12.0 (.47)	12.0 (.47)	4.9 (.19)	5.8 (.23)	500/100
	8 (10.00)	HU 10.0/15	2389.0	15.0 (.59)	15.0 (.59)	4.9 (.19)	5.8 (.23)	500/100
	8 (10.00)	HU 10.0/18	2229.0	18.0 (.71)	18.0 (.71)	4.9 (.19)	5.8 (.23)	500/100
	6 (16.00)	HU 16.0/12	2391.0	12.0 (.47)	12.0 (.47)	6.2 (.24)	7.5 (.30)	500/100
	6 (16.00)	HU 16.0/15	2392.0	15.0 (.59)	15.0 (.59)	6.2 (.24)	7.5 (.30)	500/100
	6 (16.00)	HU 16.0/18	2393.0	18.0 (.71)	18.0 (.71)	6.2 (.24)	7.5 (.30)	500/100
	4 (25.00)	HU 25.0/15	2394.0	15.0 (.59)	15.0 (.59)	7.7 (.30)	9.5 (.37)	500/100
	4 (25.00)	HU 25.0/18	2395.0	18.0 (.71)	18.0 (.71)	7.7 (.30)	9.5 (.37)	100
	2 (35.00)	HU 35.0/18	2396.0	18.0 (.71)	18.0 (.71)	8.7 (.34)	11.0 (.43)	100
	1/0 (50.00)	HU 50.0/32	2816.0	32.0 (1.26)	32.0 (1.26)	10.9 (.43)	13.0 (.51)	100
	2/0 (70.00)	HU 70.0/25	2790.0	26.0 (1.02)	25.0 (.98)	13.3 (.52)	15.0 (.59)	100
	3/0 (95.00)	HU 95.0/32	2791.0	30.0 (1.18)	32.0 (1.26)	15.3 (.60)	17.0 (.67)	50
	4/0 (120.00)	HU 120.0/32	2792.0	32.0 (1.26)	32.0 (1.26)	17.5 (.69)	19.0 (.75)	50
	250MCM(150.00)	HU 150.0/40	2793.0	38.0 (1.50)	40.0 (1.57)	19.5 (.77)	21.0 (.83)	50
	350MCM(185.00)	HU 185.0/40	2815.0	40.0 (1.57)	40.0 (1.57)	21.2 (.83)	23.5 (.93)	25

* Different standard packs are available as shown. To order the desired standard pack, please use the quantity required as a suffix to the cat. no.

Example for 100 standard pack: Type HU 0.50/6, Cat. No. 2216.0/100

DUAL WIRE FERRULES

Insulated

Dual Wire Ferrules have larger diameters and special shaped sleeves that accept two conductors of the same or different size. They provide an efficient connection of multiple wires in the same terminal clamp or simplify wire jumpering between terminal clamps. They are color coded with the same convention as the insulated DIN standard ferrules.

To ensure efficient ferrule crimping always select the smallest ferrule diameter that fits the wire and use only professional crimping tools. (Please refer to the ordering pages and the Crimper Selector Guide on pages 58-61.)

- Sleeve: polypropylene
- Tube: tin plated copper

DUAL WIRE FERRULES

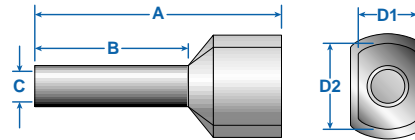

	Wires x AWG (mm ²)	Color	Type	Cat. No.	Stripping Length mm (in.)		Ferrule Dimensions mm (in.)					Std. Pk.*
						A	B	C	D2	D1		
	2x22 (2x.50)	White	HH 2x0.50/15	2794.0	11.0 (.43)	14.6 (.57)	8.2 (.32)	1.7 (.07)	3.0 (.12)	5.0 (.20)	500/100	
	2x20 (2x.75)	Gray	HH 2x0.75/15	2775.0	11.0 (.43)	14.6 (.57)	8.2 (.32)	2.0 (.08)	3.0 (.12)	5.5 (.22)	500/100	
	2x20 (2x.75)	Gray	HH 2x0.75/17	2795.0	13.0 (.51)	16.4 (.65)	10.0 (.39)	2.0 (.08)	3.0 (.12)	5.5 (.22)	500/100	
	2x18 (2x1.0)	Red	HH 2x1.0/15	2776.0	11.0 (.43)	15.4 (.61)	8.2 (.32)	2.4 (.09)	3.2 (.13)	5.8 (.23)	500/100	
	2x18 (2x1.0)	Red	HH 2x1.0/20	2796.0	13.0 (.51)	25.2 (.99)	18.0 (.71)	2.4 (.09)	3.2 (.13)	5.8 (.23)	500/100	
	2x16 (2x1.5)	Black	HH 2x1.5/16	2777.0	12.0 (.47)	15.8 (.62)	8.2 (.32)	2.6 (.10)	3.6 (.14)	6.5 (.26)	500/100	
	2x16 (2x1.5)	Black	HH 2x1.5/20	2797.0	16.0 (.63)	19.6 (.77)	12.0 (.47)	2.6 (.10)	3.6 (.14)	6.5 (.26)	500/100	
	2x14 (2x2.5)	Blue	HH 2x2.5/19	2778.0	14.0 (.55)	18.5 (.73)	10.0 (.39)	3.3 (.13)	4.5 (.18)	8.0 (.31)	250/100	
	2x14 (2x2.5)	Blue	HH 2x2.5/21	2798.0	17.0 (.67)	20.5 (.80)	12.0 (.47)	3.3 (.13)	4.5 (.18)	8.0 (.31)	250/100	
	2x12 (2x4.0)	Gray	HH 2x4.0/22	2799.0	14.0 (.63)	22.0 (.87)	12.0 (.47)	3.9 (.15)	5.2 (.20)	9.0 (.35)	100	
	2x10 (2x6.0)	Yellow	HH 2x6.0/23	2800.0	18.0 (.75)	23.0 (.91)	12.0 (.47)	5.0 (.20)	6.2 (.24)	11.4 (.45)	100	
	2x8 (2x10.0)	Red	HH 2x10.0/24	2801.0	19.0 (.75)	24.0 (.94)	12.0 (.47)	6.2 (.24)	7.6 (.30)	13.4 (.53)	100	
	2x6 (2x16.0)	Blue	HH 2x16.0/29	2802.0	16.0 (.55)	29.0 (1.14)	16.0 (.63)	8.9 (.35)	9.5 (.37)	17.2 (.68)	100/50	



* Different standard packs are available for many ferrules. To order the desired standard pack, please use the quantity required as a suffix to the Cat. No. **Example: Type HH2x0.5/15, Cat. No. 2794.0/100 for a standard pack of 100**

INSULATED FERRULES Assortment Box

Handy Assortment Boxes for convenient dispensing and storage of Industry and DIN Standard Insulated Ferrules. Types AB1-S and AB1-D are equipped with five different ferrule sizes. Types AB2-S and AB2-D are equipped with four different ferrule sizes. Contents of each box is listed. Dimensions for industry and DIN standard insulated ferrules are listed on pages 53-54.



AB1-S



AB2-S

Ferrule Qty.	AWG (mm ²)	Ferrule Type	Ferrule Cat. No.	Ferrule Color	Type	Cat. No.	Std. Pk.
AB1-S Industry Standard					AB1-S	2884.9	1
50	20 (.50)	HI 0.50/14	2201.0	Orange			
100	20 (.75)	HI 0.75/14	2202.0	White			
100	18 (1.00)	HI 1.0/12	2399.0	Yellow			
100	16 (1.50)	HI 1.5/14	2204.0	Red			
50	14 (2.50)	HI 2.5/14	2206.0	Blue			
AB2-S Industry Standard					AB2-S	2885.9	1
50	12 (.4.0)	HI 4.0/18	2208.0	Gray			
20	10 (6.0)	HI 6.0/20	2210.0	Black			
20	8 (10.0)	HI 10.0/22	2212.0	Ivory			
10	6 (16.0)	HI 16.0/22	2214.0	Green			
AB1-D DIN Standard					AB1-D	2884.0	1
50	20 (.50)	HD 0.50/14	2864.0	White			
100	20 (.75)	HD 0.75/14	2867.0	Gray			
100	18 (1.0)	HD 1.0/14	2871.0	Red			
100	16 (1.5)	HD 1.5/14	2841.0	Black			
50	14 (2.5)	HD 2.5/14	2845.0	Blue			
AB2-D DIN Standard					AB2-D	2885.0	1
50	12 (4.00)	HD 4.0/18	2848.0	Gray			
20	10 (6.00)	HD 6.0/20	2851.0	Yellow			
20	8 (10.00)	HD 10.0/22	2853.0	Red			
10	6 (16.00)	HD 16.0/22	2855.0	Blue			