

## Cable sleeve - CES-STPG-GY-12 - 0801684

Please be informed that the data shown in this PDF Document is generated from our Online Catalog. Please find the complete data in the user's documentation. Our General Terms of Use for Downloads are valid (<http://phoenixcontact.com/download>)



Small, slotted cable sleeves suitable for cables with a diameter of 11 ... 12 mm, material: SEBS

### Product Description

Slotted sleeves for accommodating pre-assembled cables and lines with a diameter of 11 ... 12 mm, can be used in CES sealing frames. When fitted, the sleeves also ensure strain relief according to DIN EN 50262.



### Key Commercial Data

Packing unit	1 pc
Minimum order quantity	10 pc
Weight per Piece (excluding packing)	6.0 g
Custom tariff number	85472000
Country of origin	Poland

### Technical data

#### Dimensions

External cable diameter	1x 11 mm ... 12 mm
Length	29.5 mm
Width	19.5 mm
Height	17 mm

#### Ambient conditions

Degree of protection	IP54 (for sealing frames with screw locking. IP44 sealing frames with locking latch.)
Ambient temperature (operation)	-40 °C ... 80 °C (static)

#### General

Product description	Slotted sleeves for accommodating pre-assembled cables and lines with a diameter of 11 ... 12 mm, can be used in CES sealing frames. When fitted, the sleeves also ensure strain relief according to DIN EN 50262.
---------------------	--

## Cable sleeve - CES-STPG-GY-12 - 0801684

### Technical data

#### General

No. of conductors	1
Material	SEBS
Flammability rating according to UL 94	V0
Color	gray

#### Standards and Regulations

Connection in acc. with standard	CUL
Flammability rating according to UL 94	V0

### Classifications

#### eCl@ss

eCl@ss 4.0	27081002
eCl@ss 4.1	27081002
eCl@ss 5.0	27081002
eCl@ss 5.1	27081002
eCl@ss 6.0	27081002
eCl@ss 7.0	27081002
eCl@ss 8.0	27069220

#### ETIM

ETIM 3.0	EC000879
ETIM 4.0	EC000451
ETIM 5.0	EC000451

#### UNSPSC

UNSPSC 6.01	30212109
UNSPSC 7.0901	39121708
UNSPSC 11	39121708
UNSPSC 12.01	39121708
UNSPSC 13.2	39121708

### Approvals

#### Approvals

---

#### Approvals

UL Recognized / cUL Recognized / GL / cULus Recognized

# Cable sleeve - CES-STPG-GY-12 - 0801684

## Approvals

Ex Approvals

Approvals submitted

## Approval details

UL Recognized

cUL Recognized

GL

cULus Recognized

## Drawings

Dimensional drawing

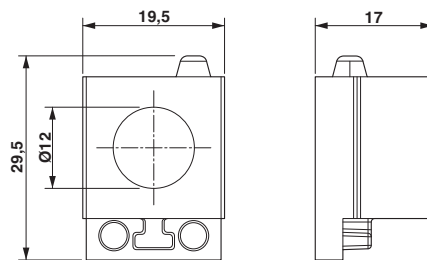

Dimensional drawing