

PRODUCT PARTNUMBER
10150775-XXXX0LF

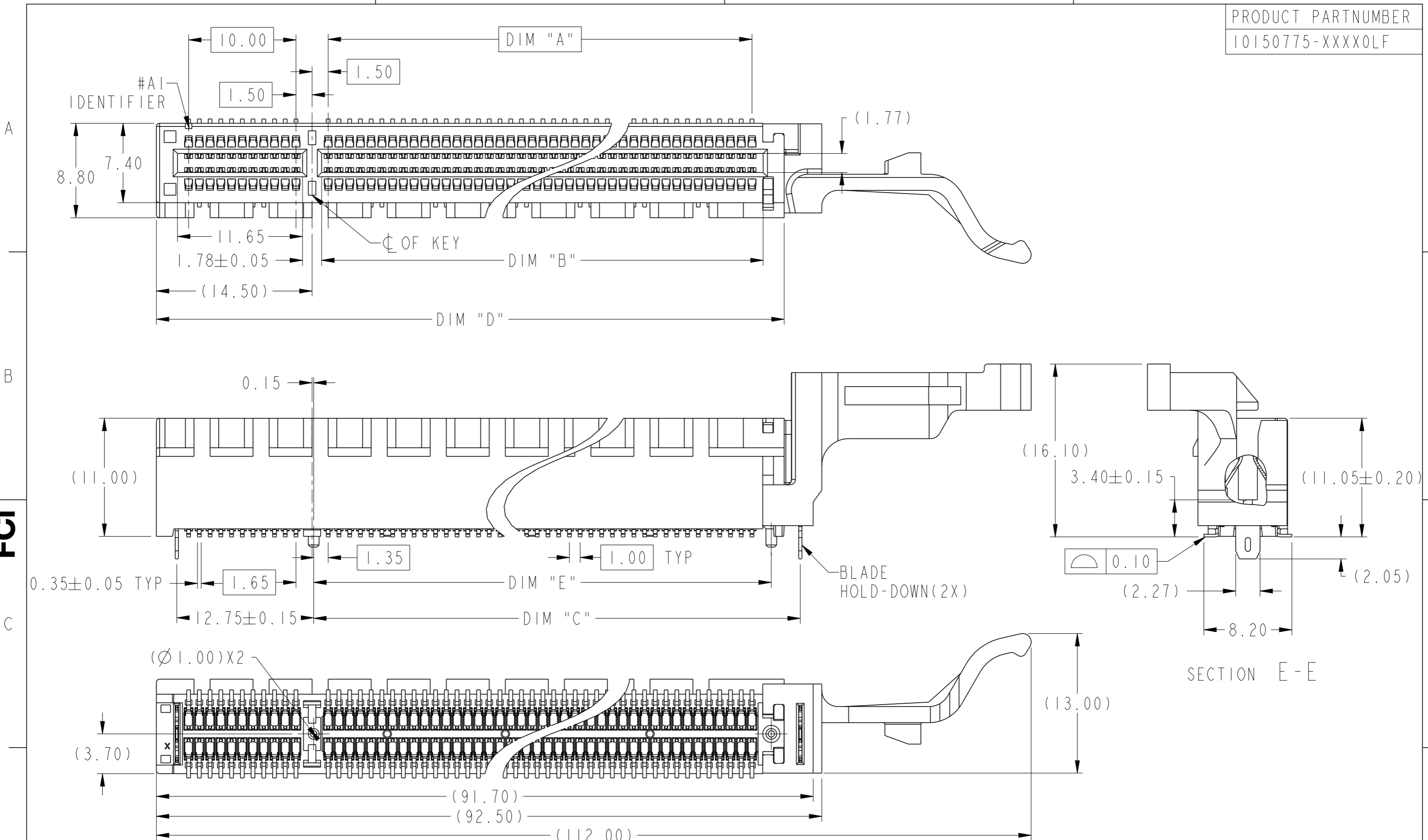

Amphenol
FCi

© 2020 Amphenol Corporation

spec ref	-	dr	Sandar Soe	2019/01/22	projection	MM	size	A3	scale	3:1
tolerance std	ISO 406 ISO 1101	eng	Sandar Soe	2021/01/07			ecn no	-	rel level	Released
TOLERANCES UNLESS OTHERWISE SPECIFIED		chr	-	-			product family	PCI express	rel level	Released
surface	linear	appr	Koon-Poh Tay	2021/01/07			dwg no	10150775	rev	A
ISO 1302	angular	cat. no.		-	Product - Customer Drw		sheet 1 of 4			
	0.X	±0.30								
	0.XX	±0.20								
	0.XXX	±0.1								
	0°	±2°								

Creo File:ELX-WC-A3C.REV F.2020-12-21

CONNECTOR LINK WIDTH	POSITION	N	DIM "G"	DIM "F"	PIN "L"
X16	164	70	72.15	70.00	B81

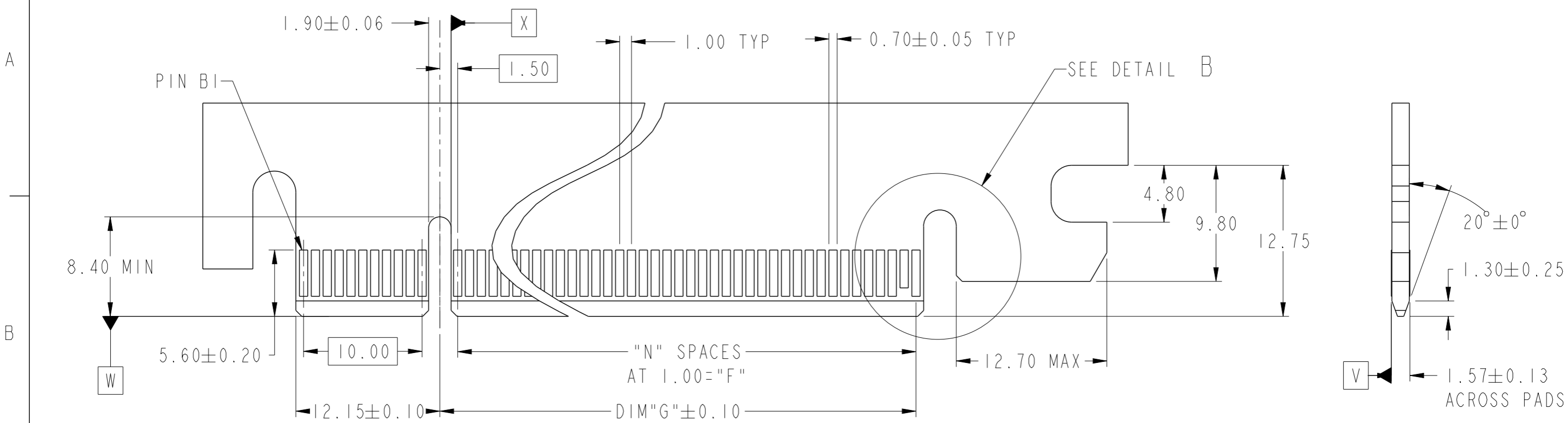

← I/O PANEL DIRECTION
PRIMARY (COMPONENT) SIDE

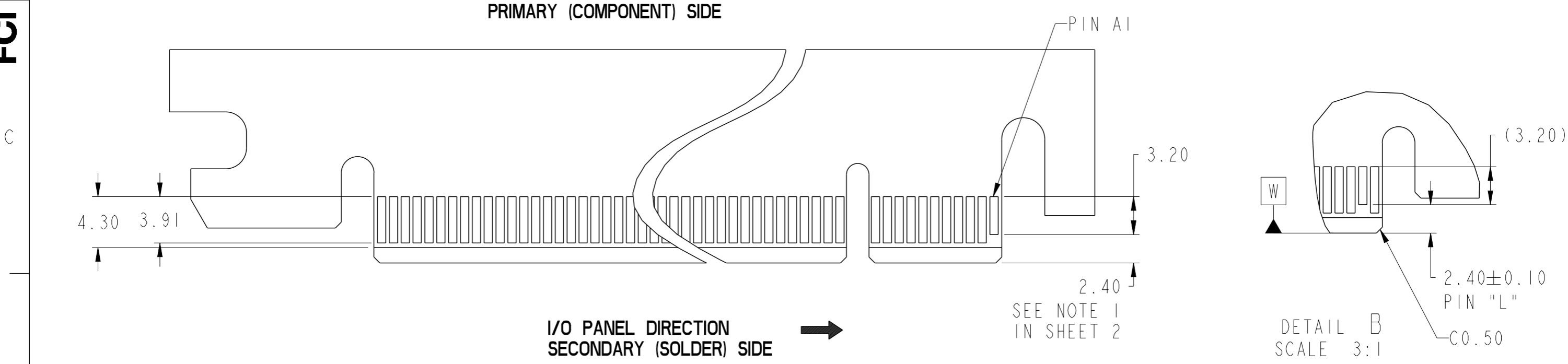

→ I/O PANEL DIRECTION
SECONDARY (SOLDER) SIDE

DETAIL B
SCALE 3:1

- NO TIE BAR PERMITTED FROM CARD EDGE TO LEADING EDGE OF PAD FOR PIN AI AND PIN "L"
- CHAMFER EDGES MUST BE FREE OF CUTTING BURRS
- TOLERANCE: ± 0.13

spec ref	-	dr	Sandar Soe	2019/01/22	projection	MM	size	A3	scale	1:1
tolerance std	ISO 406 ISO 1101	eng	Sandar Soe	2021/01/07			ecn no	-	rel level	Released
surface	linear	chr	-	apppr			Koon-Poh Tay	2021/01/07		product family
	angular	0°	$\pm 2^\circ$	Amphenol FCI		PCIE GEN4, CUSTOMIZED LATCH	dwg no	10150775	rev	A
				cat. no.	Product - Customer Drw		sheet 2 of 4			

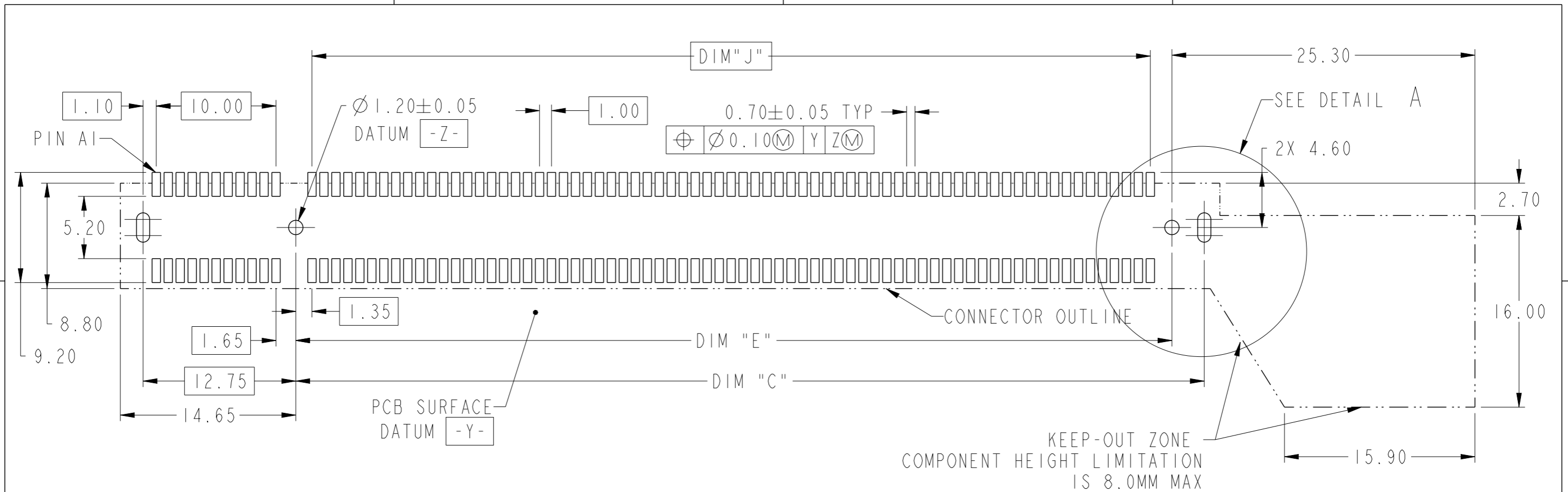

RECOMMENDED PCB LAYOUT, PAD TYPE

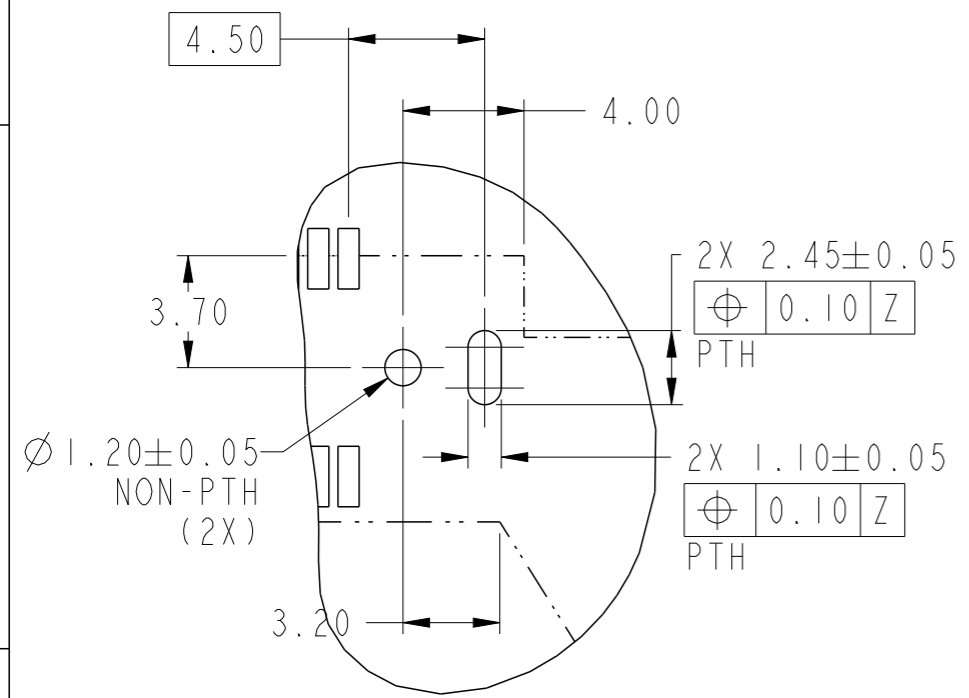

DETAIL A
SCALE 4:1

POSITION	DIMENSIONS					
	A	B	C ±0.15	D ±0.23	J	E
164	70.00	71.65	75.85	89.00	70.00	73.15

spec ref	-	dr	Sandar Soe	2019/01/22	projection	MM	size	A3	scale	1:1
tolerance std	ISO 406 ISO 1101	eng	Sandar Soe	2021/01/07			ecn no		rel level	
TOLERANCES UNLESS OTHERWISE SPECIFIED		chr	-	-			-		Released	
surface	linear	appr	Koon-Poh Tay	2021/01/07	product family	PCIE GEN4, CUSTOMIZED LATCH		dwg no	10150775	rev
ISO 1302	angular			cat. no.	Product - Customer Drw				sheet 3 of 4	A

PRODUCT NUMBER CODE

10150775- □□□□ 0LF

HOUSING COLOR

1: BLACK

CONTACT AREA PLATING

1: 30u" Au
2: 15u" Au

PACKAGING OPTIONS

Y: SOFT TRAY WITH KAPTON TAPE
K: CUSTOMIZED HARD TRAY (330X136MM) WITHOUT KAPTON TAPE
L: CUSTOMIZED HARD TRAY (330X136MM) WITH KAPTON TAPE, 22MM

NO. OF POSITION

3: 164 POSITIONS

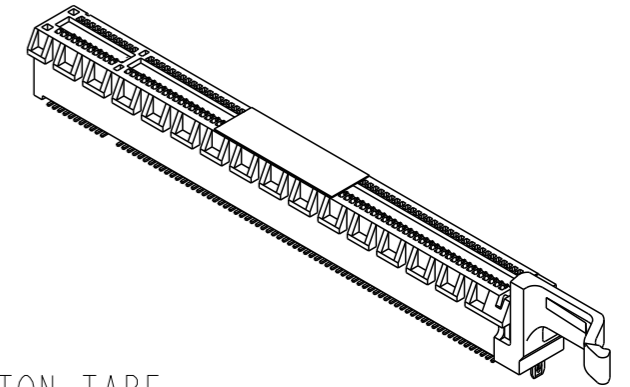

NOTES:

- MATERIAL:
HOUSING: HIGH PERFORMANCE RESINS, UL94V-0
LATCH: HIGH PERFORMANCE THERMOPLASTIC, UL94V-0
CONTACT: COPPER ALLOY.
METAL PADS: COPPER ALLOY
- PLATING:
CONTACT: UNDERPLATE: 50u" NICKEL OVER ALL.
SOLDER AREA: 100u" TIN (LEAD FREE).
MATING AREA: SEE PRODUCT NUMBER CODE.
HOLDDOWN CLIP: 100u" TIN OVER 50 u" NICKEL.
- PRODUCT SPECIFICATION: GS-12-1406
- PRODUCT MEETS EUROPEAN UNION DIRECTIVES AND OTHER COUNTRY REGULATIONS AS DESCRIBED IN GS-47-0004.
- DATE CODE "MMDDYYL", MMDDYY IS ASSEMBLY DATE.
L IS AFCI PRODUCTION SITE.
- 6-1. THE CONNECTOR PLASTIC WILL WITHSTAND EXPOSURE TO 260° PEAK TEMPERATURE FOR 10 SECONDS IN A CONVECTION, INFRA-RED OR VAPOR PHASE REFLOW OVEN.
- 6-2. THE CONNECTOR LATCH WILL WITHSTAND EXPOSURE TO 260° PEAK(MAX) TEMPERATURE FOR 10 SECONDS(MAX) IN A CONVENTION, INFRA-RED OR VAPOR PHASE REFLOW OVEN
- A \triangle SYMBOL WILL BE PLACED ON ANY DIMENSION, NOTE OR VIEW WHICH HAS BEEN MODIFIED.

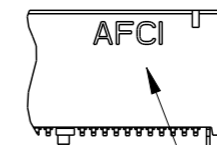
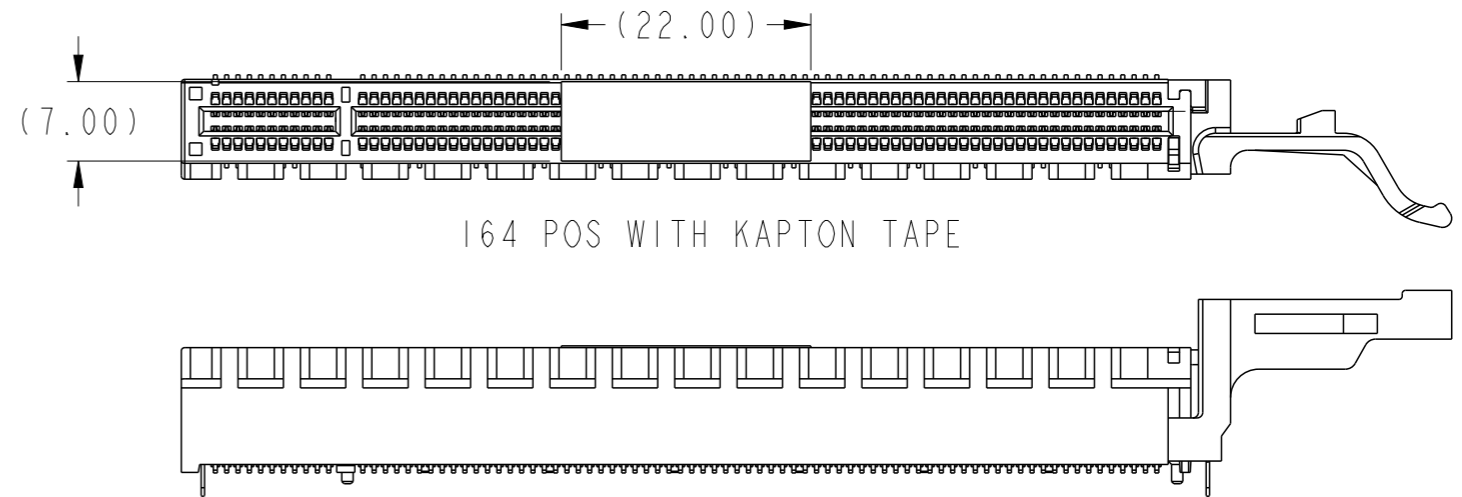

DATE CODE & PARTNO

spec ref -		dr Sandar Soe	2019/01/22	projection	MM	size A3	scale 3:1
tolerance std ISO 406 ISO 1101		eng Sandar Soe	2021/01/07			ecn no -	
TOLERANCES UNLESS OTHERWISE SPECIFIED		chr -	-			product family PCI express	rel level Released
surface	linear	0.X	±0.30		PCIE GEN4, CUSTOMIZED LATCH MODULE ASSY, SMT - BLADE	dwg no 10150775	rev A
		0.XX	±0.20				
0.XXX	±0.1						
ISO 1302	angular	0°	±2°	cat. no. -	Product - Customer Drw	sheet 4 of 4	