

PRODUCT NUMBER  
65166-001(LF)

WHEN NEEDED, SUFFIX LETTER "LF"  
INDICATES THE PRODUCT IS RoHS  
COMPLIANT, SEE NOTE 2

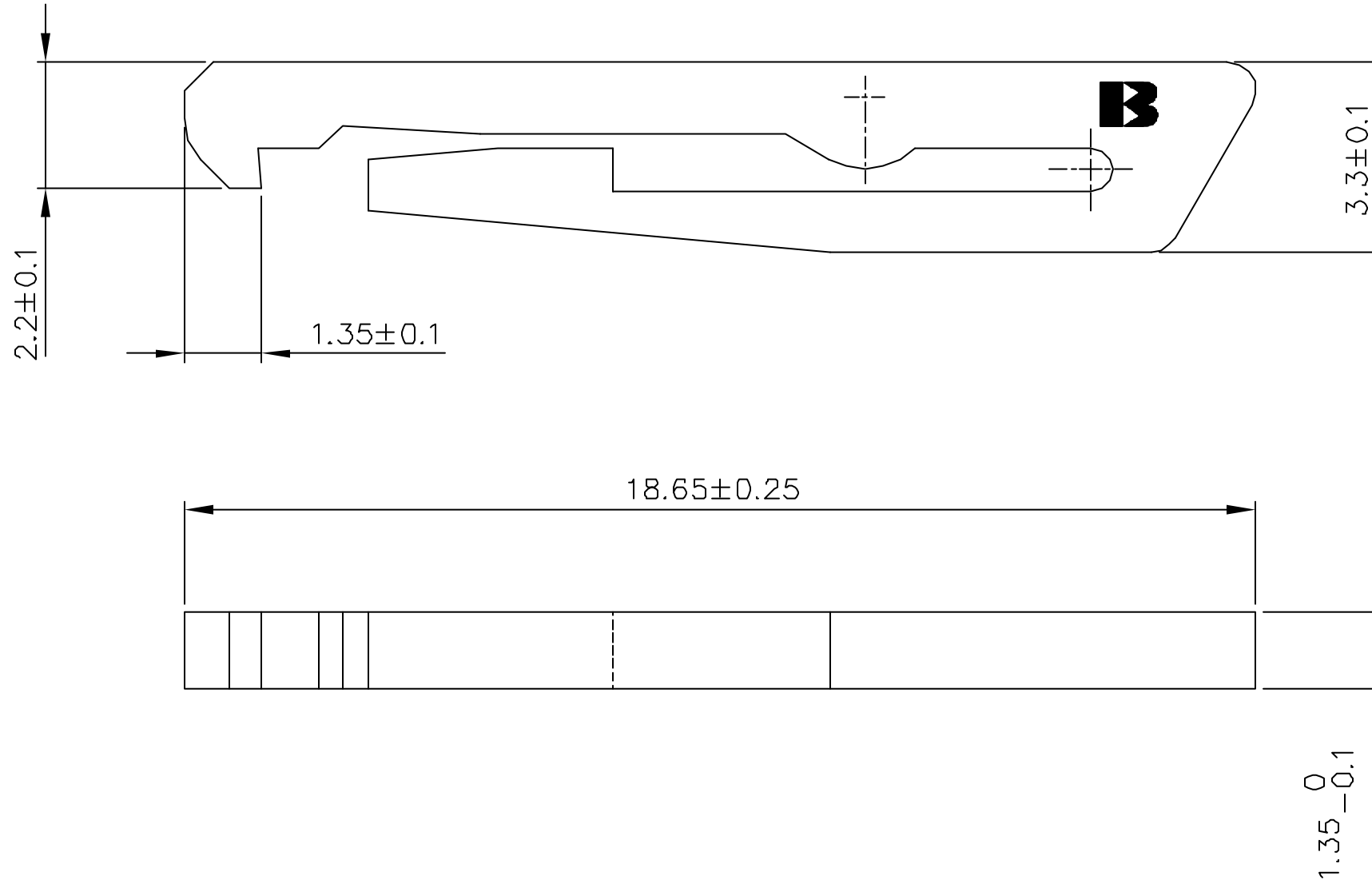
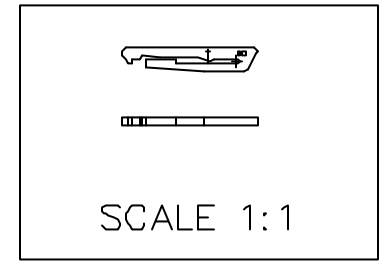

NOTES:

1. MAT'L: THERMOPLASTIC POLYESTER 30% GLASSFILLED  
UL-94-V0, COLOUR; BLEU.
2. - RoHS COMPATIBLE PRODUCT SPECIFICATIONS
  - a - LABELING:  
- MEETS PACKAGING SPECS AS PER GS-14-920
  - b - LEGAL STATEMENT: SEE GS-22-008

THE PRODUCT IS NOT INTENDED TO BE EXPOSED TO A  
MANUFACTURING SOLDER PROCESS.

mat'l. code		surface		tolerance		projection		product family	
--		ISO 1302		ISO 406 ISO 101		101		BERGCON	
ltr		ecn no		date		tolerances unless otherwise specified		title	
A		7851		LNA 880801		angles		KEY STRAIGHT FOR POL. AND LATCH.	
B		V51229		DDB 950927		Linear		mm	
C		HB0467		LGI 980723				scale 10:1	
D		F00406		LLA 000522		dr		D. de Bil 950927	
E		F05-0235		DLE 05.08.24		engr		M. Loman 950927	
F		F05-0286		DLE 05.11.07		chr		M. Loman 950927	
G		F06-0218		DLE 06.07.11		appd		M. Loman 950927	
sheet index		revision sheet						FCJ	
								dwg no 65166 sheet 1 of 1 size A3	
								type Product Customer Drawing	



Copyright FCJ