

PRODUCT NUMBER

89898-XXXXHELF

ROHS COMPATIBLE. SEE NOTE 6

OPTION LETTERS, NOTE 1b, OMIT FROM PRODUCT NUMBER IF NOT APPLICABLE

A=PRODUCT WITH GREY PICK UP CAP IN TAPE & REEL, SEE TA-856.
AV=PRODUCT WITH GREY PICK UP CAP IN TAPE & REEL FOR CUSTOMER DEDICATED PART, SEE TA-856.

B=PRODUCT WITH PICK UP CAP PACKED IN TUBE.

G=PRODUCT WITH BLACK PICK UP CAP IN TAPE & REEL, SEE TA-856.
K=PRODUCT WITHOUT PICK UP CAP IN TAPE & REEL, SEE TA-856

NUMBER OF POSITIONS PER ROW: 02 TO 30.
OVER THAN 30 POSITIONS ON SPECIAL REQUEST.

PLATING CODE

- 3 = 0.76µm GOLD ON CONTACT AREA.
2µm MIN MATTE TIN ON TAIL.
- 4 = 2µm MIN MATTE TIN FULL PLATED
1.27µm Ni MIN UNDERPLATING

NOTES:

1a - HOUSING & PICK UP CAP MAT'L: THERMOPLASTIC GLASS FILLED FLAME RETARDANT PER UL 94 V-0 COLOR: GREY.

b - HIGH TEMPERATURE PLASTIC 30% GLASS REINFORCED NON HALOGEN FLAME RETARDED MOLDING COMPOUND COLOR BLACK.

2 - TERMINAL MATERIAL: PHOSPHOR BRONZE.

3 - PACKAGING:
2 UP TO 4 POSITIONS PRODUCT PACKED IN PLASTIC BOX.
5 UP TO 30 POSITIONS PRODUCT PACKED IN TUBE.
WHOLE 89898-304B PACKED IN TUBE.

4 - TO DETERMINE DIMENSIONS:
N = NUMBER OF POSITIONS PER ROW
EXAMPLE: 8 POS: (Nx2.54)-0.08=20.24 mm.

5 - RECOMMENDED IR PROFILE PER TA842.

6 - ROHS COMPATIBLE PRODUCT SPECIFICATIONS

d - PLATING:

- "L" MEANS THE PRODUCT IS LEAD-FREE,
2µm MINIMUM MATTE TIN OVER
MINIMUM NICKEL UNDERPLATE.

b - MANUFACTURING PROCESS COMPATIBILITY

- THE HOUSING WILL WITHSTAND EXPOSURE TO 260°C PEAK TEMPERATURE FOR 30 SECONDS MAX IN A CONNECTION INFRA-RED OR VAPOR PHASE OR REFLOW OVEN.

c - LABELING:

- MEETS PACKAGING SPECS AS PER GS-14-920

d - LEGAL STATEMENT: SEE GS-47-0004

7 - END STAND-OFFS FOR 2x2 UP TO 2x4 POS
NO END STAND-OFFS FOR 2x5 UP TO 2x50 POS

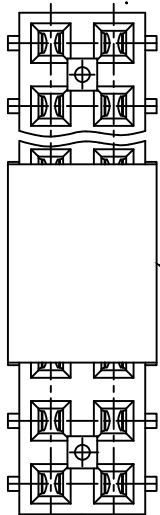

OPTIONAL PICK UP CAP

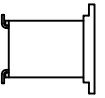
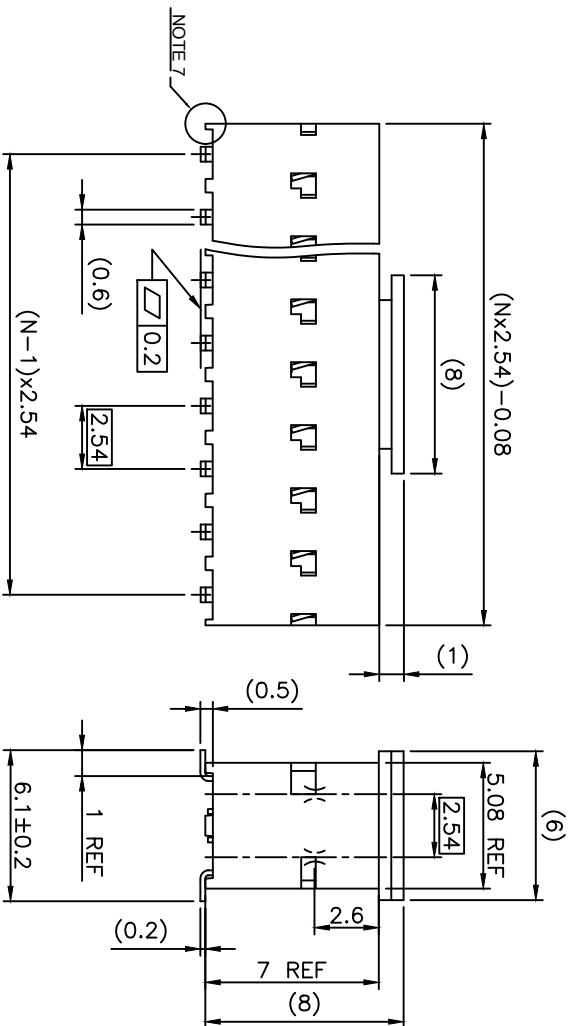

CAP ORIENTATION FOR
2x2 POSITIONS ONLY

mat'l. code	surface	tolerance	projection	product family
SEE NOTE 1 & 2	ISO 1302	ISO 406 ISO 1101	mm	DUBOX
trf ecn no dr date	ISO 1302	ISO 406 ISO 1101	mm	
AE F12-0047 JCOO 12.07.16		X 40.3		
AF B-18748 LMU 14.08.04		XXX±0.3		
AG B-19123 LMU 14.10.21		XXX±0.06		
AH F-24429 AMA 16.07.01				
AI F-29050 DDE 16.08.28				
AK F-30587 DDE 18.06.29				
sheet revision AK C	sheet	sheet	sheet	sheet
index sheet 1 2	index	index	index	index



product family: DUBOX
title: SMT
BIB RECEIPT.
dwg no: 89898
sheet 1 of 2
size: A3
type: CUSTOMER Drawing

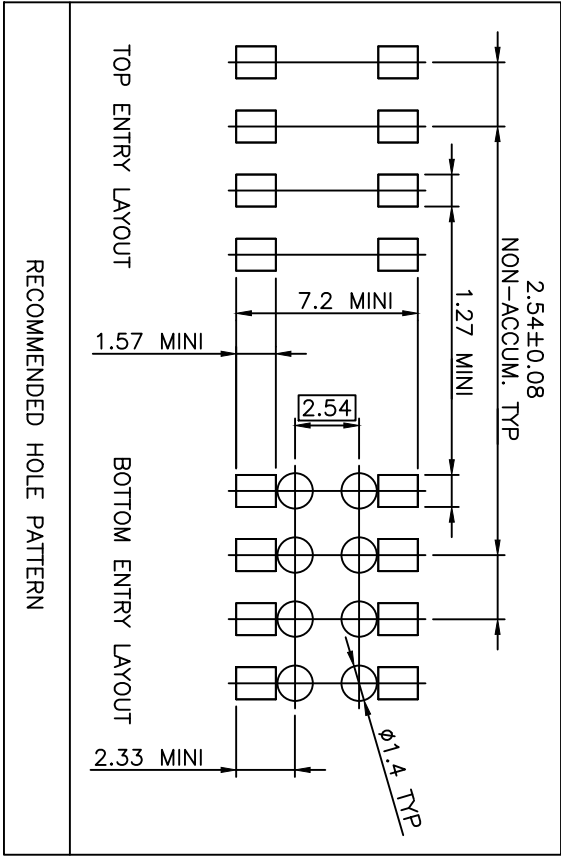

mat'l. code		surface		tolerance		projection		product family	
SEE NOTE 1 & 2		ISO 1302		ISO 406 ISO 1101		 mm		DUBOX	
litr	ecn no	dr	date	tolerances unless otherwise specified		 mm		title	
A	F04-0347	DLE	04.11.10	X 40.3 XX 40.13 XXX 40.05		scale 5:1		SMT BIB RECEIPT.	
B	F06-0204	DLE	06.06.23	angles linear		dr P NIZZI		dwg no 89898	
C	F11-0016	JCO	11.01.31	linear		engr JIM.PHAM/VAN chr P.NIZZI		sheet 2 of - size A4	
Sheet		revision		apprl		JM.P		Drawing	
index		sheet							