

**Features:**

- Universal AC input/ Full range
- Wide Operating Ambient Temperature (-20°C~60°C)
- High Efficiency, and High Reliability
- Ultra-minature size, low profile
- Output Protections: OLP/OVP/SCP
- All using 105°C long life electrolytic capacitors.
- 100% full load burn-in test



Model	QPS-20-3.3	QPS-20-5	QPS-20-12	QPS-20-15	QPS-20-24	QPS-20-48
<b>Output Characteristics</b>						
DC Output	3.3V	5V	12V	15V	24V	48V
Rated Current	4A	4A	1.67A	1.34A	0.84A	0.42A
Current Range	0~4A	0~4A	0~1.67A	0~1.34A	0~0.84A	0~0.42A
Ripple and Noise	0~60°C	<50mV	<50mV	<50mV	<50mV	<100mV
	-20~0°C	<75mV	<75mV	<75mV	<75mV	<100mV
Voltage ADJ. Range	3.1~3.6V	4.4~5.6V	11.1~13.1V	13.7~16.1V	22.0~25.4V	45.6~50.4V
Voltage Accuracy	±2.0%	±2.0%	±2.0%	±2.0%	±2.0%	±2.0%
Line Regulation	±0.5%	±0.5%	±0.5%	±0.5%	±0.5%	±0.5%
Load Regulation	±2.0%	±2.0%	±2.0%	±2.0%	±2.0%	±2.0%
Set-up Time	<2.0s (115VAC input, full load); <1.0s (230VAC input, full load)					
Hold-up Time	>10ms (115VAC input, full load); >20ms (230VAC input, full load)					
Temperature Coefficient	±0.03%/°C					
Overshoot and Undershoot	<5.0%					
<b>Input Characteristics</b>						
Voltage Range	90VAC~264VAC, 127VDC~370VDC					
Frequency Range	47Hz-63Hz					
Efficiency (Typical)	115VAC Input	69%	76%	79%	80%	80%
	230VAC Input	68%	75%	78%	79%	79%
AC Current (max)	<0.5A					
Inrush Current (Typical)	20A@115VAC Cold start 40A@230VAC Cold start					
Leakage Current	Input-Output: <0.35mA Input-PG: <0.75mA					
<b>Protection</b>						
Over Load (OLP)	105%~150% of rated output power, hiccup mode, auto recover					
Over Voltage (OVP)	110%~140% of rated output voltage, constant voltage					
Short Circuit (SCP)	Long-term mode, auto recovery					
<b>Environmental Characteristics</b>						
Operating Amb. Temp. & Hum	-20°C~60°C; 20%~90% RH Non-Condensing					
Storage Temp. & Hum	-40°C~85°C; 10%~95% RH Non-Condensing					
Safety Standards	UL60950-1; EN60950-1: 2006					
Withstand Voltage	Primary-Secondary: 3.0KVAC;≤10mA. Primary-PG: 1.5KVAC;≤10mA. Secondary-PG: 0.5KVDC;≤10mA					
Isolation Resistance	≥100M ohms					
EMI Conduction & Radiation	Compliance to EN55022(CISPR22) Class B					
Harmonic Current	Compliance to EN61000-3-2, 17625.1-2003					
EMS Immunity	Compliance to EN61000-4-2, 3, 4, 5, 6, 8, 11; ENV50204, light industry level, criteria A					
<b>General Characteristics</b>						
MTBF (MIL-HDBK-217F)	More than 200,000Hrs (25°C, Full load)					
Dimension (LxWxH)	89x51x20mm					
Packing	60PCS/CTN. G.W: 7.6kgs					
Cooling Method	Cooling by free air convection					

### MECHANICAL SPECIFICATIONS

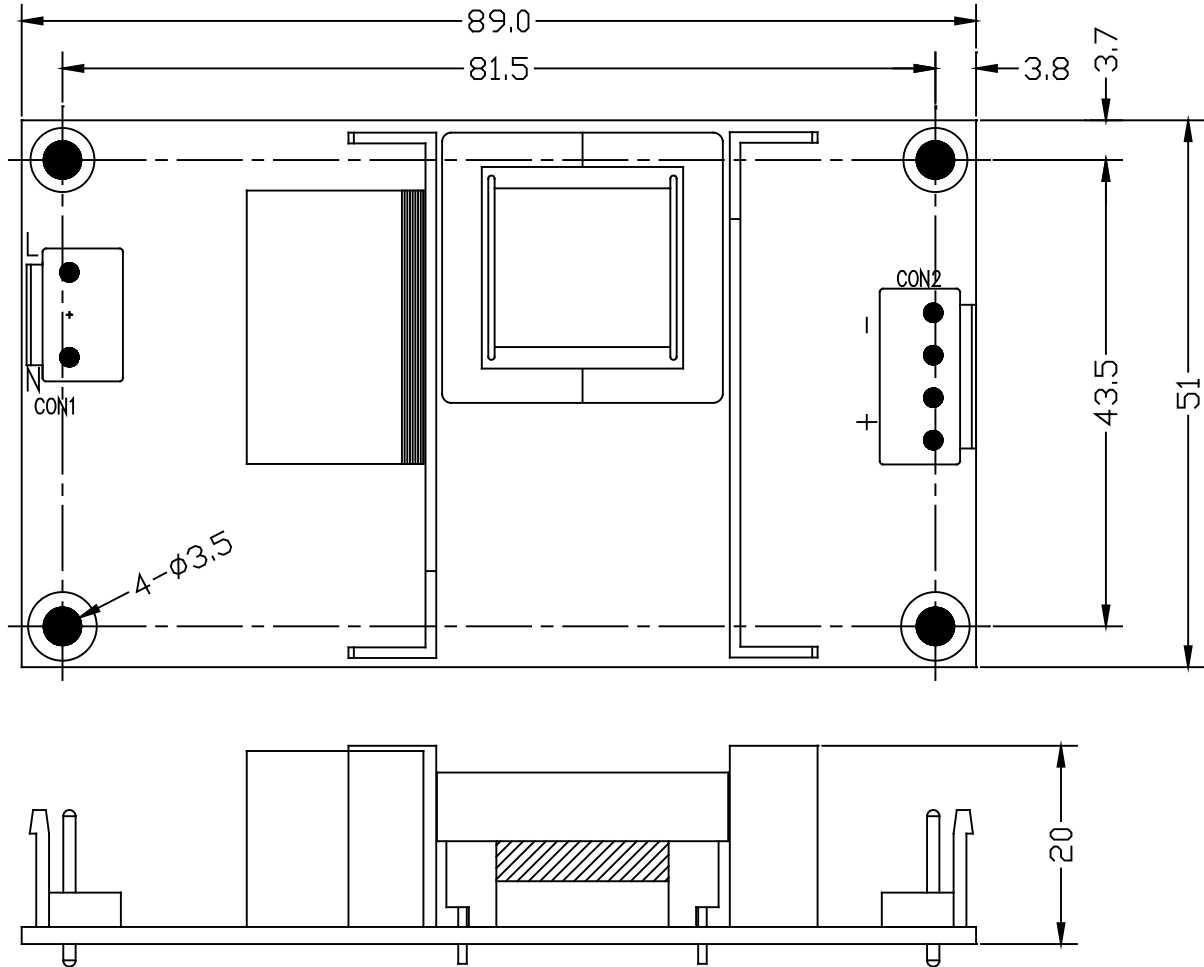

ITEM	CONNECTOR	MATING HOUSING	TERMINAL
AC IN (CON1)	LANDWIN 3961P0300T (CENTER PIN REMOVED)	LANDWIN 3960S OR JST VHR OR MOLEX 51144	LANDWIN 3963T011R OR JST SVH-21T-P1.1 OR MOLEX 50539
DC OUT (CON2)	LANDWIN 3961P0400T		

### DERATING CURVE

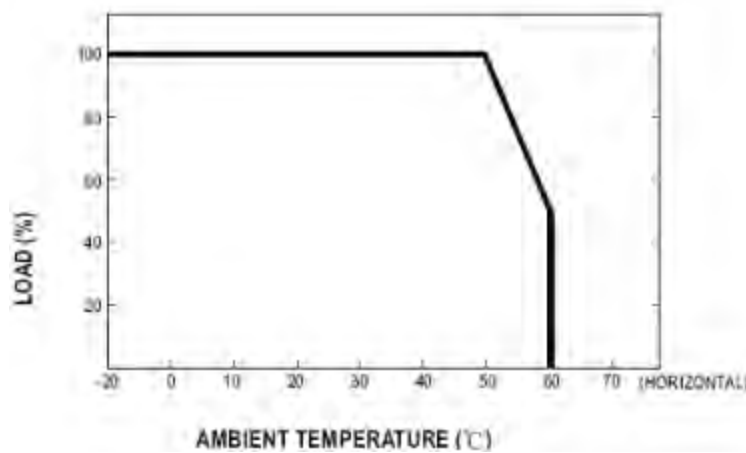

UNIT: mm

# Mouser Electronics

Authorized Distributor

Click to View Pricing, Inventory, Delivery & Lifecycle Information:

[Qualtek:](#)

[QPS-20-5](#) [QPS-20-12](#) [QPS-20-15](#) [QPS-20-24](#) [QPS-20-48](#)