

THIS COPY IS PROVIDED ON A RESTRICTED BASIS AND IS NOT TO BE USED IN ANY WAY DETRIMENTAL TO THE INTERESTS OF PANDUIT CORP.

PANDUIT P/N	WEIGHT
CMB**	.51 LB/100 PCS (232g/100 PCS)
IAPCMBWH-X	

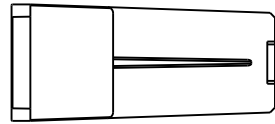

NOTES:

1. SEE CURRENT CATALOG FOR ADDITIONAL PART NUMBER SUFFIXES TO INDICATE COLOR AND OR PACKAGE QUANTITY.
2. SEE CATALOG FOR COMPLETE LIST OF PARTS APPLICABLE FOR USE WITH THIS PART.
3. DIMENSIONS IN PARENTHESES ARE IN METRIC.

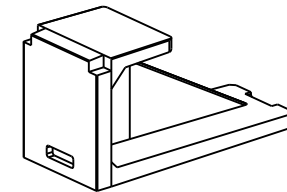
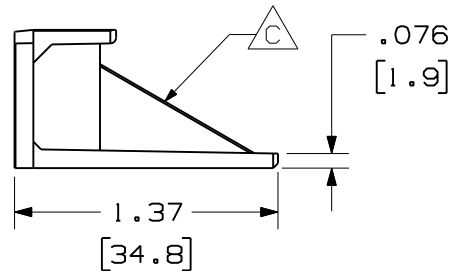
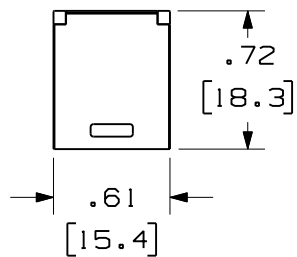

MODEL FILENAME	SIZE
DRAWING FILENAME	A

MINI-COM BLANK MODULE
CUSTOMER DRAWING

PANDUIT[®]
TINLEY PARK, IL 60487

I.I. NUMBER	
PRODUCT SPEC/ PKG SPEC	
ASSY METHOD/ TEST METHOD	
SCALE	NONE
PART NO.	SEE TABLE
DRAWING NO.	35241-01

THIRD ANGLE PROJECTION	ALL DIMENSIONS ARE GIVEN IN INCHES, UNLESS OTHERWISE SPECIFIED. DIMENSIONAL TOLERANCES ARE: (.X) ± (.XXX) ±.010(.3) (.XX) ±.03(.8) ANGLES ±
DRAWN BY DW	REVIEW DRAWING NUMBERS
DATE 06-22-95	MAT'L A ABS
CHK'D CEF	

REV	DATE	BY	CHK	DESCRIPTION	ECN	R	CUST	SUP	OTH
3	6-8-11	BJN	JCO	E. ADDED SUPPLEMENTAL P/N IAPCMBWH-X	35241-01	JCO	JCO		
2	6-14-01	JsP	AMYR	D. WEIGHT WAS .47LB/ 100PCS. C. ADDED RIB TO PART FOR STRENGTH.	35241-01	AMYR	AMYR		
1	08-29-95	DW	CEF	B. CORRECTED WEIGHT. A. REV'D MATERIAL WAS ABS.	35241-01				
R	08-15-95	DW	CEF	RELEASED TO PRODUCTION.	35241-01				

Mouser Electronics

Authorized Distributor

Click to View Pricing, Inventory, Delivery & Lifecycle Information:

Panduit:

[CMBEI-X](#) [CMBIG-X](#) [CMBIW-L](#) [CMBWH-X](#) [CMBWH-L](#) [CMBIW-X](#) [CMBBL-C](#) [CMBAW-L](#) [CMBRG-X](#) [CMBIG-L](#)
[CMBWH-C](#) [CMBIG-C](#) [CMBAW-X](#) [CMBBL-L](#) [CMBEI-L](#) [CMBBU-C](#) [CMBEW-X](#) [CMBEI-C](#) [CMBIW-C](#) [IAPCMBWH-X](#)