

DIMENSIONS mm (inches)

94 maxi (3.700 MAX)

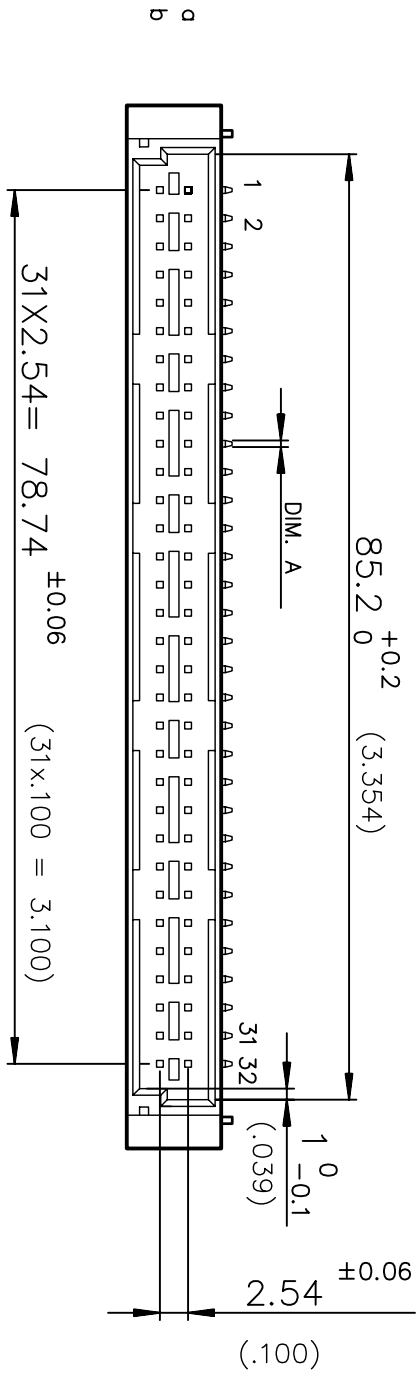
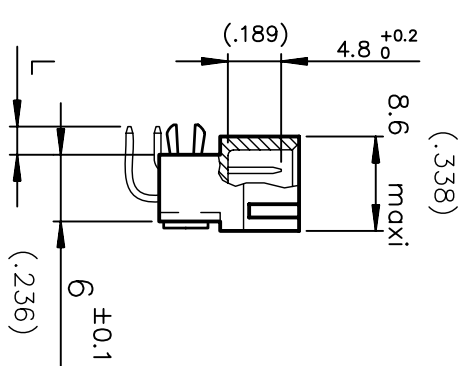
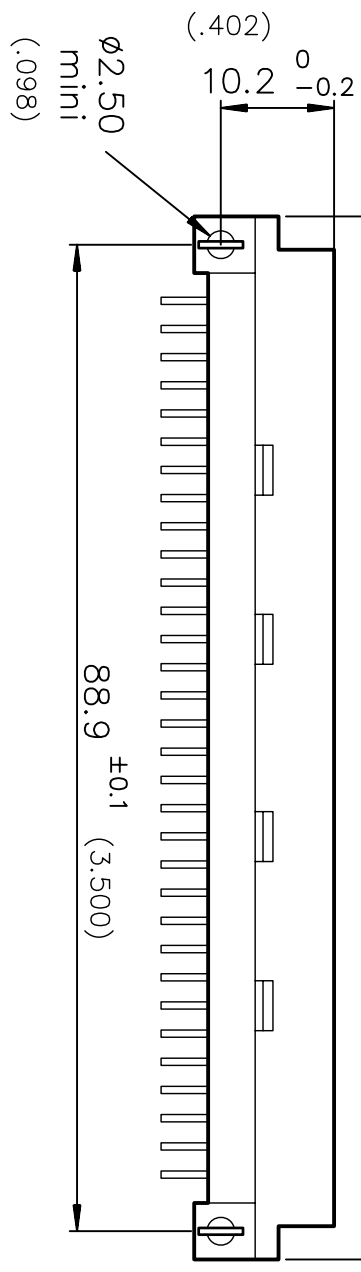

GENERAL CHARACTERISTICS AND ROHS INFORMATIONS:
SEE DRAWING C-8609-0000A

TIN LEAD		LEAD FREE	
8609 264 51 13 755 000 E1	8609 264 51 13 755 E1 LF	Style B header, 64 Position, solder to board, class 2	
8609 264 51 13 765 000 E1	8609 264 51 13 765 E1 LF	Style B header, 64 Position, solder to board, class 1	
8609 264 51 13 H55 000 E1	8609 264 51 13 H55 E1 LF	Style B header, 64 Position, solder to board, class 2, fixing clips	
TIN LEAD		LEAD FREE	
8609 264 51 13 745 000 E1	8609 264 51 13 745 E1 LF	Style B header, 64 Position, solder to board, class 3	
8609 264 51 13 H65 000 E1	8609 264 51 13 H65 E1 LF	Style B header, 64 Position, solder to board, class 1 fixing clips	

Application specific part-numbers: See sheet 2



D

C

B

A

rev	ecn no	dr	date
C	-	ROU	2002/08/30
D	LS05-001	JTA	2005/03/04
E	LS06-0097	LGO	2006/07/11
F	LS07-0033	HLG	2007/02/07
G	I10-0224	SAL	2010-11-19

www.fciconnect.com		surface		tolerance std		projection		Scale	
ROULLARD		ISO 1302		ISO 406 ISO 1101		mm		1.5	
TARON		ANGULAR		UNLESS OTHERWISE SPECIFIED		A3		110-0224	
S ALOSUS		LINEAR		0.X		ECN		-	
BIJU K PAUL		0.XX ±2		0.XXX		DIN 8609		Spec ref -	
Product family		Product family		Product family		Product family		Product family	
RIGHT ANGLE HEADER - STYLE B		SOLDER TO BOARD		C-8609-0288		CUSTOMER		sheet 1 of 2	
FCI logo		Rev. G		Rev. G		Rev. G		Rev. G	

D

C

B

A

PART NUMBER	8609	51	5
PIN OUT		32	64
rows a		1	2
rows a-b			
NUMBER OF CONTACTS			
TERMINATION	L = 2.75 ±0.15 (.108)	A =	B = $\phi 0.8^{+0.3}_0$
	L = 4.15 ±0.15 (.163)	A = 0.6X0.6	B = $\phi 1 \pm 0.1$
OPTIONS	no option		13
	with harpoons	for PCB thickness 1.6 mm	23
PERFORMANCE CLASS			7
DIN 41612 class 3			4
DIN 41612 class 2			5
DIN 41612 class 1			6
TERMINATION TYPE			
TIN LEAD			000E1
LEAD FREE			E1LF

PCB DRILLING

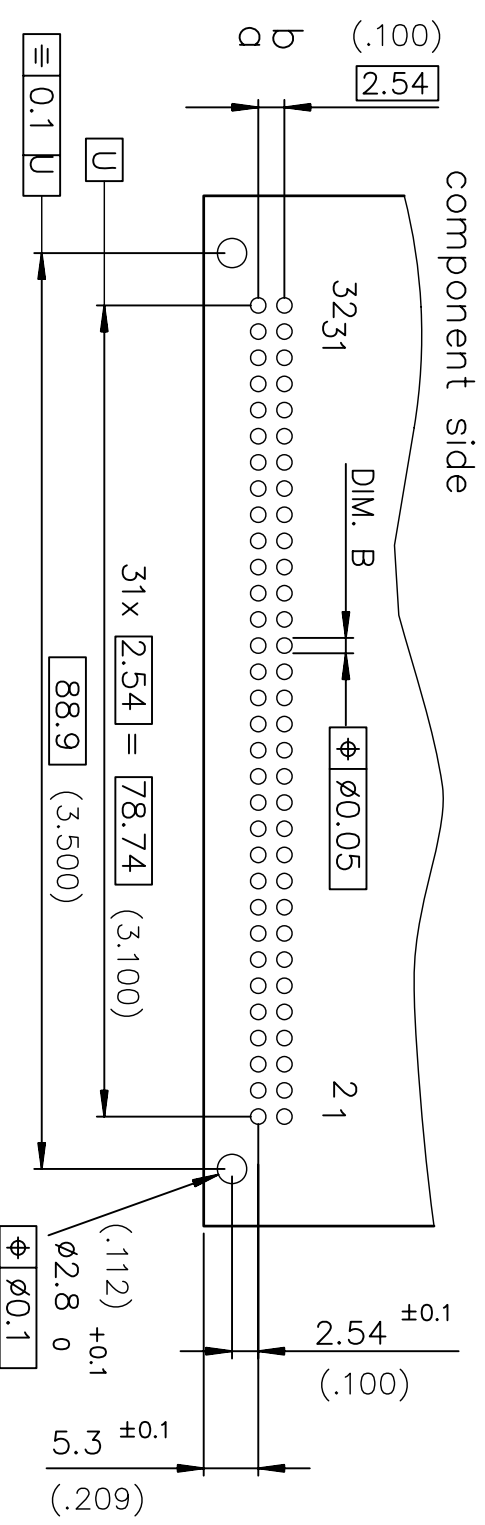

GENERAL CHARACTERISTICS AND ROHS INFORMATIONS:
SEE DRAWING C-8609-0000A

rev	ecn no	dr	date
C	-	ROU	2002/08/30
D	LS05-001	JTA	2005/03/01
E	LS06-0097	LGO	2006/07/11
F	LS07-0033	HLG	2007/02/07
G	110-0224	SAL	2010-11-19

www.fciconnect.com		surface	ISO 1302	tolerance std	ISO 406 ISO 1101	projection	mm
Dr	ROULLARD	ANGULAR	✓	±0.1		⊕	Scale
Eng	TARON	LINEAR		±0.1			1.5
Chr	S ALOSUIS	0.xx' ±2		±0.1	ECN		110-0224
Apr	BlU K PAUL	Product family		DIN 8609	Spec ref		
RIGHT ANGLE HEADER - STYLE B		SOLDER TO BOARD		C-8609-0288		Rev. G	
catalog no				CUSTOMER	sheet	2 of 2	

European Views