

PRODUCT NUMBER	NO. OF POS	DIM K	DIM J	DIM C	DIM W DIM Z
78211-003	LF 3	7.47	5.08	1.35	0.05
78211-004	LF 4	10.01	7.62	1.35	0.05
78211-005	LF 5	12.55	10.16	1.35	0.05
78211-006	LF 6	15.09	12.70	1.35	0.10
78211-007	LF 7	17.63	15.24	1.35	0.10
78211-008	LF 8	20.17	17.78	1.35	0.10
78211-009	LF 9	22.71	20.32	1.35	0.10
78211-010	LF 10	25.25	22.86	1.35	0.10
78211-011	LF 11	27.79	25.40	1.35	0.15
78211-012	LF 12	30.33	27.94	1.35	0.15
78211-013	LF 13	32.87	30.48	1.35	0.15
78211-014	LF 14	35.41	33.02	1.35	0.15
78211-015	LF 15	37.95	35.56	1.35	0.15
78211-103	LF 3	7.47	5.08	2.54	0.05
78211-105	LF 5	12.55	10.16	2.54	0.05
78211-106	LF 6	15.09	12.70	2.54	0.10

NOTES:

- MOLDING MATERIAL : MODIFIED POLYPHELYNENE
COLOR BLACK; UL 94 V0
- LATCH MUST WITHSTAND 18N MIN PULL OUT FORCE
- STANDARD PACKAGING IN POLYBAGS
- TERMINALS MUST BE CRIMPED PROPERLY FOR SATISFACTORY LATCHING :
 - FOR CRIMPING INSTRUCTIONS, SEE TA-75 AND TA-295
 - FOR TERMINAL APPLICATION SEE TA-531.
- THIS HOUSING IS INTENDED FOR USE WITH MINI PV TERMINAL WITH 22-36 GAUGE WIRE
- ROHS COMPLIANT PRODUCT SPECIFICATIONS :
 - MEETS PACKAGING SPECS AS PER GS-14-920
 - PRODUCT MEETS EUROPEAN UNION DIRECTIVES AND OTHER COUNTRY REGULATIONS AS DESCRIBED IN GS-22-008.
 - THE PRODUCT IS NOT INTENDED TO BE EXPOSED TO A MANUFACTURING SOLDER PROCESS.

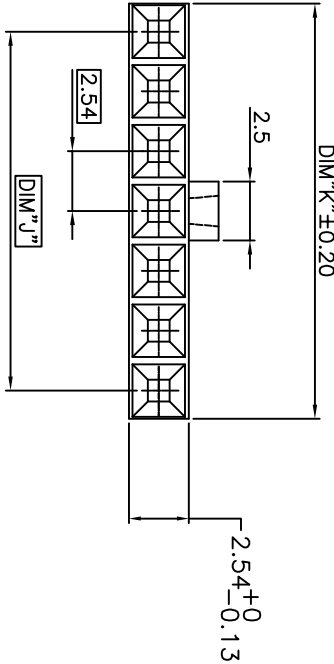
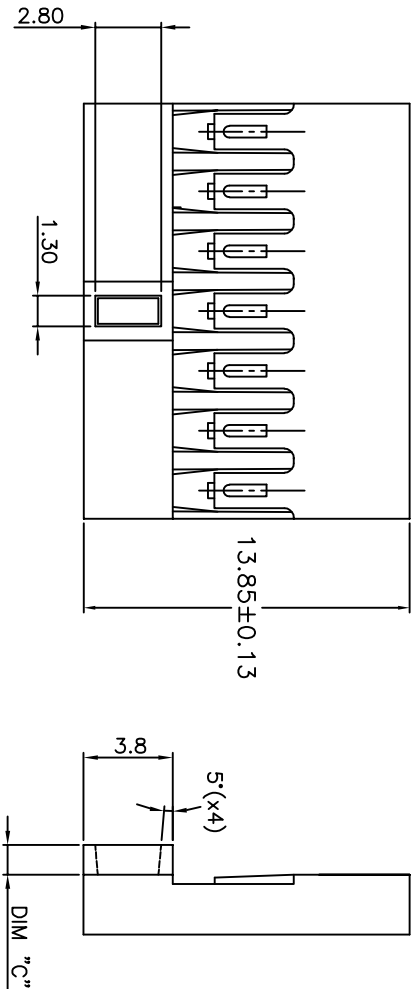

mat'l. code	10036738	surface	ISO 1302	tolerance	ISO 406	ISO 1101	projection	product family	BERGCON
lfr	ecn no	dr	date	tolerances unless otherwise specified	X	±0.3	mm	title	MINI LATCH
K	W7-0533	HTB	07.08.21	linear	.XX	±0.13		HOUSING SR POLARIZED	
L	B-14321	LMU	13.03.21	.XXX	±0.05	scale	5:1	sheet no	78211
M	F-30075	DDE	18.05.03					sheet 1 of 1	A3
		dr	LMULN					size	A3
		eng	L.MULN					customer drawing	
		chr	J.COMPARISON						
		app	LMU						
sheet index	revision	sheet							