

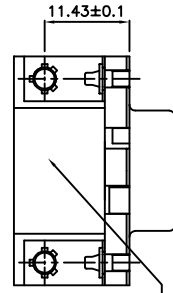

FCIconnect.com

Copyright FCI



Part No&date Code printing

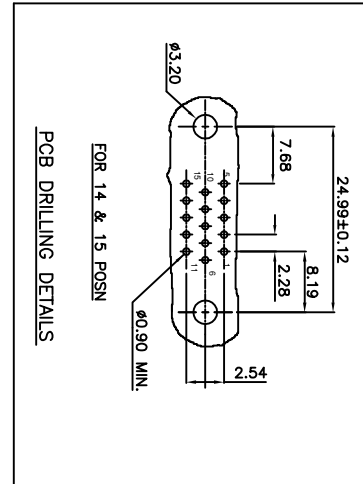
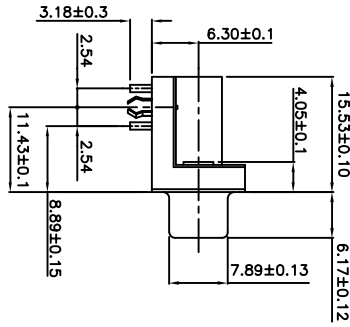
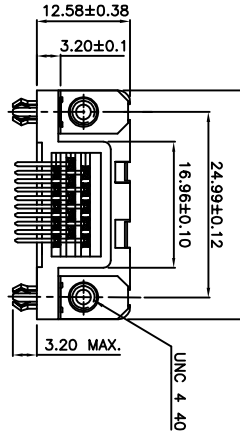

PCB DRILLING DETAILS

TECHNICAL SPECIFICATIONS

- MATERIAL
  - SHELL : STEEL, TIN/ZINC O3 PLATED
  - INSULATORS : SELF EXTINGUISHING BLACK POLYESTER UL CLASS 94V0
- CONTACTS : THE HOUSING WILL WITHSTAND EXPOSURE TO 260-285°C IF WE USE PROTECTIVE ADHESIVE (Type Kapton or Teflon) OR PROTECTIVE METALLIC DEVICE
- PLATING : COPPER ALLOY
- ACTIVE ZONE : GOLD OVER NICKEL
- TERMINATION ZONE : TIN LEAD OVER NICKEL

FOR LEAD FREE PLATING

- METAL BRACKET : 24MINI MATE TIN TOP OVER
- HARPOON : 1.27U MIN NICKEL UNDER PLATE (ON TERMINATION ZONE)
- CLINCH NUT : BRASS, TIN/ZINC O3 PLATED
- SCREW LOCK : BRASS, TIN/ZINC O3 PLATED

ELECTRICAL DATA

- MAX CURRENT RATING : 3A
- TEST VOLTAGE : 1000V
- RATED VOLTAGE : 300V
- CONTACT RESISTANCE : ≤ 25mΩ
- SHELL RESISTANCE : ≤ 5mΩ
- INSULATION RESISTANCE : > 5000MΩ

ENVIRONMENTAL CHARACTERISTICS

- OPERATING TEMPERATURE RANGE : -55°C - +125°C

MECHANICAL CHARACTERISTICS

- MATING UNMATING CYCLES (MIN) : 200 (FLASH Au), 500 (0.76u Au)
- INSERTION/EXTRACTION FORCE PER CONTACT : 5 N MAX, 0.3 N MIN.

"This product meets European Union Directives and other country regulations as described in GS-22-008"

The housing will withstand exposure to 260°C peak temperature for 3.5 seconds in a wave solder application with a 1.6mm minimum thick circuit board.

Packaging as per GS-14-920

ORDERING INFORMATION

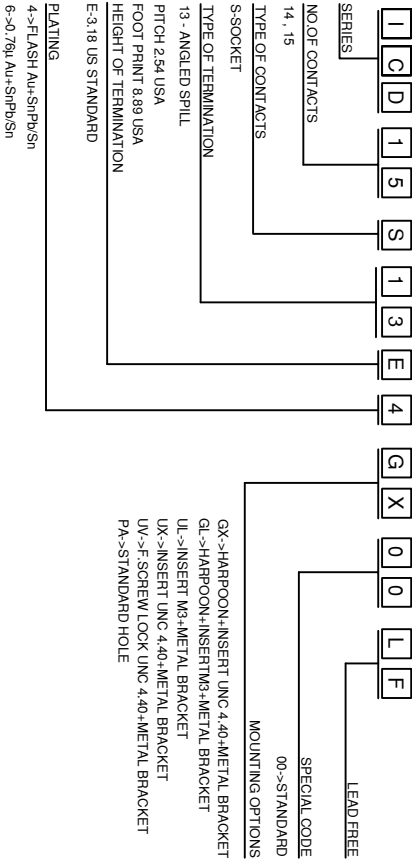

FOR 14 POSN, HOLE NO. 9 IS BLOCKED.

mat'l. code		SEE NOTE 4		surface	tolerance	projection	product family
ltr	ecrn no	dr	date	ISO 1302	ISO 406 ISO 1101	MM	COMPACT D
E	006-0074	GVJ	2006/08/08	tolerances unless otherwise specified			
F	007-0108	AS	2007/09/23	angles			
G	108-0159	AS	2008/11/20	linear	0.03-0.1		
					0.00-0.00X	scale	
				dr	ANSI/SYSLAM	1989/12/16	dwg no
				engr	ANSI/SYSLAM	1989/12/16	sheet 1 of 1
				chr	ANSI/SYSLAM	2008/11/20	A3
				appd	SUDIR, VARMA	2008/11/20	Product Customer Drawing
sheet index	revision	sheet	1				

form: A3

1

2

3

4

5

6