

PRODUCT NO.

SEE TABLE

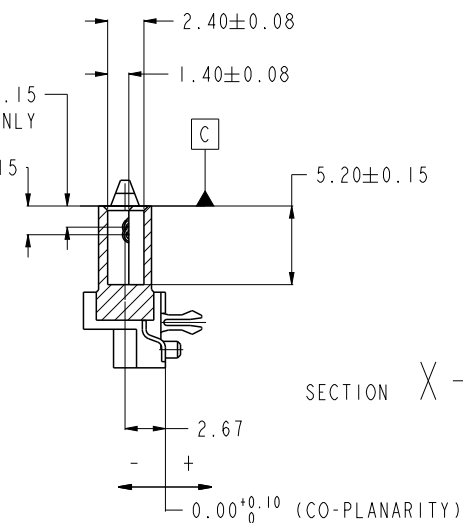
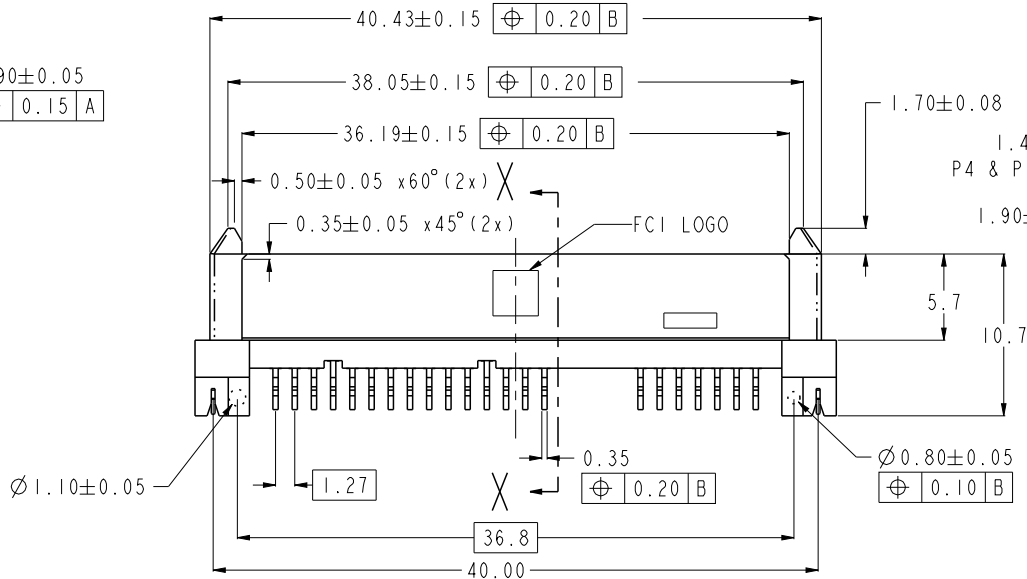
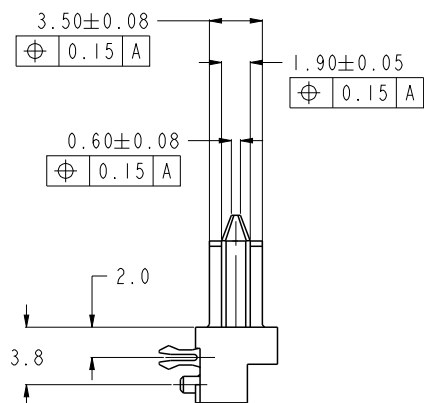
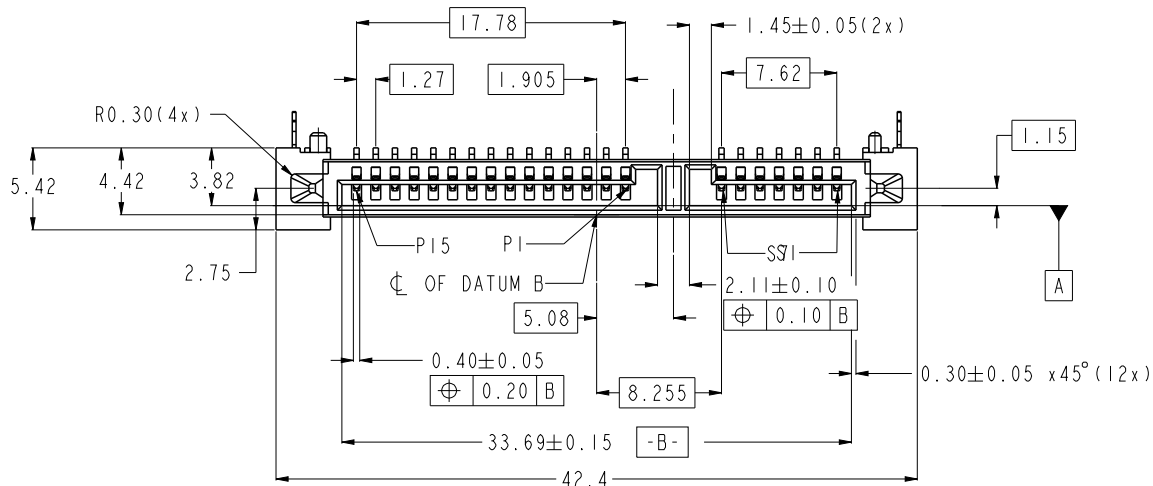

spec ref		dr <a href="#">w cadmin</a> 2006/02/20		projection 	MM ←→	size	scale	
tolerance std ASME Y14.5	TOLERANCES UNLESS OTHERWISE SPECIFIED		eng <a href="#">Koon-Poh Tay</a> 2013/04/10			A4	1:1	
			chr -			ecn no <a href="#">ELX-J-14320-1</a>		
		appr <a href="#">Chen-Hong Tan</a> 2013/04/15		product family -		rel level <b>Released</b>		
surface ✓	linear	0.X	±----		S-ATA COMB RECEPTACLE R/A SMT TYPE ASSY	dwg no 10029364	rev <b>S</b>	
		0.XX	±0.20					
0.XXX	±----							
	angular	0°	±°	<a href="http://www.fci.com">www.fci.com</a>	cat. no. -	Product - Customer Drw		
						sheet 1 of 3		

ProjE File - REV C - 2009-06-09

10029364-00XLF/TRLF

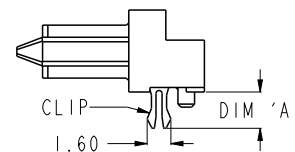
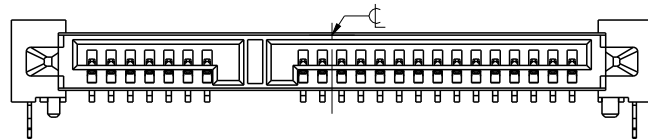

10029364-01XLF/TRLF

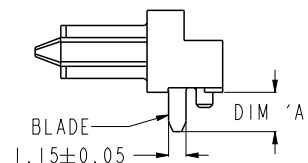
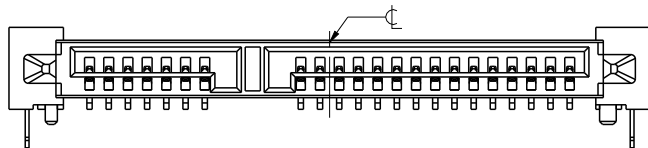

10029364-10XLF/TRLF

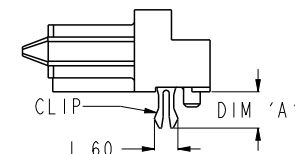
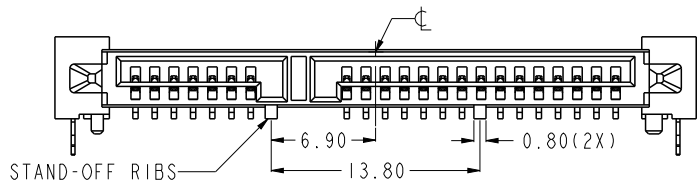

10029364-11XLF/TRLF

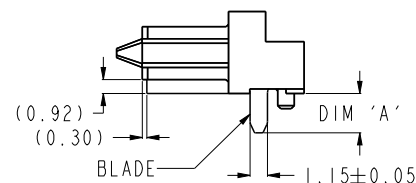
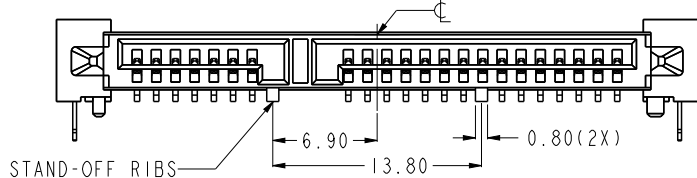

10029364-11XCLEF/C-TRLF

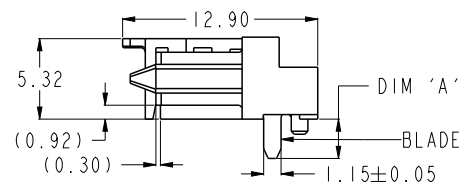
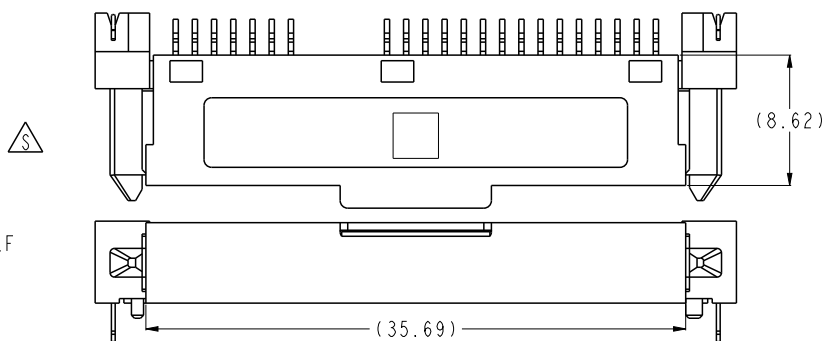

spec ref		dr <a href="#">w wcadmin</a>		2006/02/20		projection		MM		size A4		scale 1:1	
tolerance std		eng <a href="#">Koon-Poh Tay</a>		2013/04/10						ecn no		ELX-J-14320-1	
ASME Y14.5		chr -		-						rel level		Released	
surface ✓		appr <a href="#">Chen-Hong Tan</a>		2013/04/15		product family		-		rev		S	
linear		0.X		±----				title S-ATA COMB RECEPTACLE R/A SMT TYPE ASSY		dwg no 10029364		sheet 2 of 3	
		0.XX		±0.20									
angular		0°		±°									
		www.fci.com		cat. no.		-		Product - Customer Drw		sheet 2 of 3			

ProjE File - REV C - 2009-06-09



Copyright FCI.

PRODUCT NO.	RECOMMENDED P.C.B. THICKNESS	HOLD DOWN	DIM 'A'	HOUSING WITH STAND-OFF RIBS	PACKAGING
10029364-001LF	1.60	METAL CLIP	2.40	NO	TRAY
10029364-001TRLF					TAPE & REEL
10029364-002LF	1.00		NO	TRAY	
10029364-002TRLF				TAPE & REEL	
10029364-102LF			YES	TRAY	
10029364-102TRLF				TAPE & REEL	
10029364-011LF	--	BLADE	2.60	NO	TRAY
10029364-011TRLF					TAPE & REEL
10029364-111LF			YES	TRAY	
10029364-111TRLF					TAPE & REEL
10029364-111CLF				TRAY	
10029364-111C-TRLF				TAPE & REEL	

NOTES:-

1. MATERIAL:

1) HOUSING : HIGH TEMP. THERMOPLASTIC, UL 94V-0  
COLOR : BLACK

2) TERMINAL : COPPER ALLOY  
3) HOLD DOWN : COPPER ALLOY

2. FINISH:

1) TERMINAL : 30u" GOLD PLATING (CONTACT POINT)  
OVER 50u" MIN NICKEL

2) SOLDER TAIL : 100u" MIN TIN OVER 50u" NICKEL  
3) HOLD DOWN : 100u" MIN TIN OVER 50u" NICKEL

3. TRUE POSITION APPLY AT TERMINAL TIP

4. THE STANDARD PACKAGING IS IN TRAY.

5. THE HOUSING WILL WITHSTAND EXPOSURE TO 260°C PEAK TEMPERATURE FOR 10 SECONDS IN A CONVECTION, INFRA-RED OR VAPOR PHASE REFLOW OVEN

6 THIS PRODUCT MEETS EUROPEAN UNION DIRECTIVES AND OTHER COUNTRY REGULATIONS AS DESCRIBED IN GS-22-008

7 PART NUMBERS ENDING IN "LF" ARE MEANT FOR LEAD-FREE IDENTIFICATION. P/N XXXXXXXX-XXXLF IS EQUIVALENT TO PREVIOUS P/N XXXXXXXX-XXX

8. A  $\Delta$  SYMBOL WILL BE NEXT TO ANY DIMENSION, VIEW, OR NOTE WHICH HAS BEEN MODIFIED WITH THE CURRENT DRAWING REVISION.

RECOMMENDED P.C.B. LAYOUT  
TOLERANCE UNLESS OTHERWISE  $\pm 0.10$

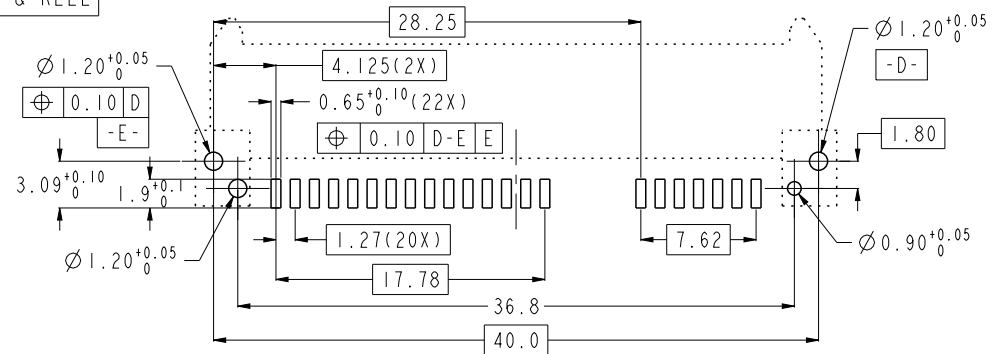

ALTERNATIVE P.C.B. LAYOUT  
REFER TO RECOMMENDED PCB LAYOUT FOR UNSPECIFIED DIMENSIONS  
TOLERANCE UNLESS OTHERWISE  $\pm 0.10$

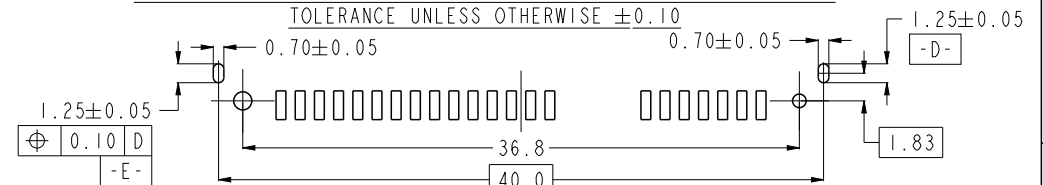

spec ref		dr	w wcadmin	2006/02/20	projection 	MM $\longleftrightarrow$	size	A4	scale	1:1
tolerance std		eng	Koon-Poh Tay	2013/04/10			ecn no	ELX-J-14320-1		
ASME Y14.5		chr	-	-			rel level	Released		
surface $\checkmark$	linear	0.X	$\pm$ ----		product family	-	rev	10029364	S	
		0.XX	$\pm 0.20$							
		0.XXX	$\pm$ ----							
	angular	0°	$\pm$ °		product family	-	Product - Customer Drw	sheet 3 of 3		