

Energy Chain System® E2 Medium Series 26/27/27i Mounting Brackets - Steel



26
27
27i



Option 1: Steel

- Pivoting connections
- One part (two-piece) for all chain widths
- Electrically conductive
- Bolted connection outside of chain cross-section possible

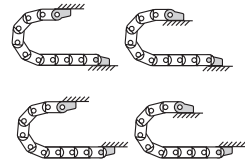
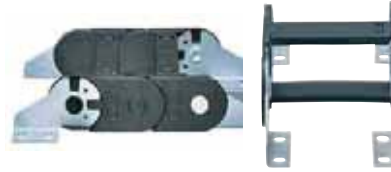
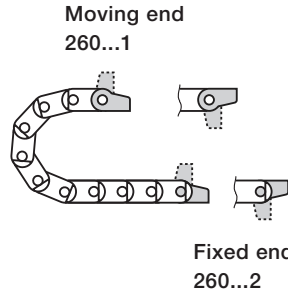

Possible installation configurations -

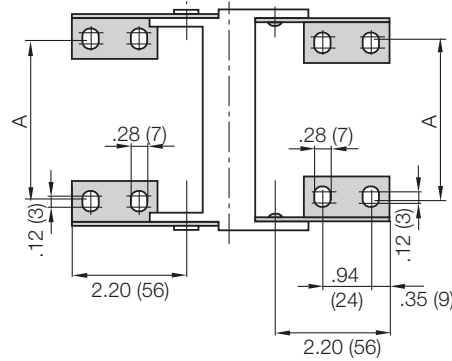
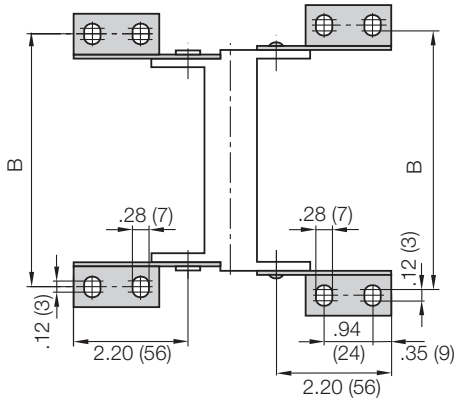

Chain Type	Part No. Full Set	Dimension A		Dimension B	
		in.	(mm)	in.	(mm)
26/27/27i-05	260-12	1.44	(36.5)	3.31	(84)
26/27/27i-07	260-12	2.44	(62)	4.25	(108)
26/27/27i-10	260-12	3.43	(87)	5.24	(133)
26/27/27i-12	260-12	4.41	(112)	6.22	(158)
26/27/27i-15	260-12	5.39	(137)	7.20	(183)
26/27/27i-17	260-12	6.42	(163)	8.23	(209)
26/27/27i-20	260-12	7.40	(188)	9.21	(234)

Part No. Mounting Brackets Full Set

4 parts, 2 with pin, 2 with bore
Series 26/27/27i:
260-12

Part No. Mounting Bracket Moving End

2 parts, 1 left & 1 right
Series 26/27/27i:
260-1

Part No. Mounting Bracket Fixed End

2 parts, 1 left & 1 right
Series 26/27/27i:
260-2

PDF: www.igus.com/e-chain-pdfs
Specs/CAD/RFQ: www.igus.com/e-chains
RoHS info: www.igus.com/RoHS

