



Price index



Cleanroom Class 1 (ISO class 3)  
for Series 14, tested by the Dryden  
Engineering Company, California



Special equipment:  
Electrically conductive ESD/ATEX  
version upon request



UL94-V2 classifications



Easy to assemble and to disassemble



When to use the Series 14:

- For applications with low loads
- Fast installation of the cables



When not to use it:

- For gliding applications  
▶ Series 15 Zipper, page 4.18
- For long unsupported lengths  
▶ Series 15 Zipper, page 4.18

- 1 Snap-open along inner radius with film-hinge
- 2 Flammability class UL V2
- 3 Mounting bracket with strain relief
- 4 Dirt-repellent exterior
- 5 For gliding applications  
▶ Series 15 Zipper, page 4.18
- 6 For longer unsupported lengths  
▶ Series 15 Zipper, page 4.18



Order example complete E-Chain®

Please indicate chain-lengths or number of links Example: 1 m or 33 links

1 m 14.2.038.0



E-Chain®

1 set 114.2.12PZ



Mounting bracket



**Unsupported length**

$FL_G$  = with straight upper run

$FL_B$  = with permitted sag

Further information ► **Design, page 1.12**

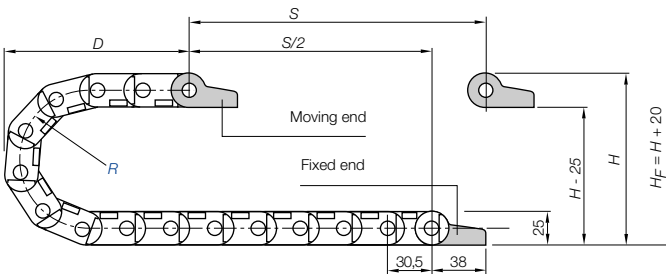
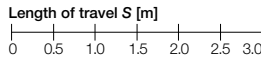
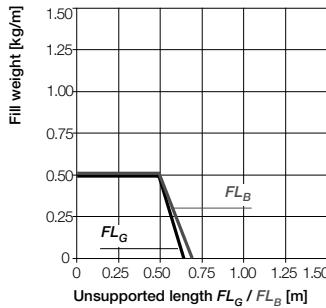
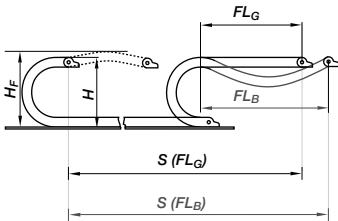

- $S$  = Length of travel
- $R$  = Bending radius
- $H$  = Nominal clearance height
- $H_F$  = Required clearance height
- $D$  = Overlength E-Chain® radius in final position
- $K = \pi \cdot R + \text{"safety"}$



**Short travels - unsupported**

Unsupported E-Chains® feature positive camber over short travels. This must be accounted for when specifying the clearance height  $H_F$ . Please consult igus® if space is particularly restricted.

**Pitch = 30,5 mm/link Links/m = 33 (1.006,5 mm) Chain length =  $S/2 + K$**

R	028	038	048	075	100	125
H	82	102	122	177	227	277
D	71	81	91	120	145	170
K	150	185	215	300	375	455

The required clearance height:  
 $H_F = H + 20$  mm  
 (with 0,5 kg/m fill weight)



E2 mini  
Inner height: 20 mm

Phone +49- (0) 22 03-96 49-800  
Fax +49- (0) 22 03-96 49-222



**Technical Data**

Speed / acceleration $FL_G$	max. 20 [m/s] / max. 200 [m/s²]
Speed / acceleration $FL_B$	max. 3 [m/s] / max. 6 [m/s²]
Gliding speed / acceleration (maximum)	max. 3 [m/s] / max. 10 [m/s²]
Material - permitted temperature °C	igumid G / -40° up to +120° C
Flammability class, igumid NB	VDE 0304 IIC UL94 V2



**Details of material properties**  
 ► page 1.38



► page 5.47

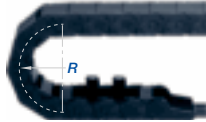
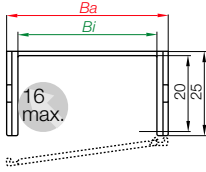

Series 14 E-Chain® - snap-open along inner radius

Part No.	Bi [mm]	Ba [mm]	R [mm]	Bending radii	Weight [kg/m]
14.1. <input type="text"/> .0	15	26	<input type="text"/>	<input type="text"/> <input type="text"/> <input type="text"/> <input type="text"/> <input type="text"/> <input type="text"/>	≈ 0,31
14.2. <input type="text"/> .0	25	36	<input type="text"/>	<input type="text"/> <input type="text"/> <input type="text"/> <input type="text"/> <input type="text"/> <input type="text"/>	≈ 0,32
14.3. <input type="text"/> .0	38	49	<input type="text"/>	<input type="text"/> <input type="text"/> <input type="text"/> <input type="text"/> <input type="text"/> <input type="text"/>	≈ 0,40
14.4. <input type="text"/> .0	50	61	<input type="text"/>	<input type="text"/> <input type="text"/> <input type="text"/> <input type="text"/> <input type="text"/> <input type="text"/>	≈ 0,41

Supplement Part No. with required radius. Example: 14.2.  .0

0 = standard color, other colors ▶ page 1.39 · Pitch = 30,5 mm/link - Links/m = 33

Part No. structure

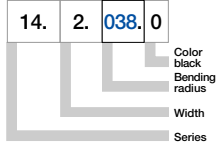



**Option Polymer, one-piece**

- One-piece mounting bracket
- Corrosion-resistant
- Available preassembled
- Inner and outer attachment possible
- Available with or without strain relief tiewrap plates

Moving end with bore (outer link) 114...1P(Z)

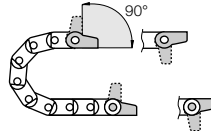

114...2P(Z) Fixed end with pin (inner link)



Possible installation conditions for assembled mounting brackets ▶ Order example "preassembled" below

114...1P(Z)  
Moving end

114...2P(Z)  
Fixed end

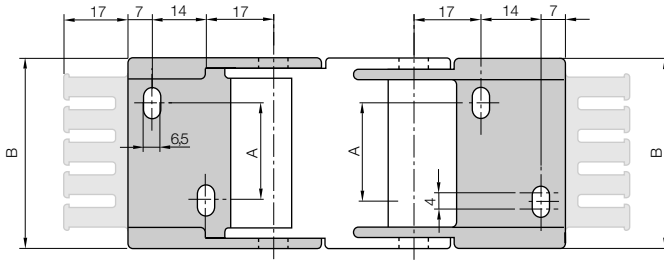

**Dimensions and order configurations**

Strain relief is possible on the moving end and/or the fixed end.

**Part No. structure**

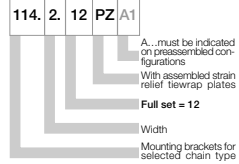

**Full set, for both ends:**

114.2.12PZ +tiewrap plate

**Single-part order:**

114.2.1PZ +tiewrap plate

Mounting bracket with bore

114.2.2PZ +tiewrap plate

Mounting bracket with pin

For E-Chain®	Part No. full set with tiewrap plate	Part No. full set without tiewrap plate	Dim. A [mm]	Dim. B [mm]
14.1. ▶	114.1.12PZ	114.1.12P	-	26,3
14.2. ▶	114.2.12PZ	114.2.12P	10	36,3
14.3. ▶	114.3.12PZ	114.3.12P	23	49,3
14.4. ▶	114.4.12PZ	114.4.12P	35	61,3

For the preassembled mode please add the index A1 ... A4 e.g. 114.2.12PZA1



**Quicksnap** - the complete, detachable mounting unit, upon request



**Quickfix** - mounting bracket with dowel, upon request

**Additional Features**



▶ page 5.47

Phone +49- (0) 22 03-96 49-800  
Fax +49- (0) 22 03-96 49-222