

PRODUCT NUMBER
65043-0XX(E)LF

PIN STYLE
SEE SHEET 2

INDICATES THE PRODUCT IS ROHS COMPLIANT, SEE NOTE 6

65043-YYXLF OR 65043-YYXELF ARE EXACTLY THE SAME PRODUCTS. EXTENSION "E" JUST FOR OLD EUROPEAN DESIGN AND MANUFACTURING SITE

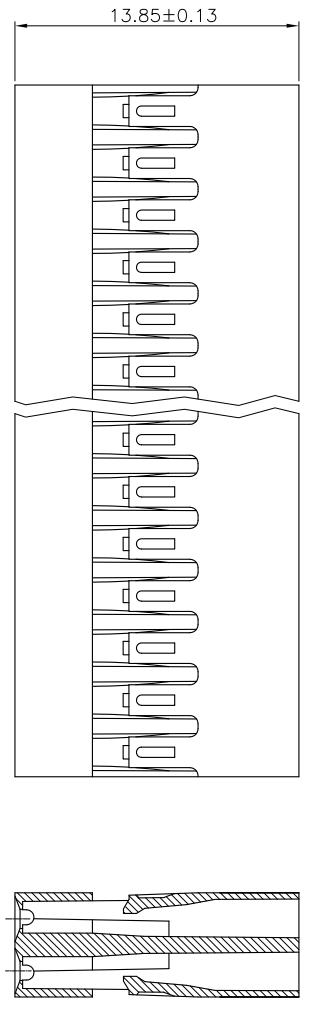

NOTES:

1. MOLDING MATERIAL : MODIFIED POLYPHELYENE
COLOR BLACK, UL 94 V0
2. LATCH MUST WITHSTAND 18N MIN PULL OUT FORCE
3. STANDARD PACKAGING IN POLYBAGS
4. TERMINALS MUST BE CRIMPED PROPERLY FOR SATISFACTORY LATCHING :
 - FOR CRIMPING INSTRUCTIONS, SEE TA-75 AND TA-295
 - FOR TERMINAL APPLICATION SEE TA-531.
 PRODUCT SPECIFICATION: BUS-12-067.
5. THIS HOUSING IS INTENDED FOR USE WITH MINI PV TERMINAL WITH 22-36 GAUGE WIRE
6. ROHS COMPLIANT PRODUCT SPECIFICATIONS :
 - MEETS PACKAGING SPECS AS PER GS-14-920
 - PRODUCT MEETS EUROPEAN UNION DIRECTIVES AND OTHER COUNTRY REGULATIONS AS DESCRIBED IN GS-22-008.
 - THE PRODUCT IS NOT INTENDED TO BE EXPOSED TO A MANUFACTURING SOLDER PROCESS.

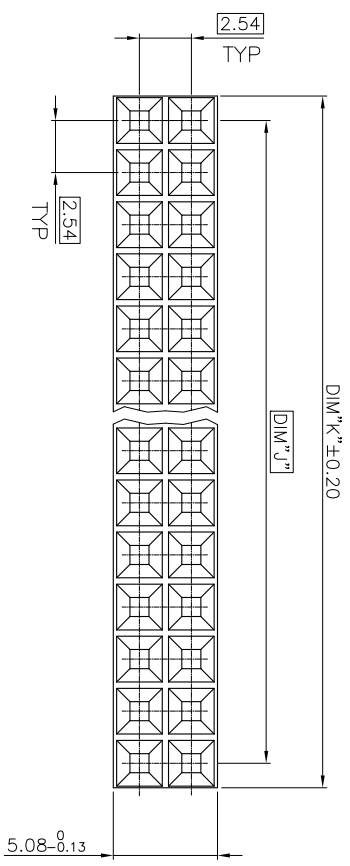

mat'l code		SEE NOTES		surface	tolerance	projection	product family	
ltr	ecn no	dr	date	ISO 902	ISO 406 ISO 1011	mm	BERCONN	title
BG	K08-0022LMU		08.01.15	tolerances unless otherwise specified	X ±0.3	mm		MINI LATCH HOUSING
BH	F12-0064LMU		12.06.08		.xx ±0.13	mm		DOUBLE ROW 2.54mm
BU	B-14321 LMU		13.03.21		xxx ±0.05	mm		
		dr		L.MULIN		scale	5:1	dwg no
		engr		L.MULIN				65043
		chr		JCO				sheet 1 of 2
		appd						size
sheet	revision	BU	BH					A3
index	sheet	1	2					

1 2 3 4 5 6

PIN STYLE	No. OF POS.	DIM J	DIM K
35	2x02	2.54	4.93
34	2x03	5.08	7.47
33	2x04	7.62	10.01
32	2x05	10.16	12.55
31	2x06	12.70	15.09
30	2x07	15.24	17.63
29	2x08	17.78	20.17
28	2x09	20.32	22.71
27	2x10	22.86	25.25
26	2x11	25.40	27.79
25	2x12	27.94	30.33
24	2x13	30.48	32.87
23	2x14	33.02	35.41
22	2x15	35.56	37.95
21	2x16	38.10	40.49
20	2x17	40.64	43.03
19	2x18	43.18	45.57
18	2x19	45.72	48.11
17	2x20	48.26	50.65
16	2x21	50.80	53.19
15	2x22	53.34	55.73
14	2x23	55.88	58.27
13	2x24	58.42	60.81
12	2x25	60.96	63.35
11	2x26	63.50	65.89
10	2x27	66.04	68.43
09	2x28	68.58	70.97
08	2x29	71.12	73.51
07	2x30	73.66	76.05
06	2x31	76.20	78.59
05	2x32	78.74	81.13
04	2x33	81.28	83.67
03	2x34	83.82	86.21
02	2x35	86.36	88.75
01	2x36	88.90	91.29

Item A3 1 2 3 4 5 6

PDS: Rev: B1

STATUS: Released Printed: Nov 15, 2013

mat'l. code	SEE NOTES	surface	ISO 302	tolerance	ISO 406 ISO 1011
lfr	ecn no	dr	date	ISO 406 ISO 1011	
BG	W08-0022HTB		08.01.15	tolerances unless otherwise specified	
BH	F12-0064LMU		12.06.08	linear	.xx #0.13
				xxx	#0.05
		dr	L.MULIN		11.01.10
		engr	L.MULIN		11.01.10
		chr			
		appl	L.MU		11.01.10
sheet	revision				
index	sheet				



projection
mm
scale 5:1

product family
BERCONN

title
MINI LATCH HOUSING
DOUBLE ROW 2.54mm

dwg no
65043

sheet 2 of 2

size
A3

type
CUSTOMER Drawing