

PRODUCT NUMBER
SEE SHEET 3

1 | 2

3

4

Tous droits strictement réservés. Reproduction ou communication à des tiers interdite sous quelque forme que ce soit sans autorisation écrite du propriétaire. Propriété de c.FCI. Droits de reproduction FCI.



All rights strictly reserved. Reproduction or issue to third parties in any form whatever is not permitted without written authority from the proprietor. Property of FCI. Copyright FCI.

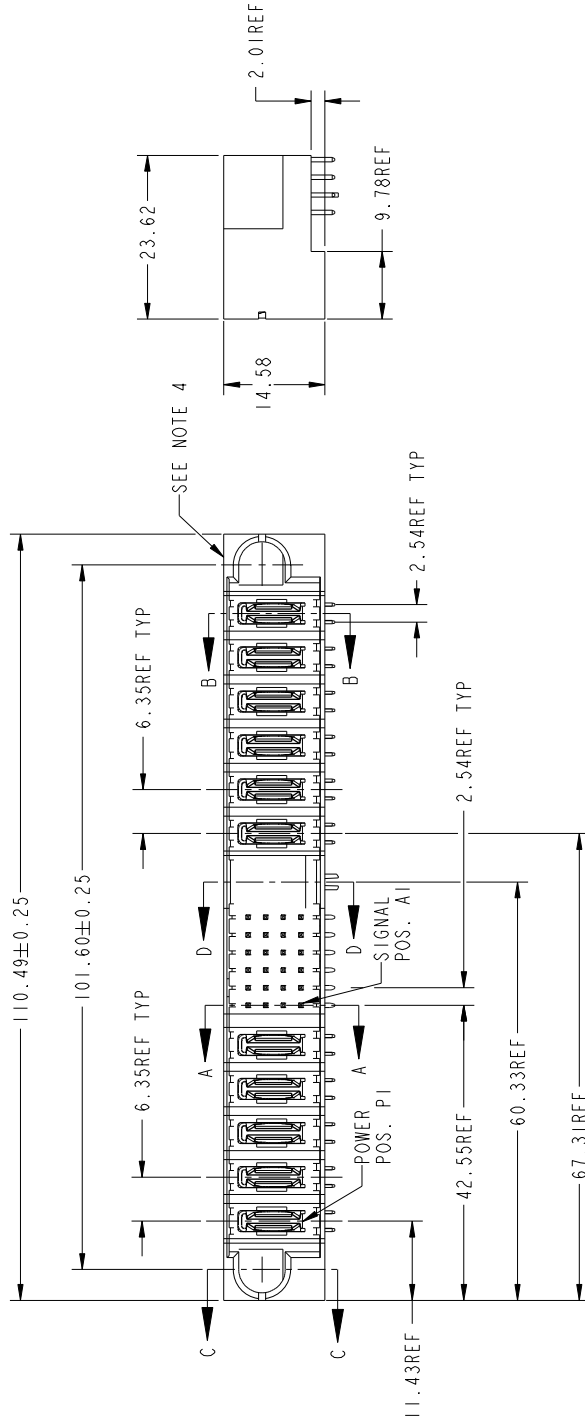

mat'l code		SEE NOTES		tolerances unless otherwise specified		CUSTOMER		FCI	
lfr	ecrn no.	dr	date	linear	0. XX ± 0.13	projection	copy	title	www.fciconnect.com
M	0605-012	6wJM	05/17/05					5P + 24S + 1M + 6P	
N	0605-019	6wJM	06/14/05		.XXX ± .051			RIGHT ANGLE SOLDER HEADER	
P	0605-0338	SW	09/19/05	angles	0° ± 2°			product family	PWRBLADE
R	0605-0387	CS	10/20/05	dr	D. WOLFORD	01-28-99		size	2 13
S	0605-0454	CS	11/11/05	engr	J. BROWN	01-28-99		sheet	2 of 4
T	0608-0239	JC	09/12/08	chr	J. BROWN	01-28-99		scale	1 : 1
revision	sheet	1	1	1	1	1			
2	2	2	2	2	2	2			
3	3	3	3	3	3	3			
4	4	4	4	4	4	4			
sheet index		Pro/E		3		cage code		22526	
								4	

1 | 2

3

4

PRODUCT NUMBER
 51624-XX00X--
 Note: (2)

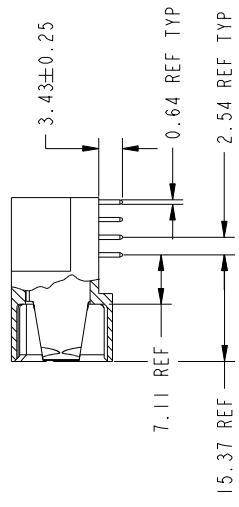
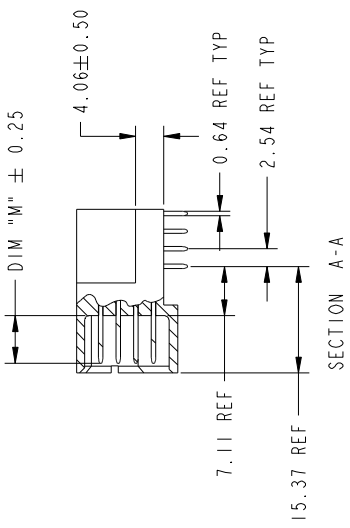

- CONNECTOR NOTES:
 1. HOUSING MATERIAL: UL 94 V-0 GLASS FILLED HIGH TEMP THERMOPLASTIC
 POWER CONTACT MATERIAL: COPPER ALLOY
 SIGNAL CONTACT MATERIAL: COPPER ALLOY
 2. PLATING:
 △ SEE ITEM 1 & 2 IN PRINT 10064183 FOR PLATING SPEC OF 51624-XX00X AND 51624-XX00XLF RESPECTIVELY
 3. PRODUCT SPECIFICATION 6S-12-149
 4. "MANUFACTURER" NAME, P/N, AND DATE CODE TO APPEAR ON THIS SURFACE

- PCB NOTES:
 5. ALL DIMENSIONS ARE BASIC UNLESS OTHERWISE SPECIFIED.
 6. ALL THROUGH HOLES ARE LOCATED WITH A TRUE POSITION OF 0.004 [0.10]
 7. ALL HOLE DIAMETERS ARE FINISHED HOLE SIZE
 8. Ø0.098 [2.49] AND Ø0.126 [3.20] THROUGH HOLES ARE UNPLATED.
 9. Ø0.0453±0.0010 [1.151±0.025] DRILLED HOLES PLATED WITH 0.0003 [0.008] MIN SnPb OVER 0.001 [0.03] TO 0.003 [0.08] Cu PLATING TO ACHIEVE A Ø0.040±0.003 [1.02±0.07] HOLE.
 10. A△SYMBOL WILL BE NEXT TO ANY DIMENSION, VIEW, OR NOTE WHICH HAS BEEN MODIFIED WITH THE CURRENT DRAWING REVISION.

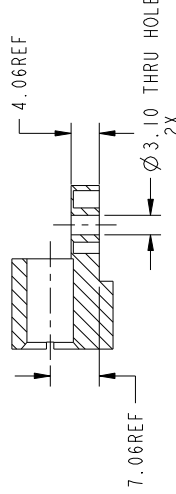

mat'l code		SEE NOTES		tolerances unless otherwise specified		CUSTOMER		FCI	
lfr	ecrn no.	dr	date	linear	angles	projection	copy	title	www.fciconnect.com
T				0.X ±0.3	°.XXX ±.051	MM	CPY	5P + 24S + 1M + 6P RIGHT ANGLE SOLDER HEADER	
				dr	0° ±2°			product family	PWRBLADE
				dr	D. WOLFORD			dwg no	51624
				engr	J. BROWN			size	2 1/3
				chr	J. BROWN			sheet	2 of 4
				appd	J. BROWN			scale	1:1
sheet	revision								
index	sheet								
			Pro/E			3		cage code	22526
						4			



All rights strictly reserved. Reproduction or issue to third parties in any form whatsoever is not permitted without written authority from the proprietor. Property of FCI. Copyright FCI.

Tous droits strictement réservés. Reproduction ou communication à des tiers interdite sous quelque forme que ce soit sans autorisation écrite du propriétaire. Propriété de FCI. Droits de reproduction FCI.

PRODUCT NUMBER
51624-XX00X:--
NOTE: (2)

1 | 2

3 |

4

Tous droits strictement réservés. Reproduction ou communication a des tiers interdite sous quelque forme que ce soit sans autorisation écrite du propriétaire. Propriete de c.FCI. Droits de reproduction FCI.



All rights strictly reserved. Reproduction or issue to third parties in any form whatsoever is not permitted. Copyright FCI.

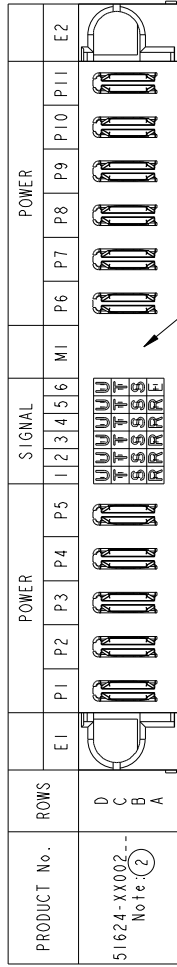
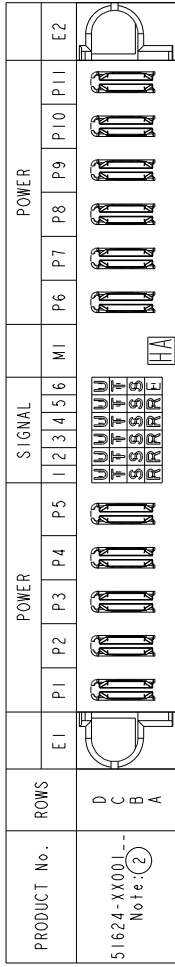

A

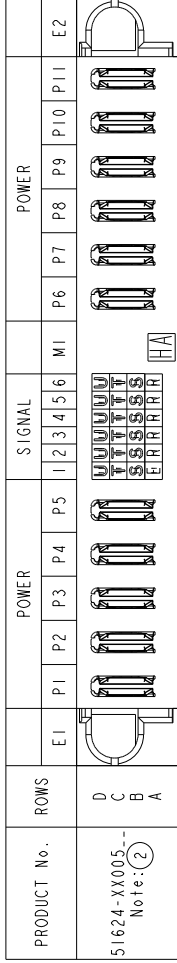

B

CODE	DIM "M" ±0.25	CONTACT TYPE
PA	[N/A]	POWER
R	[6.86]	SIGNAL
S	[6.86]	SIGNAL
T	[6.86]	SIGNAL
U	[6.86]	SIGNAL
E	[5.59]	SIGNAL
HA	[N/A]	HOLD-DOWN

FCI		www.fciconnect.com	
Title		5P + 24S + 1M + 6P RIGHT ANGLE SOLDER HEADER	
product family		PWRBLADE	
size		2.3	
sheet		3 of 4	
product family		PWRBLADE	
code		51624	
dwg no		A	
sheet		3 of 4	
cage code		22526	
Pro/E		3	
sheet index		3	
revision		1:1	
scale		Scale	
chr		J. BROWN	
appr		J. BROWN	
date		01-28-99	
engr		01-28-99	
dr		D. WOLFORD	
angles		0° ±2°	
linear		.XXX ±.051	
date		0.X ±0.3	
dr		0.X ±0.3	
ecm no.		T	
tolerances unless otherwise specified		SEE NOTES	
CUSTOMER		COPY	

1 | 2

3 |

4

Pro/E 3
sheet index 3
revision 1:1
scale Scale
chr J. BROWN
appr J. BROWN
date 01-28-99
engr 01-28-99
dr D. WOLFORD
angles 0° ±2°
linear .XXX ±.051
date 0.X ±0.3
dr 0.X ±0.3
ecm no. T
tolerances unless otherwise specified
CUSTOMER COPY
Title 5P + 24S + 1M + 6P
RIGHT ANGLE SOLDER HEADER
product family PWRBLADE
code 51624
size 2.3
sheet 3 of 4
cage code 22526

PRODUCT NUMBER
51624-XX00X--
NOTE: (2)

Tous droits strictement réservés. Reproduction ou communication à des tiers interdite sous quelque forme que ce soit sans autorisation écrite du propriétaire.
Property of FCI. Copy right FCI. Reproduction or issue to third parties in any form whatever is not permitted without written authority from the proprietor.

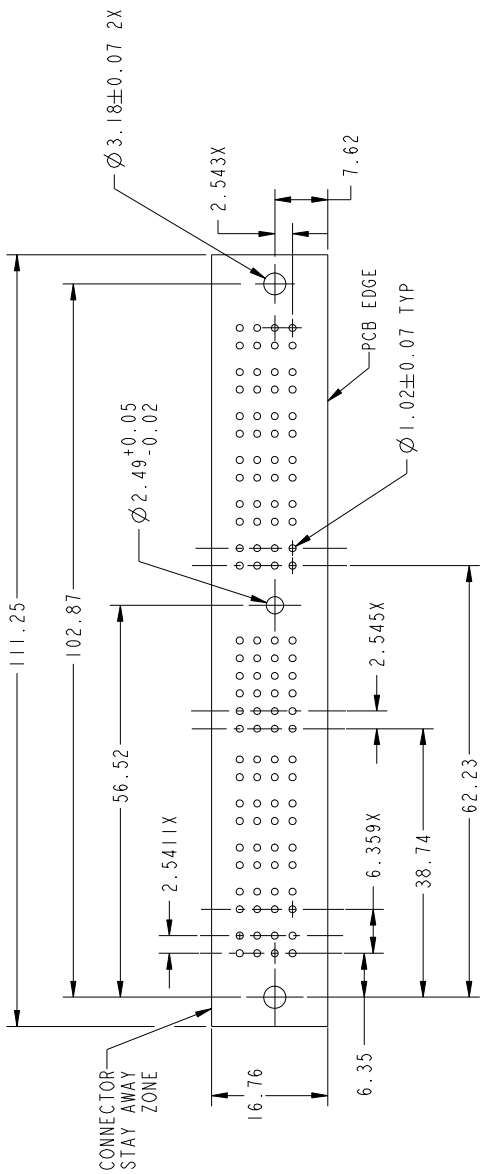

RECOMMENDED PCB LAYOUT

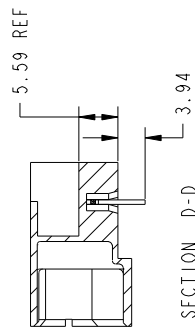

mat'l code		SEE NOTES		tolerances, unless otherwise specified		CUSTOMER		FCI		www.fciconnect.com	
l/r	ecn no.	dr	date	linear	angles	dr	engr	chr	appd	projection	title
T				0. XX ±0.13	0° ±2°	D. WOLFORD	J. BROWN	J. BROWN	J. BROWN	5P + 24S + 1M + 6P	RIGHT ANGLE SOLDER HEADER
						01-28-99	01-28-99	01-28-99	01-28-99	MIN	product family
											PWRBLADE
											size
											2 1 3
											sheet
											4
											code
											51624
											code
											22526
											4

CONFIDENTIAL

1 | 2

Pro/E

3 |

code code 22526

4