

**PLEASE CHECK WWW.MOLEX.COM FOR LATEST PART INFORMATION**

**Part Number:** **0190440168**  
**Status:** **Active**  
**Overview:** High-Temperature Temp Terms Terminals and Splices  
**Description:** Krimptite Ring Tongue Terminal for 14-16 Heavy Duty AWG Wire

**Documents:**

<a href="#">3D Model</a>	<a href="#">Product Specification PS-19902-011-001 (PDF)</a>
<a href="#">Drawing (PDF)</a>	<a href="#">Product Specification PS-19902-013-001 (PDF)</a>
<a href="#">3D Model (PDF)</a>	<a href="#">RoHS Certificate of Compliance (PDF)</a>

**Agency Certification**

CSA	LR18689
UL	E32244

**General**

Product Family	Ring and Spade Terminals
Series	19044
Comments	Heavy Duty
Crimp Quality Equipment	Yes
Overview	<u>High-Temperature Temp Terms Terminals and Splices</u>
Product Name	Krimptite
Type	Ring
UPC	800755060348

**Physical**

Barrel Type	Closed
Insulation	None
Material - Plating Mating	Tin
Net Weight	2.250/g
Packaging Type	Bag
Plating min - Mating	2.540µm
Plating min - Termination	2.540µm
Stud Size	5/16" (M8)
Termination Interface: Style	Crimp or Compression
Wire Size AWG	14, 16
Wire Size mm <sup>2</sup>	1.30-2.00

**Material Info**

Engineering Number	B-130-56HD
--------------------	------------

**Reference - Drawing Numbers**

Product Specification	PS-19902-011-001, PS-19902-013-001
Sales Drawing	SD-19044-008-001

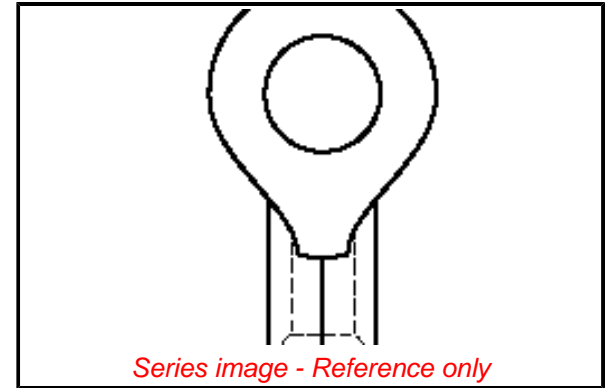

**EU ELV**

**Not Relevant**

**EU RoHS**

**Compliant**

**REACH SVHC**

Not Contained Per -  
D(2021)4569-DC (8  
July 2021)

**Halogen-Free**

**Status**

**Low-Halogen**

For more information, please visit [Contact US](#)

China ROHS

ELV

RoHS Phthalates

**China RoHS**

Green Image

Not Relevant

Not Contained

**Search Parts in this Series**

19044 Series

**Application Tooling | FAQ**

*Tooling specifications and manuals are found by selecting the products below. Crimp Height Specifications are then contained in the Application Tooling Specification document.*

**Global**

Description	Product #
PremiumGrade Hand Crimp Tool for Krimptite/Versakrimp Terminals and Splices, 10-22 AWG and 6.0mm <sup>2</sup> - 0.5mm <sup>2</sup>	<a href="#">640030100</a>
Crimp Head for the AT-200 Pneumatic Hand Tool	<a href="#">640070100</a>
ServiceGrade Hand Crimp Tool - Ratchet	<a href="#">640160038</a>

This document was generated on 08/27/2021

**PLEASE CHECK [WWW.MOLEX.COM](http://WWW.MOLEX.COM) FOR LATEST PART INFORMATION**