

Series 82 Illuminated pushbutton Ø 22 mm stainless steel 304, with illuminated symbol.

Part No: 82-6151.1A24.B005

Technical data



Mounting cut-out	22 mm
Terminal	Soldering terminal, 2.8 x 0.5 mm
Shape of illumination	Symbol
Operating voltage (LED)	24 V DC
OperatingTravel	ca. 3 mm
Lens illumination	illuminative
Lens colour	Silver
Lens shape	flush
Lens material	Plastic metalised
Lens optics	opaque
Front bezel shape	flush
Front bezel material	Stainless steel
Weight	0.025 kg
Contact material	Silver
Illumination colour	Blue
Kind of illumination	Single-LED
Switching action	Momentary
Switching system	Snap-action switching element
Symbol	Bell
Contacts	1C- 30 °C ... + 70 °C
Operating temperature	CB, CCC, C UL, UL
Approbations	4 ... 7 N
Operating force	Damp heat, 21 days according to IEC 60512-11
Climate resistance	240 V AC
Switching Voltage	3 A
Switching Current	

Dimensions

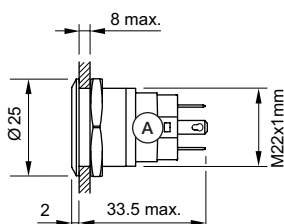

Mounting cut-outs

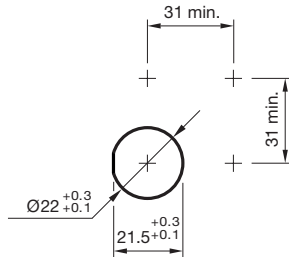

Wiring diagrams

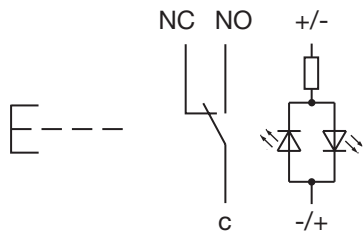

Component layouts

