

CUSTOMER PRINT

PART NUMBER: W6380-XPG-P-3XX

NOTES:

1. ALL PARTS TO BE BULK PACKED.
2. CONTACTS ARE SUPPLIED UNASSEMBLED
3. ALL DIMENSIONS ARE REFERENCE EXCEPT THOSE WITH A TOLERANCE
4. DIMENSIONS IN BRACKETS [] ARE IN MILLIMETERS

ASS'Y P/N	GROMMET SIZE
W6380-XPG-P-311	CABLE O.D. .09-.14 [2.3 - 3.6]
W6380-XPG-P-315	CABLE O.D. .15-.17 [3.8 - 4.3]
W6380-XPG-P-318	CABLE O.D. .18-.20 [4.6 - 5.1]
W6380-XPG-P-321	CABLE O.D. .21-.23 [5.3 - 5.8]

ASSEMBLY P/N	CONTACTS
W6380-2PG-P-3XX	2 #16
W6380-3PG-P-3XX	3 #16
W6380-4PG-P-3XX	4 #16
W6380-XPG-P-3XX	

GROMMET SIZE FOR SINGLE GROMMET OR "DC" FOR DAISY CHAIN

NUMBER OF CONTACTS

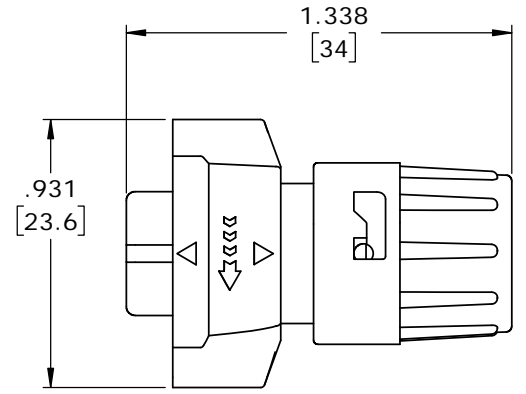

SHOWN ASSEMBLED
FOR CUSTOMER REFERENCE ONLY

DAISY CHAIN GROMMETS
FOR W6380-XPG-P-3DC
.125 I.D. FOR CABLES .09-.14 [2.3 - 3.6] O.D.
.188 I.D. FOR CABLES .18-.20 [4.6 - 5.1] O.D.
.250 I.D. FOR CABLES .24-.26 [6.1 - 6.6] O.D.

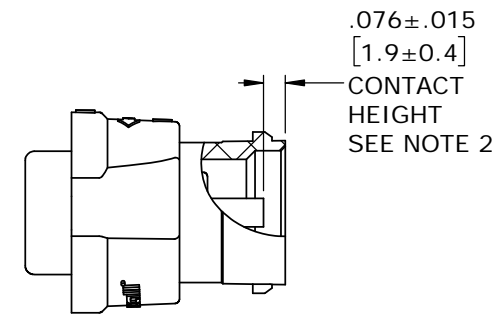

.076±.015
[1.9±0.4]
CONTACT
HEIGHT
SEE NOTE 2

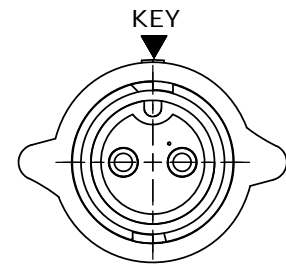
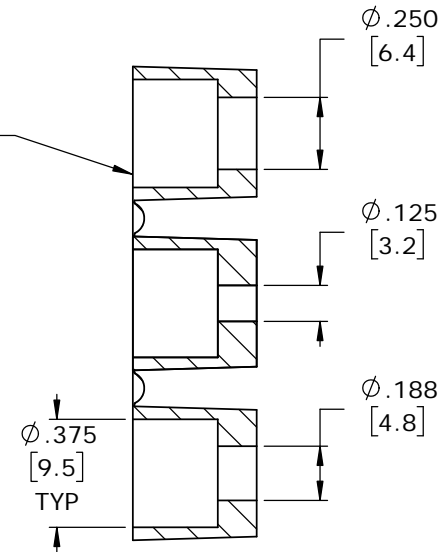

MATING FACE
W6380-2PG-P-3XX SHOWN

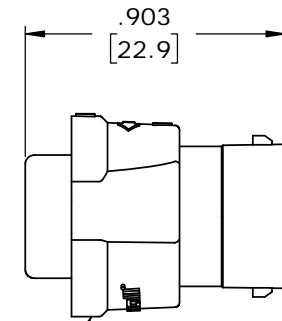

CABLE-END HOUSING
MAT'L: UV PBT, BLACK
COUPLING RING
MAT'L: UV PBT, BLACK
O-RING
MAT'L: SILICONE, RED
SPRING
MAT'L: STAINLESS STEEL

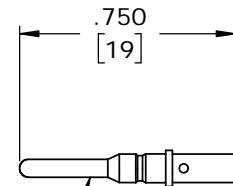

(2-4) #16 PIN CONTACT, CRIMP
MAT'L: COPPER ALLOY, GOLD PLATED

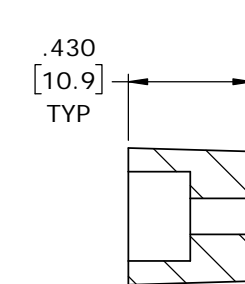

GROMMET
MAT'L: SANTOPRENE, BLACK

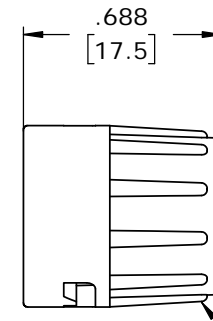

BACKSHELL
MAT'L: UV PBT, BLACK

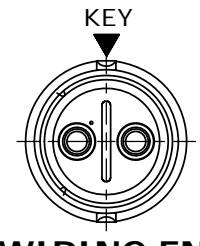

WIRING END
W6380-2PG-P-3XX SHOWN
WITHOUT HARDWARE

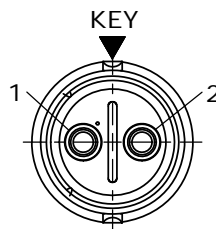

WIRING END
W6380-2PG-P-3XX

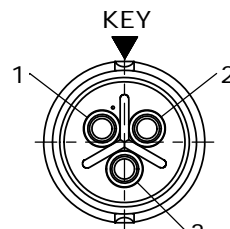

WIRING END
W6380-3PG-P-3XX

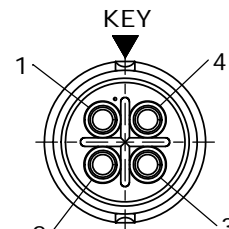

WIRING END
W6380-4PG-P-3XX

CUSTOMER APPROVAL

THIS DOCUMENT CONTAINS CONFIDENTIAL INFORMATION PROPRIETARY TO CONXALL CORPORATION. ANY REPRODUCTION, DISCLOSURE, OR USE OF THIS DOCUMENT /INFORMATION IS EXPRESSLY PROHIBITED UNLESS AUTHORIZED IN WRITING BY CONXALL CORPORATION.

APPROVED BY: _____
DATE: _____

RoHS COMPLIANT

REV.	INIT.	DATE	DESCRIPTION
A	MA	02-28-20	RELEASED PER PDR 16014-7
	PNK	11-25-19	BACKSHELL P/N 6284 CHANGES TO 6284V4
	PNK	05-10-19	PDR 16014

ALL INFORMATION ILLUSTRATED IS THE PROPERTY OF "CONXALL CORPORATION". UNAUTHORIZED DUPLICATION OR DISTRIBUTION OF THIS DOCUMENT IS PROHIBITED.	ORIG. DRAWN BY: PNK DATE: 05-10-19	
ALL UNITS ARE IN FEET, INCHES, FRACTION OF INCHES AND DECIMALS. UNLESS OTHERWISE SPECIFIED TOLERANCES: 3 PLACE DECIMALS ±.010 ANGLES ±1° FRACTIONS ±1/16 - CRITICAL CHARACTERISTIC FLAG PER SPEC. XXXX	CHECKED BY:	
APPROVED BY:	APPROVED BY:	TITLE: CABLE-END ASSEMBLY 2-4 #16 PIN CONTACTS, CRIMP INSTA-CLICK™ MINI-CON-X STANDARD PRODUCT
SCALE: NTS	SIZE: B	SHEET: 1 OF 1
FILE: W6380-XPG-P-3XX	DIRECTORY: SLW	CUSTOMER: W6380-XPG-P-3XX



601 E. WILDWOOD VILLA PARK, IL 60181

Mouser Electronics

Authorized Distributor

Click to View Pricing, Inventory, Delivery & Lifecycle Information:

Switchcraft:

[W6380-3PG-P-3DC](#) [W6380-4PG-P-311](#) [W6380-3PG-P-315](#) [W6380-2PG-P-318](#) [W6380-2PG-P-321](#) [W6380-3PG-P-318](#) [W6380-2PG-P-315](#) [W6380-4PG-P-318](#) [W6380-2PG-P-3DC](#) [W6380-2PG-P-311](#) [W6380-3PG-P-321](#) [W6380-4PG-P-3DC](#) [W6380-4PG-P-321](#) [W6380-3PG-P-311](#) [W6380-4PG-P-315](#)