

"Explosionszeichnung als Referenz,  
Polzahl siehe description"  
"Exploded drawing for reference,  
pole count see description"

A3

Druckschraube  
pressing screw

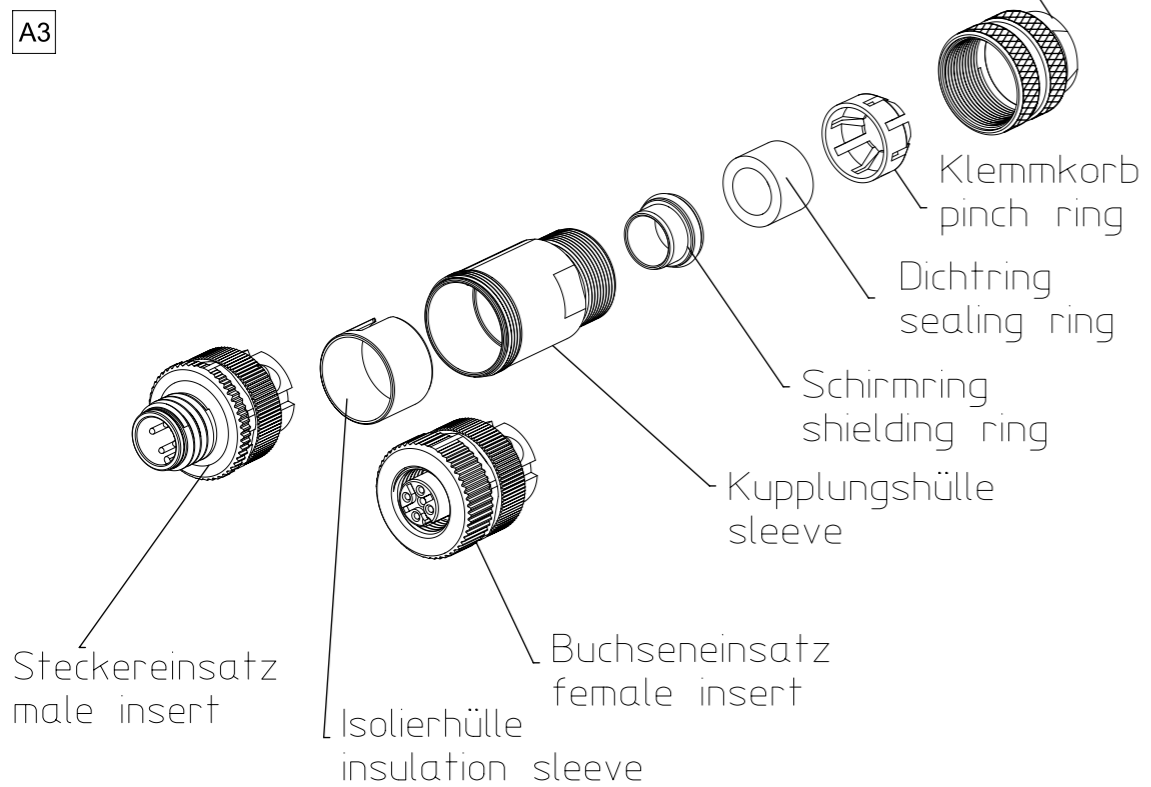

CHANGES SEE  
REVISION MARKING A3

NOTES/CHANGE IN PIN  
NUMBERS

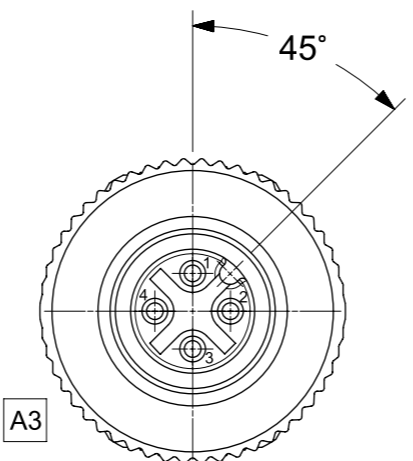

A3

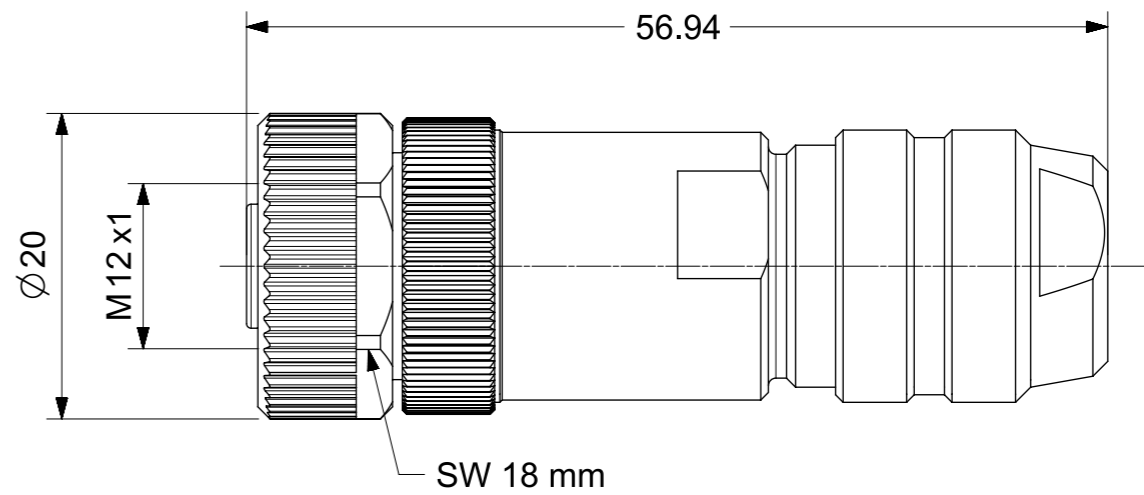

NOTES:

- 1. LOCKING SYSTEM: SCREW  
WIRE GAUGE: 0.75mm<sup>2</sup>  
CABLE OUTLET: 6 - 8mm
- 2. ELECTRICAL DATA:  
CURRENT RATING: 4A  
VOLTAGE RATING: 250V
- 3. MECHANICAL:  
OPERATING TEMP.: -40°C to +85°C  
PROTECTION CLASS: IP67
- 4. MATERIAL:  
CONTACT: CuZn (BRASS)  
CONTACT PLATING: Au (GOLD)  
HOUSING: zinc die cast  
COUPLING NUT: CuZn (BRASS)

PRE-RELEASE  
REFERENCE  
USE ONLY

ENG.-NO: 8A4S00-32

THIS DRAWING CONTAINS INFORMATION THAT IS PROPRIETARY TO MOLEX ELECTRONIC TECHNOLOGIES, LLC AND SHOULD NOT BE USED WITHOUT WRITTEN PERMISSION

<b>QUALITY SYMBOLS</b> FA = 0 FE = 0 FP = 0 FV = 0 FC = 0 FX = 0 FS = 0 FT = 0	EC NO: 107393 DRWN: LRAMAMURTHY CHK'D: APPR:	2016/08/10 2015/07/01	<b>GENERAL TOLERANCES (UNLESS SPECIFIED)</b> ANGULAR TOL ± 1.0 ° 4 PLACES ± 3 PLACES ± 2 PLACES ± 0.05 1 PLACE ± 0.3 0 PLACES ± 0.5	DIMENSION UNITS: MM SCALE: 2:1	  FA M12 4P AC FE STR SCR SHLD  PRODUCT CUSTOMER DRAWING SERIES: 120071 MATERIAL NUMBER: 1200710033 CUSTOMER: GENERAL MARKET DOCUMENT NUMBER: 1200710033 DOC TYPE: PSD DOC PART: 000 SHEET NUMBER: 1 OF 1	
	EC NO: 107393 DRWN: LRAMAMURTHY CHK'D: APPR:	2016/08/10 2015/07/01	DRWN BY: MSCHWARZ DATE: 2015/07/01 CHK'D BY: DATE: APPR BY: DATE:	DRAFT WHERE APPLICABLE MUST REMAIN WITHIN DIMENSIONS		DRAWING SIZE: A3 THIRD ANGLE PROJECTION
	EC NO: 107393 DRWN: LRAMAMURTHY CHK'D: APPR:	2016/08/10 2015/07/01	DRWN BY: MSCHWARZ DATE: 2015/07/01 CHK'D BY: DATE: APPR BY: DATE:	DRAFT WHERE APPLICABLE MUST REMAIN WITHIN DIMENSIONS		DRAWING SIZE: A3 THIRD ANGLE PROJECTION
	EC NO: 107393 DRWN: LRAMAMURTHY CHK'D: APPR:	2016/08/10 2015/07/01	DRWN BY: MSCHWARZ DATE: 2015/07/01 CHK'D BY: DATE: APPR BY: DATE:	DRAFT WHERE APPLICABLE MUST REMAIN WITHIN DIMENSIONS		DRAWING SIZE: A3 THIRD ANGLE PROJECTION
	EC NO: 107393 DRWN: LRAMAMURTHY CHK'D: APPR:	2016/08/10 2015/07/01	DRWN BY: MSCHWARZ DATE: 2015/07/01 CHK'D BY: DATE: APPR BY: DATE:	DRAFT WHERE APPLICABLE MUST REMAIN WITHIN DIMENSIONS		DRAWING SIZE: A3 THIRD ANGLE PROJECTION

RELEASE STATUS	RQ	RELEASE DATE	25.08.2016	14:38:21
----------------	----	--------------	------------	----------