

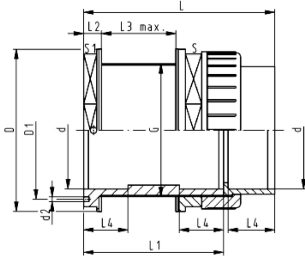

Tank adaptor type 050 PVC-U
Union with solvent cement socket metric

Model:

- Gaskets: flat gaskets EPDM
- Washer: PP
- Run-out holes: two holes in octagonal head
- FKM flat gaskets available for tank adaptor type 050



| d (mm) | PN (bar) | Code | SP | Weight (kg) |
|-----------|-------------|--------------------|----|----------------|
| 16 | 16 | 161 050 245 | 1 | 0.064 |
| 20 | 16 | 161 050 246 | 1 | 0.070 |
| 25 | 16 | 161 050 247 | 1 | 0.100 |
| 32 | 16 | 161 050 248 | 1 | 0.196 |
| 40 | 16 | 161 050 249 | 1 | 0.328 |
| 50 | 16 | 161 050 250 | 1 | 0.395 |
| 63 | 16 | 161 050 251 | 1 | 0.530 |

| d (mm) | L (mm) | L2 (mm) | L1 (mm) | D (mm) | L3 max (mm) | Diameter of bore in tank side (mm) | S1 (mm) | L4 (mm) | d2 (mm) | D1 (mm) | S (mm) | G (inch) |
|-----------|-----------|------------|------------|-----------|-------------------|---|------------|------------|------------|------------|-----------|-------------|
| 16 | 77 | 11 | 58 | 44 | 19 | 28 | 40 | 14 | 5 | 29 | 32 | 3/4 |
| 20 | 83 | 12 | 61 | 54 | 17 | 35 | 50 | 16 | 5 | 35 | 40 | 1 |
| 25 | 90 | 13 | 65 | 60 | 18 | 43 | 55 | 19 | 5 | 42 | 50 | 1 1/4 |
| 32 | 95 | 13 | 67 | 69 | 19 | 49 | 65 | 22 | 5 | 49 | 56 | 1 1/2 |
| 40 | 104 | 13 | 72 | 84 | 16 | 61 | 80 | 26 | 5 | 59 | 69 | 2 |
| 50 | 113 | 15 | 76 | 92 | 16 | 67 | 85 | 31 | 5 | 70 | 76 | 2 1/4 |
| 63 | 128 | 15 | 84 | 108 | 19 | 83 | 100 | 38 | 5 | 82 | 95 | 2 3/4 |

The technical data are not binding. They neither constitute expressly warranted characteristics nor guaranteed properties nor a guaranteed durability. They are subject to modification. Our General Terms of Sale apply.

Georg Fischer Piping Systems Ltd, Postfach, CH-8201 Schaffhausen/Switzerland

Phone +41 -(0)52-631 1111

e-mail: info.ps@georgfischer.com

Internet: <http://www.gfps.com>