

DESCRIPTION: FEMALE - SOLDER CUP / MACHINED - ECONOMY

WILL ACCEPT 26-20 AWG WIRE

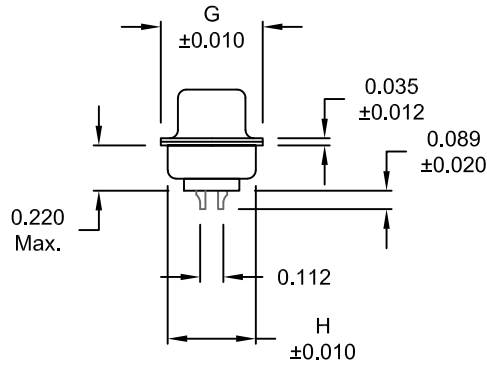
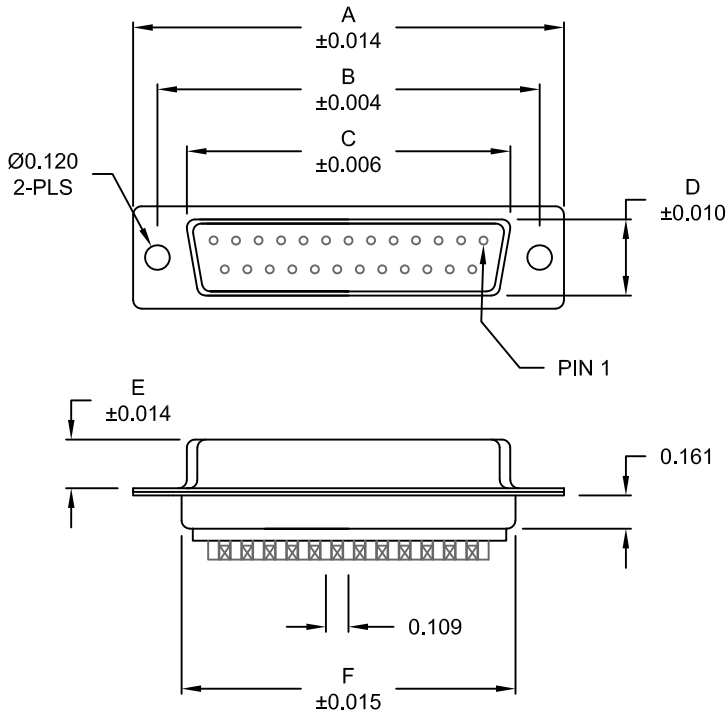

No. OF PINS	DIMENSIONS							
	A	B	C	D	E	F	G	H
9	1.213	0.984	0.642	0.311	0.236	0.756	0.496	0.427
	30.80	24.99	16.30	7.90	5.99	19.20	12.60	10.85
15	1.541	1.312	0.970	0.311	0.236	1.091	0.496	0.427
	39.15	33.32	24.65	7.90	5.99	27.70	12.60	10.85
25	2.087	1.852	1.512	0.311	0.236	1.618	0.496	0.427
	53.00	47.04	38.40	7.90	5.99	41.10	12.60	10.85
37	2.728	2.500	2.157	0.311	0.236	2.256	0.496	0.427
	69.30	63.50	54.80	7.90	5.99	57.30	12.60	10.85
50	2.638	2.406	2.055	0.429	0.240	2.169	0.602	0.527
	67.00	61.11	52.20	10.90	6.10	55.10	15.30	13.39

172-EYY-20YRY1

- SERIES _____
 POSITIONS _____
 E09
 E15
 E25
 E37
 E50
 GENDER _____
 2 = FEMALE
 TERMINATION _____
 0 = SOLDER CUP
 SHELL PLATING _____
 2 = TIN
 3 = NICKEL
 RoHS COMPLIANT _____
 HARDWARE OPTIONS _____
 00 = NO HARDWARE
 01 = .098" CLINCH NUT (SOLDER SIDE)
 02 = .236" CLINCH NUT (SOLDER SIDE)
 03 = .236" CLINCH NUT (MATING SIDE)
 05 = .237" 4-40 BOARD LOCK
 91 = .237" 4-40 SPACER/ BOARD LOCK
 PLATING OPTIONS _____
 1 = GOLD FLASH
 2 = 30MICRO-INCH GOLD

MATERIAL:

SHELL: STEEL, NICKEL OR TIN PLATED
 INSULATOR: UL 94V-O RATED PA6T
 PROCESS TEMP.: 260°C
 CONTACT: BRASS

ELECTRICAL:

CURRENT RATING: 5 AMPS
 CONTACT RESISTANCE: 15 mOhms Max.
 INSULATION RESISTANCE: 1,000 MOhms min.
 VOLTAGE: 500VAC FOR 1 MINUTE
 TEMPERATURE: -55° C TO 125° C

DO NOT SCALE FROM DRAWING



THESE DRAWINGS AND SPECIFICATIONS ARE THE PROPERTY OF NorComp AND SHALL NOT BE REPRODUCED, COPIED OR USED AS THE BASIS FOR THE MANUFACTURE OF SALE OF APPARATUS WITHOUT WRITTEN PERMISSION.

DRAWN: PAM JENKINS		DATE: 11-28-05	
SCALE: NTS	SHEET 1	OF 2	REV 12
DWG NO. 172-EYY-20YRY1			

RoHS COMPLIANT

NorComp

DESCRIPTION: CLINCH NUT HARDWARE

TOLERANCE:
ALL DIMENSIONS ARE ± 0.010

ALL CLINCH-NUTS ARE 4-40 INTERNAL THREADS

01X 0.098" (SOLDER SIDE)

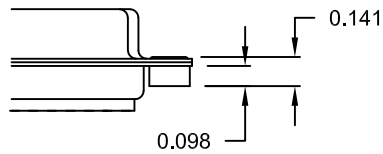

02X 0.236" (SOLDER SIDE)

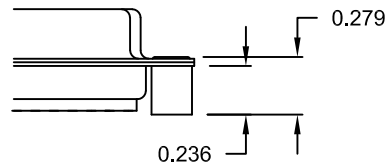

03X..... 0.236" (MATING SIDE)

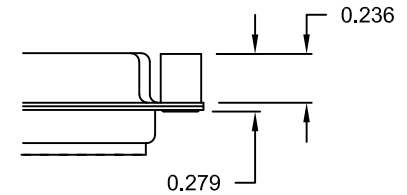

05X 0.237" (SOLDER SIDE)

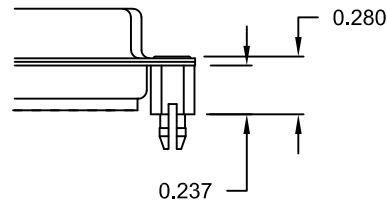

91X 0.237" (SOLDER SIDE)

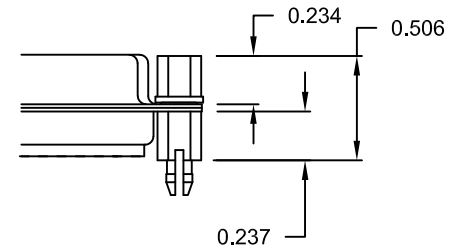

NOTE: 4-40 FEMALE SCREW LOCK IS REMOVABLE

DO NOT SCALE FROM DRAWING

RoHS COMPLIANT



THESE DRAWINGS AND SPECIFICATIONS ARE THE PROPERTY OF NorComp AND SHALL NOT BE REPRODUCED, COPIED OR USED AS THE BASIS FOR THE MANUFACTURE OF SALE OF APPARATUS WITHOUT WRITTEN PERMISSION.

DRAWN:
PAM JENKINS

DATE:
11-28-05

NorComp

SCALE: NTS SHEET 2 OF 2 REV 12

DWG NO. 172-EYY-20YRY1

Mouser Electronics

Authorized Distributor

Click to View Pricing, Inventory, Delivery & Lifecycle Information:

NorComp:

<u>172-E50-203R021</u>	<u>172-E50-203R011</u>	<u>172-E50-203R031</u>	<u>172-E25-203R021</u>	<u>172-E25-203R011</u>	<u>172-E25-203R031</u>
<u>172-E15-203R031</u>	<u>172-E15-203R011</u>	<u>172-E15-203R021</u>	<u>172-E25-203R911</u>	<u>172-E37-203R911</u>	<u>172-E50-203R911</u>
<u>172-E09-203R011</u>	<u>172-E09-203R031</u>	<u>172-E09-203R021</u>	<u>172-E37-203R021</u>	<u>172-E37-203R011</u>	<u>172-E37-203R031</u>
<u>172-E09-203R001</u>	<u>172-E09-203R911</u>	<u>172-E15-203R911</u>	<u>172-E09-202R011</u>	<u>172-E09-202R021</u>	<u>172-E09-202R031</u>
<u>172-E15-202R011</u>	<u>172-E15-202R021</u>	<u>172-E15-202R031</u>	<u>172-E25-202R011</u>	<u>172-E25-202R021</u>	<u>172-E25-202R031</u>
<u>172-E37-202R011</u>	<u>172-E37-202R021</u>	<u>172-E37-202R031</u>	<u>172-E50-202R011</u>	<u>172-E50-202R021</u>	<u>172-E50-202R031</u>