

C&K 1000 Series Miniature Slide Switches

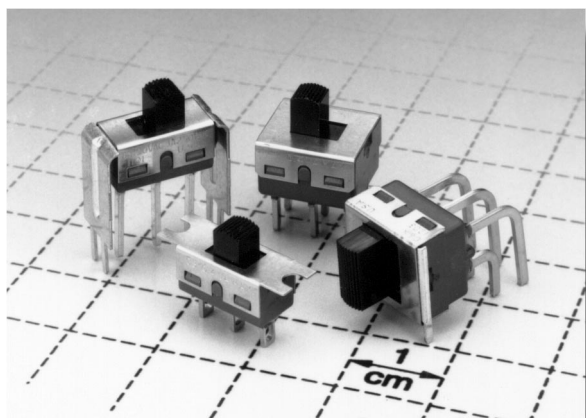

Features/Benefits

- Variety of actuators and terminations
- Panel mount tabs available
- Epoxy terminal seal—compatible with bottom-wash cleaning



Typical Applications

- Test & measurement equipment
- Telecommunications
- Computer & peripherals

Build-A-Switch

Our easy Build-A-Switch concept allows you to mix and match options to create the switch you need. Below is a complete listing of options shown in catalog. To order, simply select desired option from each category and place in the appropriate box. Switches with standard options are shown on page E-11. Available options are shown and described on pages E-12 thru E-15. For additional options not shown in catalog, consult Customer Service Center. All models have epoxy terminal seal and are compatible with all "bottom-wash" PCB cleaning methods.

Typical Example: 1 1 0 1 — M 2 — S 3 — Z — Q — E — 2

Switch Function

- 1101 (STD.) SP On-None-On**
- 1103** SP On-Off-On
- 1108** SP Mom.-None-On
- 1201** DP On-None-On
- 1203** DP On-Off-On

Mounting Style

- M2 (STD.) PC mount without tabs**
- M1** Panel mount with tabs

Actuator

- S3 (STD.) .200" high**
- S1** .040" high
- S2** .140" high
- S4** .285" high
- S5** .370" high
- S6** .485" high
- T3** .200" high

Terminations

- A (STD.) Right angle, PC thru-hole**
- C (STD.) PC Thru-hole**
- AV2 (STD.) Vertical right angle, PC thru-hole**
- Z (STD.) Solder lug**
- AW** Right angle, extended, PC thru-hole
- AW1** Right angle, extended, PC thru-hole
- V3** V-bracket
- V4** V-bracket
- W** .750" long, wire wrap
- W3** .425" long, wire wrap
- Z3** Quick connect

Contact Material

- B (STD.) Gold**
- Q (STD.) Silver**
- K** Gold
- M** Silver
- G** Gold over silver
- L** Gold over silver

Seal

- E (STD.) Epoxy**
- I** Epoxy potted base

Actuator Color

- 2 (STD.) Black**
- 1** White
- 3** Red

Specifications

CONTACT RATING: B contact material: 0.4 VA max. @ 20 V AC or DC max. Q contact material: 6 AMPS @ 120 V AC or 28 V DC, 3 AMPS @ 250 V AC. See page E-15 for additional ratings.

ELECTRICAL LIFE: 100,000 make-and-break cycles at full load on models with B or K contact material; 40,000 cycles on models with G, Q, L or M contact material.

CONTACT RESISTANCE: Below 10 milliohms typ. initial @ 2-4 V DC, 100 mA, for both silver and gold plated contacts.

INSULATION RESISTANCE: 10⁹ ohms min.

DIELECTRIC STRENGTH: 1,000 V RMS min. @ sea level.

OPERATING TEMPERATURE: -30°C to 65°C

SOLDERABILITY: Per MIL-STD-202F method 208D, or EIA RS-186E method 9 (1 hour steam aging).

Materials

CASE: diallyl phthalate (DAP), (UL 94V-0).

ACTUATOR: Nylon, black, standard.

HOUSING: Stainless steel.

SWITCH SUPPORT: Brass or steel, tin plated.

END CONTACTS: B contact material: Copper alloy, with gold plate over nickel plate. Q contact material: Coin silver, silver plated. See page E-15 for additional contact materials.

CENTER CONTACT & ALL TERMINALS: B contact material: Copper alloy, with gold plate over nickel plate. Q contact material: Copper alloy, silver plated. See page E-15 for additional contact materials.

TERMINAL SEAL: Epoxy

NOTE: Specifications and materials listed above are for switches with standard options. For information on specific and custom switches, consult Customer Service Center.

C&K 1000 Series Miniature Slide Switches

SWITCHES WITH STANDARD OPTIONS

PART NUMBER	FUNCTION	POS. 1	POS. 2	POS. 3
		1101M2S3CQE2	SPDT	ON

NOTE: For PC mounting information, see page E-13.

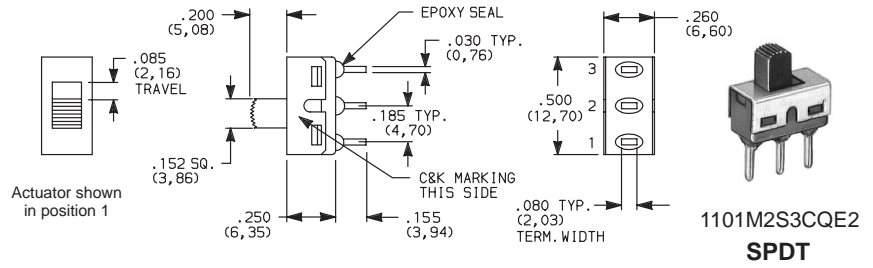

PART NUMBER	FUNCTION	POS. 1	POS. 2	POS. 3
		1201M2S3CQE2	DPDT	ON

NOTE: For PC mounting information, see page E-13.

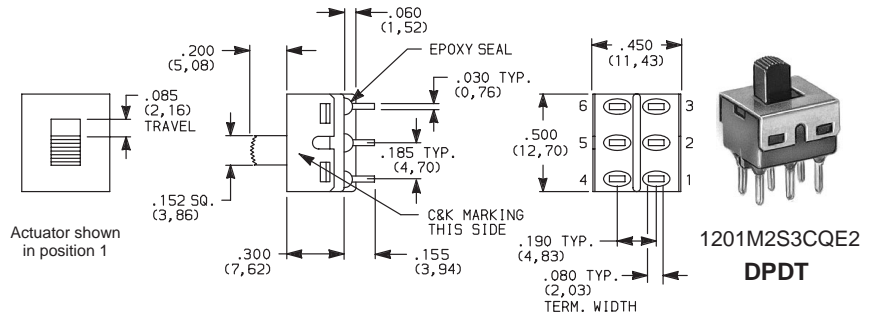

PART NUMBER	FUNCTION	POS. 1	POS. 2	POS. 3
		1101M2S3V3BE2	SPDT	ON

NOTE: For PC mounting information, see page E-15.

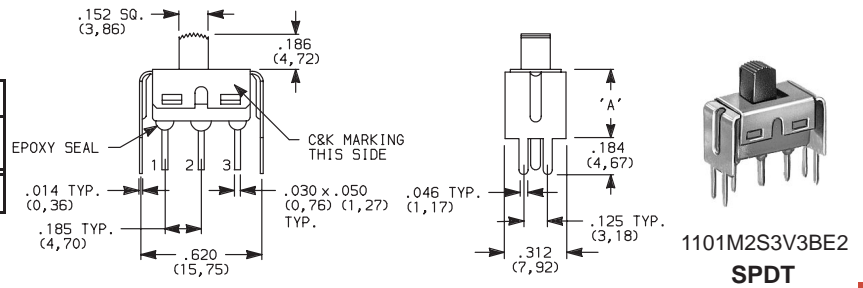

PART NUMBER	FUNCTION	POS. 1	POS. 2	POS. 3
		1101M2S3AQE2	SPDT	ON

NOTE: For PC mounting information, see page E-13.

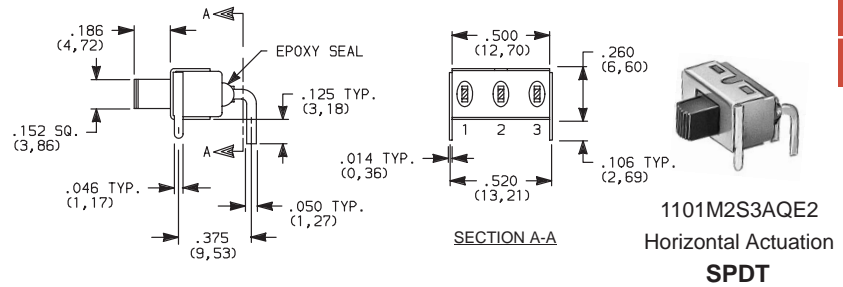

PART NUMBER	FUNCTION	POS. 1	POS. 2	POS. 3
		1101M2S3AV2BE2	SPDT	ON

NOTE: For PC mounting information, see page E-14.

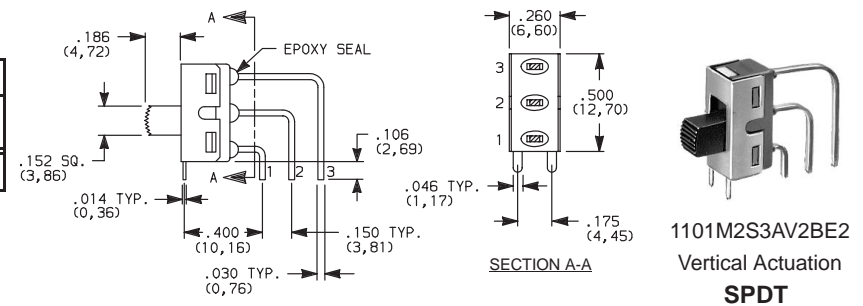

C&K 1000 Series Miniature Slide Switches

SWITCH FUNCTION

NO. POLES	MODEL NO.	SWITCH FUNCTION			CONNECTED TERMINALS			SCHEMATIC
		POS. 1	POS. 2	POS. 3	POS. 1	POS. 2	POS. 3	
SP	1101 (STD.)	ON	NONE	ON	1-2	OPEN	2-3	
	1103	ON	OFF	ON				
	1108	ON	NONE	MOM.				
DP	1201	ON	NONE	ON	2-1,5-4	OPEN	2-3,5-6	
	1203	ON	OFF	ON				

MOM. = Momentary

All models with all options when ordered with G, L, M or Q contact material.

MOUNTING STYLE

M2 (STD.) PC MOUNTING WITHOUT TABS

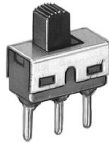

NOTE: Available with A, AV2, AW, AW1, C, V3, V4, W, W3 terminations only.

M1 PANEL MOUNTING WITH TABS

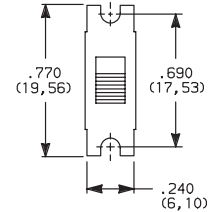
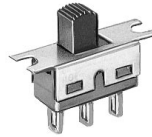

NOTE: Available with C, W, W3, Z, Z3 terminations only. No mounting hardware supplied.

PANEL MOUNTING

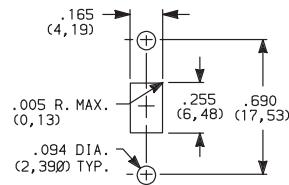

All actuators except T3.

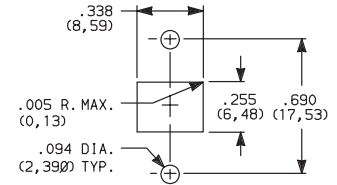

For T3 actuator only.

ACTUATOR

S3 (STD.) .200" HIGH

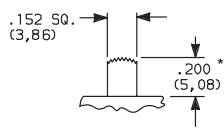

S2 .140" HIGH

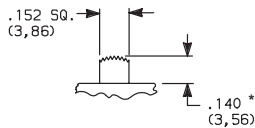

110X models only.

S1 .040" HIGH

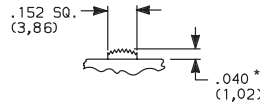

120X models only.

S4 .285" HIGH

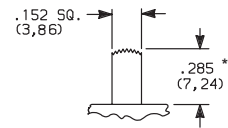

S5 .370" HIGH

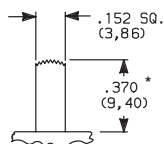

S6 .485" HIGH

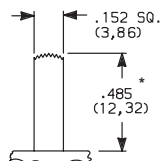

T3 .200" HIGH

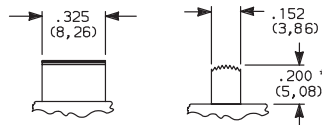

120X models only.

OPTION CODE	ACTUATOR COLOR
2	(STD.) BLACK
1	WHITE
3	RED

Other colors available, consult Customer Service Center.

* Subtract .014 (0,36) from actuator height, all models with A, AV2, AW, AW1, V3, V4 terminations.

C&K 1000 Series Miniature Slide Switches

TERMINATIONS

Z (STD.) SOLDER LUG

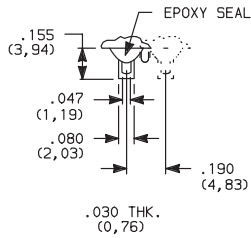

C (STD.) PC THRU-HOLE

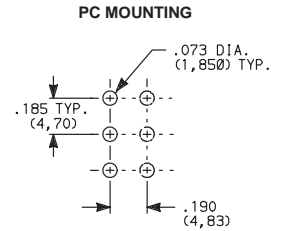
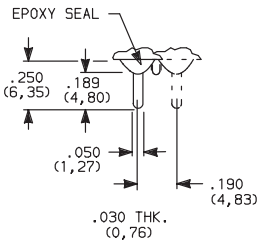

SPDT & DPDT

Not available with K, L or M contact materials.

SPDT & DPDT

Z3 QUICK CONNECT

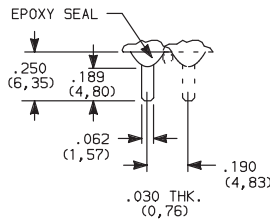

W, W3 WIRE WRAP

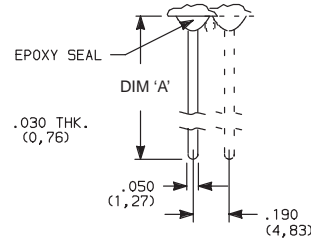

OPTION CODE	DIM 'A'
W	.750 (19,05)
W3	.425 (10,80)

SPDT & DPDT

Not available with K, L or M contact materials. Mating quick connector available; order part number 530100000.

SPDT & DPDT

A (STD.) RIGHT ANGLE, PC THRU-HOLE

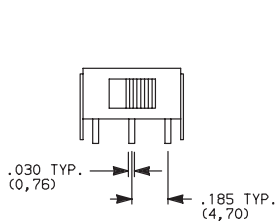

Actuator Shown In Pos. 1

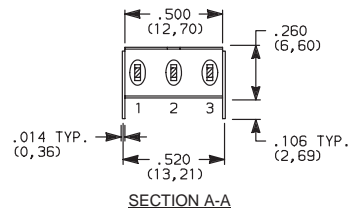
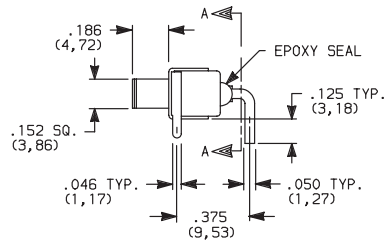

1101M2S3ABE2
Horizontal Actuation
SPDT

AW, AW1 RIGHT ANGLE, EXTENDED, PC THRU-HOLE

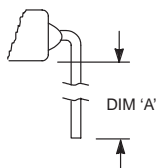

OPTION CODE	DIM 'A'
AW	.50 (12,7)
AW1	.71 (18,0)

PC MOUNTING

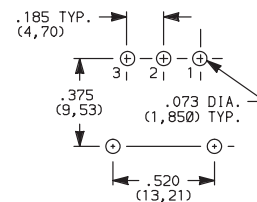

Not available with M1 mounting style, I seal option.
Terminal bend radii and lead-in manufacturing option.

C&K 1000 Series Miniature Slide Switches

TERMINATIONS

A (STD.) RIGHT ANGLE, PC THRU-HOLE



1201M2S3ABE2
Horizontal Actuation
DPDT

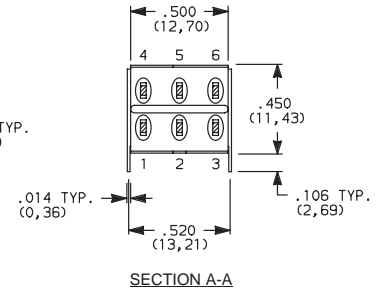
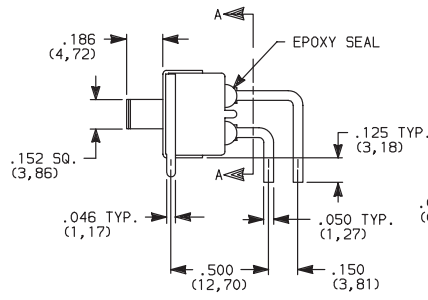
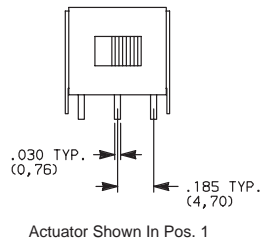

AW1 RIGHT ANGLE, EXTENDED, PC THRU-HOLE

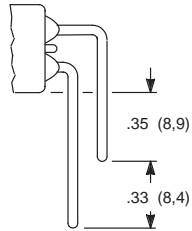

PC MOUNTING

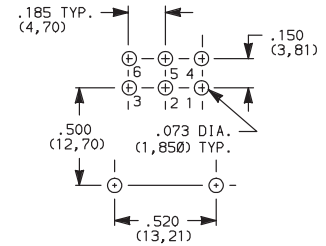

Not available with M1 mounting style, I seal option.
Terminal bend radii and lead-in manufacturing option.

AV2 (STD.) VERTICAL RIGHT ANGLE, PC THRU-HOLE, .150" PITCH



1101M2S3AV2BE2
Vertical Actuation
SPDT

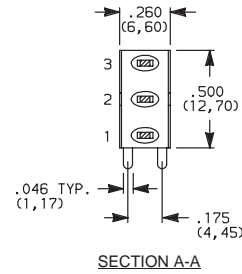
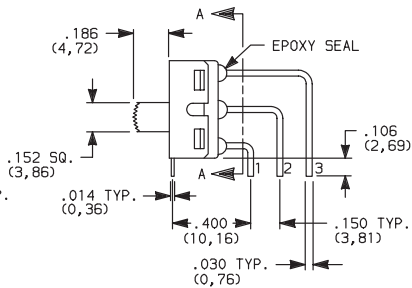
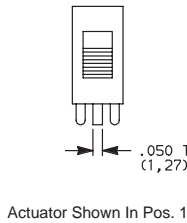

PC MOUNTING

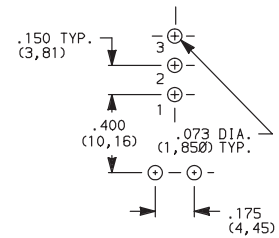

Not available with M1 mounting style, I seal option.
Terminal bend radii and lead-in manufacturing option.

AV2 (STD.) VERTICAL RIGHT ANGLE, PC THRU-HOLE, .150" PITCH

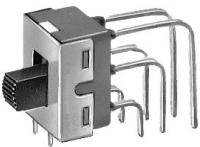

1201M2S3AV2BE2
Vertical Actuation
DPDT

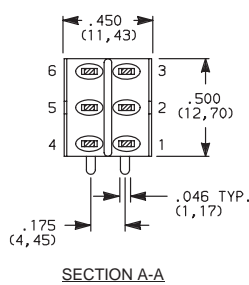
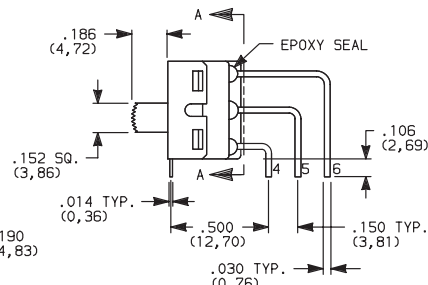
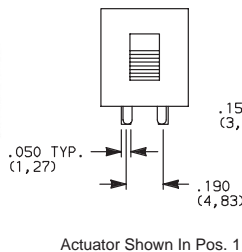

PC MOUNTING

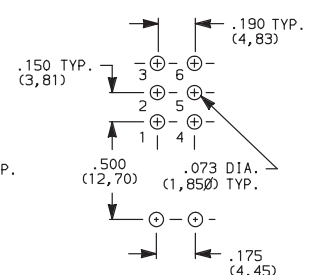

Not available with M1 mounting style, I seal option.
Terminal bend radii and lead-in manufacturing option.

TERMINATIONS

V3, V4 VERTICAL MOUNT, V-BRACKET

OPTION CODE	DIM 'A'
V3	.350 (8,89)
V4	.525 (13,34)

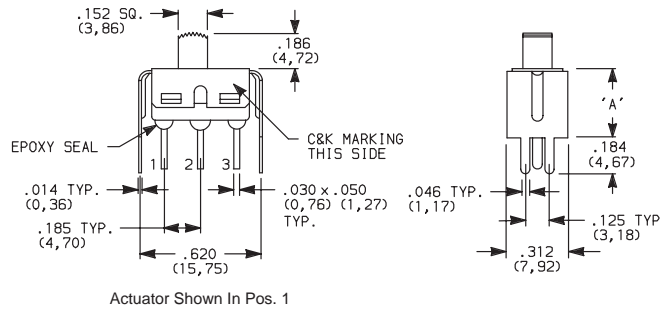

PC MOUNTING

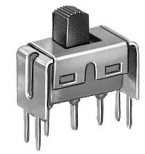
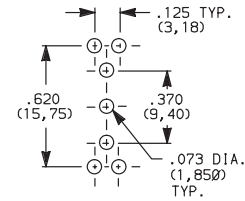

1101M2S3_BE2
SPDT

Not available with M1 mounting style and I seal.

V3, V4 VERTICAL MOUNT, V-BRACKET

OPTION CODE	DIM 'A'
V3	.400 (10,16)
V4	.575 (14,61)

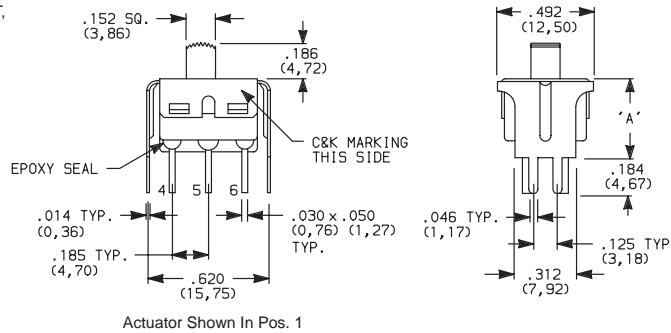

PC MOUNTING

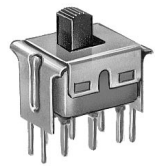
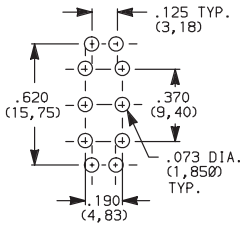

1201M2S3_BE2
DPDT

Not available with M1 mounting style and I seal.

CONTACT MATERIAL

OPTION CODE	CONTACT MATERIAL	TERMINAL PLATING	RATINGS	
B (STD.)	GOLD ¹	GOLD ¹	LOW LEVEL/DRY CIRCUIT	0.4 VA MAX. @ 20 V AC OR DC MAX.
K		TIN-LEAD ⁶		
Q (STD.)	SILVER ^{4,5}	SILVER ⁵	POWER	6 AMPS @ 120 V AC OR 28 V DC; 3 AMPS @ 250 V AC.
M		TIN-LEAD ⁶		
G	GOLD OVER SILVER ^{2,3}	GOLD ³	LOW LEVEL/DRY CIRCUIT OR POWER	0.4 VA MAX @ 20 V AC OR DC MAX. OR 6 AMPS @ 120 V AC OR 28 V DC; 3 AMPS @ 250 V AC.
L		TIN-LEAD ⁶		

CONTACT MATERIAL/APPLICATION RECOMMENDATIONS—SEE CHART, PAGE L-31.

- CONTACTS & TERMINALS: Copper alloy, with gold plate over nickel plate.
- END CONTACTS: Coin silver, with gold plate over nickel plate.
- CENTER CONTACTS & ALL TERMINALS: Copper alloy, with gold plate over nickel plate.
- END CONTACTS: Coin silver, silver plated.
- CENTER CONTACT & ALL TERMINALS: Copper alloy, silver plated.
- TERMINALS: Copper alloy, with tin-lead alloy over nickel plate.

- All models with all options when ordered with G, L, M or Q contact material.
- B contact material standard with all terminations except C, Z, Z3..
- Q contact material standard with C, Z, Z3 terminations..
- K, L, M contact materials not available with Z, Z3 terminations.

SEAL

E (STD.) EPOXY SEAL

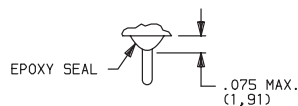

I EPOXY POTTED BASE

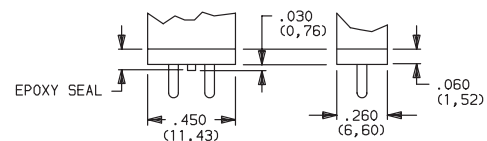

LENGTH IS SAME AS SWITCH BODY

NOTE: Available with C, W, W3, Z, Z3 terminations only.