

Features

- RoHS compliant*
- Conductive plastic or cermet
- Linear and audio tapers
- PC board and bushing mount
- Gangable
- Metal bushing and shaft
- Sealed for board washing



51/53 – Sealed 1/2" (12.5 mm) Square Control

| Electrical Characteristics ¹ | Conductive Plastic | Cermet |
|---|-----------------------------|-----------------------|
| Standard Resistance Range | | |
| Linear | 1 K ohms to 1 megohm | 150 ohms to 1 megohm |
| Audio | 1 K ohms to 1 megohm | 1 K ohms to 1 megohm |
| Total Resistance Tolerance | | |
| Linear Tapers | ±10 % or ±20 % | ±10 % or ±5 % |
| Audio Tapers | ±10 % or ±20 % | ±10 % |
| Independent Linearity | ±5 % | ±5 % |
| Absolute Minimum Resistance | 2 ohms maximum | 2 ohms maximum |
| Effective Electrical Angle | 270 ° ±5 ° | 270 ° ±5 ° |
| Contact Resistance Variation | 2 % | 2 % |
| Dielectric Withstanding Voltage (MIL-STD-202 – Method 301) | | |
| Sea Level | 1,500 VAC minimum | 1,500 VAC minimum |
| 70,000 | 500 VAC minimum | 500 VAC minimum |
| Insulation Resistance | 1,000 megohms minimum | 1,000 megohms minimum |
| Power Rating At 70 °C (Derate To 0 At 125 °C) (Voltage Limited By Power Dissipation or 350 VAC, Whichever Is Less) | | |
| Linear Tapers | 0.5 watt | 1.0 watt |
| Audio Tapers | 0.25 watt | 0.5 watt |
| Theoretical Resolution | Essentially infinite | Essentially infinite |

| Environmental Characteristics ¹ | Conductive Plastic | Cermet |
|--|-------------------------|-------------------|
| Operating Temperature Range | +1 °C to +125 °C | +1 °C to +125 °C |
| Storage Temperature Range | -55 °C to +125 °C | -55 °C to +125 °C |
| Temperature Coefficient Over Storage Temperature Range | ±1,000 ppm/°C | ±150 ppm/°C |
| Vibration (Single Section) | 15 G | 15 G |
| Total Resistance Shift | ±2 % maximum | ±2 % maximum |
| Voltage Ratio Shift | ±5 % maximum | ±5 % maximum |
| Shock (Single Section) | 30 G | 30 G |
| Total Resistance Shift | ±2 % maximum | ±2 % maximum |
| Voltage Ratio Shift | ±5 % maximum | ±5 % maximum |
| Load Life | 1,000 hours | 1,000 hours |
| Total Resistance Shift | ±10 % TRS maximum | ±5 % TRS maximum |
| Rotational Life (No Load) | 50,000 cycles | 25,000 cycles |
| Total Resistance Shift | ±10 % TRS maximum | ±10 % TRS maximum |
| Contact Resistance Variation @ 25,000 Cycles | ±2 % | ±4 % |
| Moisture Resistance (MIL-STD-202, Method 103, Condition B) | | |
| Total Resistance Shift | ±10 % TRS | ±5 % TRS |
| IP Rating | | |
| Entire Unit | IP64 | IP64 |
| Shaft/Bushing | IP65 | IP65 |

| Mechanical Characteristics | Conductive Plastic | Cermet |
|--|--|--------|
| Stop Strength | 56 N-cm (5 lb.-in.) | |
| Mechanical Angle | 290 ° ±5 ° | |
| Torque | | |
| Starting (Dual Sections) | +0.35 N-cm (+0.5 oz.-in.) maximum | |
| Running (Single Section) | 0.15 to 1.4 N-cm (0.2 to 2.0 oz.-in.) | |
| Running (Dual Section) | 0.35 to 1.8 N-cm (0.5 to 2.5 oz.-in.) | |
| Detent (Single Section) | 1.94 N-cm (2.75 oz.-in.) minimum | |
| Mounting (Torque on Bushing) | 1.7 to 2.0 N-m (15 to 18 lb.-in.) maximum | |
| Weight (Single Section) | 5.5 grams | |
| (Additional Section) | 3.0 grams | |
| Terminals | PC pin or solder lug | |
| Soldering Condition | Recommended hand soldering using Sn95/Ag5 no clean solder, 0.025" wire diameter. Maximum temperature 399 °C (750 °F) for 3 seconds. No wash process to be used with no clean flux. Part can be wave soldered at 260 °C (500 °F) for 5 seconds, no wash process with no clean flux. | |
| Marking | Manufacturer's trademark, part number and date code | |
| Ganging (Multiple Section Potentiometer) | 2 sections maximum** | |
| Hardware | One lockwasher and one mounting nut is shipped with each potentiometer (Bushing A: H-37-2 & H-38-2; Bushing C: H-37-1 & H-38-1; Bushing R: H-37-4 & H-38-9; Bushing S: H-37-1 & H-38-14; Bushing U: H-37-3 & H-38-8) | |

¹Electrical specifications tested at 200 RPM, at room ambient: +25 °C nominal.

** Additional sections available on special request with higher minimum order quantities.



WARNING
Cancer and Reproductive Harm
www.P65Warnings.ca.gov

*RoHS Directive 2015/863, Mar 31, 2015 and Annex.

Specifications are subject to change without notice. Users should verify actual device performance in their specific applications. The products described herein and this document are subject to specific legal disclaimers as set forth on the last page of this document, and at www.bourns.com/docs/legal/disclaimer.pdf.

51/53 – Sealed 1/2" (12.5 mm) Square Control

BOURNS®

Product Dimensions

PACKAGE DIMENSIONS

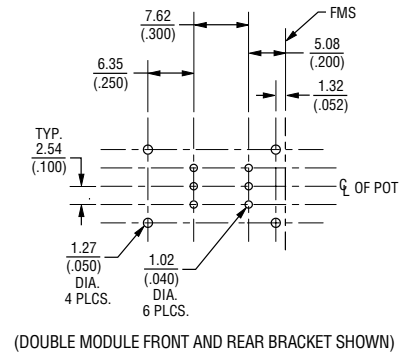
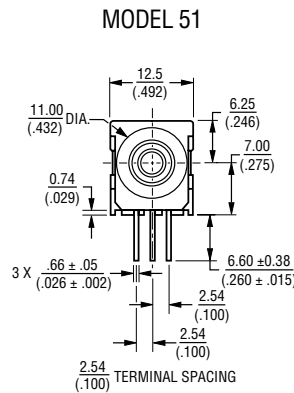
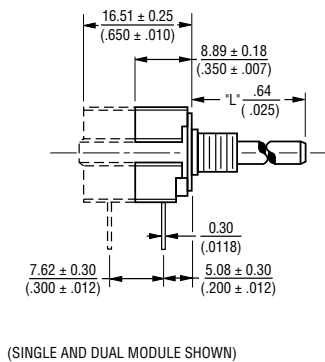

PACKAGE DIMENSIONS PCB MOUNTING BRACKET

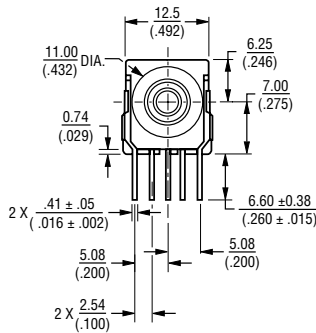
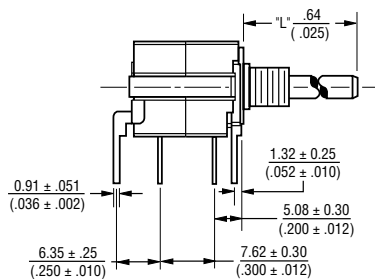

SOLDER LUG TERMINALS MODEL 53

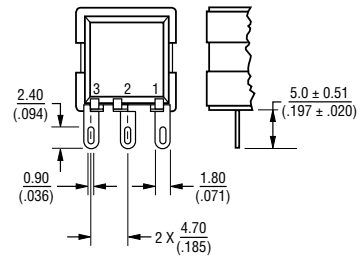

ELECTRICAL SCHEMATIC

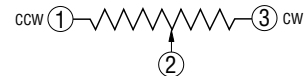

ANTI-ROTATION LUG (Style "A" Shown)

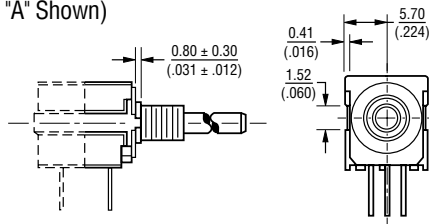

DIMENSIONS: $\frac{\text{MM}}{\text{(INCHES)}}$

SHAFT FLAT ORIENTATION

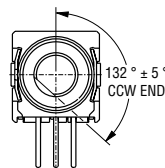

SUGGESTED PANEL LAYOUT

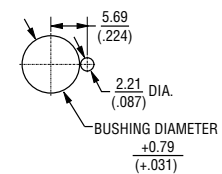

FOR TOLERANCES SHOWN: .XX = ± (.010)
 .XXX = ± (.005)
 SHAFT DIMENSIONS = $\frac{.80}{(.1/32)}$

Specifications are subject to change without notice.

Users should verify actual device performance in their specific applications.

The products described herein and this document are subject to specific legal disclaimers as set forth on the last page of this document, and at www.bourns.com/docs/legal/disclaimer.pdf.

51/53 – Sealed 1/2" (12.5 mm) Square Control

BOURNS®

Hardware

LOCKWASHER H-37-1

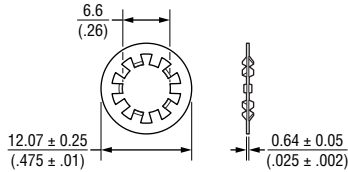

LOCKWASHER H-37-2

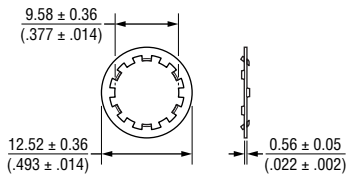

LOCKWASHER H-37-3

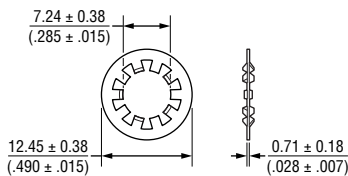

LOCKWASHER H-37-4

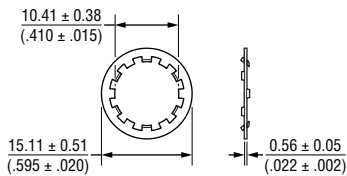

NUT H-38-1

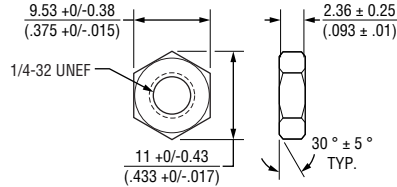

NUT H-38-2

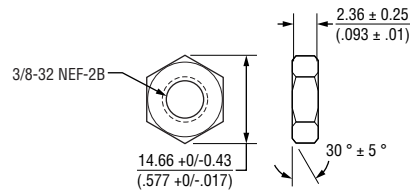

NUT H-38-8

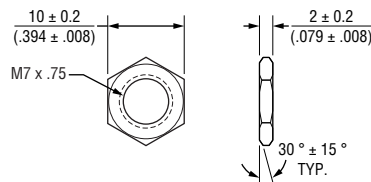

NUT H-38-9

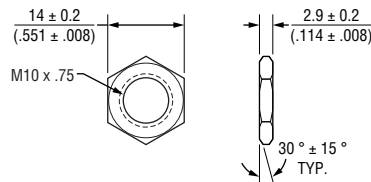

NUT H-38-14

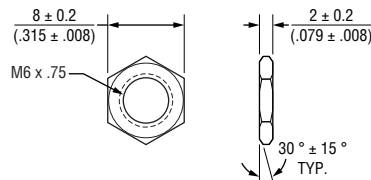

Date Code Description

YY WW M

YY = LAST TWO DIGITS OF YEAR MANUFACTURED
 WW = WEEK NUMBER
 M = COUNTRY OF MANUFACTURE (MEXICO)

BOURNS®

Asia-Pacific: Tel: +886-2 2562-4117 • Email: asiacus@bourns.com

EMEA: Tel: +36 88 885 877 • Email: eurocus@bourns.com

The Americas: Tel: +1-951 781-5500 • Email: americus@bourns.com

www.bourns.com

Specifications are subject to change without notice.

Users should verify actual device performance in their specific applications.

The products described herein and this document are subject to specific legal disclaimers as set forth on the last page of this document, and at www.bourns.com/docs/legal/disclaimer.pdf.

51/53 – Sealed 1/2" (12.5 mm) Square Control

BOURNS®

Shaft/Bushing Styles

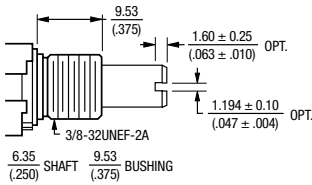

A Style Bushing

| STD. LENGTH 'L' | |
|-----------------|---------|
| .500 | (12.7) |
| .625 | (15.88) |
| .750 | (19.05) |
| .875 | (22.23) |
| 1.000 | (25.4) |

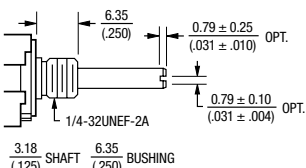

C Style Bushing

| STD. LENGTH 'L' | |
|-----------------|---------|
| .375 | (9.53) |
| .500 | (12.7) |
| .625 | (15.88) |
| .750 | (19.05) |
| .875 | (22.23) |
| 1.000 | (25.4) |

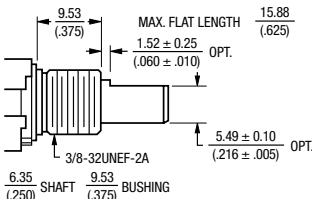

A Style Bushing - Flatted Shaft

| STD. LENGTH 'L' | |
|-----------------|---------|
| .625 | (15.88) |
| .750 | (19.05) |
| .875 | (22.23) |
| 1.000 | (25.4) |

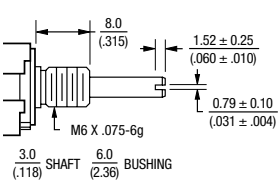

S Style Bushing

| STD. LENGTH 'L' | |
|-----------------|--------|
| .630 | (16.0) |
| .866 | (22.0) |
| .984 | (25.0) |

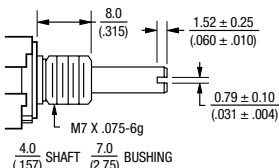

U Style Bushing

| STD. LENGTH 'L' | |
|-----------------|--------|
| .630 | (16.0) |
| .866 | (22.0) |
| .984 | (25.0) |

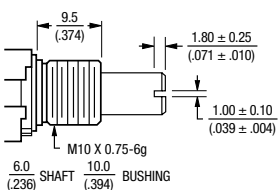

R Style Bushing

| STD. LENGTH 'L' | |
|-----------------|--------|
| .630 | (16.0) |
| .866 | (22.0) |
| .984 | (25.0) |

DIMENSIONS: $\frac{\text{MM}}{\text{(INCHES)}}$

How To Order

51 A A D - B 28 - A 15 / A15 L

Part number for multiple section potentiometers must have a taper and resistance value for each section.

| RoHS IDENTIFIER | |
|-----------------|-----------|
| L | Compliant |

MOUNTING BRACKET/ ANTI-ROTATION LUG

| Code | Description |
|------|------------------------|
| A | AR Lug 90 °CW |
| D | No AR Lug or Bracket |
| L | Front Bracket |
| M | Rear Bracket |
| N | Front and Rear Bracket |

SECTIONS/DETENTS

| Code | Description |
|------|------------------------|
| A | Single No Detent |
| B | Double No Detent |
| E | Single w/Center Detent |
| F | Double w/Center Detent |

BUSHING CONFIGURATION

| Code | Description |
|------|--------------------|
| A | 3/8" D x 3/8" L |
| C | 1/4" D x 1/4" L |
| R | 10 mm D x 9.5 mm L |
| S | 6 mm D x 8 mm L |
| U | 7 mm D x 8 mm L |

MODEL

| Code | Description |
|------|-------------------------|
| 51 | PC Pins (.100" centers) |
| 53 | Solder Lugs |

| ELEMENT TAPER TYPE/TOLERANCE | | RESISTANCE (CODE) | |
|------------------------------|-------------------------------|--------------------|---------------------|
| Code | Description | VALUE IN OHMS | |
| (A) | Linear Cermet ±10 % | (28) – 150 | (14) – 7.5 K |
| (H) | Linear Cermet ±5 % | (06) – 200 | (15) – 10 K |
| | | (07) – 250 | (30) – 15 K |
| | | (08) – 500 | (16) – 20 K |
| | | (09) – 750 | (17) – 25 K |
| | | (10) – 1 K | (18) – 50 K |
| | | (29) – 1.5 K | (19) – 75 K |
| | | (11) – 2 K | (20) – 100 K |
| | | (12) – 2.5 K | (23) – 500 K |
| | | (13) – 5 K | (25) – 1 M |
| (B) | Linear C-P ±20 % | (10) – 1 K | (18) – 50 K |
| (E) | Linear C-P ±10 % | (12) – 2.5 K | (20) – 100 K |
| | | (13) – 5 K | (22) – 250 K |
| | | (15) – 10 K | (23) – 500 K |
| | | (16) – 20 K | (25) – 1 M |
| | | (17) – 25 K | |
| (C) | CW Audio Cermet ±10 % | (10) – 1 K | (18) – 50 K |
| (F) | CCW Audio Cermet ±10 % | (12) – 2.5 K | (20) – 100 K |
| | | (13) – 5 K | (23) – 500 K |
| | | (15) – 10 K | (25) – 1 M |
| | | (17) – 25 K | |
| (D) | CW Audio C-P ±20 % | (10) – 1 K | (18) – 50 K |
| (S) | CW Audio C-P ±10 % | (12) – 2.5 K | (20) – 100 K |
| | | (13) – 5 K | (22) – 250 K |
| | | (15) – 10 K | (23) – 500 K |
| | | (16) – 20 K | (25) – 1 M |
| | | (17) – 25 K | |
| (G) | CCW Audio C-P ±20 % | (10) – 1 K | (18) – 50 K |
| (T) | CCW Audio C-P ±10 % | (12) – 2.5 K | (20) – 100 K |
| | | (13) – 5 K | (22) – 250 K |
| | | (15) – 10 K | (23) – 500 K |
| | | (17) – 25 K | (25) – 1 M |
| (Y) | CW Dual Audio Taper C-P ±20 % | (10) – 1 K | (18) – 50 K |
| | | (12) – 2.5 K | (20) – 100 K |
| | | (13) – 5 K | (22) – 250 K |
| | | (15) – 10 K | (23) – 500 K |
| | | (17) – 25 K | (25) – 1 M |

| SHAFT TYPE | | AVAILABLE ONLY IN BUSHINGS | |
|------------|-----------------------|----------------------------|----------------|
| Code | Description | Code | Description |
| B | Single Slotted 1/4" D | A | 24,28 |
| C | Single Flatted 1/4" D | A | 20,24,28,32 |
| E | Single Slotted 1/8" D | C | 12,16,20,24,28 |
| R | Single Slotted 6 mm D | R | 16,22,25 |
| T | Single Slotted 4 mm D | U | 16,22,25 |
| U | Single Slotted 3 mm D | S | 16,22,25 |

| SHAFT LENGTH (FMS) | | AVAILABLE ONLY IN BUSHING |
|--------------------|-------------|---------------------------|
| Code | Description | Code |
| 12 | 3/8" | C |
| 16 | 1/2" | A, C |
| 20 | 5/8" | A, C |
| 24 | 3/4" | A, C |
| 28 | 7/8" | A, C |
| 32 | 1" | A, C |
| Metric | | |
| 16 | 16 mm | R, S, U |
| 22 | 22 mm | R, S, U |
| 25 | 25 mm | R, S, U |

Boldface features are Bourns standard options. All others are available with higher minimum order quantities.

REV. 10/20

Specifications are subject to change without notice.

Users should verify actual device performance in their specific applications.

The products described herein and this document are subject to specific legal disclaimers as set forth on the last page of this document, and at www.bourns.com/docs/legal/disclaimer.pdf.

This legal disclaimer applies to purchasers and users of Bourns® products manufactured by or on behalf of Bourns, Inc. and its affiliates (collectively, “Bourns”).

Unless otherwise expressly indicated in writing, Bourns® products and data sheets relating thereto are subject to change without notice. Users should check for and obtain the latest relevant information and verify that such information is current and complete before placing orders for Bourns® products.

The characteristics and parameters of a Bourns® product set forth in its data sheet are based on laboratory conditions, and statements regarding the suitability of products for certain types of applications are based on Bourns’ knowledge of typical requirements in generic applications. The characteristics and parameters of a Bourns® product in a user application may vary from the data sheet characteristics and parameters due to (i) the combination of the Bourns® product with other components in the user’s application, or (ii) the environment of the user application itself. The characteristics and parameters of a Bourns® product also can and do vary in different applications and actual performance may vary over time. Users should always verify the actual performance of the Bourns® product in their specific devices and applications, and make their own independent judgments regarding the amount of additional test margin to design into their device or application to compensate for differences between laboratory and real world conditions.

Unless Bourns has explicitly designated an individual Bourns® product as meeting the requirements of a particular industry standard (e.g., ISO/TS 16949) or a particular qualification (e.g., UL listed or recognized), Bourns is not responsible for any failure of an individual Bourns® product to meet the requirements of such industry standard or particular qualification. Users of Bourns® products are responsible for ensuring compliance with safety-related requirements and standards applicable to their devices or applications.

Bourns® products are not recommended, authorized or intended for use in nuclear, lifesaving, life-critical or life-sustaining applications, nor in any other applications where failure or malfunction may result in personal injury, death, or severe property or environmental damage. Unless expressly and specifically approved in writing by two authorized Bourns representatives on a case-by-case basis, use of any Bourns® products in such unauthorized applications might not be safe and thus is at the user’s sole risk. Life-critical applications include devices identified by the U.S. Food and Drug Administration as Class III devices and generally equivalent classifications outside of the United States.

Bourns expressly identifies those Bourns® standard products that are suitable for use in automotive applications on such products’ data sheets in the section entitled “Applications.” Unless expressly and specifically approved in writing by two authorized Bourns representatives on a case-by-case basis, use of any other Bourns® standard products in an automotive application might not be safe and thus is not recommended, authorized or intended and is at the user’s sole risk. If Bourns expressly identifies a sub-category of automotive application in the data sheet for its standard products (such as infotainment or lighting), such identification means that Bourns has reviewed its standard product and has determined that if such Bourns® standard product is considered for potential use in automotive applications, it should only be used in such sub-category of automotive applications. Any reference to Bourns® standard product in the data sheet as compliant with the AEC-Q standard or “automotive grade” does not by itself mean that Bourns has approved such product for use in an automotive application.

Bourns® standard products are not tested to comply with United States Federal Aviation Administration standards generally or any other generally equivalent governmental organization standard applicable to products designed or manufactured for use in aircraft or space applications. Bourns expressly identifies Bourns® standard products that are suitable for use in aircraft or space applications on such products’ data sheets in the section entitled “Applications.” Unless expressly and specifically approved in writing by two authorized Bourns representatives on a case-by-case basis, use of any other Bourns® standard product in an aircraft or space application might not be safe and thus is not recommended, authorized or intended and is at the user’s sole risk.

The use and level of testing applicable to Bourns® custom products shall be negotiated on a case-by-case basis by Bourns and the user for which such Bourns® custom products are specially designed. Absent a written agreement between Bourns and the user regarding the use and level of such testing, the above provisions applicable to Bourns® standard products shall also apply to such Bourns® custom products.

Users shall not sell, transfer, export or re-export any Bourns® products or technology for use in activities which involve the design, development, production, use or stockpiling of nuclear, chemical or biological weapons or missiles, nor shall they use Bourns® products or technology in any facility which engages in activities relating to such devices. The foregoing restrictions apply to all uses and applications that violate national or international prohibitions, including embargos or international regulations. Further, Bourns® products and Bourns technology and technical data may not under any circumstance be exported or re-exported to countries subject to international sanctions or embargoes. Bourns® products may not, without prior authorization from Bourns and/or the U.S. Government, be resold, transferred, or re-exported to any party not eligible to receive U.S. commodities, software, and technical data.

To the maximum extent permitted by applicable law, Bourns disclaims (i) any and all liability for special, punitive, consequential, incidental or indirect damages or lost revenues or lost profits, and (ii) any and all implied warranties, including implied warranties of fitness for particular purpose, non-infringement and merchantability.

For your convenience, copies of this Legal Disclaimer Notice with German, Spanish, Japanese, Traditional Chinese and Simplified Chinese bilingual versions are available at:

Web Page: <http://www.bourns.com/legal/disclaimers-terms-and-policies>

PDF: <http://www.bourns.com/docs/Legal/disclaimer.pdf>

Mouser Electronics

Authorized Distributor

Click to View Pricing, Inventory, Delivery & Lifecycle Information:

Bourns:

[53CAD-E12-A10](#) [53RAA-R16-D18](#) [53CAD-E12-A13](#) [53CAD-E12-A15](#) [51RAD-R22-B18](#) [51RAD-R22-B16](#) [51RAD-R22-B12](#) [51RAD-R22-B10](#) [51RAD-R22-B15](#) [51RAD-R22-B13](#) [53AEA-B28-A20](#) [51RAD-R22-B25](#) [51RAD-R22-B22](#) [53AEA-C28-A20](#) [51RAD-R22-B20](#) [53RAA-R25-B15](#) [51RAA-R25-D20](#) [53AEA-B28-A16](#) [53AEA-C28-A16](#) [53AEA-C28-A11](#) [53AEA-B28-A15](#) [53AEA-C28-A13](#) [53AEA-B28-A13](#) [53AEA-B28-A10](#) [53AEA-C28-A15](#) [53AEA-B28-A11](#) [53AEA-C28-A10](#) [53AEA-B28-A18](#) [53AEA-C28-A18](#) [51AAN-B16-B15](#) [53CAD-D14-E25](#) [53CAD-E28-D15](#) [51RAD-R25-D15](#) [51UAD-T25-B15](#) [51SAN-U13-A15](#) [51AAN-B28-B18](#) [51SAN-U16-A10](#) [51AAA-B24-A20](#) [51AAA-C24-A20](#) [53CAD-D20-D10](#) [53CAD-D20-D13](#) [51CAD-E28-D15](#) [53CAD-E20-D15](#) [51SAN-U16-A15](#) [53UAD-T13-S15](#) [51AAD-B28-D13](#) [51CAD-E20-D15](#) [51AAD-C28-D13](#) [51AAD-B28-D15](#) [51CAD-D20-D15](#) [51CED-E28-C15](#) [53AAD-C28-A22](#) [51CAL-E20-C15](#) [51FAD-E28-A13](#) [53CAA-D20-E17](#) [53AAA-C28-E13](#) [51AFD-B24-E15](#) [51AAL-C20-A13](#) [51CAN-E28-A18](#) [51AAD-B24-B15](#) [51AAL-C20-A15](#) [51CAN-E28-A13](#) [51CAN-E28-A15](#) [51AAD-B24-B18](#) [51CAN-D28-A15](#) [51AAL-C20-A10](#) [51CAL-E28-A10](#) [53UAD-T22-B20](#) [53UAD-T22-B22](#) [51AAN-B24-A15](#) [53UAD-T22-A15](#) [51AAD-C20-H15](#) [53UAD-T22-A13](#) [51AAN-B28-T13](#) [51CAN-E20-T17](#) [53CAD-E16-B20](#) [53AAC-B24-A20](#) [51UAD-T22-A20](#) [53UAD-T16-A15](#) [53CAD-E20-B20](#) [51CAN-D20-D13](#) [51CAN-D20-D15](#) [51AAN-B28-D15](#) [51CAN-D20-D10](#) [51CAN-D20-D17](#) [51SAD-U25-A18](#) [51SAD-U25-A13](#) [51SAD-U25-A10](#) [51SAD-U25-A15](#) [51UAD-T16-G18](#) [51AEA-B28-B20](#) [51AEA-C28-B18](#) [51AEA-B28-B16](#) [51AEA-B28-B10](#) [51AEA-B28-B18](#) [51AEA-C28-B20](#) [51AEA-C28-B10](#) [51AEA-B28-B13](#) [51AEA-B28-B11](#) [51AEA-C28-B13](#)