



Quality Products. Service Excellence.

## Eclipse DIN Rails *DR Series*



- Field installable.
- Includes a set of 3 plated rails.
- Available in 3 industry standard profiles - DIN 1, DIN 3, and CENELEC.
- **DIN rail mounting kit** required for installation.
- Rails have an oblong slot on each end for ease of mounting.
- Zinc plated.

### Accessories

- Eclipse DIN Rail Mounting Kit

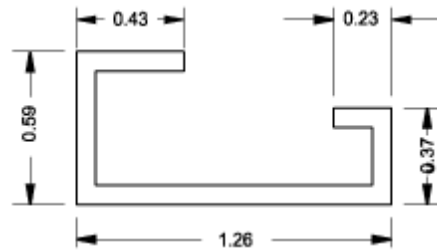

**Asymmetric DIN 1 Pro**

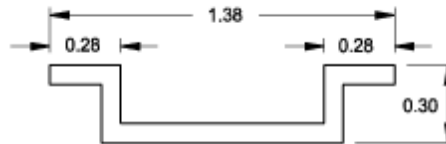

**Symmetric DIN 3 Pro**

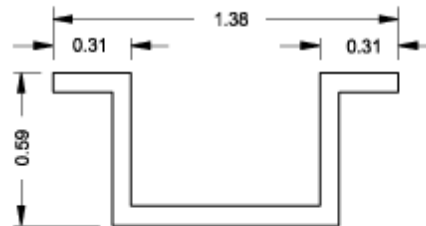

**CENELEC Pro**

| Asymmetric DIN 1 Profile<br>Part No. | Symmetric DIN 3 Profile<br>Part No. | Cenelec Profile<br>Part No. | Length |
|--------------------------------------|-------------------------------------|-----------------------------|--------|
| 2D1K12                               | 2D2K12                              | 2DCK12                      | 9.75   |
| 2D1K16                               | 2D2K16                              | 2DCK16                      | 13.75  |
| 2D1K20                               | 2D2K20                              | 2DCK20                      | 17.75  |
| 2D1K24                               | 2D2K24                              | 2DCK24                      | 21.75  |
| 2D1K30                               | 2D2K30                              | 2DCK30                      | 27.75  |

*Data subject to change without notice*

© 2021. Hammond Manufacturing Ltd. All rights reserved.