

Pegler Valve

Float valve Nylon seat, BS 1212-2 part 2, high pressure

858N-Z Float valve



General Information

Size	Pattern No.	Pack		Code	Barcode	Price (£) each ex VAT	Discontinued	Date Discontinued
		1 Qty	2 Qty					
1/2"	858N-Z	10	0	516006	5013866016776	£23.09		
1/2"	858N	10	0	516007	5013866016783	£23.38		
1/2"	858N-V	5	0	516027	5013866016806	£45.02		
3/4"	858N	1	5	516107	5022050546456	Disc(Stock available)	Discontinued	03/07/2021

858N-Z Float valve

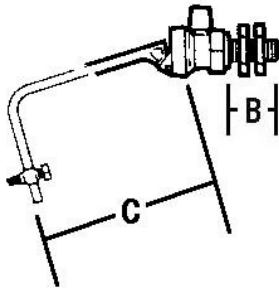

Dimensions

Code	Description	A	B	C
516006	1/2 858N-Z BRASS PT.2 FLOATVALVE (HP) No. 3 (1/8")	1 1/4"	8 3/4"	0.42
516007	1/2 858N BRASS PT.2 FLOATVALVE (HP) No. 3 (1/8")	1 1/4"	8 3/4"	0.46
516027	1/2 858N-V BRASS PT.2 FLOATVALVE (HP) No. 3 (1/8")	1 7/8"	8 3/4"	0.51

Pegler Yorkshire reserve the right to change specifications

Guarantee

Valves and Fittings

Pegler Customcare 5 Year Guarantee - Terms and Conditions

Products are subject to a 5 year guarantee that is between Pegler and the final purchaser of the product.

The guarantee is subject to proof of purchase being supplied.

This guarantee does not affect any statutory rights the consumer may have in law.

The guarantee covers manufacturing or material defects and does not cover parts subject to normal wear and tear.

This product range has been designed for the use of homeowners, domestic and commercial applications and therefore the guarantee is subject to the product being properly selected for their intended service conditions.

The guarantee is not applicable where the product is fitted contrary to the conditions in the fitting instructions.

This is reinforced where valves are covered by the European Pressure Equipment Directive (PED97/23/EC) where Installation, Operating and Maintenance Instructions are supplied with each product and/or carton.

Provided it is installed correctly and receives adequate preventative maintenance it should give years of trouble-free service.

Abusive behaviour and accidental damage to the product are not covered by this guarantee.

The extent of this liability is limited to the cost of the replacement of the defective item and not to fitting or consequential damages.

Pressure and Temperature

Description	Minimum Operating Pressure (bar)	Maximum Cold Working Pressure (bar)	Maximum Hot Working Pressure (bar)
858N-Z Float valve	No Minimum Operating Pressure	14.0 bar at temperatures up to 85oC	Not Suitable for Maximum Hot Working Pressure

Care and Maintenance

Care

No regular aesthetic care is required for this product

Maintenance

No regular maintenance is required for this product.

For any further help please contact the Service Support Team on: 0800 1560050.

Regulations

Regulations

It is important to ensure that the water supplies to your fittings are connected in accordance with the water regulations (WRAS) requirements and good plumbing practice.

This product has been designed in accordance with BS1212 part 2 standard.

Materials

Component Material

Seat Nylon

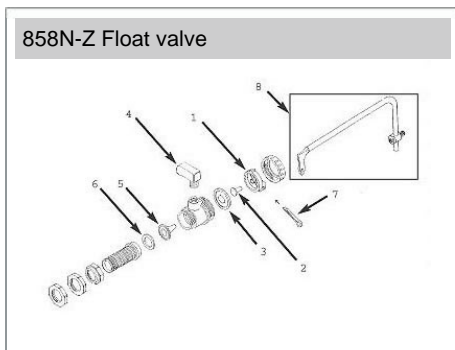

Spare Key	Description	Code	Barcode	Date From	Date To	Price (£) ex VAT
1						
1	BP3 BACKPLATE (NYLON)	816017	5013866057434	01/01/1900	To Current	£0.00
1	BP3 BACKPLATE (NYLON)	816017	5013866057434	01/01/1900	To Current	£0.00
1	BP3 BACKPLATE (NYLON)	816017	5013866057434	01/01/1900	To Current	£0.00
1	BP3 BACKPLATE (NYLON)	816017	5013866057434	01/01/1900	To Current	£0.00
1	BP3 BACKPLATE (NYLON)	816017	5013866057434	01/01/1900	To Current	£0.00
2						
2	PLN1 PLUNGER (DZR)	816257	5013866058356	01/01/1900	To Current	£0.00
2	PLN1 PLUNGER (DZR)	816257	5013866058356	01/01/1900	To Current	£0.00
2	PLN1 PLUNGER (DZR)	816257	5013866058356	01/01/1900	To Current	£0.00
2	PLN1 PLUNGER (DZR)	816257	5013866058356	01/01/1900	To Current	£0.00
2	PLN1 PLUNGER (DZR)	816257	5013866058356	01/01/1900	To Current	£0.00
3						
3	DM3 DIAPHRAGM (RUBBER)	816250	5013866058332	01/01/1900	To Current	£3.17
3	DM3 DIAPHRAGM (RUBBER)	816250	5013866058332	01/01/1900	To Current	£3.17
3	DM3 DIAPHRAGM (RUBBER)	816250	5013866058332	01/01/1900	To Current	£3.17
3	DM3 DIAPHRAGM (RUBBER)	816250	5013866058332	01/01/1900	To Current	£3.17
3	DM3 DIAPHRAGM (RUBBER)	816250	5013866058332	01/01/1900	To Current	£3.17
4						
4	FO1 FILLING OUTLET	816249	5013866058325	01/01/1900	To Current	£0.00
4	FO1 FILLING OUTLET	816249	5013866058325	01/01/1900	To Current	£0.00
4	FO1 FILLING OUTLET	816249	5013866058325	01/01/1900	To Current	£0.00
4	FO1 FILLING OUTLET	816249	5013866058325	01/01/1900	To Current	£0.00
4	FO1 FILLING OUTLET	816249	5013866058325	01/01/1900	To Current	£0.00
5						
5						

Spare Key	Description	Code	Barcode	Date From	Date To	Price (£) ex VAT
5	ST1 FLOATVALVE SEAT - NYLON (1/8) (WHITE)	816001	5013866057281	01/01/1900	To Current	£0.00
5	ST1 FLOATVALVE SEAT - NYLON (1/8) (WHITE)	816001	5013866057281	01/01/1900	To Current	£0.00
5	ST2 FLOATVALVE SEAT - NYLON (1/4) (RED)	816007	5013866057342	01/09/2003	To Current	£0.00
5	ST3 FLOATVALVE SEAT-NYLON (3/16) (BLACK)	816008	5013866057359	01/01/1900	To Current	£0.00
5	ST1 FLOATVALVE SEAT - NYLON (1/8) (WHITE)	816001	5013866057281	01/01/1900	To Current	£0.00
5	ST2 FLOATVALVE SEAT - NYLON (1/4) (RED)	816007	5013866057342	01/01/1900	To Current	£0.00
Spare Key	Description	Code	Barcode	Date From	Date To	Price (£) ex VAT
6						
6	SW17 SEAT WASHER	816090	5013866057649	01/01/1900	To Current	£0.00
6	SW17 SEAT WASHER	816090	5013866057649	01/01/1900	To Current	£0.00
6	SW17 SEAT WASHER	816090	5013866057649	01/01/1900	To Current	£0.00
6	SW17 SEAT WASHER	816090	5013866057649	01/01/1900	To Current	£0.00
6	SW17 SEAT WASHER	816090	5013866057649	01/01/1900	To Current	£0.00
Spare Key	Description	Code	Barcode	Date From	Date To	Price (£) ex VAT
7						
7	CTP2 SPLIT COTTER PIN	816256	5013866058349	01/01/1900	To Current	£2.82
7	CTP2 SPLIT COTTER PIN	816256	5013866058349	01/01/1900	To Current	£2.82
7	CTP2 SPLIT COTTER PIN	816256	5013866058349	01/01/1900	To Current	£2.82
7	CTP2 SPLIT COTTER PIN	816256	5013866058349	01/01/1900	To Current	£2.82
7	CTP2 SPLIT COTTER PIN	816256	5013866058349	01/01/1900	To Current	£2.82
Spare Key	Description	Code	Barcode	Date From	Date To	Price (£) ex VAT
8						
8	LA7 FLOATVALVE LEVER ARM ASSEMBLY	816070	5013866057595	01/01/1900	To Current	£0.00
8	LA7 FLOATVALVE LEVER ARM ASSEMBLY	816070	5013866057595	01/01/1900	To Current	£0.00
8	LA7 FLOATVALVE LEVER ARM ASSEMBLY	816070	5013866057595	01/01/1900	To Current	£0.00
8	LA7 FLOATVALVE LEVER ARM ASSEMBLY	816070	5013866057595	01/01/1900	To Current	£0.00
8	LA7 FLOATVALVE LEVER ARM ASSEMBLY	816070	5013866057595	01/01/1900	To Current	£0.00

FLOW RATE & SIZE SELECTION CHART (GPM)

	Static Pressure		BS 1212 PART 1 Seat Bore Size			
	PSI	Feet	1/8"	3/16"	1/4"	3/8"
LOW PRESSURE	0.5	1.15	0.18	0.41	0.55	0.71
	1.0	2.30	0.25	0.58	0.78	1.00
	2.0	4.60	0.35	0.82	1.10	1.40
	4.0	9.20	0.50	1.16	1.56	2.00
	7.0	16.10	0.66	1.53	2.02	2.60
	10.0	23.10	0.79	1.83	2.46	3.20
	15.0	34.60	0.97	2.25	3.00	3.87
	20.0	46.20	1.12	2.60	3.49	4.47
	25.0	57.70	1.25	2.90	3.90	5.00
	30.0	69.30	1.34	3.17	4.27	5.48
MEDIUM PRESSURE	35.0	80.80	1.48	3.43	4.61	5.90
	40.0	92.40	1.58	3.67	4.93	6.30
	50.0	115.00	1.77	4.10	5.50	7.10
	60.0	138.00	1.94	4.50	6.00	7.74
	70.0	161.00	2.10	4.85	6.50	8.30
	80.0	184.00	2.24	5.20	6.98	8.90
HIGH PRESSURE	90.0	207.00	2.37	5.50	7.40	9.50
	100.0	231.00	2.50	5.80	7.80	10.00
	110.0	254.00	2.62	6.08	8.20	10.50
	125.0	289.00	2.79	6.48	8.70	11.20
	150.0	346.00	3.06	7.10	9.50	12.20
	175.0	404.00	3.30	7.67	10.30	13.20
	200.0	462.00	3.53	8.20	11.00	14.10

Flow Rate and Size Selection Chart general Notes:
 The discharge through a floatvalve is governed by the running pressure maintained at its inlet. In practice this is difficult to measure and so the tables shown indicate the 'estimated' flow rate in G.P.M. that will occur at various static heads for each size of floatvalve or for each size of seat in floatvalves that accept a variety of seat sizes. The flow rates quoted will only occur when the floatvalve is fully open and will reduce as the water level in the tank rises. Excessive pipe runs to the floatvalve will result in lower running pressures and thus reduced flow rates.



RANGE											
		Patt. No.	Size	Diaphragm Material	Backnut Material	Seat Bore	Tail Length	Lever Length	Recommended Float Size		Weight Approx kg
									Copper	Plastic	
HIGH PRESSURE	NYLON SEAT	858 N	1/2"	Rubber	Brass	No. 3 (1/8")	1 1/4"	8 3/4"	4 1/2" x 5/16"W	4 1/2" x 5/16"W	0.45
		858 N-Z	1/2"	Rubber	Nylon	No. 3 (1/8")	1 1/4"	8 3/4"	4 1/2" x 5/16"W	4 1/2" x 5/16"W	0.40
		858 N-V	1/2"	Rubber	Brass	No. 3 (1/8")	1 7/8"	8 3/4"	4 1/2" x 5/16"W	4 1/2" x 5/16"W	0.47
		858 N	3/4"	Rubber	Brass	No. 6 (1/4")	1 1/2"	8 3/4"	6" x 5/16"W	6" x 5/16"W	0.52
	BRONZE SEAT	858 B	1/2"	Rubber	Brass	No. 3 (1/8")	1 1/4"	8 3/4"	4 1/2" x 5/16"W	4 1/2" x 5/16"W	0.47
		858 B-V	1/2"	Rubber	Brass	No. 3 (1/8")	1 7/8"	8 3/4"	4 1/2" x 5/16"W	4 1/2" x 5/16"W	0.49
LOW PRESSURE	NYLON SEAT	860 N	1/2"	Rubber	Brass	No. 9 (3/8")	1 1/4"	8 3/4"	4 1/2" x 5/16"W	4 1/2" x 5/16"W	0.54

Note: It is normal practice to consider the 858 as a high pressure floatvalve and the 860 as a low pressure. It is, however, possible to use a low pressure valve at high pressures provided an appropriate float is used to ensure shut off at the higher pressure. Similarly, a high pressure valve can be used at low pressures provided the resulting lower flow rates are acceptable. Where two seat size options exist for different sizes of floatvalve, select the smaller size of floatvalve if the flow rate through the seat is more than 5% in excess of the flow required.