

**NOTES:**

1. ALL PARTS TO BE BULK PACKED.
2. CONTACTS SUPPLIED UNASSEMBLED
3. ALL DIMENSIONS ARE REFERENCE EXCEPT THOSE WITH A TOLERANCE
4. DIMENSIONS IN BRACKETS [ ] ARE IN MILLIMETERS

ASS'Y P/N	GROMMET SIZE
W6280-XSG-P-513	.148 GROMMET I.D. FOR CABLE O.D. 0.13 - 0.15 [3.3 - 3.8]
W6280-XSG-P-516	.176 GROMMET I.D. FOR CABLE O.D. 0.16 - 0.18 [4.1 - 4.6]
W6280-XSG-P-519	.206 GROMMET I.D. FOR CABLE O.D. 0.19 - 0.21 [4.8 - 5.3]
W6280-XSG-P-522	.245 GROMMET I.D. FOR CABLE O.D. 0.22 - 0.25 [5.6 - 6.3]
W6280-XSG-P-526	.265 GROMMET I.D. FOR CABLE O.D. 0.25 - 0.27 [6.3 - 6.8]
W6280-XSG-P-528	.280 GROMMET I.D. FOR CABLE O.D. 0.26 - 0.28 [6.6 - 7.1]

ASSEMBLY P/N	CONTACTS
W6280-2SG-P-5XX	2 #20
W6280-3SG-P-5XX	3 #20
W6280-4SG-P-5XX	4 #20
W6280-5SG-P-5XX	5 #20
W6280-6SG-P-5XX	6 #20
W6280-7SG-P-5XX	7 #20
W6280-8SG-P-5XX	8 #20
W6280-XSG-P-5XX	

**CUSTOMER APPROVAL**

THIS DOCUMENT CONTAINS CONFIDENTIAL INFORMATION PROPRIETARY TO CONXALL CORPORATION. ANY REPRODUCTION, DISCLOSURE, OR USE OF THIS DOCUMENT /INFORMATION IS EXPRESSLY PROHIBITED UNLESS AUTHORIZED IN WRITING BY CONXALL CORPORATION.

APPROVED BY: \_\_\_\_\_  
DATE: \_\_\_\_\_

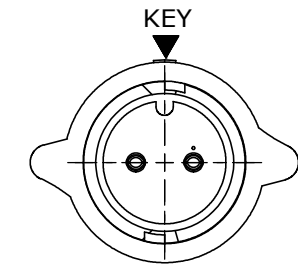

**MATING FACE**  
W6280-2SG-P-5XX SHOWN

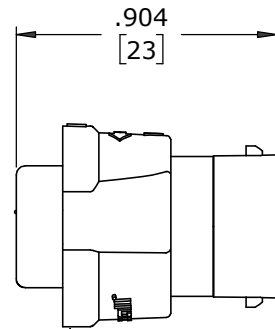
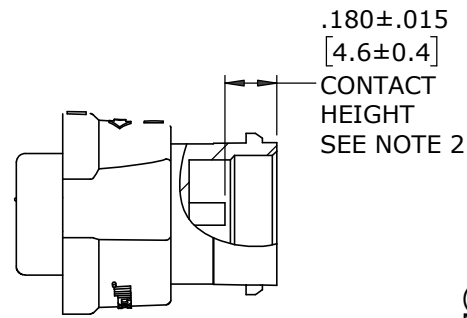

CABLE-END HOUSING  
MAT'L: UV PBT, BLACK  
COUPLING RING  
MAT'L: UV PBT, BLACK  
O-RING  
MAT'L: SILICONE, RED  
SPRING  
MAT'L: STAINLESS STEEL

(2-8) #20 SOCKET CONTACTS, CRIMP  
MAT'L: COPPER ALLOY, GOLD PLATED

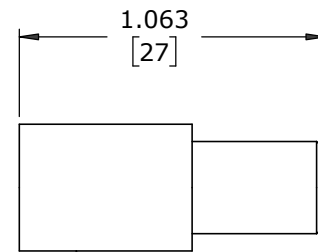
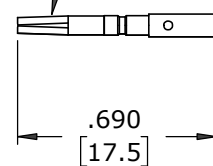

GROMMET  
MAT'L: SANTOPRENE, BLACK

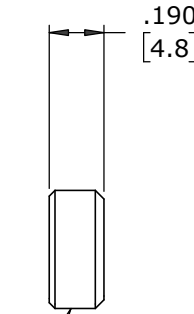

CABLE GRIP  
MAT'L: POLYPROPYLENE, BLACK

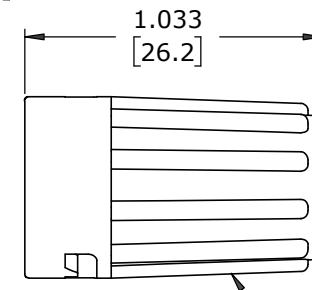

BACKSHELL  
MAT'L: UV PBT, BLACK

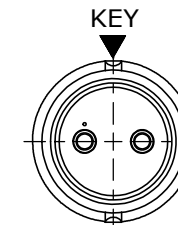

**WIRING END**  
W6280-2SG-P-5XX SHOWN  
WITHOUT HARDWARE

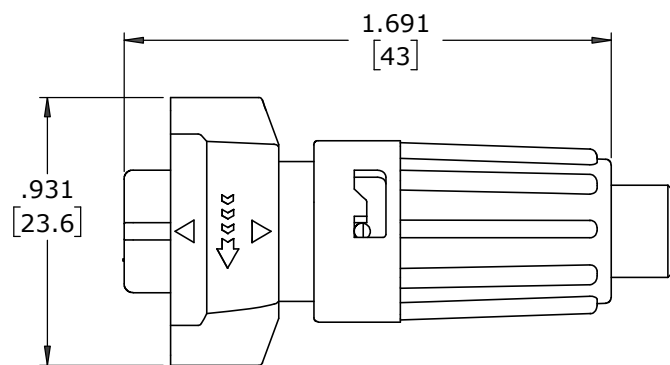

**SHOWN ASSEMBLED**  
FOR CUSTOMER REFERENCE ONLY

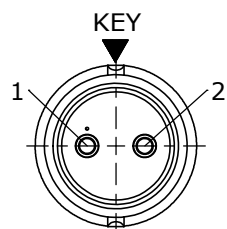

**WIRING END**  
W6280-2SG-P-5XX

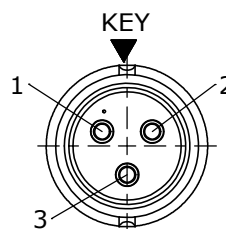

**WIRING END**  
W6280-3SG-P-5XX

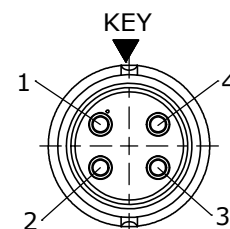

**WIRING END**  
W6280-4SG-P-5XX

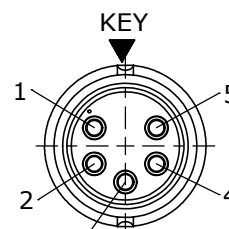

**WIRING END**  
W6280-5SG-P-5XX

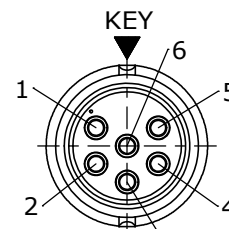

**WIRING END**  
W6280-6SG-P-5XX

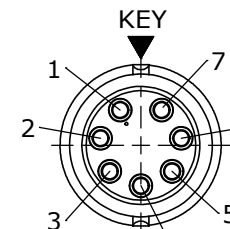

**WIRING END**  
W6280-7SG-P-5XX

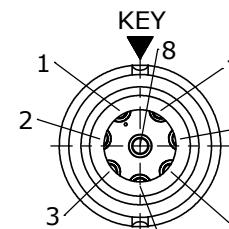

**WIRING END**  
W6280-8SG-P-528

**RoHS COMPLIANT**

B	MA	02-24-21	ADDED W6280-XSG-P-526 TO CHART PER ECR 9544
A	MA	02-28-20	RELEASED PER PDR 16014-7
	PNK	01-15-18	PDR 16014
REV.	INIT.	DATE	DESCRIPTION
<small>ALL INFORMATION ILLUSTRATED IS THE PROPERTY OF CONXALL CORPORATION. UNAUTHORIZED DUPLICATION OR DISTRIBUTION OF THIS DOCUMENT IS PROHIBITED.</small>			ORIG. DRAWN BY: PNK DATE: 01-15-18 CHECKED BY:
<small>ALL UNITS ARE IN FEET, INCHES, FRACTION OF INCHES AND DECIMALS. UNLESS OTHERWISE SPECIFIED TOLERANCES: 3 PLACE DECIMALS ±.010 ANGLES ±1° FRACTIONS ±1/16</small>			APPROVED BY: _____ TITLE: CABLE-END ASSEMBLY 2-8 #20 SOCKET CONTACTS, CRIMP INSTA-CLICK™ MINI-CON-X CUSTOMER: STANDARD PRODUCT
FILE:	W6280-XSG-P-5XX	DIRECTORY:	SLW
PART NUMBER: W6280-XSG-P-5XX			REV B

CUSTOMER PRINT

PART NUMBER: W6280-XSG-P-5XX

# Mouser Electronics

Authorized Distributor

Click to View Pricing, Inventory, Delivery & Lifecycle Information:

## Switchcraft:

[W6280-7SG-P-519](#) [W6280-3SG-P-526](#) [W6280-6SG-P-526](#) [W6280-5SG-P-513](#) [W6280-5SG-P-526](#) [W6280-4SG-P-513](#) [W6280-8SG-P-526](#) [W6280-2SG-P-522](#) [W6280-3SG-P-516](#) [W6280-7SG-P-526](#) [W6280-4SG-P-528](#) [W6280-8SG-P-528](#) [W6280-4SG-P-526](#) [W6280-5SG-P-528](#) [W6280-4SG-P-522](#) [W6280-2SG-P-528](#) [W6280-7SG-P-513](#) [W6280-2SG-P-513](#) [W6280-7SG-P-516](#) [W6280-3SG-P-513](#) [W6280-6SG-P-513](#) [W6280-3SG-P-522](#) [W6280-6SG-P-519](#) [W6280-8SG-P-522](#) [W6280-2SG-P-519](#) [W6280-3SG-P-519](#) [W6280-8SG-P-513](#) [W6280-2SG-P-516](#) [W6280-5SG-P-516](#) [W6280-4SG-P-516](#) [W6280-6SG-P-522](#) [W6280-2SG-P-526](#) [W6280-5SG-P-519](#) [W6280-8SG-P-516](#) [W6280-7SG-P-522](#) [W6280-6SG-P-516](#) [W6280-8SG-P-519](#) [W6280-5SG-P-522](#) [W6280-4SG-P-519](#) [W6280-6SG-P-528](#) [W6280-3SG-P-528](#) [W6280-7SG-P-528](#)