

PIN RECEPTACLES

**FOR .015" - .018" DIAMETER PINS (#09 CONTACT)
FOR .015" - .020" DIAMETER PINS (#11 CONTACT)
AND .015" - .022" DIAMETER PINS (#21 CONTACT)**

0467

0467-0-15-XX-21-XX-04-0

Press-fit in .037 mounting hole

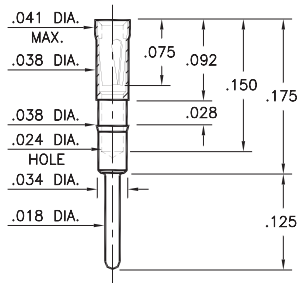

0552

0552-X-15-XX-X1-XX-10-0

Solder mount in .040 min. mounting hole
Also available on 16mm wide carrier tape:
1,500 parts per 13" reel
See page 194.1 for Tape & Reel details

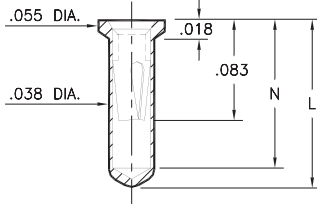

Basic Part Number	Length L	Depth N
0552-1	.136	.120
0552-2	.170	.150

5522

5522-0-15-XX-09-XX-10-0

Solder mount in .040 min. mounting hole

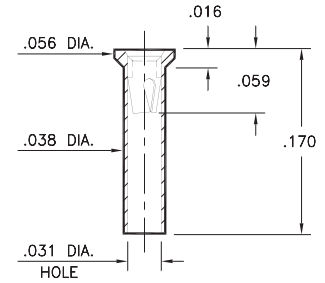

0569

0569-0-15-XX-X1-XX-10-0

Solder mount in .040 min. mounting hole
Also available on 16mm wide carrier tape:
2,000 parts per 13" reel
See page 194.1 for Tape & Reel details

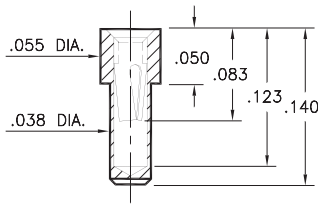

6023

6023-0-15-XX-21-XX-10-0

Solder mount in .040 min. mounting hole

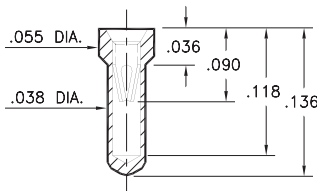

6214

6214-0-15-XX-21-XX-10-0

Solder mount in .040 min. mounting hole

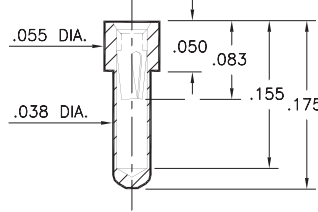

2086

2086-0-15-XX-21-XX-04-0

Press-fit in .040 mounting hole

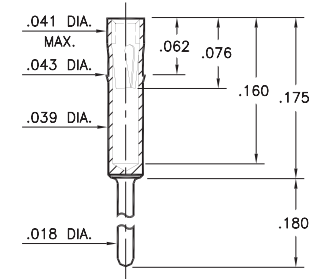

0461

0461-X-15-XX-X1-XX-04-0

Solder mount in .020 min. mounting hole

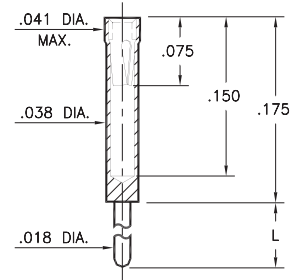

Basic Part Number	Length L
0461-0	.400
0461-1	.275
0461-2	.180
0461-3	.125
0461-4	.060
0461-5	.440

8579

8579-X-15-XX-X1-XX-10-0

Solder mount in .040 min. mounting hole
Also available on 24mm wide carrier tape
See chart for details
See page 194.1 for Tape & Reel details

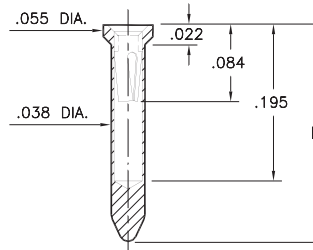

Basic Part Number	Length L
8579-0	.234
8579-1	.295

T&R Packaging

Basic Part Number	Tape Width	Parts per 13" Reel
8579-0	24mm	1,200
8579-1	24mm	1,000

SPECIFICATIONS:

Shell Material: Brass Alloy 360, 1/2 Hard

Contact Material: Beryllium Copper Alloy 172, HT

Dimensions: Inches

Tolerances On: Lengths: ±.005

Diameters: ±.002

Angles: ±2°



ORDER CODE: XXXX - X - XX - XX - XX - XX - XX - 0

BASIC PART #

SPECIFY SHELL FINISH:

- 01 200 μ" TIN/LEAD OVER NICKEL
- ◆ 80 200 μ" TIN OVER NICKEL (RoHS)
- ◆ 15 10 μ" GOLD OVER NICKEL (RoHS)

SPECIFY CONTACT FINISH:

- 02 100 μ" TIN/LEAD OVER NICKEL
- ◆ 84 100 μ" TIN OVER NICKEL (RoHS)
- ◆ 27 30 μ" GOLD OVER NICKEL (RoHS)

SELECT CONTACT:

#09, #11 or #21 CONTACT (DATA ON PAGES 250 & 251)

(For alternate contact choices, see group A on page 248)



Mouser Electronics

Authorized Distributor

Click to View Pricing, Inventory, Delivery & Lifecycle Information:

Mill-Max:

[8579-1-15-01-21-27-10-0](#) [8579-0-15-01-11-27-10-0](#) [2086-0-15-01-21-02-04-0](#) [2086-0-15-01-21-27-04-0](#) [0461-0-15-80-21-27-04-0](#) [8579-0-15-15-21-27-10-0](#) [0461-3-15-15-11-14-04-0](#) [0461-3-15-15-21-27-04-0](#) [0461-1-15-15-21-27-04-0](#) [0461-3-15-15-21-14-04-0](#) [0461-1-15-15-21-14-04-0](#) [0461-5-15-15-21-27-04-0](#) [0461-0-15-80-11-27-04-0](#) [0461-2-15-80-21-27-04-0](#) [0569-0-15-01-21-02-10-0](#) [0569-0-15-01-21-27-10-0](#) [0569-0-15-01-11-02-10-0](#) [0552-1-15-01-21-02-10-0](#) [0552-1-15-01-21-27-10-0](#) [0552-1-15-01-11-02-10-0](#) [0467-0-15-01-21-02-04-0](#) [0467-0-15-01-21-27-04-0](#) [0569-0-15-15-11-27-10-0](#) [0569-0-15-15-21-27-10-0](#) [2086-0-15-15-21-27-04-0](#) [8579-0-15-15-11-27-10-0](#) [8579-1-15-15-11-27-10-0](#) [8579-1-15-15-21-27-10-0](#) [0461-1-15-01-21-27-04-0](#) [0467-0-15-80-21-14-04-0](#) [0461-3-15-15-11-27-04-0](#) [8579-0-15-00-11-00-10-0](#) [8579-0-15-00-21-00-10-0](#) [2086-0-15-01-21-14-04-0](#) [0461-1-15-01-11-14-04-0](#) [0461-4-15-01-11-14-04-0](#) [0461-4-15-80-11-14-04-0](#) [0461-2-15-01-11-14-04-0](#) [0461-0-15-01-21-14-04-0](#) [0461-5-15-01-11-14-04-0](#) [0461-3-15-01-21-14-04-0](#) [0461-1-15-80-21-14-04-0](#) [0461-4-15-80-21-14-04-0](#) [0461-5-15-80-11-14-04-0](#) [0461-0-15-01-11-14-04-0](#) [0461-0-15-80-21-14-04-0](#) [0461-5-15-80-21-14-04-0](#) [0467-0-15-01-21-14-04-0](#) [0461-1-15-80-11-14-04-0](#) [0461-2-15-80-21-14-04-0](#) [0461-3-15-80-21-14-04-0](#) [0461-3-15-80-11-14-04-0](#) [0461-0-15-80-11-14-04-0](#) [0461-2-15-80-11-14-04-0](#) [2086-0-15-80-21-14-04-0](#) [0461-5-15-01-21-14-04-0](#) [0461-4-15-01-21-14-04-0](#) [0461-1-15-01-21-14-04-0](#) [0461-3-15-01-11-14-04-0](#) [0461-2-15-01-21-14-04-0](#) [0461-0-15-01-11-02-04-0](#) [0461-0-15-80-11-84-04-0](#) [0461-0-15-15-11-27-04-0](#) [0569-0-15-15-11-14-10-0](#) [0461-4-15-15-21-14-04-0](#) [0461-1-15-15-11-14-04-0](#) [0461-0-15-15-11-14-04-0](#) [0461-2-15-15-21-14-04-0](#) [0461-2-15-15-11-14-04-0](#) [0569-0-15-15-21-14-10-0](#) [0461-5-15-15-11-14-04-0](#) [0461-5-15-15-21-14-04-0](#) [0461-4-15-15-11-14-04-0](#) [0461-1-15-80-21-27-04-0](#) [5522-0-15-80-09-14-10-0](#) [8579-1-15-01-11-14-10-0](#) [0461-4-15-01-21-02-04-0](#) [0461-3-15-01-11-27-04-0](#) [0461-2-15-80-21-84-04-0](#) [6214-0-15-80-21-14-10-0](#) [0461-5-15-80-11-27-04-0](#) [6023-0-15-80-21-14-10-0](#) [0461-3-15-80-11-84-04-0](#) [0461-3-15-01-11-02-04-0](#) [0461-1-15-01-21-02-04-0](#) [0461-5-15-01-21-27-04-0](#) [0461-1-15-80-21-84-04-0](#) [6023-0-15-01-21-14-10-0](#) [5522-0-15-01-09-14-10-0](#) [8579-1-15-80-21-14-10-0](#) [8579-0-15-01-11-14-10-0](#) [6214-0-15-01-21-14-10-0](#) [0461-0-15-01-21-27-04-0](#) [8579-0-15-01-21-14-10-0](#) [0461-3-15-01-21-02-04-0](#) [0461-4-15-80-21-27-04-0](#) [0461-5-15-01-11-27-04-0](#) [0461-4-15-80-11-27-04-0](#) [8579-1-15-80-11-14-10-0](#) [8579-1-15-01-21-14-10-0](#)