

DESCRIPTION: MALE - DIP SOLDER / MACHINED - ECONOMY

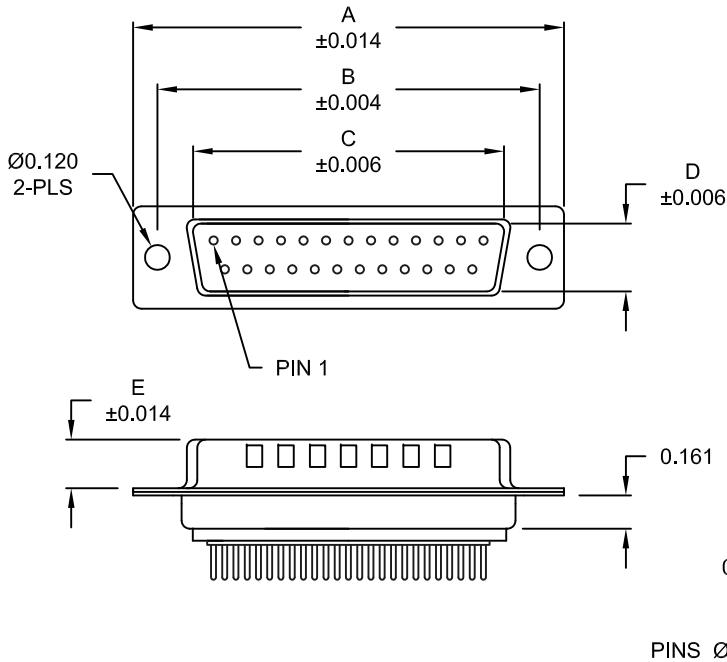

No. OF PINS	DIMENSIONS					
	A	B	C	D	E	F
9	1.213	0.984	0.666	0.329	0.236	0.496
	30.80	24.99	16.92	8.36	5.99	12.60
15	1.541	1.312	0.994	0.329	0.236	0.496
	39.15	33.32	25.25	8.36	5.99	12.60
25	2.087	1.852	1.534	0.329	0.236	0.496
	53.00	47.04	38.96	8.36	5.99	12.60
37	2.728	2.500	2.182	0.329	0.236	0.496
	69.30	63.50	55.42	8.36	5.99	12.60
50	2.638	2.406	2.079	0.436	0.240	0.602
	67.00	61.11	52.80	11.07	6.10	15.30

172-EYY-11YRYY1

- SERIES
- POSITIONS
 - E09
 - E15
 - E25
 - E37
 - E50
- GENDER
 - 1 = MALE
- TERMINATION LENGTH
 - 1 = 0.189"
 - D = 0.394" [10mm]
- SHELL PLATING
 - 3 = NICKEL (GROUND INDENTS)
- RoHS COMPLIANT
- HARDWARE OPTIONS
 - 00 = NO HARDWARE
 - 01 = .098" CLINCH NUT (BOARD SIDE)
 - 02 = .236" CLINCH NUT (BOARD SIDE)
 - 03 = .236" CLINCH NUT (MOUNTING SIDE)
 - 05 = .237" 4-40 BOARD LOCK
 - 08 = .228" 4-40 BOARD LOCK
 - 90 = .237" 4-40 BOARD LOCK FOR 0.093" BOARD MAX.
 - 91 = .237" 4-40 SPACER/ BOARD LOCK
 - 92 = .237" 4-40 SPACER/ BOARD LOCK FOR 0.093" BOARD MAX.
- PLATING OPTIONS
 - 1 = GOLD FLASH
 - 2 = 30MICRO-INCH GOLD
 - 3 = 50 MICRO-INCH GOLD
 - 5 = 15 MICRO-INCH GOLD

MATERIAL:

- SHELL: STEEL, NICKEL PLATED
- INSULATOR: UL 94V-O RATED, WHITE PA6T
- PROCESS TEMP.: 260° PROCESS TEMPERATURE
- CONTACT: BRASS

ELECTRICAL:

- CURRENT RATING: 5 AMPS
- CONTACT RESISTANCE: 15 mOhms Max.
- INSULATION RESISTANCE: 1,000 MOhms min.
- WORKING VOLTAGE: 250VAC
- TEMPERATURE: -55° C TO 125° C

UNITS = inch [mm]



THESE DRAWINGS AND SPECIFICATIONS ARE THE PROPERTY OF NorComp AND SHALL NOT BE REPRODUCED, COPIED OR USED AS THE BASIS FOR THE MANUFACTURE OF SALE OF APPARATUS WITHOUT WRITTEN PERMISSION.

DRAWN: PAM JENKINS		DATE: 11-28-05	
SCALE: NTS	SHEET 1 OF 3	REV 19	
DWG NO. 172-EYY-11YRYY1			

NorComp

RoHS COMPLIANT

DO NOT SCALE FROM DRAWING

DESCRIPTION: PCB LAYOUT - STANDARD "D" - MALE & FEMALE

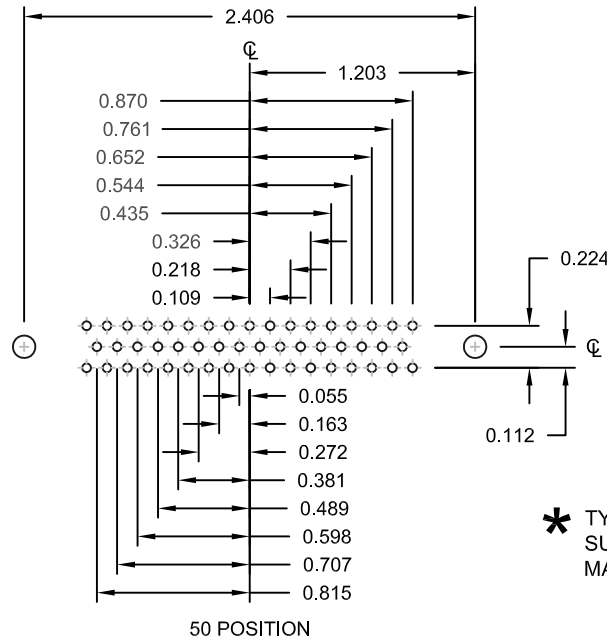
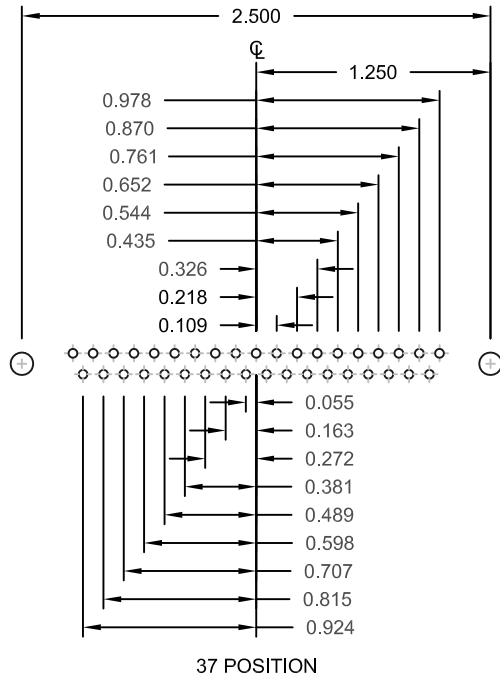
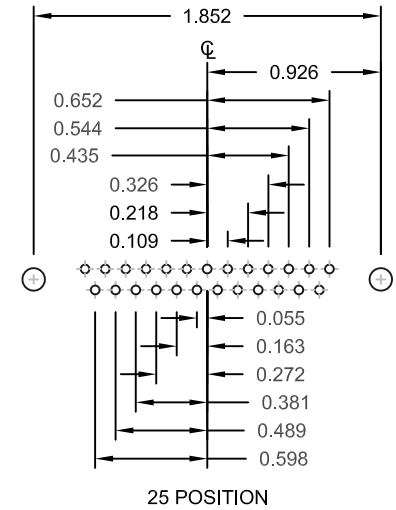
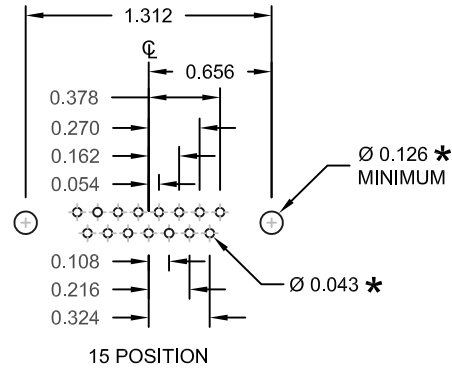
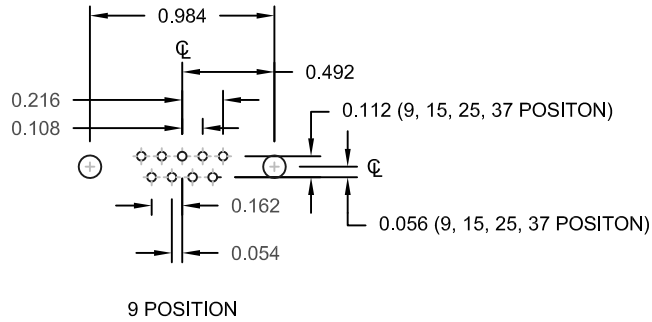

UNITS = inch

* TYP. SUGGESTED SIZE MAY NOT BE SUITABLE FOR ALL APPLICATIONS

DO NOT SCALE FROM DRAWING

	THESE DRAWINGS AND SPECIFICATIONS ARE THE PROPERTY OF NorComp AND SHALL NOT BE REPRODUCED, COPIED OR USED AS THE BASIS FOR THE MANUFACTURE OF SALE OF APPARATUS WITHOUT WRITTEN PERMISSION.		DRAWN: PAM JENKINS	DATE: 11-28-05
	NorComp		SCALE: NTS	SHEET OF 2 3
DWG NO. 172-EYY-11YRY1				

DESCRIPTION: CLINCH NUT HARDWARE

ALL CLINCH-NUTS ARE 4-40 INTERNAL THREADS

TOLERANCE:

ALL DIMENSIONS ARE ±0.010

01X 0.098" (BOARD SIDE)

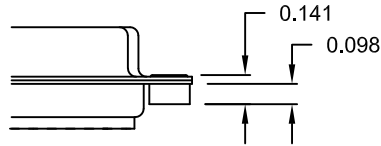

02X 0.236" (BOARD SIDE)

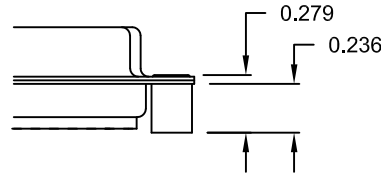

03X..... 0.236" (MATING SIDE)

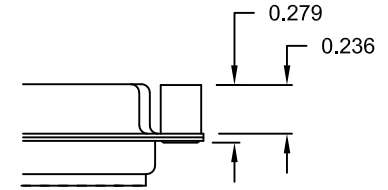

05X 0.237" (BOARD SIDE)

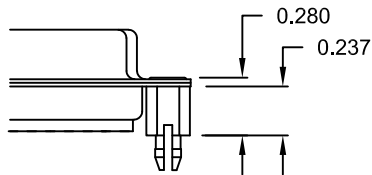

08X 0.228" (BOARD SIDE)

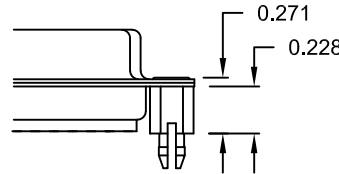

91X 0.237" BOARD SIDE

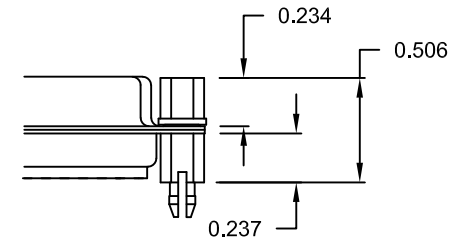

NOTE: 4-40 FEMALE SCREW LOCK IS REMOVABLE

90X 0.237" (BOARD SIDE)

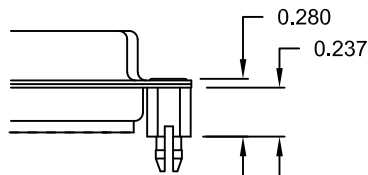

92X 0.237" BOARD SIDE

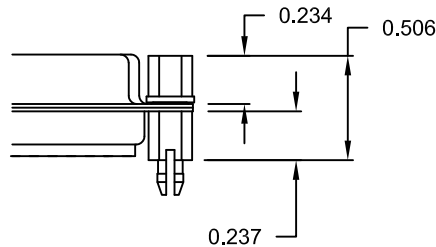

NOTE: 4-40 FEMALE SCREW LOCK IS REMOVABLE

UNITS = inch [mm]

NOTE: 90 & 92 OPTION FOR 0.093" MAX. BOARD THICKNESS

DO NOT SCALE FROM DRAWING

RoHS COMPLIANT



THESE DRAWINGS AND SPECIFICATIONS ARE THE PROPERTY OF NorComp AND SHALL NOT BE REPRODUCED, COPIED OR USED AS THE BASIS FOR THE MANUFACTURE OF SALE OF APPARATUS WITHOUT WRITTEN PERMISSION.

NorComp

DRAWN: PAM JENKINS		DATE: 11-28-05	
SCALE: NTS	SHEET 3	OF 3	REV 19
DWG NO. 172-EYY-11YRY1			

Mouser Electronics

Authorized Distributor

Click to View Pricing, Inventory, Delivery & Lifecycle Information:

NorComp:

<u>172-E37-113R021</u>	<u>172-E37-113R011</u>	<u>172-E37-113R031</u>	<u>172-E09-113R021</u>	<u>172-E09-113R011</u>	<u>172-E09-113R031</u>
<u>172-E15-113R911</u>	<u>172-E25-113R031</u>	<u>172-E25-113R011</u>	<u>172-E25-113R021</u>	<u>172-E50-113R021</u>	<u>172-E50-113R011</u>
<u>172-E50-113R031</u>	<u>172-E15-113R021</u>	<u>172-E15-113R031</u>	<u>172-E15-113R011</u>	<u>172-E37-113R001</u>	<u>172-E09-113R001</u>
<u>172-E25-113R001</u>	<u>172-E50-113R001</u>	<u>172-E15-113R001</u>	<u>172-E09-113R911</u>	<u>172-E25-113R911</u>	<u>172-E37-113R911</u>
<u>172-E50-113R911</u>	<u>172-E15-113R051</u>	<u>172-E37-113R051</u>	<u>172-E25-113R051</u>	<u>172-E09-113R051</u>	