

GP Batteries

Data Sheet

Rechargeable Nickel Metal Hydride Battery

Model: 100AAHC (Revamp)

Revision History

Revision	Date	Initiator	Change Description
00	2016-3-24	Jackie Yu	New Issue

Prepared by	Checked by	Approver
RD Engineer	RD Manager	SM
SY Jiang	Jackie Yu	Vivian Fong
Date: 2016-3-24	Date: 2016-3-24	Date: 2016-3-24

GPI International Limited

Gold Peak Building, 8/F, 30 Kwai Wing Road,
Kwai Chung, New Territories, Hong Kong.
Tel: (852) 2484 3333 Fax: (852) 24805912
Email: gpii@goldpeak.com
Website: <http://www.gpbatteries.com>

Type	: Rechargeable Nickel Metal Hydride Cylindrical Cell
Nominal Dimension (with Sleeve)	: $\Phi = 14.5\text{mm}$ H = 50.5mm
Applications	: Recommended discharge current 100 to 3000mA
Nominal Voltage	: 1.2V
Capacity	: Rated: 1000mAh Typical: 1050mAh When discharged at 200mA to 1.0V at 20°C
Charge Retention	: 80% of nominal capacity after cell storage at 20°C for 24 months When discharged at 200mA to 1.0V at 20°C
Charging Condition	: 100mA for 16hrs at 20°C
Fast Charge	: 500mA to 1000mA (0.5 to 1C) charge termination control recommended control parameters: - ΔV : 0-5mV DT/dt : 0.8°C/min (0.5 to 0.9C) 0.8 - 1°C/min (1C) TCO : 45 - 50°C Timer : 105% nominal input (for ref. only)
Service Life	: >300 cycles (IEC standard)
Continuous Overcharge	: 100mA maximum current for 1 year. No conspicuous deformation and/or Leakage
Weight	: 20.0g
Internal Resistance	: Average 28m Ω upon fully charged (Max. 40m Ω) at 1000Hz
Max. Charging Voltage	: 1.5V at 100mA charging
Ambient Temperature Range	: Standard Charge : 0 to 45°C Fast Charging : 10 to 45°C Discharge : -20 to 50°C Storage : -20 to 35°C

Model No.: **GP100AAHC**

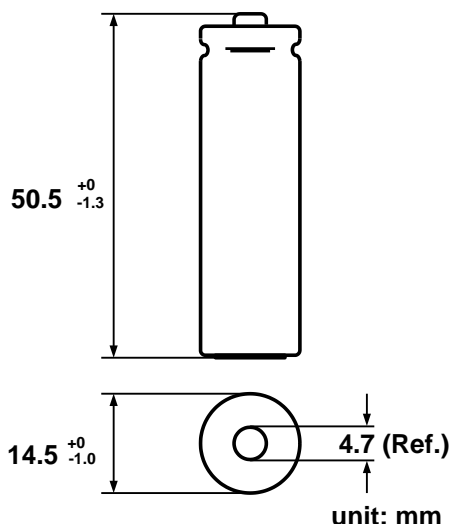

Low Rate Discharge

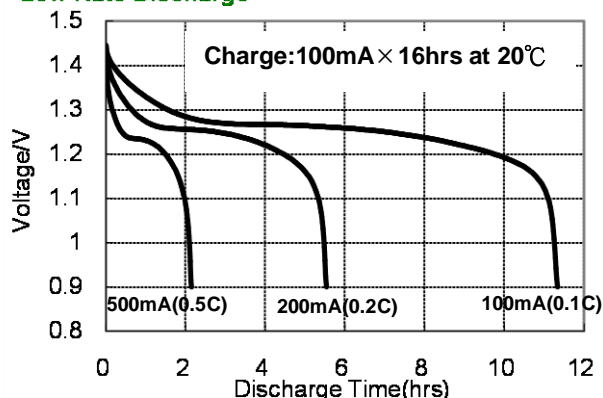

High Rate Discharge

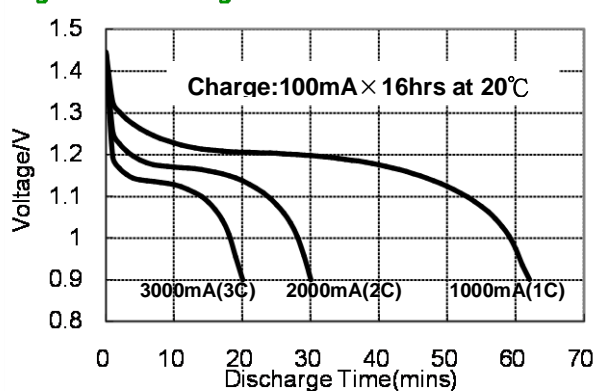

Fast Charge (Charge Control required)

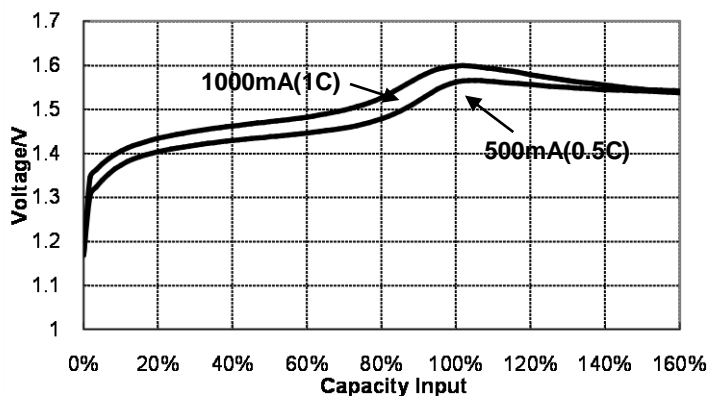

The information (subject to change without prior notice) contained in this document is for reference only and should not be used as a basis for product guarantee or warranty. For applications other than those described here, please consult your nearest GP Sales and Marketing Office or Distributors.