

REVISIONS				
P	LTR	DESCRIPTION	DATE	APVD
1		PRELIMINARY	22DEC2020	DV PS
A		PRODUCTION RELEASE	28APR2021	SS PS

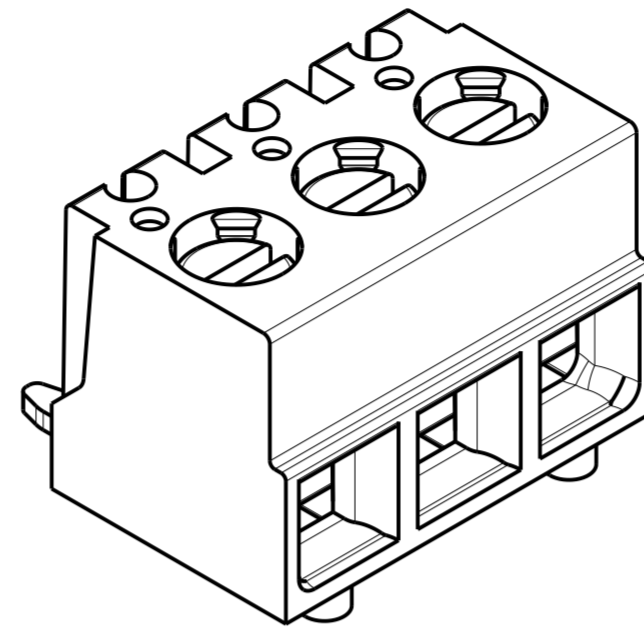
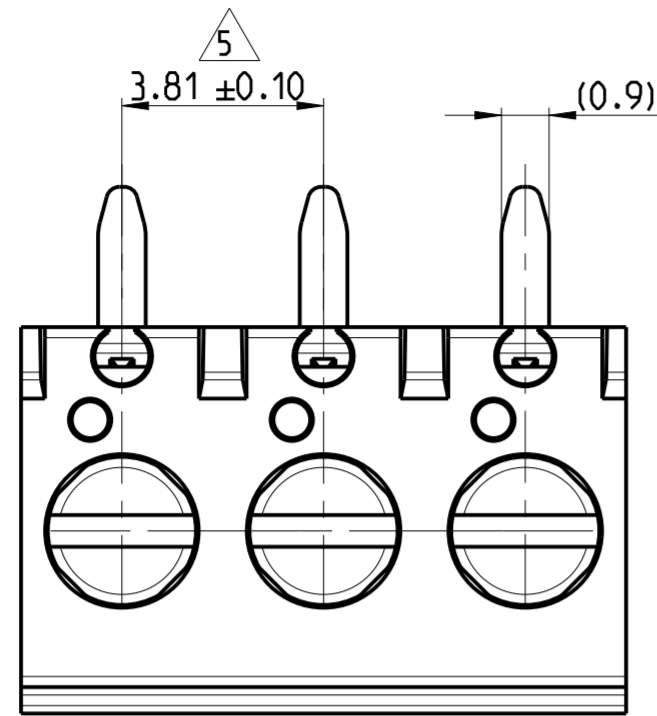

2383941-3 AS SHOWN

NOTES

- MATERIALS & FINISH**  
 HOUSING : HIGH TEMPERATURE PA, UL94 V0, COLOR -BLACK  
 SCREW M2 : COPPER ALLOY, NICKEL PLATED  
 CLAMP : COPPER ALLOY, NICKEL PLATED  
 CONTACT : COPPER ALLOY, NICKEL & TIN PLATED
- MECHANICAL**  
 WIRE STRIPPING LENGTH : 5-6 mm  
 RECOMMENDED/HIGHEST TIGHTENING TORQUE : 0.5/0.6 Nm.
- ELECTRICAL**  
 WIRE RANGE : 18 - 28 AWG  
 MAX. VOLTAGE : 300 V  
 MAX CURRENT : 7 A  
 CONTACT RESISTANCE : <15 m Ohm  
 INSULATION RESISTANCE : >1000 M Ohm (500V DC)
- OPERATING TEMPERATURE RANGE:** -40 °C TO +105 °C
- TOLERANCE NOT CUMULATIVE.**
- SCREW CLAMP WILL BE IN CLOSED CONDITION.**

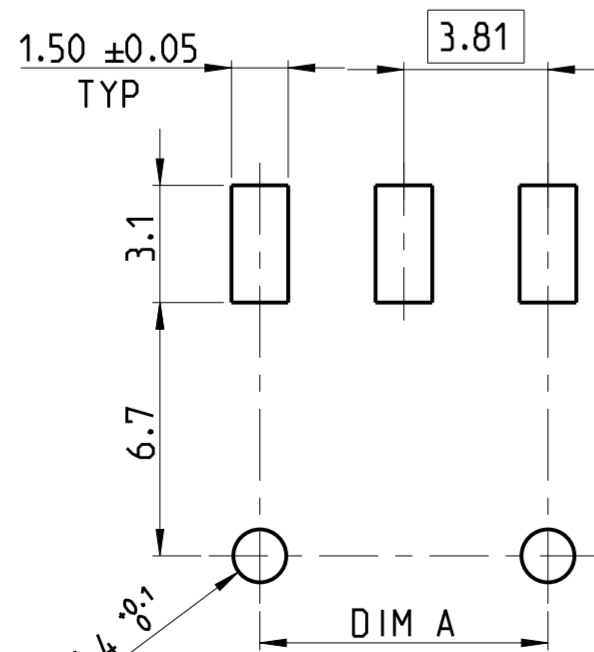
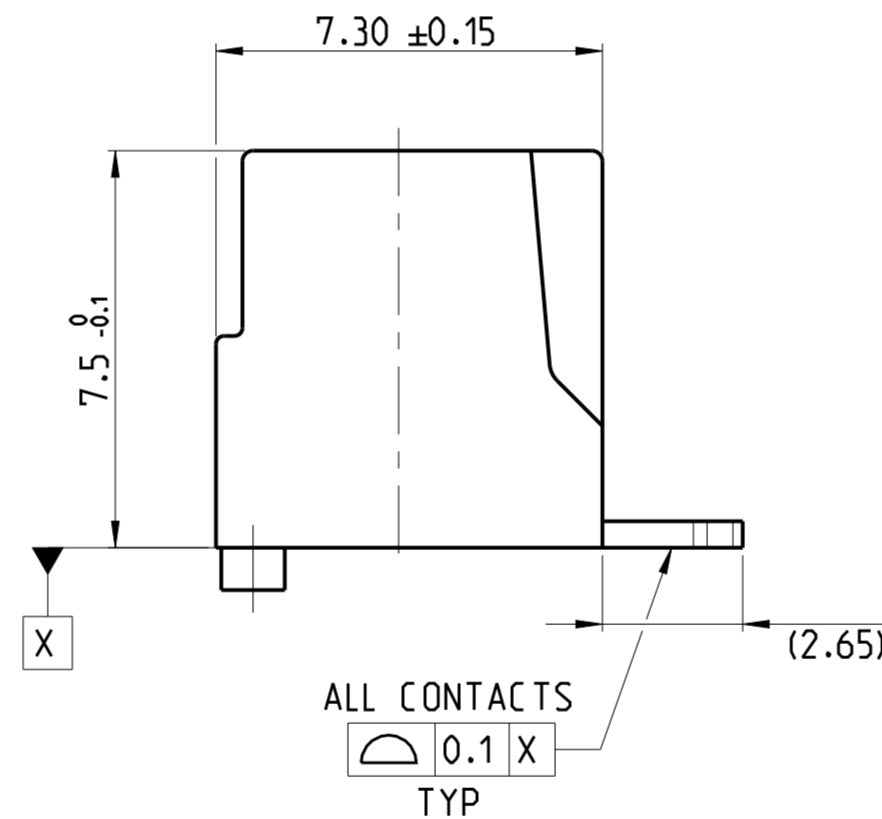
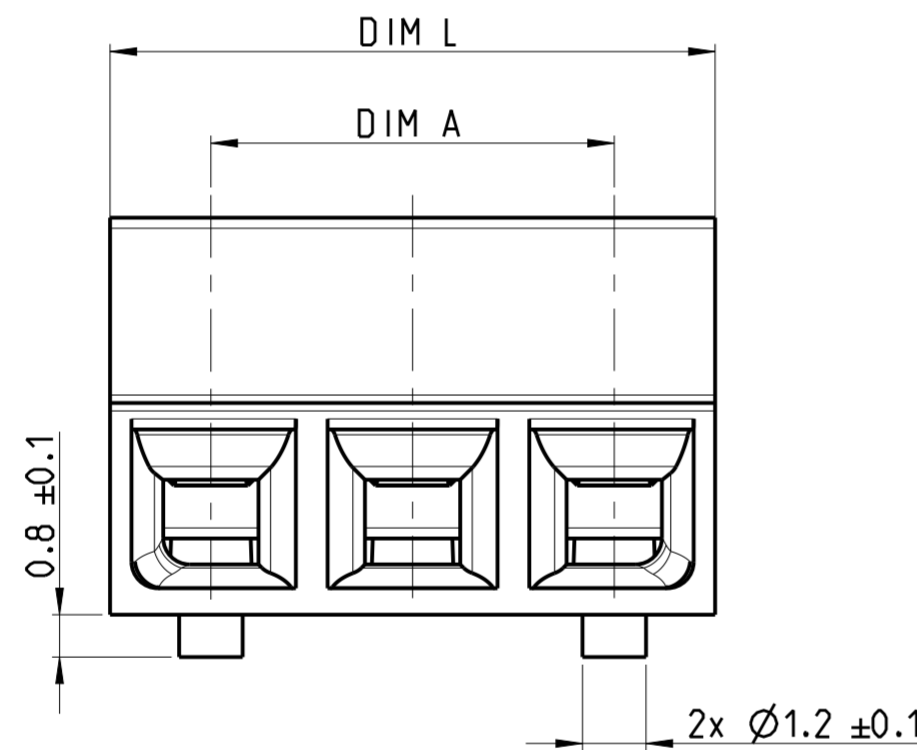

RECOMMENDED PCB LAYOUT

41.91		45.72		12	1-2383941-2
38.10		41.91		11	1-2383941-1
34.29		38.10		10	1-2383941-0
30.48	±0.20	34.29	±0.20	9	2383941-9
26.67		30.48		8	2383941-8
22.86		26.67		7	2383941-7
19.05		22.86		6	2383941-6
15.24		19.05		5	2383941-5
11.43	±0.15	15.24	±0.15	4	2383941-4
7.62		11.43		3	2383941-3
3.81	±0.10	7.62		2	2383941-2
<b>DIM A</b>		<b>DIM L</b>		<b>POSITION</b>	<b>TE PN</b>

THIS DRAWING IS A CONTROLLED DOCUMENT.

DIMENSIONS: mm	TOLERANCES UNLESS OTHERWISE SPECIFIED: 0 PLC ± 1 PLC ±0.3 2 PLC ±0.25 3 PLC ± 4 PLC ±	APVD PRASHANTH S	NAME
MATERIAL	FINISH	APVD PRASHANTH S	PRODUCT SPEC
		APVD PRASHANTH S	APPLICATION SPEC
		APVD PRASHANTH S	WEIGHT
		APVD PRASHANTH S	CUSTOMER DRAWING

DATE: 18DEC2020  
 CHK: SUBHASREE SAHOO  
 APVD: PRASHANTH S  
 PRODUCT SPEC: 108-160231  
 APPLICATION SPEC: -  
 WEIGHT: -

**STE** TE Connectivity

NAME: TERMINAL BLOCK, SMD MOUNT, 180 DEGREE, 3.81 MM PITCH 7A

SIZE: A2 CAGE CODE: 00779 DRAWING NO: C-2383941 RESTRICTED TO: 1 OF 1 REV A

SCALE: 5:1 SHEET: 1 OF 1 REV: A