

THIS IS A C.A.D. GENERATED DRAWING
DO NOT MAKE MANUAL REVISIONS TO MASTER

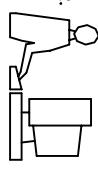

* UNLESS OTHERWISE SPECIFIED TOLERANCES
ON DECIMAL IS:
FRACTION ± 1/32
2 PLACE ± .01
3 PLACE ± .005
4 PLACE ± .0001
5 PLACE ± .000050
6 PLACE ± .000020

ISSUE NUMBER
DRIGINAL ①
RE-DRAWN AND F.BRIONES JUL.08/08 ⑥

- NOTES:
1. MATERIAL: NYLON 6/6 NATURAL
 2. SUITABLE FOR USE WITH 317, 321, 312, 341 SERIES CONTACTS.

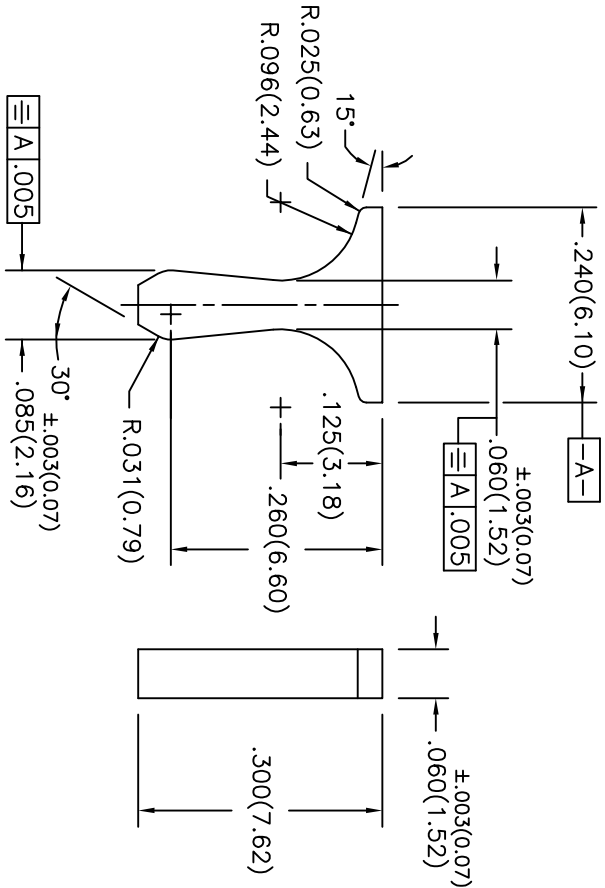

POLARIZING PIN (MOULDED)

ACAD REFERENCE NO. 321-240-328	
DRAWN: F.BRIONES	DATE: JUL.08/08
CHECKED:	DATE:
SCALE: (IN C.A.D. 1:1)	SHEET 1 OF 1
DRAWING NUMBER	ISSUE
321-240-328	6

EDAC INC
TORONTO, ONTARIO
CANADA
YOUR CONNECTION TO QUALITY & SERVICE

THESE DRAWINGS AND SPECIFICATIONS
ARE THE PROPERTY OF EDAC, INC. AND
SHALL NOT BE REPRODUCED, OR COPIED
OR USED AS THE BASIS FOR THE
MANUFACTURE OR SALE OF APPARATUS
WITHOUT WRITTEN PERMISSION.

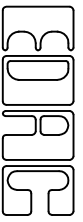

Mouser Electronics

Authorized Distributor

Click to View Pricing, Inventory, Delivery & Lifecycle Information:

[EDAC:](#)

[321-240-328](#)